

NOTE: CHAINAGES SHOWN ARE ALONG THE S R OF HEKLA

SEWER JUNCTION INFORMATION FROM VIDEO INSPECTION S-MA00007459
DISTANCE FROM S-MH00007460
7.5m EAST - 100mm CONNECTION NORTH
21.9m EAST - 100mm CONNECTION NORTH

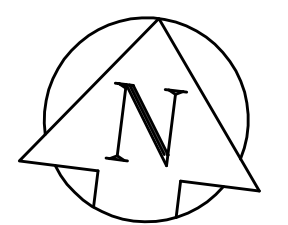

APEGM
 Certificate of Authorization
 Earth Tech Canada Inc.
 No. 730 Expiry: April 30, 2008

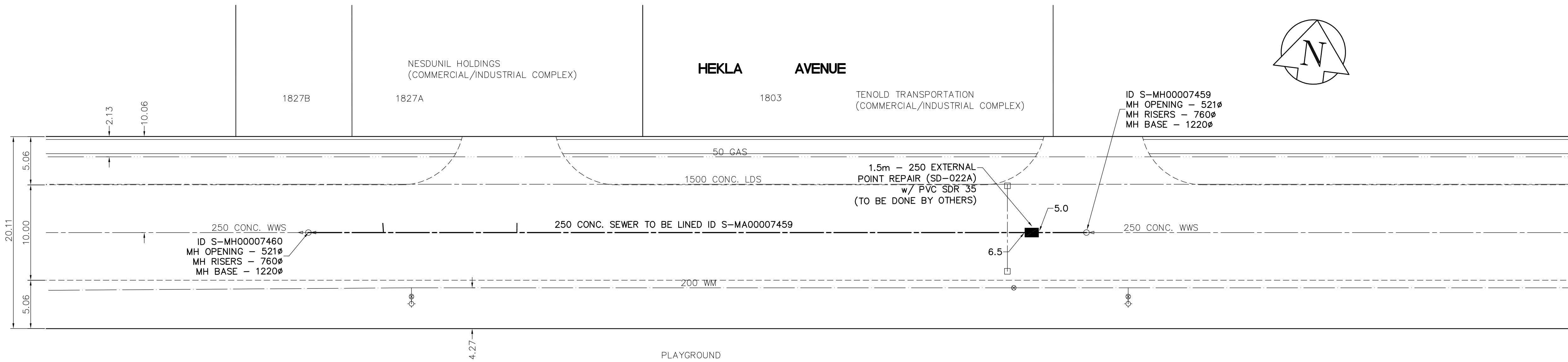
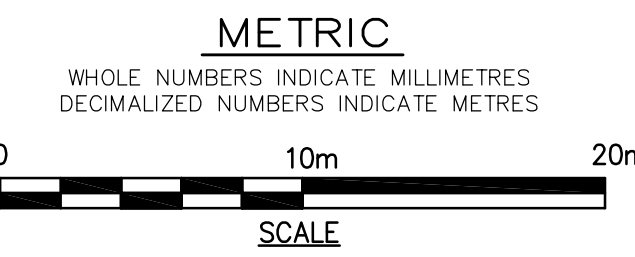

LEGEND
 -52.0 MEASUREMENT TO REPAIR FROM REFERENCE MH SHOWN THUS... 0.0
 - TO BE LINED

150 mm W.M.	WATERMAIN	150 mm W.M.	HYDRO	150 mm W.M.	WATERMAIN
300mm L.D.S.	LAND DRAINAGE SEWER	300mm L.D.S.	CONCRETE	300mm L.D.S.	LAND DRAINAGE SEWER
250mm W.W.S.	WASTEWATER SEWER	250mm W.W.S.	ASPHALT	250mm W.W.S.	WASTE WATER SEWER
MANHOLE	MANHOLE	SURVEY BAR	PROPERTY LINE	PROPERTY LINE	PROPERTY LINE
CATCH BASIN	CATCH BASIN	CURB STOP	TREE	TREE	TREE
CURB INLET	CURB INLET	ANODE	CONCRETE SIDEWALK	CONCRETE SIDEWALK	CONCRETE SIDEWALK
JUNCTIONS	JUNCTIONS	FENCE	FENCE	FENCE	FENCE
CULVERT	CULVERT				
GAS	GAS				
EXISTING	LEGEND - PLAN	PROPOSED	EXISTING	LEGEND - PLAN	PROPOSED
EXISTING	LEGEND - PROFILE	PROPOSED	EXISTING	LEGEND - PROFILE	PROPOSED

LOCATION APPROVED UNDERGROUND STRUCTURES
 SUPV. U/G STRUCTURES DATE COMMITTEE
 NOTE:
 LOCATION OF UNDERGROUND STRUCTURES AS SHOWN ARE BASED ON THE BEST INFORMATION AVAILABLE, BUT NO GUARANTEE IS GIVEN THAT ALL EXISTING UTILITIES ARE SHOWN OR THAT THE GIVEN LOCATIONS ARE EXACT. CONFIRMATION OF EXISTENCE AND EXACT LOCATION OF ALL SERVICES MUST BE OBTAINED FROM THE INDIVIDUAL UTILITIES BEFORE PROCEEDING WITH CONSTRUCTION.

B.M. 07-032	ELEV. 230.108
B	ISSUED FOR TENDER 2007/07/19 DA
A	ISSUED FOR REVIEW 2007/07/17 PL
NO.	REVISIONS
	DATE
	BY
	DATE

EARTH TECH
 A tyco INTERNATIONAL LTD. COMPANY
 Earth Tech (Canada) Inc. Winnipeg, Manitoba 204-477-5381

DESIGNED BY	PL	CHECKED BY	GSK
DRAWN BY	GDL	APPROVED BY	
HOR. SCALE: 1:250		RELEASED FOR CONSTRUCTION BY: K. ZUREK	
VERTICAL SCALE: 1:50		DATE: 2007/04/11	

ENGINEER'S SEAL
 PROVINCE OF MANITOBA
 ORIGINAL SIGNED BY
K.W. FITCHETT
 2007/07/19
 REGISTERED PROFESSIONAL ENGINEER
 CONSULTANT DRAWING NO. 99943-C12

THE CITY OF WINNIPEG
 Winnipeg WATER AND WASTE DEPARTMENT

2007 SEWER RENEWALS BY CIPP LINING

HEKLA AVENUE
 1ST M.H. WEST OF PARK LANE AVENUE
 TO 2nd M.H. WEST OF PARK LANE AVENUE

SHEET OF 12 12
 CITY DRAWING NUMBER 06068