

- NOTES:**
- ALL DEMOLISHED ELECTRICAL (POWER, TELECOMMUNICATIONS, ETC.) ARE TO HAVE THEIR WIRING AND RACEWAY REMOVED BACK TO SOURCE OF SUPPLY (TYPICAL ALL DEMOLITION).
  - WHERE DEMOLITION OF A DEVICE INTERRUPTS ELECTRICAL SERVICE TO A DOWNSTREAM DEVICE, EXTEND ELECTRICAL SERVICES TO MAINTAIN SERVICE TO DOWNSTREAM DEVICE. (TYPICAL ALL DEMOLITION)
  - UPDATE EXISTING PANELBOARD DIRECTORIES TO REFLECT DEMOLISHED DEVICES. UPDATED DIRECTORIES ARE TO BE TYPED. (TYPICAL ALL DEMOLITION)
  - REMOVE AND REINSTALL ALL EXISTING LIGHTING IN CARPET BOWLING CLUBROOM TO ACCOMMODATE NEW CEILING (NEW CEILING BEING PROVIDED DUE TO DUCTWORK ALTERATION). LIGHTING PATTERN SHOWN IS NOT ACCURATE.

- FIRE ALARM DEMOLITION NOTES:**
- FAD1. EXISTING FIRE ALARM PANEL IS MIRCOM FX-2000, INSTALLED IN 2006.
  - FAD2. REFER TO APPENDIX IN SPECIFICATION FOR F.A. VERIFICATION REPORT SHOWING FULL EXTENT OF DEMOLITION.
  - FAD3. EXISTING FIRE ALARM PANEL MAY BE REUSED, HOWEVER NEW ENCLOSURE IS REQUIRED AND REUSED PANEL MUST BE MODIFIED TO MEET THE FUNCTIONALITY REQUIRED FOR NEW SYSTEM. NEW ANNUNCIATOR IS REQUIRED REGARDLESS.
  - FAD4. EXISTING F.A. SYSTEM IS TO REMAIN IN PLACE UNTIL NEW F.A. SYSTEM (IN EXISTING BUILDING) IS OPERATIONAL AND VERIFIED UNLESS EXISTING SYSTEM CAN BE FULLY REPLACED WHEN BUILDING IS NOT OCCUPIED.
  - FAD5. PROVIDE TWO FIRE ALARM VERIFICATION REPORTS. ONE FOR EXISTING BUILDING, ONE FOR EXPANSION.
  - FAD6. TURN DEMOLISHED F.A. PANEL AND DEVICES OVER TO THE CITY FOR RE-USE.

- EMERGENCY LIGHTING DEMOLITION NOTES:**
- ELD1. EXISTING EMERGENCY LIGHTING SYSTEM IS TO REMAIN IN PLACE UNTIL NEW EMERGENCY LIGHTING SYSTEM (IN EXISTING BUILDING) IS OPERATIONAL AND VERIFIED UNLESS EXISTING SYSTEM CAN BE FULLY REPLACED WHEN BUILDING IS NOT OCCUPIED.
  - ELD2. TURN DEMOLISHED EXIT SIGNS AND BATTERY BANKS OVER TO THE CITY FOR RE-USE.

- DISTRESS/DROWNING ALARM DEMOLITION NOTES:**
- DAD1. EXISTING DISTRESS/DROWNING ALARM SYSTEM IS TO REMAIN IN PLACE UNTIL NEW DISTRESS/DROWNING ALARM SYSTEM (IN EXISTING BUILDING) IS OPERATIONAL AND VERIFIED UNLESS EXISTING SYSTEM CAN BE FULLY REPLACED WHEN BUILDING IS NOT OCCUPIED.
  - DAD2. EXISTING SYSTEM CONTROL PANELS ARE LOCATED AT FRONT DESK AND IN BASEMENT. REFER TO DETAIL FOR CONFIGURATION OF NEW SYSTEM.

- SECURITY SYSTEM DEMOLITION NOTES:**
- SSD1. EXISTING SECURITY SYSTEM IS BEING DEMOLISHED IN ITS ENTIRETY AND REPLACED WITH PEGASYS (JOHNSON CONTROLS) SECURITY MANAGEMENT SYSTEM.
  - SSD2. CURRENT SYSTEM CONSISTS OF ADT ALARM CABINET WHICH INTERFACE TO A METASYS MODULE OF THE FACILITIES MANAGEMENT SYSTEM.
  - SSD3. TURN DEMOLISHED SECURITY PANEL AND DEVICES OVER TO THE CITY TO RE-USE.

**PLAN 1**  
 SCALE 1:200  
 MAIN FLOOR  
 DEMOLITION AND EXISTING SERVICES

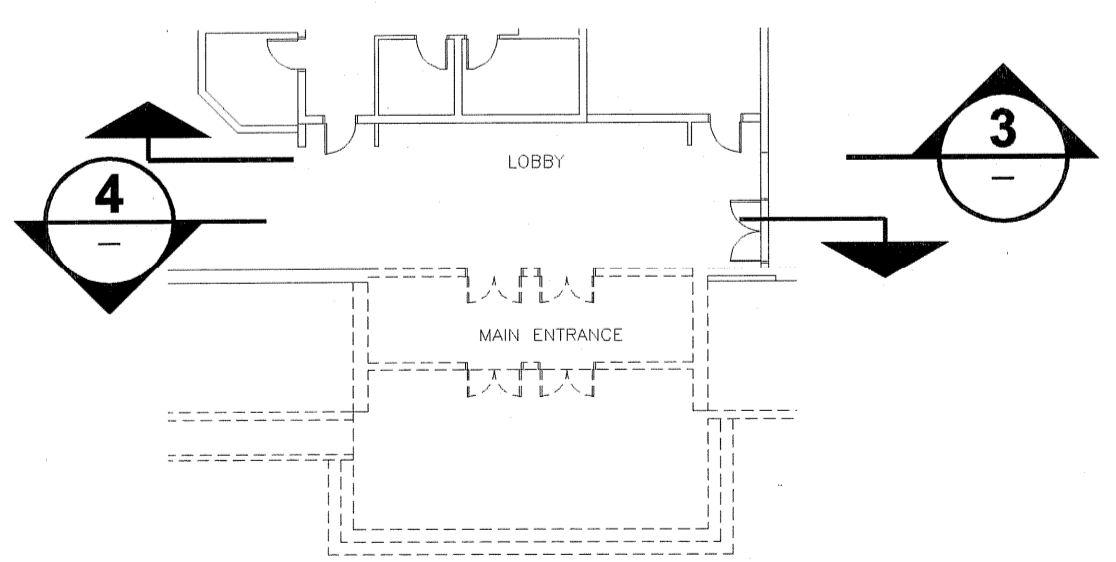

**PLAN 2**  
 SCALE 1:200  
 MAIN FLOOR - PARTIAL

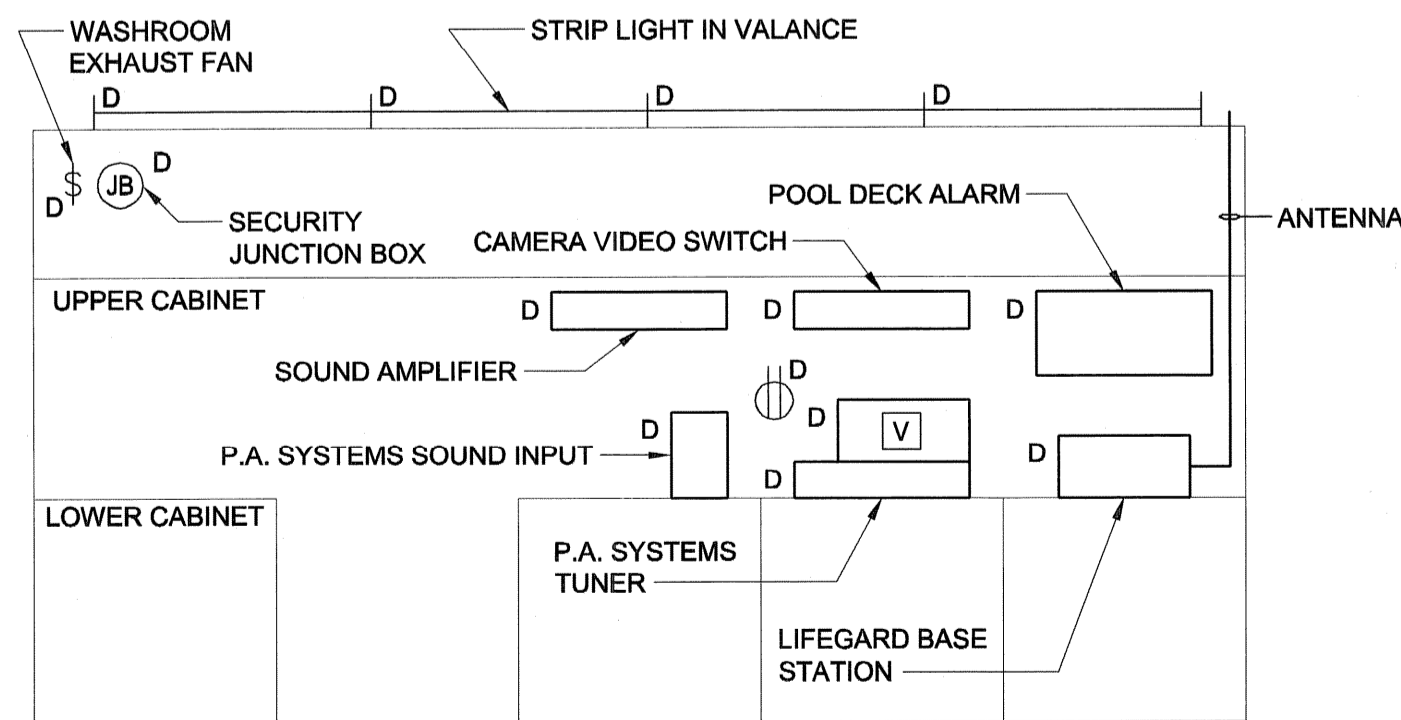

**ELEVATION 3**  
 SCALE: N.T.S.  
 DEMOLITION  
 BEHIND FRONT CONTROL DESK

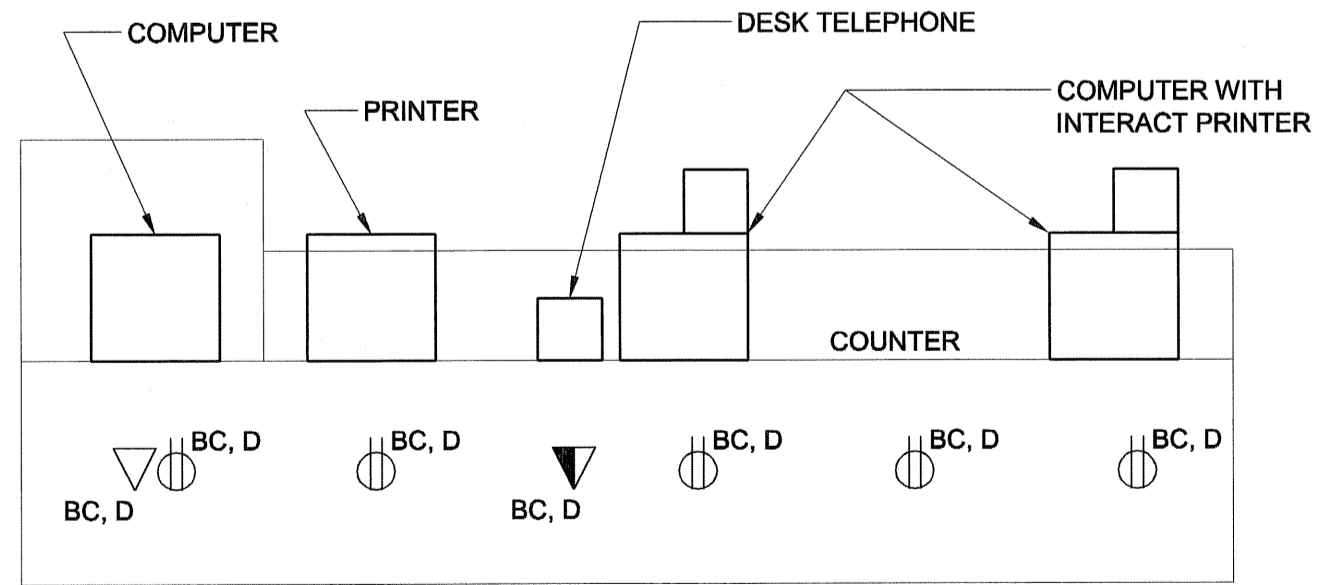

**ELEVATION 4**  
 SCALE: N.T.S.  
 DEMOLITION  
 FRONT DESK VIEW FROM BEHIND

NOTE: ELEVATION IS SCHEMATIC ONLY TO ILLUSTRATE SCOPE OF WORK, ALL SERVICES ARE TO BE DEMOLISHED.

NOTE: ELEVATION IS SCHEMATIC ONLY TO ILLUSTRATE SCOPE OF WORK, ALL SERVICES ARE TO BE DEMOLISHED.

UMA | AECOM

© 2007 UMA ENGINEERING LTD. ALL RIGHTS RESERVED.

**APEN**  
 Certificate of Authorization  
 UMA Engineering Ltd. (MB)  
 No. 256 Date: July 30, 2007

DRN CHK DES ENG IDR  
 UMA | AECOM REVIEW

1	REVISED AS PER CITY REVIEW	QL	07/07/30
0	ISSUED FOR TENDER	QL	07/07/23

NO.	REVISION/DESCRIPTION	BY	DATE

**SEALS**

PROVINCE OF MANITOBA  
 S.K. SMART  
 Member  
 20996  
 July 30, 2007  
 REGISTERED PROFESSIONAL ENGINEER

DRAWN BY: [Signature] CHECKED BY: [Signature] APPROVED: [Signature]  
 DATE: 2007/02/21 USER APPROVAL

CITY OF WINNIPEG  
 PLANNING, PROPERTY & DEVELOPMENT DEPARTMENT  
 CIVIC ACCOMMODATIONS DIVISION  
 300 - 65 GARRY ST. R3C 4K4

PROJECT  
 Construction of Cindy Klassen  
 Recreation Complex Facility  
 Enhancement Project  
 999 Sargent St, Winnipeg, Manitoba

SHEET TITLE  
 Electrical  
 Main Floor  
 Demolition and Existing Services

SCALE 1:200	PROJECT NO. 2005-059	SHEET NO. E12
----------------	-------------------------	------------------

DRAWING SHEET SIZE: A1 (841mm x 594mm) PLOT 1:1