

SEWER JUNCTION INFORMATION FROM SEWER VIDEO INSPECTION SEWER ID S-MA50015621

DISTANCE FROM MH ID S-MH50012509

Distance	W	Size	Direction	Material
20.1	W	150	SOUTH	JX
29.3	W	150	NORTH	CX
32.9	W	150	SOUTH	CN
38.6	W	150	NORTH	CX
48.7	W	150	SOUTH	JX
54.3	W	150	NORTH	JX
65.7	W	150	SOUTH	CX
64.4	W	150	NORTH	CN
65.3	W	150	SOUTH	JN
66.2	W	150	NORTH	JN
77.5	W	150	SOUTH	CN
79.3	W	150	NORTH	CN
80.1	W	150	SOUTH	CN
92.2	W	150	NORTH	JN
93.1	W	150	SOUTH	JN
107.9	W	150	NORTH	JN
108.7	W	150	SOUTH	CN
119.9	W	150	SOUTH	CN
119.9	W	150	NORTH	CX
135.6	W	150	SOUTH	CN
136.7	W	150	SOUTH	CN

NOTE: CHAINAGES SHOWN ARE ALONG N. \perp OF BLENHEIM AVE.

SEWER SERVICE INFORMATION

ADDRESS	SIZE	E DIST	JUNCTION TIE
111 BLENHEIM AVE	RESIDENTIAL	6.26 E OF WL	8.45 W 1ST MH E DES MEURONS
112 BLENHEIM AVE	RESIDENTIAL	5.50 E OF WL	7.32 W 1ST MH E DES MEURONS
115 BLENHEIM AVE	RESIDENTIAL	-	NO INFORMATION AVAILABLE
116 BLENHEIM AVE	RESIDENTIAL	-	NO INFORMATION AVAILABLE
119 BLENHEIM AVE	RESIDENTIAL	-	NO INFORMATION AVAILABLE
120 BLENHEIM AVE	RESIDENTIAL	-	NO INFORMATION AVAILABLE
123 BLENHEIM AVE	RESIDENTIAL	-	NO INFORMATION AVAILABLE
124 BLENHEIM AVE	RESIDENTIAL	-	NO INFORMATION AVAILABLE
127 BLENHEIM AVE	RESIDENTIAL	-	NO INFORMATION AVAILABLE
128 BLENHEIM AVE	RESIDENTIAL	-	NO INFORMATION AVAILABLE
131 BLENHEIM AVE	RESIDENTIAL	-	NO INFORMATION AVAILABLE
132 BLENHEIM AVE	RESIDENTIAL	-	NO INFORMATION AVAILABLE
135 BLENHEIM AVE	RESIDENTIAL	-	NO INFORMATION AVAILABLE
136 BLENHEIM AVE	RESIDENTIAL	-	NO INFORMATION AVAILABLE
137 BLENHEIM AVE	RESIDENTIAL	-	NO INFORMATION AVAILABLE
140 BLENHEIM AVE	RESIDENTIAL	-	NO INFORMATION AVAILABLE
141 BLENHEIM AVE	RESIDENTIAL	-	NO INFORMATION AVAILABLE
144 BLENHEIM AVE	RESIDENTIAL	-	NO INFORMATION AVAILABLE
145 BLENHEIM AVE	RESIDENTIAL	-	NO INFORMATION AVAILABLE
148 BLENHEIM AVE	RESIDENTIAL	-	NO INFORMATION AVAILABLE

BLENHEIM AVENUE

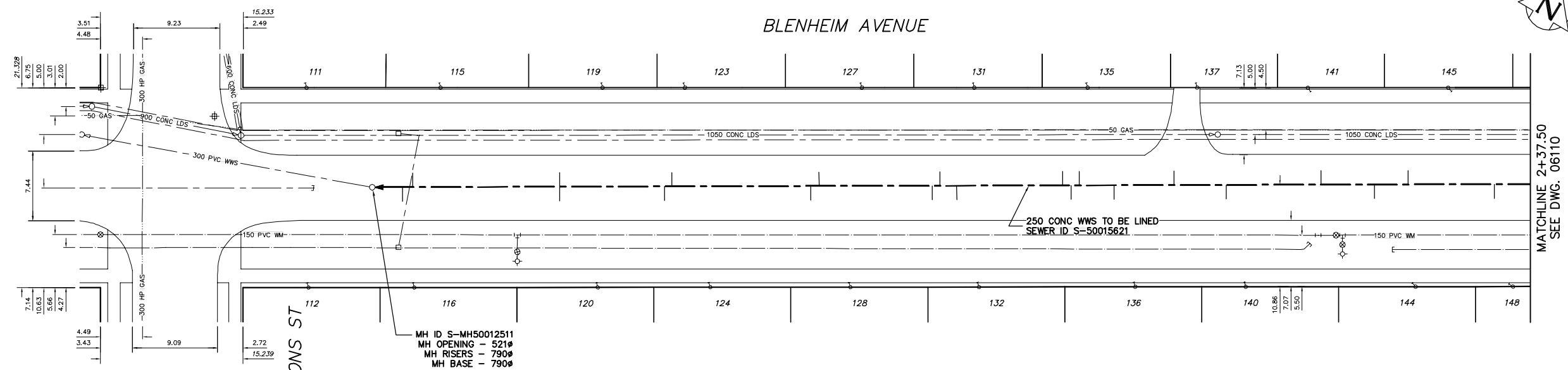

METRIC
WHOLE NUMBERS INDICATE MILLIMETRES
DECIMALIZED NUMBERS INDICATE METRES

WARNING
IF POWER EQUIPMENT OR EXPLOSIVES ARE TO BE USED FOR EXCAVATION ON THIS PROJECT THE CONTRACTOR MUST:
1) NOTIFY THE GAS COMPANY OF THE PROPOSED LOCATION OF EXCAVATION
2) TAKE PRECAUTION TO AVOID DAMAGE TO GAS COMPANY INSTALLATIONS.
SEE PROVINCIAL REGULATION 210/72 FOR DETAILS

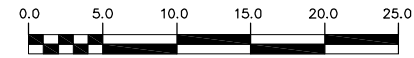

EXISTING	LEGEND-PLAN	PROPOSED	EXISTING	LEGEND-PLAN	PROPOSED	EXISTING	LEGEND-PROFILE	PROPOSED
200 WM	WATERMAIN	200 WM	SL, HYDRO	SL, HYDRO	150 WM	WATERMAIN	150 WM	
⊕	HYDRANT	⊕	MTS	MTS	+	HYDRANT	+	
⊙	VALVE	⊙	TRAFFIC SIGNALS	TRAFFIC SIGNALS	X	VALVE	X	
525 LDS	LAND DRAINAGE SEWER	525 LDS	GAS	GAS	300 LDS	LAND DRAINAGE SEWER	300 LDS	
375 WWS	WASTEWATER SEWER	375 WWS	SURVEY BAR	SURVEY BAR	250 WWS	WASTEWATER SEWER	250 WWS	
○	MANHOLE	●	FENCE	FENCE	⊕	PROFILE	⊕	
□	CATCH BASIN	■	POLE - HYDRO, MTS	POLE - HYDRO, MTS		GROUND ABOVE PIPE		
▽	CURB INLET	▽	CURB STOP	CURB STOP	●			
+	JUNCTIONS	+	GUY ANCHOR	GUY ANCHOR				
—	CULVERT	—	LIGHT STANDARD	LIGHT STANDARD				
⊕	ANODE	⊕	TREE	TREE				

LOCATION APPROVED UNDERGROUND STRUCTURES

SUPV. U/G STRUCTURES COMMITTEE DATE

NOTE:
LOCATION OF UNDERGROUND STRUCTURES AS SHOWN ARE BASED ON THE BEST INFORMATION AVAILABLE BUT NO GUARANTEE IS GIVEN THAT ALL EXISTING UTILITIES ARE SHOWN OR THAT THE GIVEN LOCATIONS ARE EXACT. CONFIRMATION OF EXISTENCE AND EXACT LOCATION OF ALL SERVICES MUST BE OBTAINED FROM THE INDIVIDUAL UTILITIES BEFORE PROCEEDING WITH CONSTRUCTION.

NO.	REVISIONS	DATE	BY

CITY OF WINNIPEG
WATER AND WASTE
ENGINEERING DIVISION

DESIGNED BY: SC
CHECKED BY: TW
DRAWN BY: CJH
APPROVED BY: KZ
HOR. SCALE: 1:250
VERTICAL SCALE: 1:50
DATE: 2007 07 19

ENGINEER'S SEAL
ORIGINAL SIGNED BY
S.R.J. COURNOYER
07/07/23

THE CITY OF WINNIPEG
WATER AND WASTE DEPARTMENT

2007 SEWER RENEWALS
BY CIPP LINING CONTRACT 21
BLENHEIM AVENUE
1ST MH W OF EGERTON ROAD TO
1ST MH E OF DES MEURONS STREET

SHEET 7 OF 25
CITY DRAWING NUMBER
06109