

SEWER JUNCTION INFORMATION FROM SEWER VIDEO INSPECTION SEWER ID S-MA50015622

DISTANCE FROM MH ID S-MH50012508			
1.3	W	150#	SOUTH CXI
1.8	W	150#	NORTH CX
2.1	W	150#	NORTH CN
10.9	W	150#	NORTH CNI
12.9	W	150#	SOUTH CNI
25.9	W	150#	SOUTH CN
39.5	W	150#	NORTH JN
44.1	W	150#	SOUTH JN
56.9	W	150#	NORTH CXI
57.0	W	150#	SOUTH JX
66.2	W	150#	NORTH JN
73.5	W	150#	SOUTH JX
79.1	W	150#	NORTH CX
86.5	W	150#	SOUTH JN
91.1	W	150#	NORTH JN
101.6	W	150#	SOUTH CX
107.6	W	150#	NORTH CX

SEWER JUNCTION INFORMATION FROM SEWER VIDEO INSPECTION SEWER ID S-MA50015621

DISTANCE FROM MH ID S-MH50012509			
2.5	W	150#	SOUTH CNI
8.1	W	150#	NORTH JX

NOTE: CHAINAGES SHOWN ARE ALONG N. P. OF BLENHEIM AVE.

SEWER SERVICE INFORMATION

ADDRESS	SIZE	R. DIST	JUNCTION TIE
148 BLENHEIM AVE			NO INFORMATION AVAILABLE
RESIDENTIAL			-
149 BLENHEIM AVE			NO INFORMATION AVAILABLE
RESIDENTIAL			-
152 BLENHEIM AVE			NO INFORMATION AVAILABLE
RESIDENTIAL			-
153 BLENHEIM AVE			NO INFORMATION AVAILABLE
RESIDENTIAL			-
156 BLENHEIM AVE			NO INFORMATION AVAILABLE
RESIDENTIAL			-
157 BLENHEIM AVE			NO INFORMATION AVAILABLE
RESIDENTIAL			-
158 BLENHEIM AVE			NO INFORMATION AVAILABLE
RESIDENTIAL			-
159 BLENHEIM AVE			NO INFORMATION AVAILABLE
RESIDENTIAL			-
162 BLENHEIM AVE			NO INFORMATION AVAILABLE
RESIDENTIAL			-
163 BLENHEIM AVE			NO INFORMATION AVAILABLE
RESIDENTIAL			-
166 BLENHEIM AVE			NO INFORMATION AVAILABLE
RESIDENTIAL			-
170 BLENHEIM AVE			NO INFORMATION AVAILABLE
RESIDENTIAL			-
174 BLENHEIM AVE			NO INFORMATION AVAILABLE
RESIDENTIAL			-
178 BLENHEIM AVE			NO INFORMATION AVAILABLE
RESIDENTIAL			-
182 BLENHEIM AVE			NO INFORMATION AVAILABLE
RESIDENTIAL			-
148 EGERTON RD			NO INFORMATION AVAILABLE
RESIDENTIAL			-
149 EGERTON RD			8.29 E OF WL (SERV. OFF BLENHEIM)
RESIDENTIAL			1.36 W 1ST MH E EGERTON

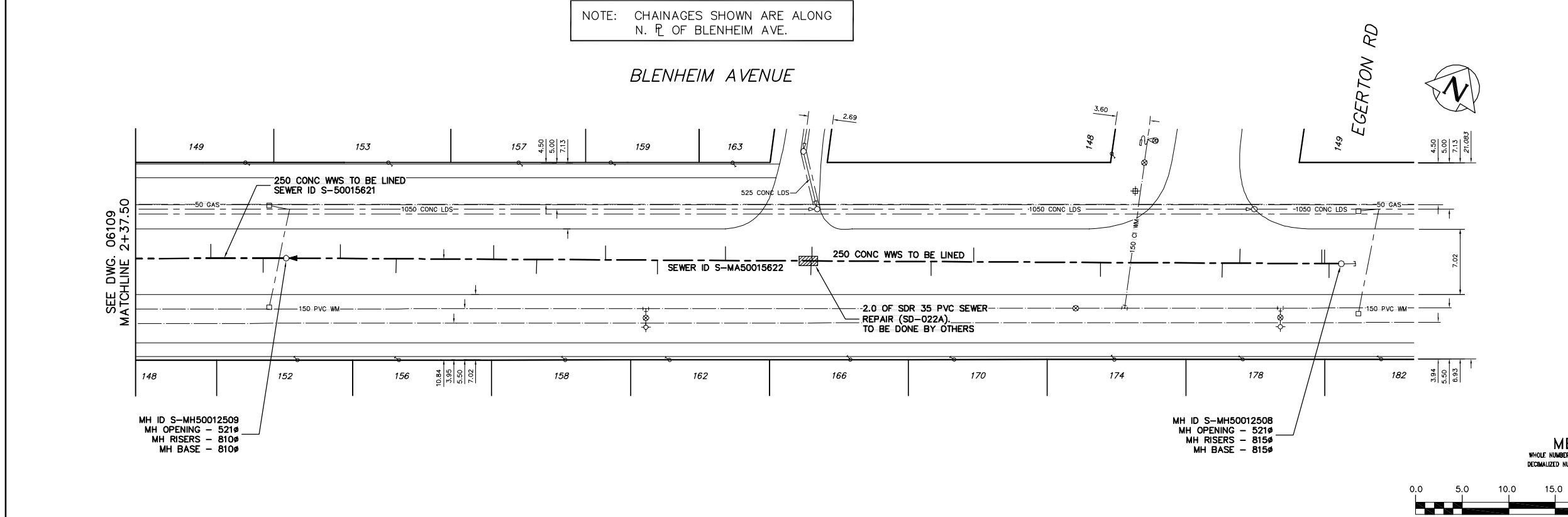

METRIC
WHOLE NUMBERS INDICATE MILLIMETRES
DECIMALIZED NUMBERS INDICATE METRES



WARNING
IF POWER EQUIPMENT OR EXPLOSIVES ARE TO BE USED FOR EXCAVATION ON THIS PROJECT THE CONTRACTOR MUST:
1) NOTIFY THE GAS COMPANY OF THE PROPOSED LOCATION OF EXCAVATION.
2) TAKE PRECAUTION TO AVOID DAMAGE TO GAS COMPANY INSTALLATIONS.
SEE PROVINCIAL REGULATION 210/72 FOR DETAILS

EXISTING	LEGEND-PLAN	PROPOSED	EXISTING	LEGEND-PLAN	PROPOSED	EXISTING	LEGEND-PROFILE	PROPOSED
200 WM	WATERMAIN	200 WM	SL, HYDRO	150 WM	WATERMAIN	150 WM		
⊕	HYDRANT	⊕	MTS	+	HYDRANT	+		
⊙	VALVE	⊙	TRAFFIC SIGNALS	X	VALVE	X		
525 LDS	LAND DRAINAGE SEWER	525 LDS	GAS	50 GAS	300 LDS	LAND DRAINAGE SEWER	300 LDS	
375 WWS	WASTEWATER SEWER	375 WWS	SURVEY BAR	250 WWS	WASTEWATER SEWER	250 WWS		
○	MANHOLE	●	FENCE	⊕	PROFILE	⊕		
□	CATCH BASIN	■	POLE - HYDRO, MTS	⊕	GROUND ABOVE PIPE	⊕		
▽	CURB INLET	▽	CURB STOP	⊕				
+	JUNCTIONS	+	GUY ANCHOR	⊕				
—	CULVERT	—	LIGHT STANDARD	⊕				
⊕	ANODE	⊕	TREE	⊕				

LOCATION APPROVED UNDERGROUND STRUCTURES

SUPV. U/G STRUCTURES COMMITTEE DATE

NOTE:
LOCATION OF UNDERGROUND STRUCTURES AS SHOWN ARE BASED ON THE BEST INFORMATION AVAILABLE BUT NO GUARANTEE IS GIVEN THAT ALL EXISTING UTILITIES ARE SHOWN OR THAT THE GIVEN LOCATIONS ARE EXACT. CONFIRMATION OF EXISTENCE AND EXACT LOCATION OF ALL SERVICES MUST BE OBTAINED FROM THE INDIVIDUAL UTILITIES BEFORE PROCEEDING WITH CONSTRUCTION.

NO.	REVISIONS	DATE	BY

CITY OF WINNIPEG WATER AND WASTE ENGINEERING DIVISION

DESIGNED BY: SC
DRAWN BY: C/JH
HOR. SCALE: 1:250
VERTICAL: 1:50

CHECKED BY: TW
APPROVED BY: KZ
RELEASED FOR CONSTRUCTION

DATE: 2007 07 19

ENGINEER'S SEAL

ORIGINAL SIGNED BY
S.R.J. COURNOYER
07/07/23

BD OPPORTUNITY: 529-2007
FILENAME: 06108_9_10.dwg
PLOT DATE: 2007 07 19

THE CITY OF WINNIPEG
WATER AND WASTE DEPARTMENT

2007 SEWER RENEWALS
BY CIPP LINING CONTRACT 21
BLENHEIM AVENUE
MH AT E P EGERTON ROAD TO
1ST MH W OF EGERTON ROAD

SHEET 8 OF 25
CITY DRAWING NUMBER
06110