

D SIZE 22" x 34" (559mm x 864mm)

PLOT: 07/07/20 4:46:40 PM

UMA AECOM REVIEW DRAFT CHK MA  
 UMA FILE NAME: D265-217-01\_00-C-1006\_RX.dwg Saved By: kberard

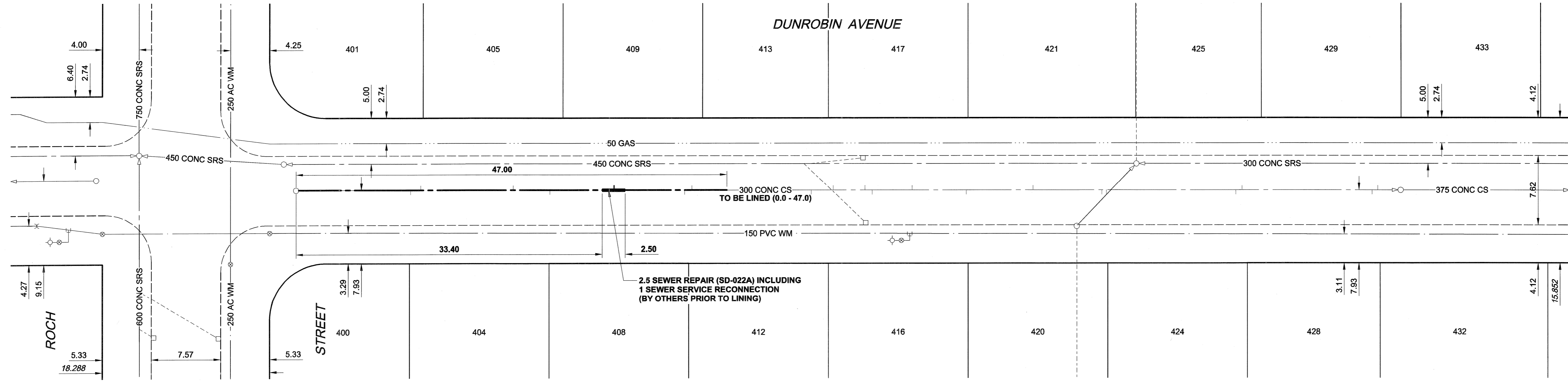
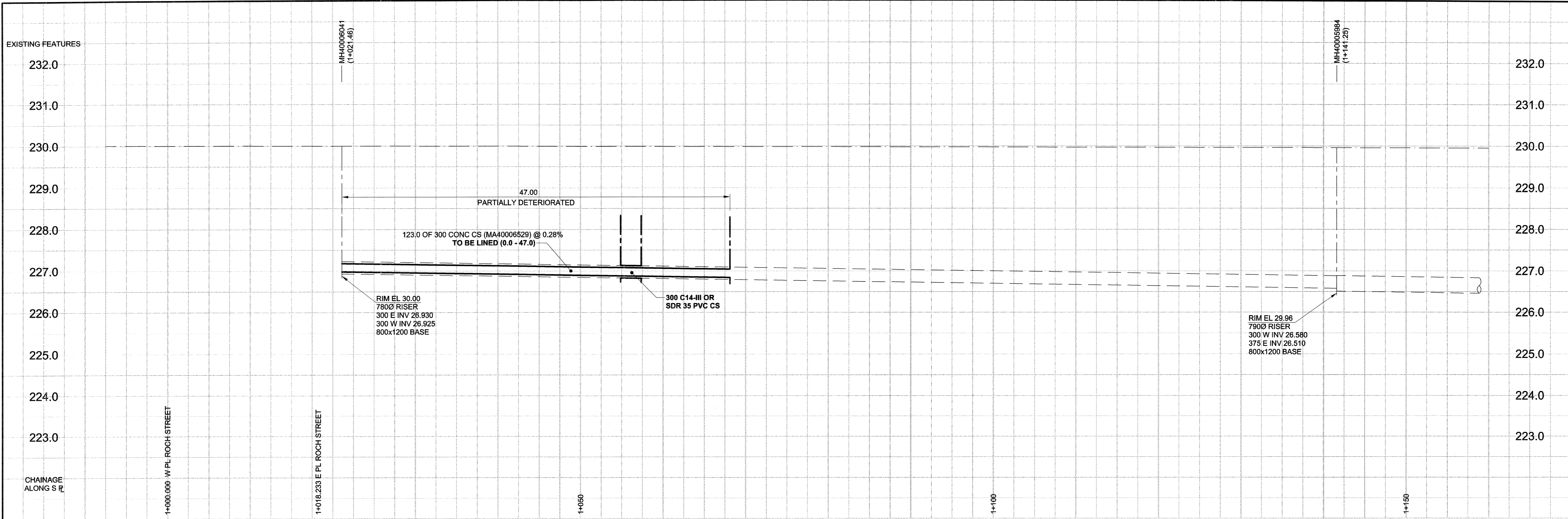

**SEWER JUNCTION INFORMATION**

REF. MH*	DIST FROM REF. MH	SIZE	CLOCK AT*
MH40006041	12.80	1500	02
MH40006041	13.60	1500	10
MH40006041	23.70	1500	10
MH40006041	27.70	1500	02
MH40006041	34.70	1500	10
MH40006041	42.40	1500	02
MH40006041	43.20	1500	10
MH40006041	56.20	1500	02
MH40006041	58.60	1500	10
MH40006041	61.70	1500	10
MH40006041	62.50	1500	02
MH40006041	67.20	1500	09
MH40006041	73.10	1500	02
MH40006041	80.40	1500	10
MH40006041	87.90	1500	02
MH40006041	88.40	1500	02
MH40006041	102.50	1500	02
MH40006041	103.20	1500	09
MH40006041	117.40	1500	02
MH40006041	118.00	1500	10

\*JUNCTION INFORMATION FROM VIDEO INSPECTION

**APEGN**  
 Certificate of Authorization  
 UMA Engineering Ltd. (MB)  
 No. 256 Date: 07/07/21

BID OPPORTUNITY NO. 545-2007

EXISTING	LEGEND - PLAN	NEW	EXISTING	LEGEND - PLAN	NEW	EXISTING	LEGEND - PROFILE	NEW
150 WM	WATERMAIN	150 WM	CURB STOP	150 WM	WATERMAIN	150 WM	WATERMAIN	150 WM
Hydrant	HYDRANT	Hydrant	REDUCER	Hydrant	HYDRANT	Hydrant	HYDRANT	Hydrant
Valve	VALVE	Valve	COUPLING	Valve	VALVE	Valve	VALVE	Valve
300 LDS	LAND DRAINAGE SEWER	300 LDS	ANODE	300 LDS	LAND DRAINAGE SEWER	300 LDS	LAND DRAINAGE SEWER	300 LDS
250 WWS	WASTE WATER SEWER	250 WWS	HYDRO	250 WWS	WASTE WATER SEWER	250 WWS	WASTE WATER SEWER	250 WWS
Manhole	MANHOLE	Manhole	MTS	Manhole	MANHOLE	Manhole	MANHOLE	Manhole
Catch Basin	CATCH BASIN	Catch Basin	GAS	Catch Basin	CATCH BASIN	Catch Basin	CATCH BASIN	Catch Basin
Curb Inlet	CURB INLET	Curb Inlet	TESTHOLE	Curb Inlet	CURB INLET	Curb Inlet	CURB INLET	Curb Inlet
Culvert	CULVERT	Culvert	LAMP STANDARD	Culvert	CULVERT	Culvert	CULVERT	Culvert
Pipe Abandonments	PIPE ABANDONMENTS	Pipe Abandonments	TREE	Pipe Abandonments	PIPE ABANDONMENTS	Pipe Abandonments	PIPE ABANDONMENTS	Pipe Abandonments
Survey Bar	SURVEY BAR	Survey Bar		Survey Bar	SURVEY BAR	Survey Bar	SURVEY BAR	Survey Bar

**LOCATION APPROVED**  
 UNDERGROUND STRUCTURES

DATE COMMITTEE

NOTE:  
 LOCATION OF UNDERGROUND STRUCTURES AS SHOWN ARE BASED ON THE BEST INFORMATION AVAILABLE. BUT NO GUARANTEE IS GIVEN THAT ALL EXISTING UTILITIES ARE SHOWN OR THAT THE GIVEN LOCATIONS ARE EXACT. CONFIRMATION OF EXISTENCE AND EXACT LOCATION OF ALL SERVICES MUST BE OBTAINED FROM THE INDIVIDUAL UTILITIES BEFORE PROCEEDING WITH CONSTRUCTION.

NO.	REVISIONS	YY/MM/DD	BY
0	ISSUED FOR CONSTRUCTION	07/07/20	KMB

DESIGNED BY	CHECKED BY
MJR	A. Deland
DRAWN BY	APPROVED BY
KMB	[Signature]
HOR. SCALE	RELEASED FOR CONSTRUCTION
1:250	[Signature]
VERT. SCALE	DATE
1:50	07/07/21

PROFESSIONAL'S SEAL  
 PROVINCE OF MANITOBA  
 21 July 2021  
 C. C. MACEY  
 REGISTERED ENGINEER  
 CONSULTANT DRAWING NO. 06  
 D265-217-01

**THE CITY OF WINNIPEG**  
 WATER AND WASTE DEPARTMENT

**2007 COMBINED SEWER RENEWALS**  
 BY CIPP LINING  
 CONTRACT 20  
 DUNROBIN AVENUE  
 MH AT ROCH STREET (EPL)  
 TO 1ST MH E OF ROCH STREET

SHEET 6 OF 11  
 CITY DRAWING NUMBER  
**06098**  
 REV 0