

PRESENTATION OF PROPOSED STAGE 2 DETOUR OPERATION
(SPRING 2009 – FALL 2009)
EASTBOUND BRIDGE CLOSED

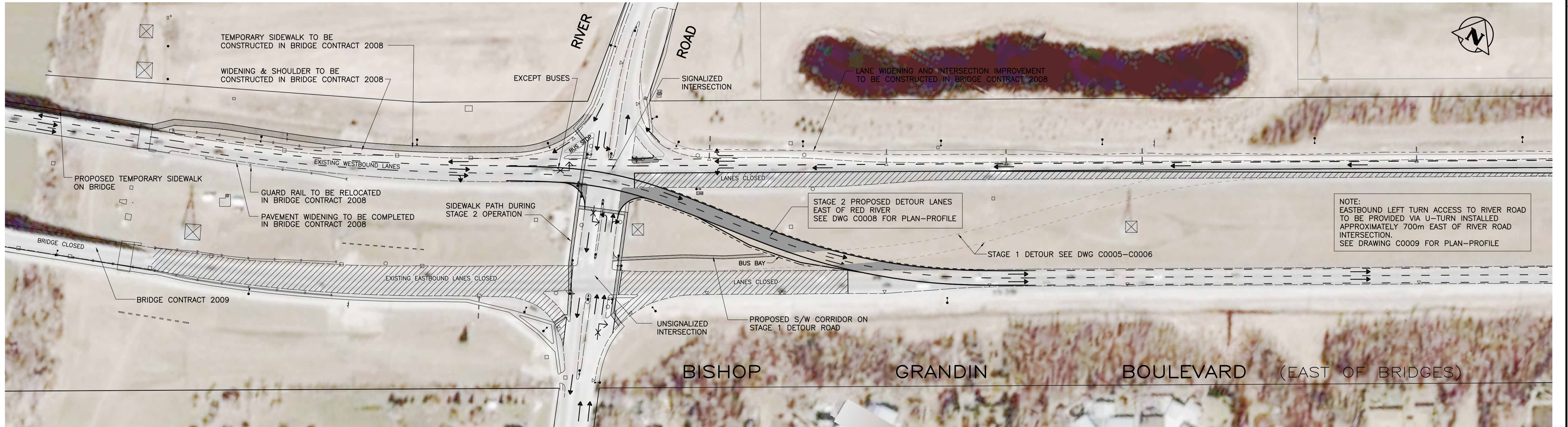

- LEGEND:**
- TRAFFIC MOVEMENT PROHIBITED
 - TRAFFIC MOVEMENT ALLOWED
 - NEW PAVEMENT FOR DETOUR ROADWAYS
 - EXISTING ROADWAYS AND SIDEWALKS CLOSED DURING CONSTRUCTION

AERIAL PHOTO BACKGROUND IS FOR PRESENTATION PURPOSES ONLY AND IS NOT FULLY ORTHORECTIFIED. DIRECTIONS, DISTANCES, AND/OR ALIGNMENTS SHOULD NOT BE PERFORMED OR INFERRED FROM THE PHOTOGRAPH.

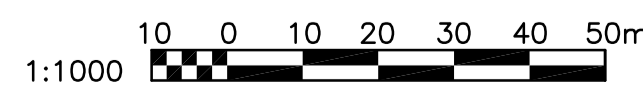

APEGM
Certificate of Authorization
Wardrop Engineering Inc.
No. 195 Expiry: April 30, 2008

B.M. ELEV.	F.B. 2153
DESIGNED BY	DAL
CHECKED BY	[Signature]
DRAWN BY	NL
APPROVED BY	[Signature]
HOR. SCALE:	1 : 1000
VERTICAL:	
RELEASED FOR CONSTRUCTION	
CONSULTANT DRAWING NO.	0600070700-DWG-C1002-00

WARDROP Engineering Inc.

DESIGNED BY DAL

CHECKED BY [Signature]

DRAWN BY NL

APPROVED BY [Signature]

HOR. SCALE: 1 : 1000

VERTICAL:

RELEASED FOR CONSTRUCTION

CONSULTANT DRAWING NO. 0600070700-DWG-C1002-00

PRELIMINARY DRAWING

NOT TO BE USED FOR CONSTRUCTION

THE CITY OF WINNIPEG
PUBLIC WORKS DEPARTMENT
ENGINEERING DIVISION

FORT GARRY BRIDGE REHABILITATION

STAGE 2 (2009 PROPOSED OPERATION)
PROPOSED DETOUR LANES
OVERALL PLAN SHOWING TRAFFIC MOVEMENTS

CITY DRAWING NUMBER

SHEET **2** OF **9**

C0002