

STAGE 1 PROPOSED DETOUR
Aligned with Bishop Grandin Boulevard
Detour Road Control Line = S Lane Edge

Control Point	Station	Coordinate		Curve Data				Spiral Data		
		Northing	Easting	Parameter	C5	C6	Parameter	S4-S5	S6-S7	
TS	20+31.97	296.712	2048.266	R	295.00	298.70	R	295.00	298.70	
SC	20+73.47	294.927	2089.719	Δ	13°28'25"	5°34'00"	L	41.50	41.50	
STA	20+90.34	292.932	2106.467	Tan	34.85	14.52	Theta	4°01'48"	3°58'49"	
CS	21+42.84	280.667	2157.446	L	69.37	29.02	P	0.24	0.24	
ST	21+84.34	265.586	2196.099				K	20.75	20.75	
TS	21+99.55	259.727	2210.135				A	110.65	111.34	
SC	22+41.05	244.635	2248.784							
CS	22+44.42	242.362	2255.793							
STA	22+70.07	236.691	2276.884							
ST	23+11.57	229.161	2317.486							

Coordinate Control Survey Monuments

No.	Wardrop Coordinate		NAD 83 Grid Coordinate		Description
	Northing	Easting	Northing	Easting	
CP1	200.457	2451.508	5520387.9452	633474.1394	GBM 76-026
CP2	143.191	2457.394	5520340.9993	633507.4585	BRASS CAP
CP3	324.616	2489.426	5520514.6806	633446.0101	BRASS CAP

CSP LAYOUT COORDINATE

	Northing	Easting
PT5	285.871	2131.133
PT6	284.507	2171.110
PT7	266.868	2219.053
PT8	266.868	2219.053

NOTE: WHERE 2 CSPs SIDE BY SIDE THE COORDINATE REPRESENTS THE CENTRE.

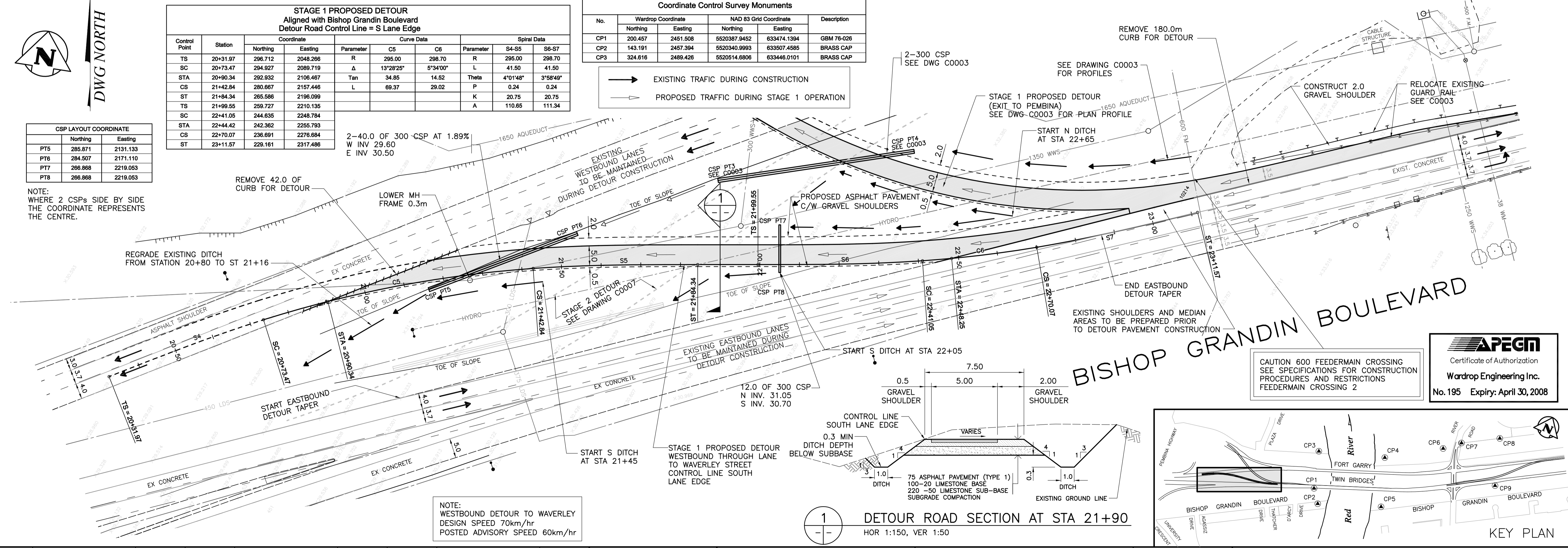

CAUTION 600 FEEDERMAIN CROSSING SEE SPECIFICATIONS FOR CONSTRUCTION PROCEDURES AND RESTRICTIONS FEEDERMAIN CROSSING 2

APEGM
Certificate of Authorization
Wardrop Engineering Inc.
No. 195 Expiry: April 30, 2008

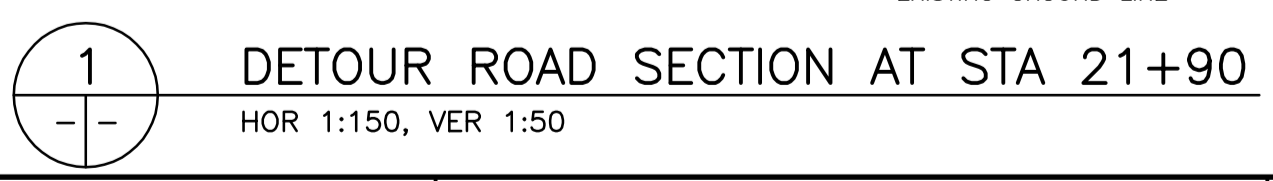
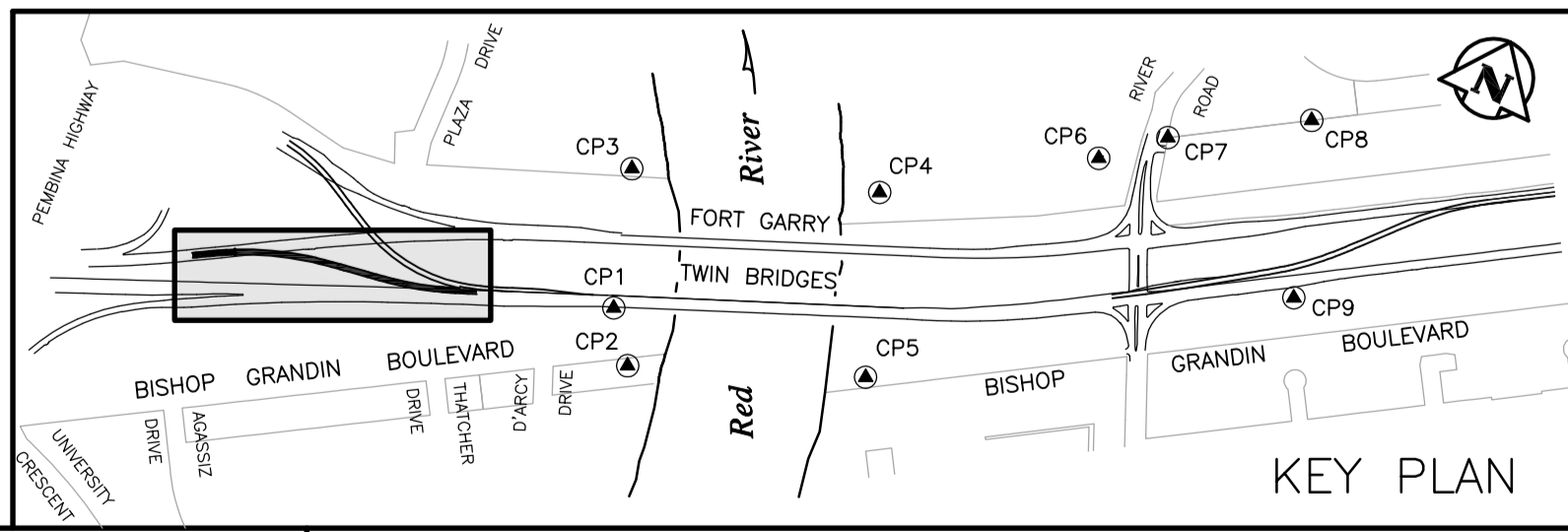

NOTE: WESTBOUND DETOUR TO WAVERLEY DESIGN SPEED 70km/hr POSTED ADVISORY SPEED 60km/hr

EXISTING	LEGEND-PLAN	PROPOSED	EXISTING	LEGEND-PLAN	PROPOSED	EXISTING	LEGEND-PLAN	PROPOSED
150 WM	WATERMAIN	150 WM	PLUG	TRAFFIC SIGNAL		B.M. ELEV.		F.B.
400 FM	FEEDERMAIN	400 FM	MANHOLE	GAS				
300 LDS	LAND DRAINAGE SEWER	300 LDS	CATCHBASIN	HYDRO				
250 WWS	WASTEWATER SEWER	250 WWS	CURB INLET	MTS				
300 CS	COMBINED SEWER	300 CS	HYDRO POLE	ELEVATION	(32.000)			
200 FCM	FORCEMAIN	200 FCM	LIGHT STANDARD	SIDEWALK				
	JUNCTIONS		ANCHOR	CURB				
	HYDRANT		TREE	ASPHALT				
	VALVE		LEGAL DIMENSION	CONCRETE				
	CURB STOP		SURVEY BAR					
	LEGEND-PLAN	PROPOSED	LEGEND-PLAN	PROPOSED	EXISTING			

LOCATION APPROVED UNDERGROUND STRUCTURES

SUPV. U/G STRUCTURES COMMITTEE DATE

NOTE: LOCATION OF UNDERGROUND STRUCTURES AS SHOWN ARE BASED ON THE BEST INFORMATION AVAILABLE. BUT NO GUARANTEE IS GIVEN THAT ALL EXISTING UTILITIES ARE SHOWN OR THAT THE GIVEN LOCATIONS ARE EXACT. CONFIRMATION OF EXISTENCE AND EXACT LOCATION OF ALL SERVICES MUST BE OBTAINED FROM THE INDIVIDUAL UTILITIES BEFORE PROCEEDING WITH CONSTRUCTION.

NO.	ISSUED FOR TENDER	DATE	NO.	REVISIONS	DATE
0	ISSUED FOR TENDER	07.08.08			

WARDROP Engineering Inc.

DESIGNED BY DAL CHECKED BY [Signature]

DRAWN BY NL APPROVED BY [Signature]

HOR. SCALE: 1 : 500

VERTICAL: 1 : 20

RELEASED FOR CONSTRUCTION

DATE 07.07.02

PRELIMINARY DRAWING

NOT TO BE USED FOR CONSTRUCTION

CONSULTANT DRAWING NO. 0600070700-DWG-C1004-00

THE CITY OF WINNIPEG
PUBLIC WORKS DEPARTMENT
ENGINEERING DIVISION

FORT GARRY BRIDGE REHABILITATION

STAGE 1 DETOUR FOR 2008 OPERATIONS WESTBOUND THROUGH LANE TO WAVERLEY STREET

CITY DRAWING NUMBER SHEET 4 OF 9

C0004