

3 LIGHT DUTY GRANULAR ROAD SECTION
L1 Scale: 1:50

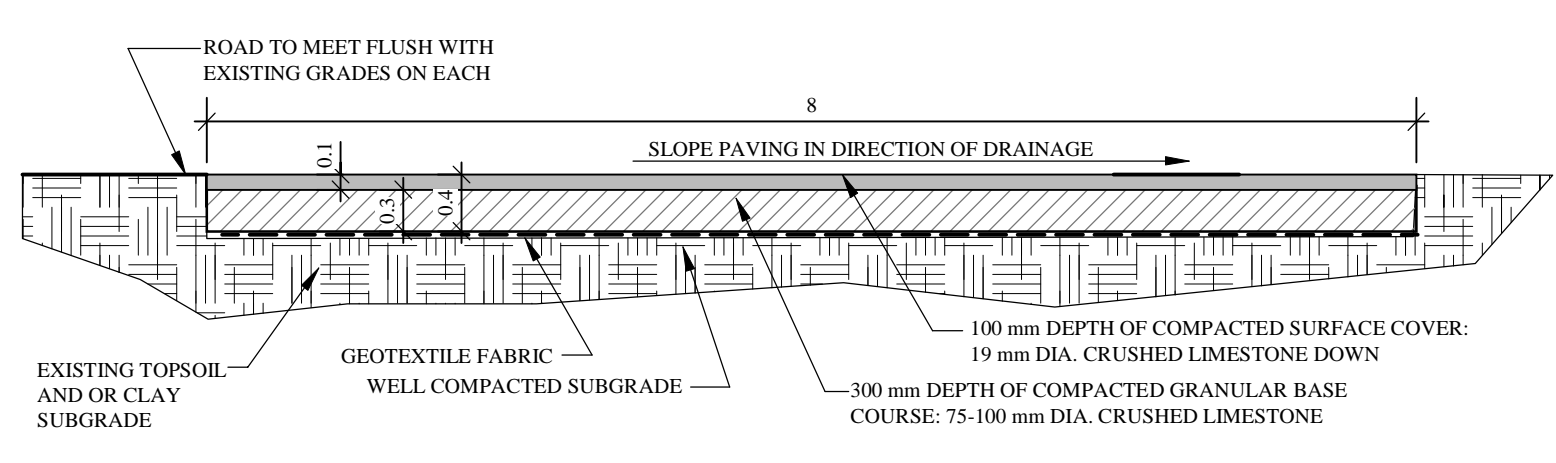

4 HEAVY DUTY GRANULAR ROAD SECTION
L1 Scale: 1:50

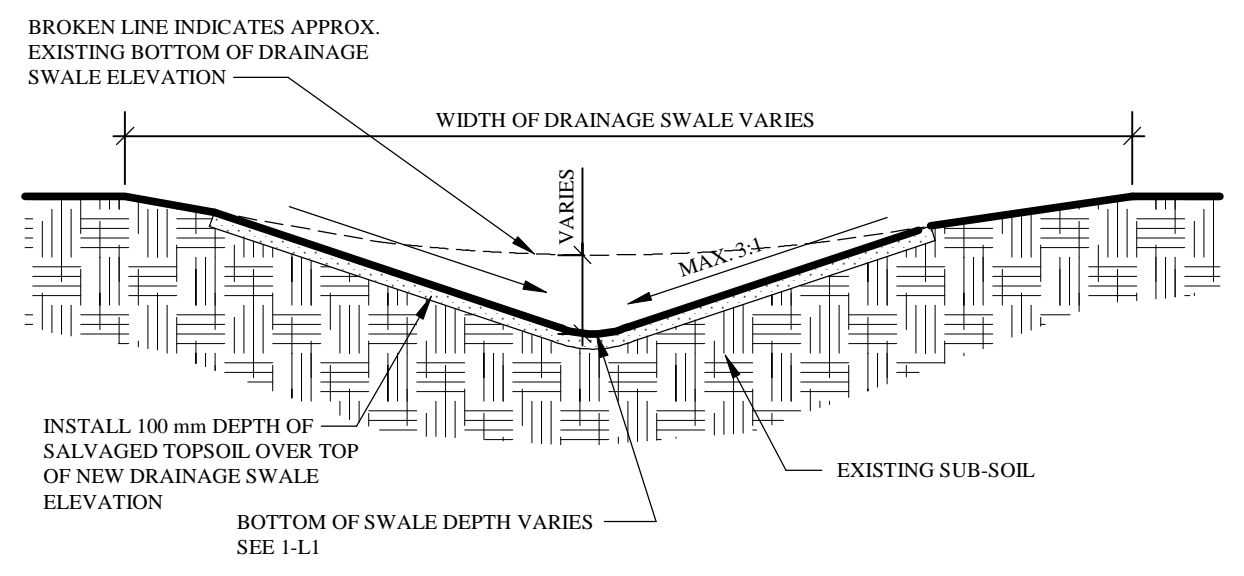

5 SWALE SECTION AT DEEP PART
L1 Scale: 1:50

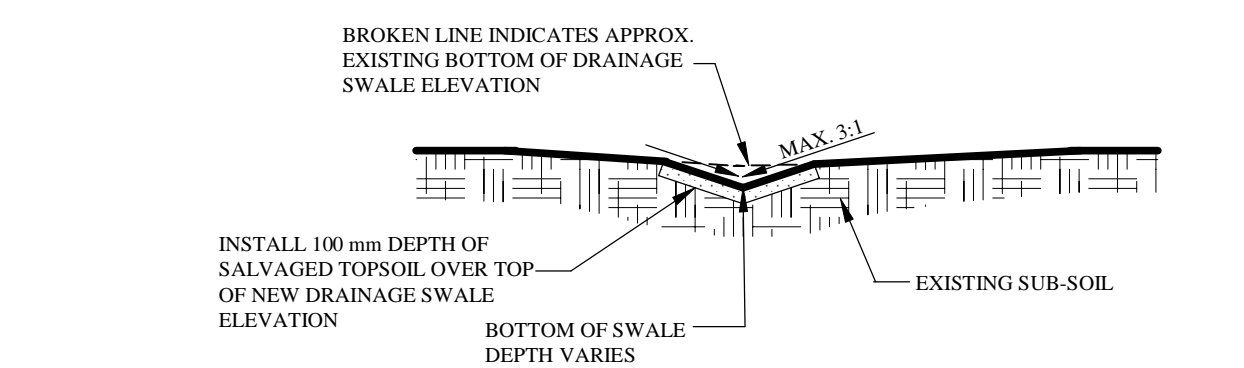

6 SWALE SECTION AT SHALLOW PART
L1 Scale: 1:50

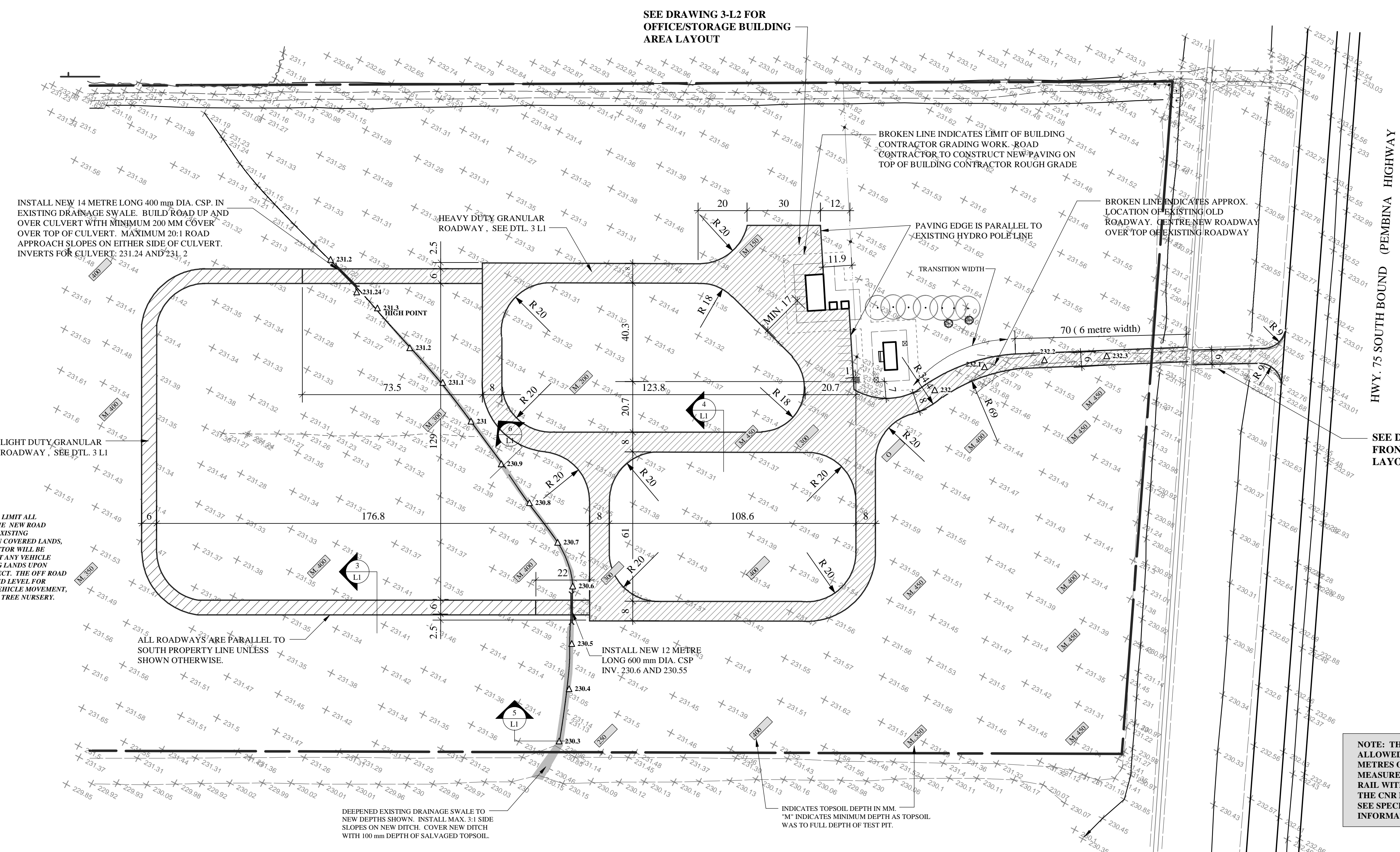

1 NURSERY ROAD LAYOUT
L1 Scale: 1:1000

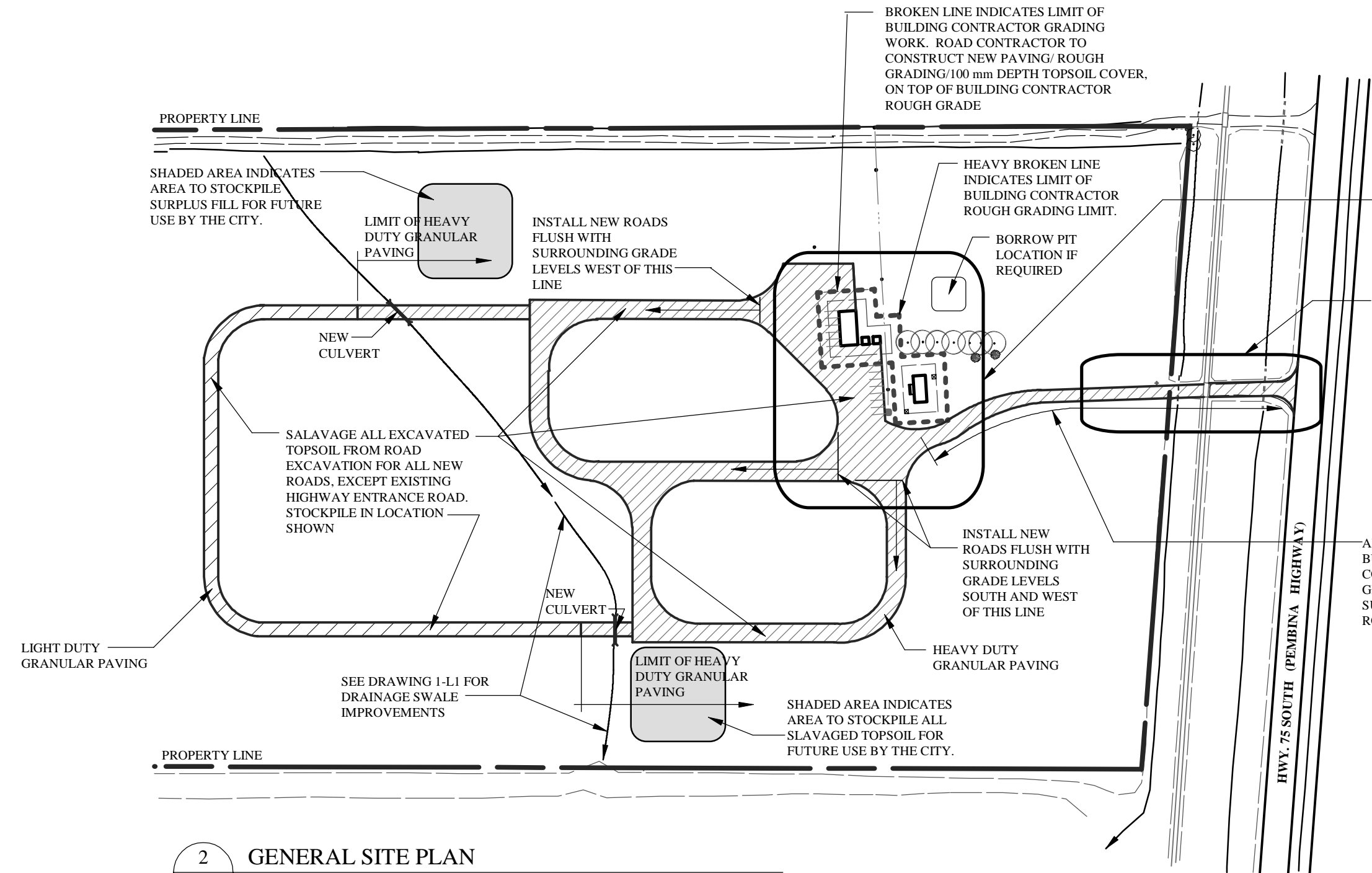

2 GENERAL SITE PLAN
L1 Scale: 1:2000

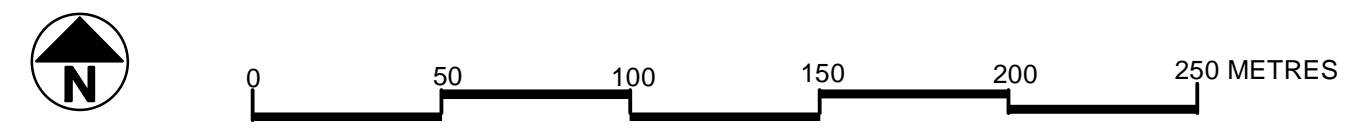

- LEGEND:**
- + 231.42 EXISTING GRADE ELEVATION
 - 232.1 Δ NEW FINISHED GRADE ELEVATION
 - DIRECTION OF DRAINAGE, HORIZ. TO VERTICAL RUN
 - M 30.0 INDICATES APPROX. DEPTH OF EXISTING TOPSOIL. 'M' IN FRONT INDICATES MINIMUM DEPTH AS TOPSOIL WAS EVIDENT TO BOTTOM OF BACKHOLE EXCAVATED PIT.
 - DRAINAGE SWALE AND SIDES TO BE REGRADED
 - HEAVY DUTY GRANULAR PAVING
 - LIGHT DUTY GRANULAR PAVING
- GRADING NOTES:**
- EXISTING GRADE ELEVATIONS ARE BASED ON BARNES & DUNCAN SURVEY UNDERTAKEN IN APRIL OF 2007. LOCAL BENCH MARK IS TOP OF OLD CBC TOWER CONCRETE FOOTING, TOP OF IRON BOLT ON TOP OF CONCRETE FOOTING, ELEV. 232.526 METRES GEODETIC.
 - THE GRAVEL ROADWAYS ARE BEING CONSTRUCTED ON VARIOUS DEPTHS OF EXISTING TOPSOIL. IN SOME CASES THE EXCAVATION FOR THE GRANULAR BASE MAY NOT BE DEEP ENOUGH TO REMOVE ALL THE EXISTING TOPSOIL. IN THESE SITUATIONS THE TOPSOIL IS TO BE THOROUGHLY COMPACTED PRIOR TO PLACING THE GEOTEXTILE LINER AND GRAVEL.
 - ALL EXISTING TOPSOIL IS TO BE REMOVED AND SALVAGED TO THE NEW GRANULAR SUB GRADE DEPTHS AND STOCKPILED ON SITE IN AN AREA DESIGNATED BY THE CONTRACT ADMINISTRATOR. PRIOR TO SALVAGING TOPSOIL CUT ALL EXISTING GRASS DOWN TO 25mm HEIGHT, AND SHEAR OFF TOP 25 MM THICK LAYER. STOCKPILE TRI-CH LAYER IN SURPLUS FILL AREA. ALL EXCAVATED CLAY FILL MAY BE USED FOR BUILDING UP THE BOTH SIDE SLOPES ON THE NEW ENTRANCE ROAD FROM THE HIGHWAY TO A POINT SOUTH OF THE NEW OFFICE BUILDING.
 - ALL FINISH GRADES SHOWN ARE TO TOP OF GRAVEL OR TOPSOIL. THE CONTRACTOR SHALL SEE DRAWING 3 L2 FOR ADDITIONAL GRADING INFORMATION AROUND THE FOUR NEW BUILDINGS. WHERE THE BUILDING CONTRACTOR IS RESPONSIBLE TO ESTABLISH SOME OF THE ROUGH GRADES BEFORE THE ROAD CONTRACTOR COMMENCES HIS WORK. THE ROAD CONTRACTOR WILL BE WORKING OVER TOP OF THE BUILDING CONTRACTORS ROUGH GRADES TO THE LIMITS SHOWN ON DRAWING DETAIL 3 L2.
 - THE EXISTING DIRT MINOR GRAVEL ROADWAY FROM THE HIGHWAY TO A POINT SOUTH OF THE NEW OFFICE BUILDING IS CONTAMINATED SOIL CONSISTING OF SOME TOPSOIL, CLAY, AND GRAVEL. ANY EXCAVATED MATERIAL FROM THIS AREA IS SUITABLE FOR FILL ON THE SIDE ROAD EMBANKMENTS ONLY. STOCKPILE ANY SURPLUS MATERIAL IN AN AREA DESIGNATED BY THE CONTRACT ADMINISTRATOR. NO WORK CAN BE UNDERTAKEN BY THE NEW ROAD APPROACH WITHIN 5 METRES OF EACH SIDE OF THE RAIL LINE, WITHOUT A CNR FLAGMAN IN FULL ATTENDANCE DURING THE WORK.
 - THE REGRADED OF THE EXISTING SWALE/DITCH MAY BE DELETED FROM THE CONTRACT IF MONETARY FUNDS ARE NOT SUFFICIENT TO DO THE WORK. THE LIGHT DUTY GRAVEL PAVED NURSERY FIELD ROAD AT THE WEST END OF THE SITE, MAY ALSO BE DELETED IF FUNDS ARE NOT SUFFICIENT.

PROJECT TITLE	NO.	REVISIONS	BY	DATE
CITY OF WINNIPEG TREE NURSERY				
ST. NORBERT, MANITOBA				
DRAWING TITLE	KEN RECH LANDSCAPE ARCHITECTS INC.			
ROADWAY SITE PLAN	1480 Wellington Crescent Winnipeg, Manitoba			
	Fax 489-6852 R3N 0B3 Tel(204) 489-6616			
DRAWN BY	SCALE	SHEET NO.		
K. Rech	1:1000	L1		
PRINT DATE	DATE			
July 23, 2007	July 23, 2007			
FILE NO	REVISION			
04-06	0			

NOTE: THE CONTRACTOR IS NOT ALLOWED TO WORK WITHIN 5 METRES OF THE RAILWAY LINE, MEASURED FROM EACH OUTSIDE RAIL WITHOUT A FLAGMAN FROM THE CNR IN FULL ATTENDANCE. SEE SPECIFICATION FOR FURTHER INFORMATION.

Ken R. Rech
Member No. 08