

B SIZE 11" x 17" (279mm x 432mm)

PLOT: 07/08/21 2:46:46 PM

UMA FILE NAME: D265-217-03_01-C-1006_RX.dwg Saved By: kberard

SEWER JUNCTION INFORMATION

REF. MH*	DIST FROM* REF. MH	SIZE*	CLOCK AT*
MH40003909	5.20	150Ø	11
MH40003909	6.80	150Ø	10
MH40003909	10.00	150Ø	01
MH40003909	17.70	150Ø	10
MH40003909	19.20	150Ø	01
MH40003909	23.30	150Ø	01
MH40003909	31.80	150Ø	10
MH40003909	38.00	150Ø	01
MH40003909	46.60	150Ø	11
MH40003909	47.30	150Ø	11
MH40003909	51.30	150Ø	01
MH40003909	51.50	150Ø	12
MH40003909	56.60	150Ø	11

SEWER JUNCTION INFORMATION

REF. MH*	DIST FROM* REF. MH	SIZE*	CLOCK AT*
MH40003909	60.60	150Ø	01
MH40003909	62.20	150Ø	11
MH40003909	63.00	150Ø	01
MH40003909	66.90	150Ø	02
MH40003909	68.80	150Ø	01
MH40003909	73.90	150Ø	11
MH40003909	81.00	150Ø	01
MH40003909	81.00	100Ø	01
MH40003909	86.70	150Ø	11
MH40003909	98.40	150Ø	01
MH40003909	110.60	150Ø	01
MH40003909	111.40	150Ø	11

*JUNCTION LOCATION FROM VIDEO INSPECTION

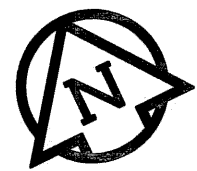
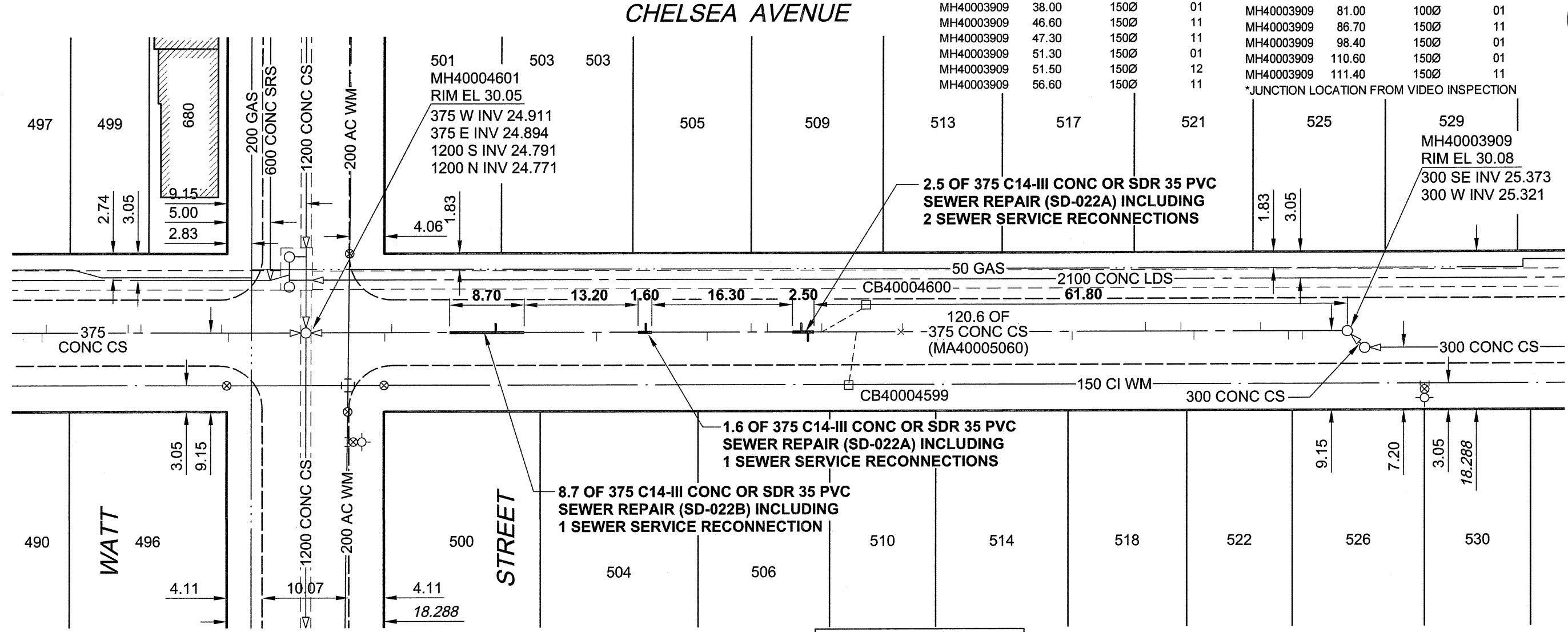

WARNING

IF POWER EQUIPMENT OR EXPLOSIVES ARE TO BE USED FOR EXCAVATION ON THIS PROJECT, THE CONTRACTOR MUST:

- 1) NOTIFY THE GAS COMPANY OF THE PROPOSED LOCATION OF EXCAVATION.
- 2) TAKE PRECAUTION TO AVOID DAMAGE TO GAS COMPANY INSTALLATIONS.

SEE PROVINCIAL REGULATION 140/92 FOR DETAILS

METRIC

WHOLE NUMBERS INDICATE MILLIMETRES
DECIMALIZED NUMBERS INDICATE METRES



Certificate of Authorization
UMA Engineering Ltd. (MB)
No. 256 Date: 07/08/21

CONSTRUCTION NOTES:

1. ALL SEWER AND WATER SERVICES WITHIN THE REPAIR LIMITS TO BE LOCATED IN THE FIELD BY THE CONTRACTOR

BID OPPORTUNITY NO. 573-2007

LOCATION APPROVED UNDERGROUND STRUCTURES

BM 12-062 ELEV 230.128m	N.E. Cor. Watt St. & Kimberley Ave., Tblt. on top of 0.05m dia. x 2.4m iron pipe, 0.3m W. of E.L. of Watt St. & on N.L. of Kimberley Ave.		
NO.	ISSUED FOR CONSTRUCTION	07/08/21	KMB
NO.	REVISIONS	YY/MM/DD	BY

DESIGNED BY MJR		CHECKED BY A. Delano	
DRAWN BY KMB		APPROVED BY Bryan Hildebrand	
HOR. SCALE 1:500		RELEASED FOR CONSTRUCTION	
VERT. SCALE		DATE 07/08/21	

PROFESSIONAL'S SEAL

PROVINCE OF MANITOBA
21 Aug 2007
C.C. MACEY
REGISTERED ENGINEER

CONSULTANT DRAWING NO. 06
D265-217-03

THE CITY OF WINNIPEG
WATER AND WASTE DEPARTMENT

2007 COMBINED SEWER RENEWALS
BY EXTERNAL POINT REPAIRS AND REPLACEMENTS
CONTRACT 15

CHELSEA AVENUE
WATT STREET
TO 217m W OF GOLSPIE STREET

SHEET 6 OF 29
CITY DRAWING NUMBER
06134
REV 0

UMA | AECOM REVIEW | DRFT CHK | AAL