

NOTE: CHAINAGES SHOWN ARE ALONG N P OF ACADEMY RD

ACADEMY ROAD

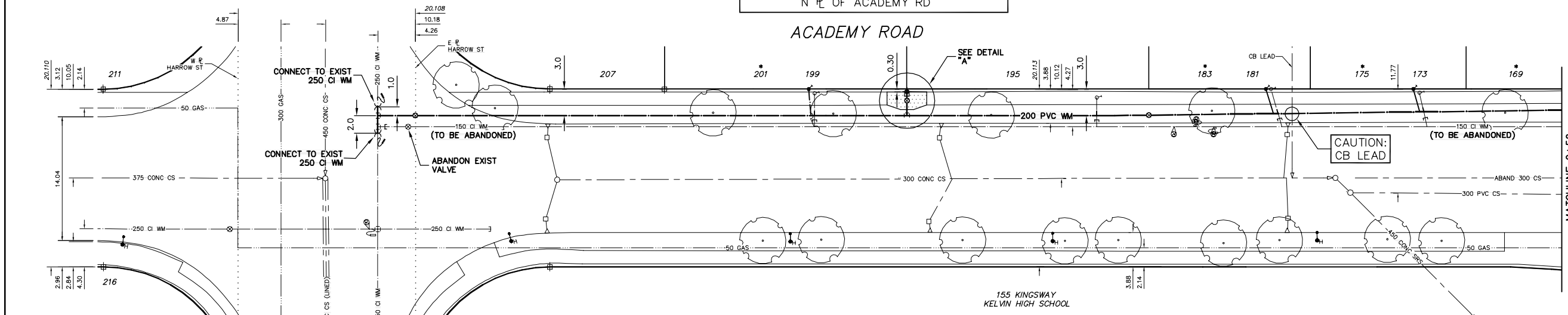

FOR CONSTRUCTION NOTES
SEE DRAWING D-9237



MATCHLINE 2+50
SEE DWG. D-9236

WATER SERVICE INFORMATION

ADDRESS	SIZE(mm) & TYPE (STREET)	SIZE(mm) & TYPE (PROP)	SHORT & LONG MEASUREMENT	CORP. LOCATION	RENEW TO R/W/20 COPPER DBL. W/ #
169 ACADEMY RD RESIDENTIAL	20 COPPER	20 COPPER	1.45 WEL HSE	1.43 E OF S/C	RENEW TO R/W/20 COPPER DBL. W/ #169
173 ACADEMY RD RESIDENTIAL	20 COPPER	20 COPPER	16.08 WML STAFFORD	1.0 E OF S/C	DBL. W/ #173
175 ACADEMY RD RESIDENTIAL	20 COPPER	20 COPPER	34.69 WML STAFFORD	1.0 E OF S/C	RENEW TO R/W/20 COPPER DBL. W/ #175
181 ACADEMY RD RESIDENTIAL	20 COPPER	20 COPPER	34.69 WML STAFFORD	1.25 E OF S/C	DBL. W/ #181
183 ACADEMY RD RESIDENTIAL	20 COPPER	20 COPPER	51.45 WML STAFFORD	1.25 E OF S/C	RENEW TO R/W/20 COPPER DBL. W/ #183
183 ACADEMY RD RESIDENTIAL	20 COPPER	20 COPPER	51.45 WML STAFFORD	1.25 E OF S/C	RENEW TO R/W/20 COPPER DBL. W/ #181

*SERVICES TO BE RENEWED TO R ALL OTHERS TO BE RECONNECTED

WATER SERVICE INFORMATION

ADDRESS	SIZE(mm) & TYPE (STREET)	SIZE(mm) & TYPE (PROP)	SHORT & LONG MEASUREMENT	CORP. LOCATION	RENEW TO R/W/20 COPPER DBL. W/ #
195 ACADEMY RD RESIDENTIAL	20 COPPER	20 COPPER	10.55 EEL HSE	OPP S/C	-
199 ACADEMY RD RESIDENTIAL	20 COPPER	20 COPPER	71.23 WML STAFFORD	OPP S/C	DBL. W/ #201
201 ACADEMY RD RESIDENTIAL	20 COPPER	20 COPPER	45.14 EEL HARROW	OPP S/C	RENEW TO R/W/20 COPPER DBL. W/ #199
207 ACADEMY RD RESIDENTIAL	20 COPPER	20 COPPER	OPP CENTER HSE	0.91 N OF S/C	SERV. OFF HARROW
155 KINGSWAY COMMERCIAL	150 PVC	150 PVC	4.30 SNL BLDG	OPP VALVE	SERV. OFF HARROW
	300 PVC	300 PVC	6.53 SNL DROWORE		

*SERVICES TO BE RENEWED TO R ALL OTHERS TO BE RECONNECTED

METRIC

WHOLE NUMBERS INDICATE MILLIMETRES
DECIMALIZED NUMBERS INDICATE METRES

NOTE: ALL VALVES TO BE INSTALLED COUNTERCLOCKWISE TO CLOSE

WARNING

IF POWER EQUIPMENT OR EXPLOSIVES ARE TO BE USED FOR EXCAVATION ON THIS PROJECT THE CONTRACTOR MUST:
1) NOTIFY THE GAS COMPANY OF THE PROPOSED LOCATION OF EXCAVATION.
2) TAKE PRECAUTION TO AVOID DAMAGE TO GAS COMPANY INSTALLATIONS.
SEE PROVINCIAL REGULATION 210/72 FOR DETAILS



EXISTING	LEGEND-PLAN	PROPOSED	EXISTING	LEGEND-PLAN	PROPOSED	EXISTING	LEGEND-PROFILE	PROPOSED
200 WM	WATERMAIN	200 WM	SL, HYDRO	SL, HYDRO	150 WM	WATERMAIN	150 WM	
525 LDS	LAND DRAINAGE SEWER	525 LDS	50 GAS	50 GAS	300 LDS	LAND DRAINAGE SEWER	300 LDS	
375 WWS	WASTEWATER SEWER	375 WWS	50 GAS	50 GAS	250 WWS	WASTEWATER SEWER	250 WWS	
○	MANHOLE	●	* * * *	FENCE	⊖	PROFILE		
□	CATCH BASIN	■	* * H * T	POLE - HYDRO, MTS	⊖	GROUND ABOVE PIPE		
▽	CURB INLET	▲	⊖	CURB STOP	⊖	⊖	DITCH (NORTH & WEST)	
∇	REDUCER	▼	⊖	GUY ANCHOR	⊖	⊖	DITCH (SOUTH & EAST)	
X	COUPLER	X	⊖	LIGHT STANDARD	⊖	⊖	GUTTER (NORTH & WEST)	
∩	ANODE	∩	⊖	TREE	⊖	⊖	GUTTER (SOUTH & EAST)	

LOCATION APPROVED UNDERGROUND STRUCTURES

SUPV. U/G STRUCTURES COMMITTEE	DATE

NOTE:
LOCATION OF UNDERGROUND STRUCTURES AS SHOWN ARE BASED ON THE BEST INFORMATION AVAILABLE BUT NO GUARANTEE IS GIVEN THAT ALL EXISTING UTILITIES ARE EXACT. CONFIRMATION OF EXISTENCE AND EXACT LOCATION OF ALL SERVICES MUST BE OBTAINED FROM THE INDIVIDUAL UTILITIES BEFORE PROCEEDING WITH CONSTRUCTION.

B.M. ELEV.	FIELD BOOK #

CITY OF WINNIPEG
WATER AND WASTE
ENGINEERING DIVISION

DESIGNED BY	SC	CHECKED BY	TW
DRAWN BY	CJH	APPROVED BY	KZ
HOR. SCALE	1:250	RELEASED FOR CONSTRUCTION	
VERTICAL	1:50		

ENGINEER'S SEAL
ORIGINAL SIGNED BY
S.R.J. COURNOYER
07/08/10

THE CITY OF WINNIPEG
WATER AND WASTE DEPARTMENT

2007 WATERMAIN RENEWALS

ACADEMY ROAD
HARROW STREET TO
19 W OF STAFFORD STREET

SHEET 1 OF 4
CITY DRAWING NUMBER
D-9235