

ADDRESS: 1400 HENDERSON HIGHWAY PROJECT No.: 2004-023 DESCRIPTION: MAIN FLOOR PLAN-RENOVATION FILE NAME: 2004023\0.dwg DATE: 2007.10.05

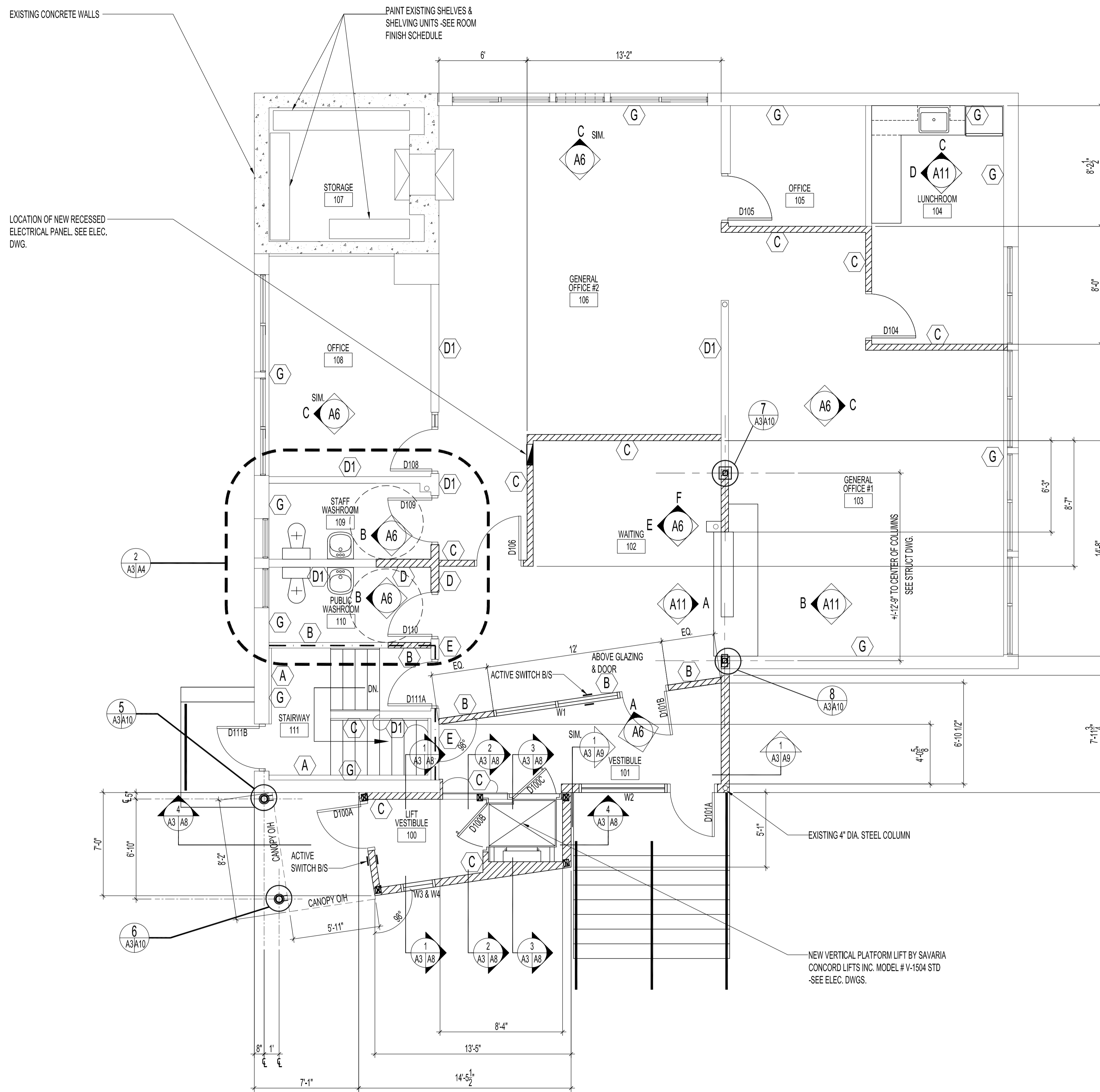

MAIN FLOOR PLAN- RENOVATION
SCALE: 1/4"=1'-0"

LEGEND

- NEW WALLS - SEE WALL TYPES
- EXISTING WOOD STUD WALLS W/ NEW FRAMING & GYPSUM BOARD- SEE TYPES
- NEW DOORS -SEE DOOR SCHED.
- 3/4 HR. FIRE RATED WALL ASSEMBLY

MAIN FLOOR ASSEMBLY FIRE RESISTANT RATING
PROVIDE A 3/4 HR. FIRE RESISTANT RATING BETWEEN BASEMENT & MAIN FLOOR ASSEMBLY BY PATCHING & SEALING ALL OPENINGS & PENETRATIONS AS REQUIRED BY CODE. PROVIDE A 3/4 HR. FIRE RESISTANT SUSPENDED CEILING IN BASEMENT- SEE REFLECTED CEILING PLAN DWG.

NOTES :
EXISTING GYPSUM BOARD MAY BE EXISTING FOR SOME INTERIOR WALLS ON MAIN FLOOR. PATCH & FILL ANY OPENINGS AND PREPARE FOR PAINTING.

ORIGINAL STAMPED BY: R.K.FOK LI Arch.
DATE: 2007.10.15

NO.	REVISION/DESCRIPTION	BY	DATE
SEALS			

DRAWN BY	MMK	CHECKED BY	APPROVED
DATE	2007.10.05	USER APPROVAL	

CITY OF WINNIPEG
PLANNING, PROPERTY &
DEVELOPMENT DEPARTMENT
CIVIC ACCOMMODATIONS DIVISION
300 - 65 GARRY ST. R3C 4K4

PROJECT
COMMUNITY POLICE SERVICE CENTRE

1400 HENDERSON HIGHWAY
SHEET TITLE
MAIN FLOOR PLAN
RENOVATION

SCALE	PROJECT NO.	SHEET NO.
AS SHOWN	2004-023	A3