

3 REINFORCING PLAN
SCALE: 1:40 • EL. 228.00m

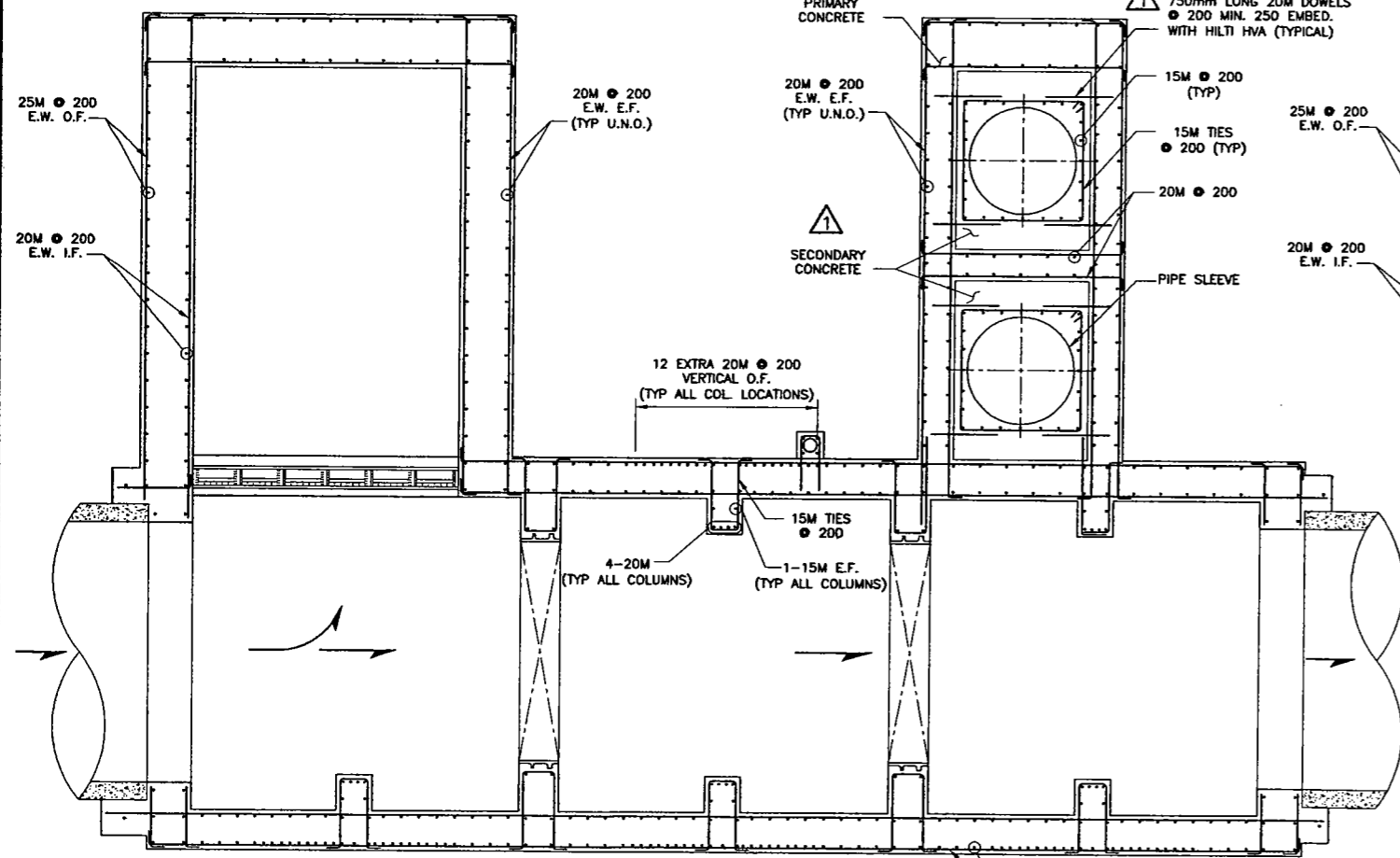

4 REINFORCING PLAN
SCALE: 1:40 • EL. 224.25m

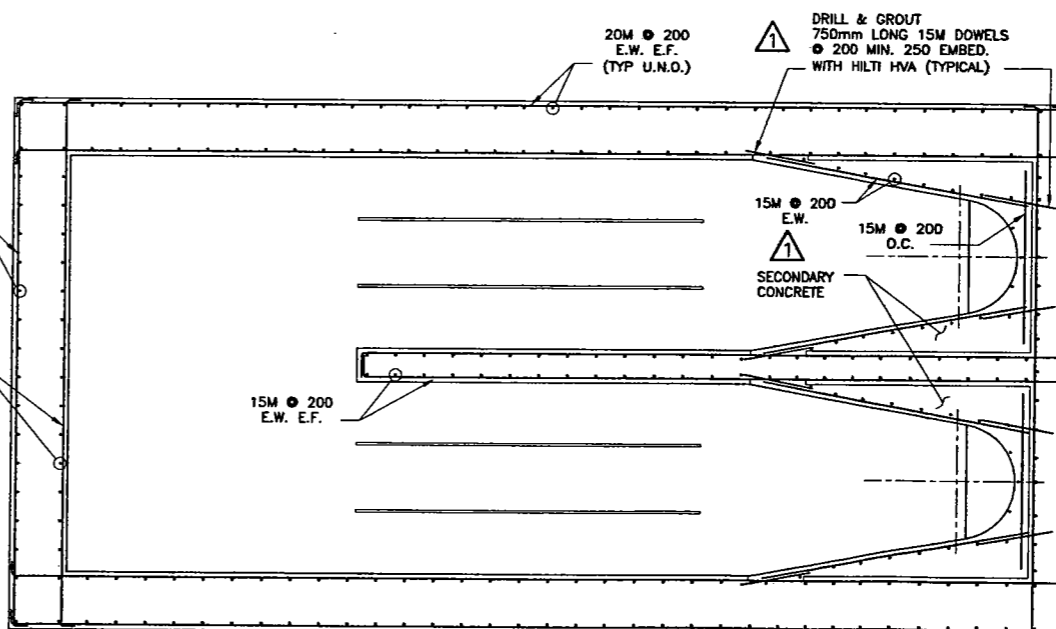

5 REINFORCING PLAN
SCALE: 1:40 • EL. 222.65m

1. REFER TO DRAWING 48aS-001c FOR GENERAL NOTES.

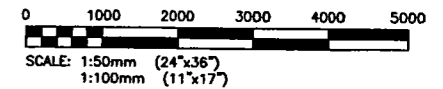

01	29/11/06	REVISED BEAM AND CONST. JOINTS	TF	CMS	JBS
00	04/07/06	ISSUED FOR TENDER AND CONSTRUCTION	TF	CMS	JBS
NO.	DATE	REVISIONS	BY	CHKD.	APP.

KGS GROUP

SUBCONSULTANT DWG NO.:

<p>APEGM Certificate of Authorization KGS Group No. 245 Expiry: April 30, 2007</p>	<p>ENR. STAMP</p> <p>THE ORIGINAL ISSUE REV. 0 WAS STAMPED, DATED AND SIGNED</p> <p>BY C.M. SIEPMAN ON 04/07/06 D/M/Y</p>
	<p>DESIGNED BY: TF</p> <p>CHECKED BY: CMS</p> <p>DRAWN BY: EC</p> <p>APPROVED BY: J B SMITH</p> <p>SCALE: AS NOTED</p> <p>DATE: MAY 2006</p>

KGS GROUP SUBMITTED BY: RICK CARSON

OWNER
MANITOBA FLOODWAY AUTHORITY

PROJECT:
RED RIVER FLOODWAY EXPANSION

PHASE:
MAIN CHANNEL CONTRACT No. C5

TITLE:
**KILDARE LAND DRAINAGE FLOOD PUMPING STATION
STRUCTURAL WORKS
REINFORCING - SECTIONAL PLANS
AT EL 228.00, 224.25 AND 222.65**

RELEASED FOR CONSTRUCTION:

DOUG McNEIL
VICE PRESIDENT OF ENGINEERING AND CONSTRUCTION

OWNER DWG NO.: CC5-48aS-008c

SHT. 01 REV. 01

