

NOTES:

1. BACKFILL UNDER PAVEMENT, IN SIDEWALKS, & WITHIN 1.0 m OF PAVEMENT TO BE CLASS 3.
2. CONFIRM LIMITS OF REPAIR IN PRESENCE OF THE CONTRACT ADMINISTRATOR BY CCTV.

SEWER JUNCTION INFORMATION FROM SEWER VIDEO INSPECTION S-MA20006066			
DISTANCE FROM MH S-MH20005568			
33.2	S	150ø	WEST CXI

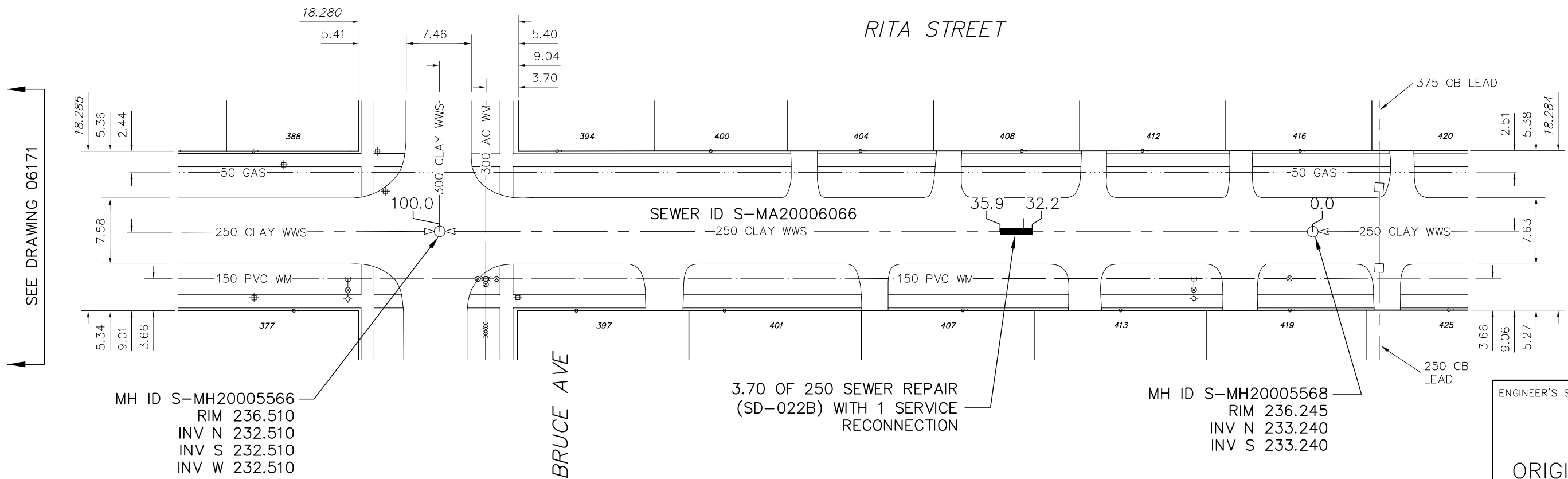
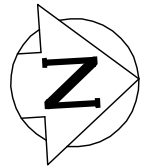

SEE DRAWING 06171

MH ID S-MH20005566  
RIM 236.510  
INV N 232.510  
INV S 232.510  
INV W 232.510

3.70 OF 250 SEWER REPAIR  
(SD-022B) WITH 1 SERVICE  
RECONNECTION

MH ID S-MH20005568  
RIM 236.245  
INV N 233.240  
INV S 233.240

ENGINEER'S SEAL

ORIGINAL SIGNED  
BY K.R. ZUREK  
07/09/10

CONTRACT 16  
FILENAME : 06170.dwg  
PLOT DATE : 2007 09 10

LEGEND:

52.0 | MEASUREMENT TO REPAIR FROM REFERENCE MH SHOWN THUS...

**METRIC**  
WHOLE NUMBERS INDICATE MILLIMETRES  
DECIMALIZED NUMBERS INDICATE METRES

B.M. ELEV.	FIELD BOOK #:	<b>CITY OF WINNIPEG WATER AND WASTE ENGINEERING DIVISION</b>	
POSTED TO LBIS		DESIGNED BY: NC	CHECKED BY: TW/KZ
		DRAWN BY: CJH	APPROVED BY: KZ
		HOR. SCALE: 1:500	RELEASED FOR CONSTRUCTION
		VERTICAL	
NO.	REVISIONS	DATE	BY
		DATE: 2007 09 10	DATE

**Winnipeg** THE CITY OF WINNIPEG  
WATER AND WASTE DEPARTMENT

2007 SEWER RENEWALS AND REPAIRS  
CONTRACT 16  
RITA STREET  
MH AT BRUCE AVENUE TO  
1ST MH N OF BRUCE AVENUE

SHEET 12 OF 25  
CITY DRAWING NUMBER  
06170