

WATER SERVICE INFORMATION

ADDRESS	SIZE(mm) & TYPE (STREET)	SIZE(mm) & TYPE (PROP)	SHORT & LONG MEASUREMENT	CORP. LOCATION
439 WALLASEY ST	-	-	0.30 NSL HSE	-
RESIDENTIAL	-	-	113.47 SSL NESS	-
448 WALLASEY ST	20	-	3.51 SNL HSE	-
RESIDENTIAL	-	-	88.23 SSL NESS	-
450 WALLASEY ST	20	-	4.11 NSL HSE	-
RESIDENTIAL	-	-	75.07 SSL NESS	-
452 WALLASEY ST	-	-	3.05 NSL HSE	-
RESIDENTIAL	-	-	61.94 SSL NESS	-
453 WALLASEY ST	-	-	1.92 SNL HSE	-
RESIDENTIAL	-	-	67.56 SSL NESS	-
454 WALLASEY ST	20	20	1.22 SSL HSE	-
RESIDENTIAL	-	-	44.62 SSL NESS	-
455 WALLASEY ST	-	-	2.11 S OF HYD @ #455	-
RESIDENTIAL	-	-	48.73 SSL NESS	-
456 WALLASEY ST	20	20	2.55 NSL HSE	-
RESIDENTIAL	-	-	22.81 SSL NESS	-
2380 NESS AVE	20	-	2.70 NSL HSE	-
RESIDENTIAL	-	-	20.55 SSL NESS	-
2395 NESS AVE	-	-	4.50 WEL BLDG	-
RESIDENTIAL	-	-	-	-

SEWER SERVICE INFORMATION

ADDRESS	SIZE	R DIST	TIE
439 WALLASEY ST	-	2.75 N	OF SL
RESIDENTIAL	-	-	-
448 WALLASEY ST	-	5.78 S	OF NL
RESIDENTIAL	-	-	-
450 WALLASEY ST	-	6.81 S	OF NL
RESIDENTIAL	-	-	-
452 WALLASEY ST	-	6.15 N	OF SL
RESIDENTIAL	-	-	-
453 WALLASEY ST	-	1.78 S	OF NL
RESIDENTIAL	-	-	-
454 WALLASEY ST	-	6.72 N	OF SL
RESIDENTIAL	-	-	-
455 WALLASEY ST	-	3.04 S	OF NL
RESIDENTIAL	-	-	-
456 WALLASEY ST	-	12.04 N	OF SL
RESIDENTIAL	-	-	-
2380 NESS AVE	-	9.90 N	OF SL, SERV. OFF WALLASEY
RESIDENTIAL	-	-	-
2395 NESS AVE	-	-	-
COMMERCIAL	-	-	-

- CONSTRUCTION NOTES:**
- SEWER TO BE RENEWED BY TRENCHLESS METHODS.
 - CONFIRM THE LOCATION OF ALL EXISTING SEWER SERVICES WITHIN LIMITS OF RENEWAL. EXACT LOCATIONS OF NEW SERVICES WILL BE DETERMINED BY CONDITIONS IN THE FIELD.
 - BACKFILL UNDER PAVEMENT, IN SIDEWALKS, & WITHIN 1.0 m OF PAVEMENT TO BE CLASS 3.
 - BACKFILL IN BOULEVARD TO BE CLASS 5.
 - SEWER SERVICES TO BE INSTALLED AT A MINIMUM 1.0% SLOPE.

NOTE: CHAINAGES SHOWN ARE ALONG E. R. OF WALLASEY ST.

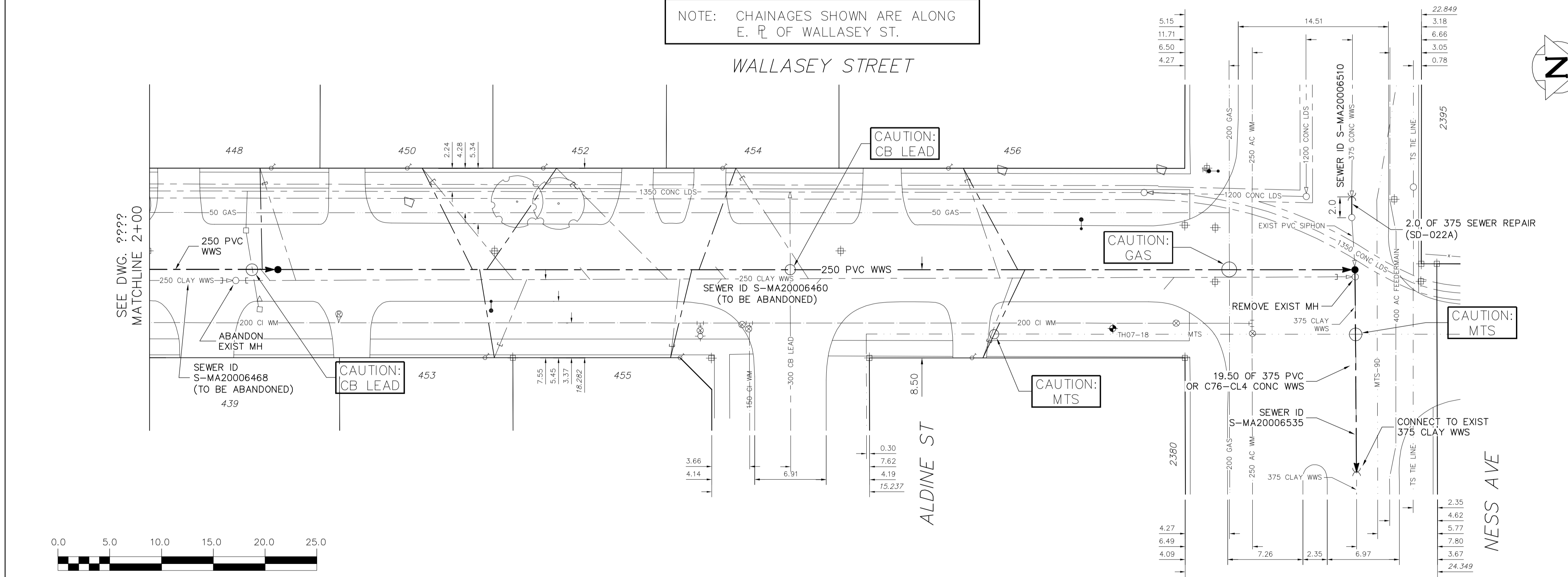

SEWER JUNCTION INFORMATION FROM SEWER VIDEO INSPECTION
SEWER ID S-MA20006460

DISTANCE FROM MH ID S-MH20005944

DISTANCE	DIRECTION	SIZE	TYPE	NOTE
3.3	N	150#	WEST	JN
5.8	N	150#	WEST	CNI
28.8	N	150#	WEST	JN
28.1	N	150#	EAST	JN
34.2	N	150#	WEST	CNI
41.7	N	150#	WEST	JN
42.9	N	150#	EAST	JN
42.9	N	150#	EAST	JN
46.6	N	150#	EAST	JN
47.3	N	150#	WEST	CNI
55.3	N	150#	WEST	CN
56.5	N	150#	EAST	JN
73.8	N	150#	WEST	CN
75.0	N	150#	EAST	JN
90.6	N	150#	EAST	CNI

METRIC
WHOLE NUMBERS INDICATE MILLIMETRES
DECIMALIZED NUMBERS INDICATE METRES

WARNING
IF POWER EQUIPMENT OR EXPLOSIVES ARE TO BE USED FOR EXCAVATION ON THIS PROJECT THE CONTRACTOR MUST:
1) NOTIFY THE GAS COMPANY OF THE PROPOSED LOCATION OF EXCAVATION.
2) TAKE PRECAUTION TO AVOID DAMAGE TO GAS COMPANY INSTALLATIONS.
SEE PROVINCIAL REGULATION 210/72 FOR DETAILS

200 WM	WATERMAIN	200 WM	SL, HYDRO	150 WM	WATERMAIN	150 WM
⊕	HYDRANT	⊕	MTS	⊕	HYDRANT	⊕
⊕	VALVE	⊕	TRAFFIC SIGNALS	⊕	VALVE	⊕
—○—	LAND DRAINAGE SEWER	—○—	GAS	—○—	LAND DRAINAGE SEWER	—○—
—○—	WASTEWATER SEWER	—○—	SURVEY BAR	—○—	WASTEWATER SEWER	—○—
○	MANHOLE	●	FENCE	○	€ PROFILE	○
□	CATCH BASIN	■	POLE - HYDRO, MTS	○	GROUND ABOVE PIPE	○
▽	CURB INLET	♂	CURB STOP	○		○
—○—	JUNCTIONS	—○—	GUY ANCHOR	—○—		—○—
—○—	CULVERT	—○—	LIGHT STANDARD	—○—		—○—
—○—	ANODE	—○—	TREE	—○—		—○—
—○—	EXISTING LEGEND-PLAN	—○—	PROPOSED EXISTING LEGEND-PLAN	—○—	PROPOSED EXISTING LEGEND-PROFILE	—○—

LOCATION APPROVED UNDERGROUND STRUCTURES

SUPV. U/G STRUCTURES COMMITTEE DATE

NOTE: LOCATION OF UNDERGROUND STRUCTURES AS SHOWN ARE BASED ON THE BEST INFORMATION AVAILABLE BUT NO GUARANTEE IS GIVEN THAT ALL EXISTING UTILITIES ARE SHOWN OR THAT THE GIVEN LOCATIONS ARE EXACT. CONFIRMATION OF EXISTENCE AND EXACT LOCATION OF ALL SERVICES MUST BE OBTAINED FROM THE INDIVIDUAL UTILITIES BEFORE PROCEEDING WITH CONSTRUCTION.

NO.	REVISIONS	DATE	BY

CITY OF WINNIPEG WATER AND WASTE ENGINEERING DIVISION

DESIGNED BY: NC
CHECKED BY: TW

DRAWN BY: CJH
APPROVED BY: KZ

HOR. SCALE: 1:250
VERTICAL: 1:50

DATE: 2007 09 10

ENGINEER'S SEAL

ORIGINAL SIGNED BY K.R. ZUREK 07/09/10

BID OPPORTUNITY: 653-2007
FILENAME: 06182_83.dwg
PLOT DATE: 2007 09 10

THE CITY OF WINNIPEG
WATER AND WASTE DEPARTMENT

2007 SEWER RENEWALS
CONTRACT 16
WALLASEY STREET
1ST MH S OF NESS AVENUE TO
MH AT NESS AVENUE

SHEET 25 OF 25
CITY DRAWING NUMBER
06183