

- WOOD OVERHEAD HUTCH
- TACK BOARD
- 2 LIGHTS
- KEYBOARD TRAY / DRAWER
- 2 @ LOCKABLE, MOBILE  
PDS 1 @ P/B/F  
1 @ F/F
- 3 GROMMETS

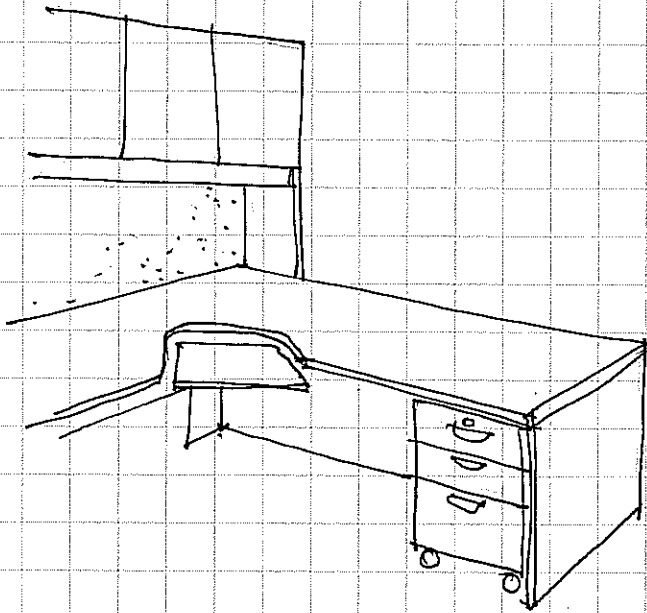
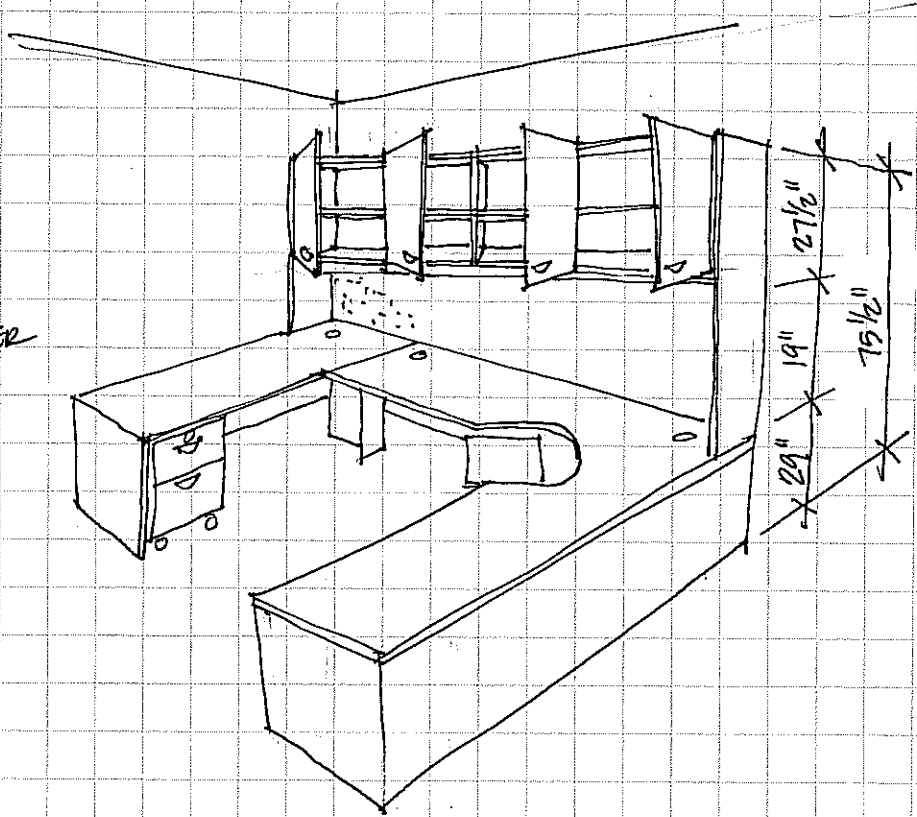

DEMPINA TRAIL LIBRARY PAGE 2  
STATION 1  
"SUPERVISOR'S DESK"

COLOURS TO FOLLOW

A-16

SEDA  
AUG 07