

WALL TYPES:

- W1 EXISTING CAST-IN-PLACE CONCRETE TYPICAL UNLESS NOTED
- W4 CMU 190mm
- W6 CMU 90mm

FIRE RATINGS:

- 1 HR FIRE RATING
- 2 HR FIRE RATING

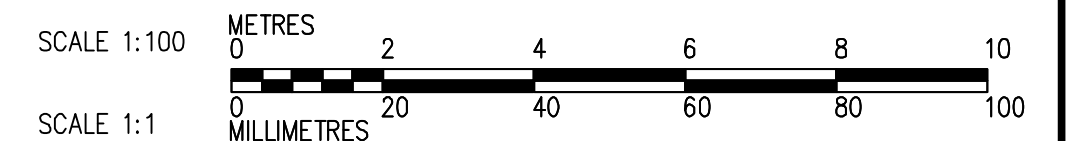
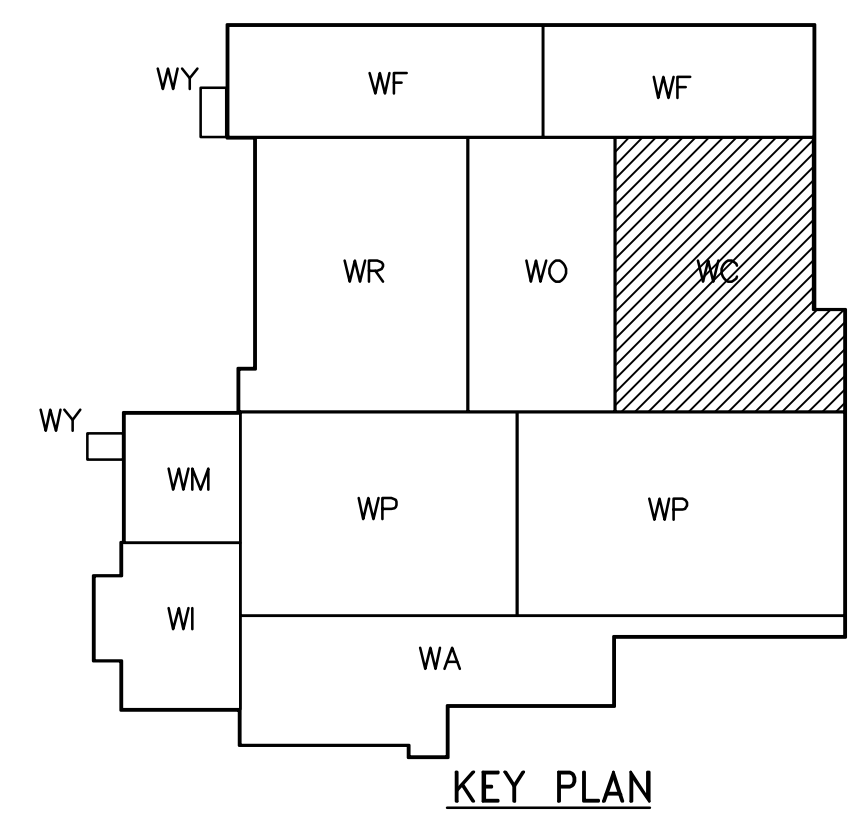

1 PARTIAL PLAN - POLYMER AND INSTRUMENTATION ROOM (SECOND FLR) 1:100



| | | | |
|-------------------------|---------------------------------|-------------------------------|---------------|
| INFORMATION ONLY | | | |
| DESIGNED BY | TWS | CHECKED BY | BJS |
| DRAWN BY | SH/LK/AL | APPROVED BY | AHL |
| SCALE: | 1:100 | RELEASED FOR CONSTRUCTION BY: | R. SOROKOWSKI |
| NO. | REVISIONS | DATE | DATE |
| 02 | 95-2007 ISSUED FOR CONSTRUCTION | 07/09/10 | LK |
| 01 | 95-2007 ADDENDUM 02 | 07/06/20 | LK |
| 00 | ISSUED FOR TENDER | 07/06/05 | LK |
| 2005/08/03 | | 2007/06/05 | |

ENGINEER'S SEAL
 ORIGINAL SIGNED BY
 NEIL COOPER
 2007/06/05
 CONSULTANT DRAWING NO.
 WB-B0125

THE CITY OF WINNIPEG
 WATER AND WASTE DEPARTMENT
 ENGINEERING DIVISION

WATER TREATMENT PLANT
 MAIN BUILDING
 OFFICE AND PLANT INTERIOR FINISHES

ARCHITECTURAL
 PARTIAL PLAN OF
 POLYMER AND INSTRUMENTATION ROOM

CITY FILE NUMBER
 SHEET OF
 CITY DRAWING NUMBER
1-0601B-A-B0125-001-02D