

1 PARTIAL PLAN - ADMINISTRATION (SECOND FLOOR LEVEL)
WB-B0129 1:100

2 PARTIAL PLAN - DAF INFLUENT GALLERY (SECOND FLOOR LEVEL)
WB-B0129 1:100

NOTE: SEE DRAWING WB-B0353 FOR INTERIOR DETAILS OF THIS AREA

WALL TYPES:

- W1 EXIST CAST-IN-PLACE CONCRETE TYPICAL UNLESS NOTED
- W2 CMU 290mm
- W3 CMU 240mm
- W4 CMU 190mm
- W5 CMU 140mm
- W6 CMU 90mm
- WB6B CMU 90mm BURNISHED CMU 90mm BURNISHED (DUAL WHYTHE - BACK TO BACK)
- W7 FROM FIN FLOOR TO 1200mm AFF: CMU 90mm BURNISHED 13mm FURRING BAR @ 400mm O/C 13mm GYP BD - PT FROM 1200mm AFF TO U/S OF CONCRETE SLAB - WALL TYPE WB
- WB 13mm GYP BD - PT 92mm STEEL STUDS @ 400mm O/C 13mm GYP BD - PT ACOUSTICAL BATT INSULATION ACOUSTICAL CAULK ON TOP & BOT PLATE
- WB 16mm TYPE X GYP BD - PT 92mm STEEL STUDS @ 400mm O/C 13mm GYP BD - PT ACOUSTICAL BATT INSULATION ACOUSTICAL CAULK ON TOP & BOT PLATE
- WB2B CMU 290mm BURNISHED
- WB3A 240mm CMU AIR SPACE 92mm METAL STUDS 13mm GYP BD-PT
- WB4B CMU 190mm BURNISHED
- WB5B CMU 140mm BURNISHED
- WB6B CMU 90mm BURNISHED

FIRE RATINGS:

- 1 HR FIRE RATING
- 2 HR FIRE RATING

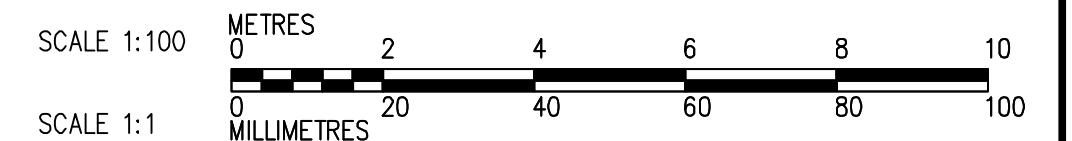
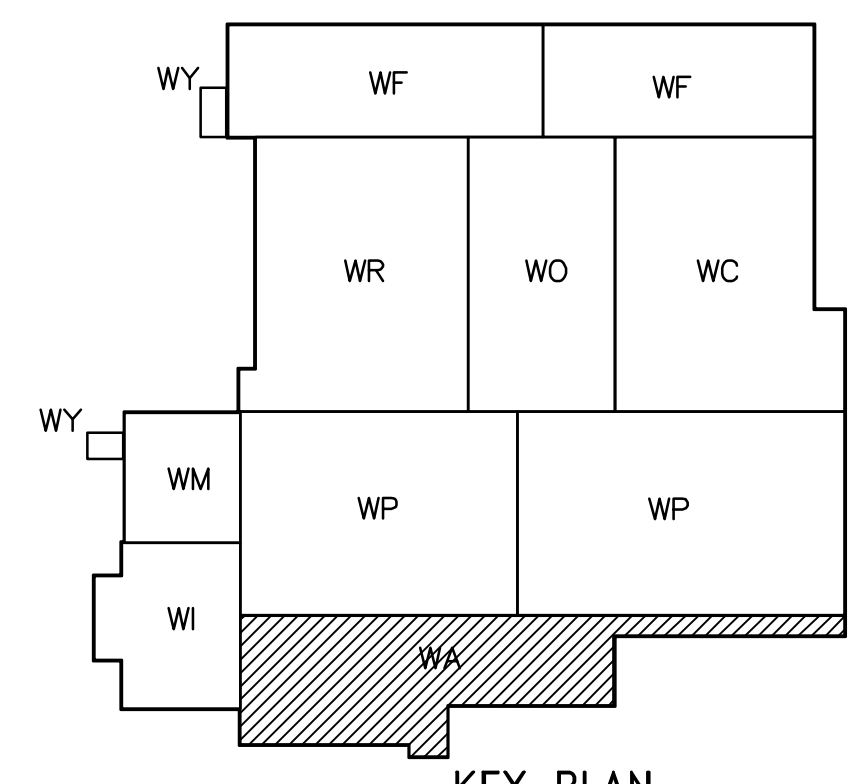

INFORMATION ONLY



NO.	REVISIONS	DATE	BY
05	95-2007 FI-O-006-FC	07/12/04	LK
04	95-2007 ISSUED FOR CONSTRUCTION	07/09/10	LK
03	95-2007 ADDENDUM 06	07/07/20	LK
02	95-2007 ADDENDUM 05	07/07/13	LK
01	95-2007 ADDENDUM 02	07/06/20	LK
00	ISSUED FOR TENDER	07/06/05	LK

DESIGNED BY	TWS	CHECKED BY	BJS
DRAWN BY	SH/LK/AL	APPROVED BY	AHL
SCALE:	1:100	RELEASED FOR CONSTRUCTION BY:	R. SOROKOWSKI
DATE	2005/08/03	DATE	2007/06/05

ENGINEER'S SEAL	ORIGINAL SIGNED BY	NEIL COOPER
		2007/06/05
CONSULTANT DRAWING NO.	WB-B0129	

THE CITY OF WINNIPEG
WATER AND WASTE DEPARTMENT
ENGINEERING DIVISION

WATER TREATMENT PLANT
MAIN BUILDING
OFFICE AND PLANT INTERIOR FINISHES

ARCHITECTURAL
PARTIAL PLAN OF ADMINISTRATION
& DAF INFLUENT GALLERY (ELEV. 242.500)

CITY FILE NUMBER
SHEET OF
CITY DRAWING NUMBER
1-0601B-A-0129-001-05D