

NOTES:
 THIS DRAWING MUST NOT BE SCALED.
 THE CONTRACTOR SHALL VERIFY ALL DIMENSIONS, DATUMS, AND LEVELS PRIOR TO COMMENCEMENT OF WORK. ALL ERRORS AND OMISSIONS TO BE REPORTED TO THE CONTRACT ADMINISTRATOR BEFORE PROCEEDING.
 VARIATIONS AND MODIFICATIONS TO WORK SHOWN ON THESE DRAWINGS SHALL NOT BE CARRIED OUT WITHOUT WRITTEN PERMISSION OF THE CONTRACT ADMINISTRATOR.
 THIS DRAWING IS THE EXCLUSIVE PROPERTY OF NUMBER TEN ARCHITECTURAL GROUP AND THE COPYRIGHT IN THE SAME BEING RESERVED TO THEM. IT MAY BE REPRODUCED ONLY WITH THE PERMISSION OF THE CITY OF WINNIPEG.

SITE PLAN GENERAL NOTES:
 1.) ARCHITECTURAL SITE PLAN IS PROVIDED TO IDENTIFY EXISTING BUILDINGS FOR DEMOLITION AND LOCATE NEW CONSTRUCTION ONLY - REFER TO OTHER DISCIPLINES FOR ALL OTHER DEMOLITION AND SITE WORKS INFORMATION.
 2.) REFER TO DRAWING C-1.0 FOR COMPLETE SITE SURVEY.

SITE PLAN KEYED NOTES:
 [1] EXISTING BRONX PARK COMMUNITY CENTRE TO BE DEMOLISHED - REFER TO 2/A-1.1
 [2] EXISTING MAINTENANCE GARAGE TO BE DEMOLISHED - REFER TO 3/A-1.1

FIRE DEPARTMENT ACCESS ROUTE:
 FIRE DEPARTMENT ACCESS ROUTE TO BE VIA NEW APPROACH AND PARKING LOT ASSESSMENT FROM HENDERSON HWY - REFER TO LANDSCAPE FOR LOCATION AND DIMENSIONS.

CONSTRUCTION ACCESS ROUTE:
 DEMOLITION AND CONSTRUCTION ACCESS ROUTES TO BE DEVELOPED BY CONTRACTOR AND APPROVED BY CITY.

LEGAL DESCRIPTION:
 PARCEL A PLAN 15622 WILTO IN RL 88 PARISH OF KILDONAN

CIVIC ADDRESS:
 131 CHELSEA PLACE

SITE AREA:
 APPROX. 3.8 ACRES

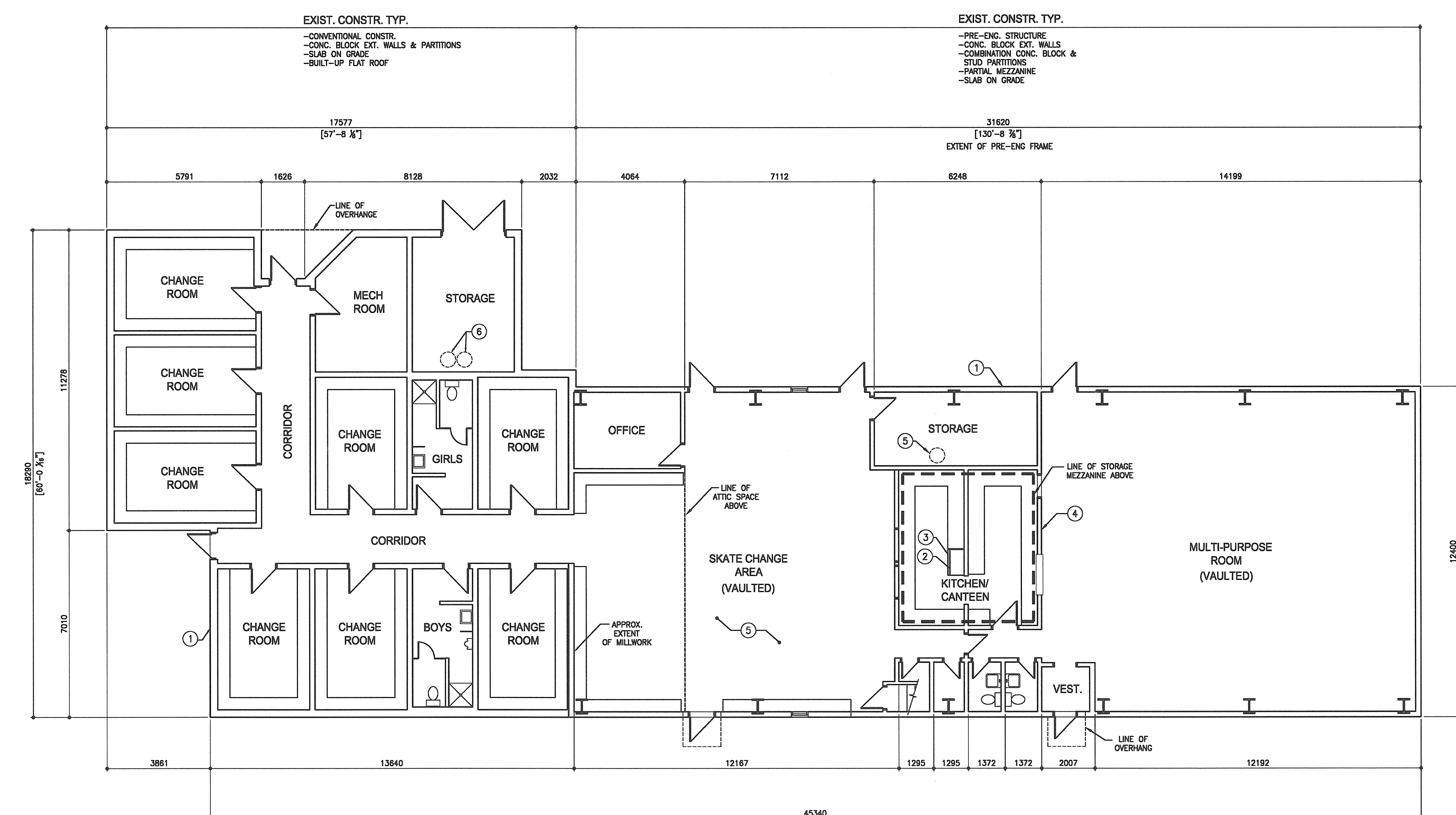

2 DEMOLITION PLAN - EXISTING BRONX PARK COMMUNITY CENTRE
 SCALE: 1:100

- DEMOLITION GENERAL NOTES:**
- DEMOLITION PLANS ARE PROVIDED FOR GENERAL SCALE AND REFERENCE OF ITEMS TO BE SALVAGED ONLY, AND DO NOT NECESSARILY REFLECT AS BUILT CONDITIONS.
 - CONTRACTOR SHALL PLUG AND ABANDON THE EXISTING SEWER AND WATER SERVICES FOR THE EXISTING BUILDING TO BE DEMOLISHED.
 - SEWER SERVICES SHALL BE PLUGGED AND ABANDONED IN ACCORDANCE WITH CW2130 OF THE CITY OF WINNIPEG STANDARD CONSTRUCTION SPECIFICATIONS, LATEST EDITION.
 - WATER SERVICES SHALL BE PLUGGED AND ABANDONED IN ACCORDANCE WITH CW210 OF THE CITY OF WINNIPEG STANDARD CONSTRUCTION SPECIFICATIONS, LATEST EDITION.
 - LOCATION AND ELEVATION OF EXISTING WORKS TO BE VERIFIED BY THE CONTRACTOR PRIOR TO CONSTRUCTION. IT IS THE RESPONSIBILITY OF THE CONTRACTOR TO VERIFY SERVICES TO BE ABANDONED. THE LOCATION OF SUCH SERVICES AND NOTIFY THE RELEVANT UTILITIES PRIOR TO CONSTRUCTION.
 - CONTACT GAS UTILITY COMPANY FOR REMOVAL OF EXISTING GAS SERVICE BACK TO MAIN BRANCH AND PROVIDE VALVE AND CAP.
- DEMOLITION PLAN KEYED NOTES:**
- DEMOLISH & REMOVE ALL CONSTRUCTION TO UNDERSIDE OF EXISTING GRADE BEAM EXCEPT WHERE INDICATED OTHERWISE. CUT DOWN EXISTING FOUNDATIONS TO EL. 230.517 AS REQUIRED FOR NEW FOUNDATIONS.
 - REMOVE & STORE EXISTING GRILLE, DEEP FRYER, WARMING TABLE AND STAND FOR REUSE IN NEW CONSTRUCTION.
 - REMOVE & STORE EXISTING EXHAUST HOOD & WALL PROTECTION FOR REUSE IN NEW CONSTRUCTION SEE MECH.
 - REMOVE AND TURN OVER TO CITY EXISTING METAL SHELVING TO BE REINSTALLED IN NEW CONSTRUCTION BY CITY (10 UNITS APPROX. 42"W x 24"D x 72" H).
 - REMOVE AND STORE EXISTING HOT WATER TANK FOR REUSE IN NEW CONSTRUCTION-SEE MECH.
 - REMOVE & STORE EXISTING HOT WATER STORAGE TANKS FOR REUSE IN NEW CONSTRUCTION-SEE MECH.
 - REMOVE AND STORE APPROX. 10 sq.m OF EXISTING ASPHALT PLANK TO BE REUSED IN NEW EXTERIOR CONSTRUCTION - SEE LANDSCAPE FOR LOCATION.

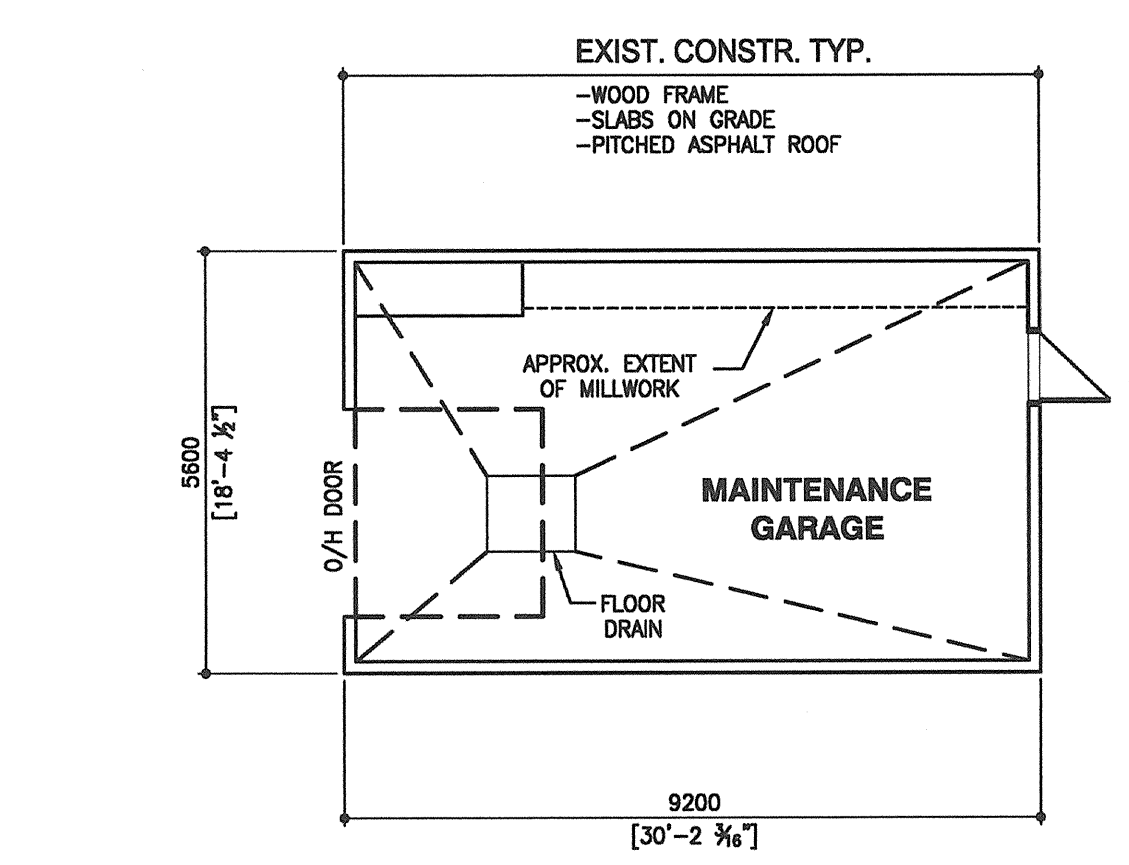

3 DEMOLITION PLAN - OTHER
 SCALE: 1:100



NO.	REVISION/DESCRIPTION	DATE
1	ISSUED FOR 40% REVIEW	28-OCT-2007
2	ISSUED FOR CLASS 'X' OPINION OF PROBABLE COSTS	28-NOV-2007
3	ISSUED FOR 80% REVIEW	7-DEC-2007
4	ISSUED FOR 100% REVIEW	11-JAN-2008
5	ISSUED FOR TENDER	18-JAN-2008

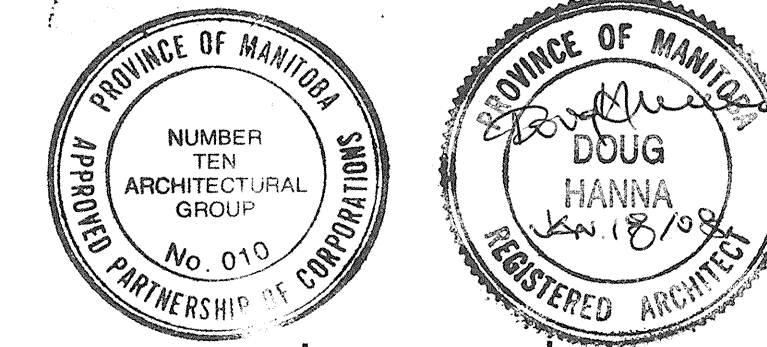

DRAWN BY: PLS.GD CHECKED BY: DH APPROVED
 DATE: 18-JAN-2008 USER APPROVAL

CITY OF WINNIPEG
 PLANNING, PROPERTY &
 DEVELOPMENT DEPARTMENT
 CIVIC ACCOMMODATIONS DIVISION
 300 - 65 GARRY ST. R3C 4K4

PROJECT
 BRONX PARK COMMUNITY CENTRE
 HOME OF
 GOOD NEIGHBOURS SENIOR CENTRE
 WINNIPEG, MANITOBA

SHEET TITLE
 SITE PLAN
 DEMOLITION PLANS