

1 EXISTING BUILDING
E.T.O. NTS

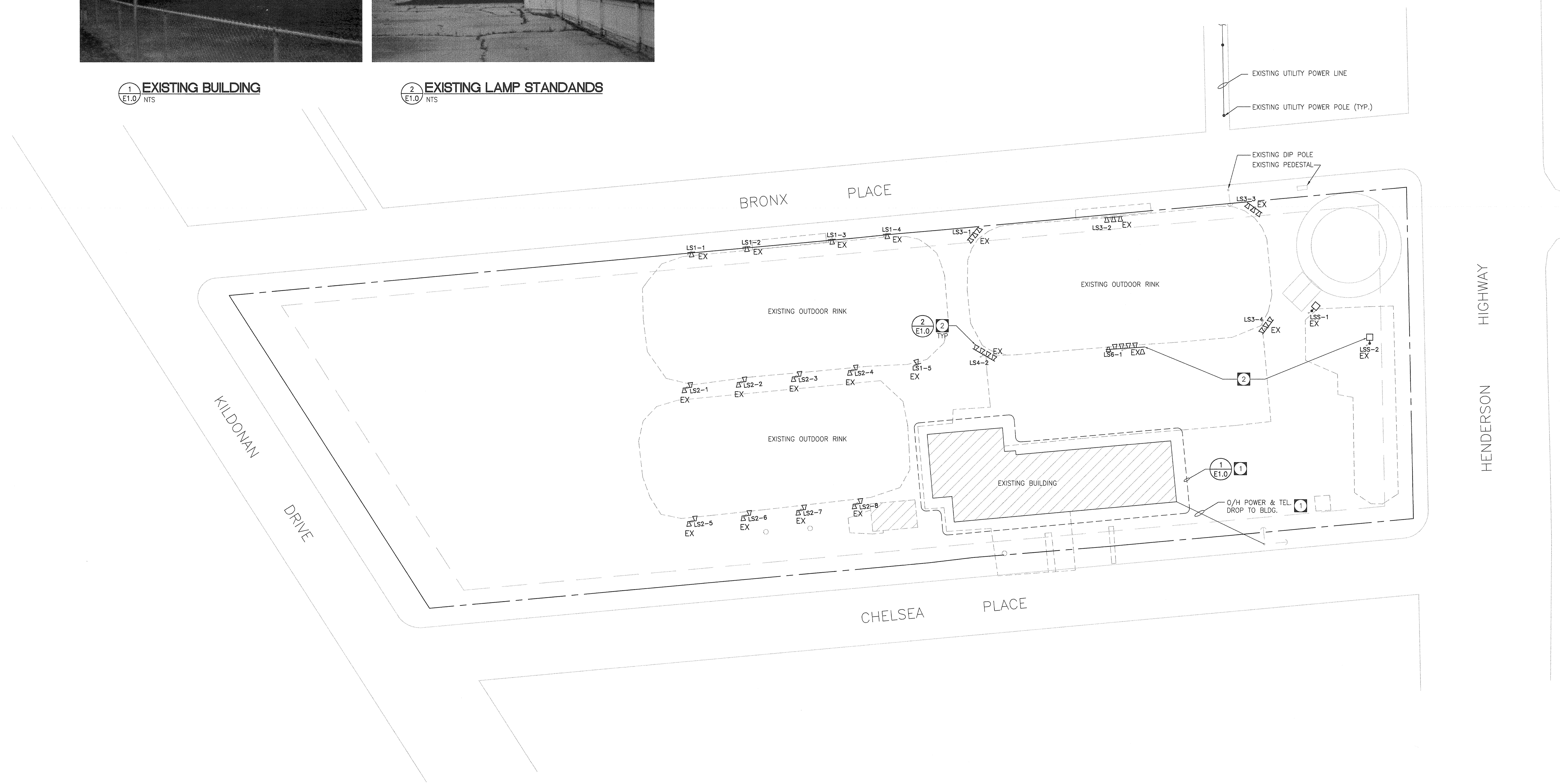

2 EXISTING LAMP STANDARDS
E.T.O. NTS



DEMO SITE PLAN
SCALE: 1:400 (METRIC)

NOTES:
THIS DRAWING MUST NOT BE SCALED.
THE CONTRACTOR SHALL VERIFY ALL DIMENSIONS, OUTLINES, AND LEVELS PRIOR TO COMMENCEMENT OF WORK. ALL ERRORS AND OMISSIONS TO BE REPORTED TO THE CONTRACT ADMINISTRATOR BEFORE PROCEEDING.
VARIATIONS AND MODIFICATIONS TO WORK SHOWN ON THESE DRAWINGS SHALL NOT BE CARRIED OUT WITHOUT WRITTEN PERMISSION OF THE CONTRACT ADMINISTRATOR.
THIS DRAWING IS THE EXCLUSIVE PROPERTY OF NUMBER TEN ARCHITECTURAL GROUP AND THE COPYRIGHT IN THE SAME REMAINS RESERVED TO THEM. IT MAY BE REPRODUCED ONLY WITH THE PERMISSION OF THE CITY OF WINNIPEG.

TOWER PROJECT NO.: 6150
TOWER ENGINEERING GROUP
208 - 887 CROFTON AVE. WINNIPEG, MB R3M 0W7
TEL: (204) 925-1150 FAX: (204) 925-1155
EMAIL: towereng@towereng.ca WEB: www.towereng.ca

numberTEN architectural group
Winnipeg, MB 204 942 0781
Victoria, BC 250 360 2106
architecture • interior design • graphic design

NO.	REVISION/ISSUED/PLOTTED	DATE
1	DESIGN DEVELOPMENT SUBMISSION	31/AUG/07
2	ISSUED FOR 40% REVIEW	28/OCT/07
3	ISSUED FOR 80% REVIEW	07/DEC/07
4	ISSUED FOR 100% REVIEW	11/JAN/08
5	ISSUED FOR TENDER	18/JAN/08

NO.	REVISION/DESCRIPTION	BY	DATE

SEALS

ELECTRICAL SPECIFICATIONS (DEMOLITION)

1.1 GENERAL SPECIFICATIONS:

- ALL ASPECTS OF THE DEMOLITION MUST COMPLY WITH THE MOST STRINGENT OF THE APPLICABLE BUILDING CODES, LOCAL REGULATIONS, AND BY-LAWS. BEFORE PROCEEDING WITH PROVIDE ALL NECESSARY NOTICES, OBTAIN ALL REQUIRED PERMITS, PAY ALL FEES REQUIRED BY LAW, AND ARRANGE FOR ALL INSPECTIONS RELATED TO THE PERFORMANCE OF THE SPECIFIED WORK.
- EACH CONTRACTOR SHALL COORDINATE THE WORK WITH OTHER CONTRACTORS IN ORDER TO AVOID CONFLICTS.
- NEATLY STORE ALL MATERIALS, AND CLEAN UP REFUSE ON A REGULAR BASIS.

1.2 SCOPE OF WORK:

- THE REQUIREMENTS UNDER THIS SCOPE OF WORK WILL CONSIST OF THE DECOMMISSIONING AND REMOVAL OF ALL ELECTRICAL EQUIPMENT, TELEPHONE SERVICES, COMMUNICATION EQUIPMENT, ETC. INSIDE AND OUTSIDE THE BUILDING AS WELL AS ALL RELATED SERVICES TO THE BUILDING.
- REFER TO ARCHITECTURAL SPECIFICATIONS FOR "SUMMARY OF WORK" REQUIREMENT AND INCLUDE ALL ELECTRICAL WORK INDICATED THEREIN.
- EXAMINE THE COMPLETE SET OF CONTRACT DOCUMENTS TO ENSURE THAT THE WORK CAN BE CARRIED OUT WITHOUT SIGNIFICANT CHANGES TO THE INTENT OF THE DOCUMENTS. NO FUTURE ALLOWANCE WILL BE MADE FOR CHANGES UNLESS THE CONTRACT ADMINISTRATOR HAS BEEN NOTIFIED IN WRITING OF ANY DISCREPANCIES OR INTERFERENCES, PRIOR TO THE BID SUBMISSION DEADLINE IN ACCORDANCE WITH B4. NO ALLOWANCE WILL BE MADE FOR ITEMS WHICH SHOULD HAVE BEEN NOTIFIED.
- COORDINATE ALL WORK WITH THE CONTRACT ADMINISTRATOR, AND DO NOT BEGIN ANY WORK UNTIL ENTIRE SCOPE OF WORK IS KNOWN AND WRITTEN AUTHORIZATION IS OBTAINED.
- CONTRACTOR SHALL BE RESPONSIBLE FOR ALL ASSOCIATED WORKS RELATED TO THE REMOVAL OF EXISTING ELECTRICAL SYSTEMS AND EQUIPMENT IN THE ENTIRE BUILDING.
- OBTAIN ALL PERMITS, APPROVALS AND PAY ALL RELATED FEES REQUIRED FOR THIS DEMOLITION.
- THE REQUIREMENTS UNDER THIS SCOPE OF WORK WILL CONSIST OF THE DECOMMISSIONING AND REMOVAL OF ALL ELECTRICAL EQUIPMENT, CONDUITS, WIRES AND CABLES, ETC. THIS WORK IS TO BE PERFORMED IN A PROFESSIONAL AND SYSTEMATIC MANNER AND SHALL INCLUDE FOR THE COMPLETE COORDINATION OF DECOMMISSIONING WITH UTILITIES AS REQUIRED.
- WHERE BRACING SUPPORTS EQUIPMENT TO BE DEMOLISHED BY MORE THAN ONE TRADE, COORDINATE REMOVAL WITH THE CONTRACT ADMINISTRATOR BEFORE REMOVAL. COOPERATE WITH OTHER DEMOLITION CONTRACTORS.
- ENSURE THAT ELECTRICAL EQUIPMENT IS HANDLED AND REMOVED BY LICENSED ELECTRICIANS ONLY. ENTIRE SITE IS TO BE DE-ENERGIZED AND MADE SAFE TO THE SATISFACTION OF THE LOCAL ELECTRICAL INSPECTION AUTHORITY. DO ALL WORK IN ACCORDANCE WITH LOCAL ELECTRICAL AND BUILDING CODES, AND OBTAIN PERMITS AS REQUIRED.
- CONTACT ELECTRIC UTILITY AND TELEPHONE UTILITY AND ARRANGE FOR DISCONNECTION OF SERVICES TO THE SITE. REMOVE ALL CONDUIT, CABLES, DUCTS, DUCT BANKS, AND OTHER EQUIPMENT, AS DIRECTED BY THE UTILITIES BACK TO PROPERTY LINE.
- ONCE THE MAIN ELECTRICAL SERVICE IS DE-ENERGIZED (BY UTILITY) AND CONFIRMED AS SAFE, DISCONNECT SECONDARY CABLES, REMOVE CABLES, ALL GROUNDING CONNECTIONS, AND ASSOCIATED MATERIALS FROM EXISTING DISTRIBUTION.
- DISCONNECT AND REMOVE ALL CONDUIT AND CABLE FROM THE MAIN DISTRIBUTION SWITCHGEAR, INCLUDING ALL BRANCH CIRCUIT AND SERVICE ENTRANCE CONDUITS AND CABLES.
- ALL THE ELECTRICAL EQUIPMENT WITHIN THE DEMOLISHED AREA TO BE TURNED OVER TO THE CITY.
- SUPERVISE THE WORK AT ALL TIMES THROUGH A RESPONSIBLE AND FULLY COMPETENT SUPERVISOR.

DRAWING NOTES:

- EXISTING BUILDING TO BE DEMOLISHED. MAKE ALL PROVISIONS TO COORDINATE DISCONNECTION OF ALL EXISTING OVERHEAD AND UNDERGROUND SERVICES.
- EXISTING RINK AND SITE LIGHTING TO BE DISCONNECTED, REMOVED AND TURNED OVER TO THE CITY (REFER ALSO TO SPECIFICATIONS).

DRAWN BY: [Signature] CHECKED BY: [Signature] APPROVED: [Signature]
DATE: 2007.08.28 USER APPROVAL

CITY OF WINNIPEG
PLANNING, PROPERTY AND
DEVELOPMENT DEPARTMENT
CIVIC ACCOMMODATIONS DIVISION
300 - 65 GARRY ST. R3C 4K4

PROJECT
**BRONX PARK COMMUNITY CENTRE
HOME OF
GOOD NEIGHBOURS SENIOR CENTRE**
WINNIPEG, MB

SHEET TITLE
**ELECTRICAL
DEMOLITION SITE PLAN**

SCALE AS SHOWN PROJECT NO. PP&D 2006-065 SHEET NO. E-1.0
DRAWING SHEET SIZE: ARCH E1 (42" x 30") PLOT 1:1