

CONSTRUCTION NOTES:

- 1.) THIS SPECIFICATION WILL SUPPLEMENT THE CITY OF WINNIPEG'S STANDARD CONSTRUCTION SPECIFICATION CW 3170 - R3
- 2.) THE CONTRACTOR SHALL EXCAVATE EXISTING IN-SITE MATERIAL WITHIN THE PARKING LOT AREAS IDENTIFIED ON THE CONSTRUCTION DRAWINGS TO THE REQUIRED DEPTH TO ALLOW FOR THE SPECIFIED COMPACTED THICKNESS OF BASE AND ASPHALT
- 3.) ALL EXCESS EXCAVATED MATERIAL WILL BE REMOVED, HAULED AND DISPOSED OFF-SITE TO THE SATISFACTION OF THE CONTRACT ADMINISTRATOR.
- 4.) SITE GRADING WILL BE COMPLETED WITHIN THE LIMITS INDICATED AND TO THE DESIGN ELEVATIONS AND GRADIENTS SHOWN ON THE CONSTRUCTION DRAWINGS
- 5.) THE DESIGN GRADIENT FOR ALL AREAS WILL BE CONSIDERED TO BE STRAIGHT GRADE (I.E. TOP OF ASPHALT AND SOD)
- 6.) ELEVATIONS SHOWN ON THE CONSTRUCTION DRAWINGS ARE TO BE FINISHED GRADE (I.E. TOP OF ASPHALT AND SOD)
- 7.) ALL PLANS TO BE APPROVED BY THE CITY OF WINNIPEG WATER AND WASTE AND PUBLIC WORKS DEPARTMENTS.
- 8.) ALL GRADES TO BE CONFIRMED WITH CITY OF WINNIPEG PRIOR TO CONSTRUCTION
- 9.) DETERMINE LOCATION OF ALL UNDERGROUND UTILITIES AND OBTAIN CLEARANCES PRIOR TO CONSTRUCTION. UNDERGROUND INFORMATION IS BASED ON THE BEST INFORMATION AVAILABLE. THE CITY OF WINNIPEG MAKES NO GUARANTEE TO THE CORRECTNESS OF THE INFORMATION.
- 10.) CONTRACTOR RESPONSIBLE TO CLEAN UP SITE AFTER CONSTRUCTION. THE CONTRACTOR SHALL RESTORE ALL AREAS OF THE SITE BEYOND THE ESTABLISHED LIMIT OF WORK TO AS GOOD OR BETTER THAN THE ORIGINAL CONDITION.
- 11.) ALL ELEVATIONS BASED UPON GEODETIC ELEVATIONS. ADD 200.00 FOR ALL ELEVATIONS.

1.0 CONSTRUCTION NOTES

1. ALL CONSTRUCTION TO CONFORM WITH APPROPRIATE CITY OF WINNIPEG CONSTRUCTION SPECIFICATIONS.
2. CONTRACTOR TO OBTAIN ALL PERMITS.
3. CONTRACTOR TO CLEAR UTILITIES BEFORE EXCAVATING.
4. AUGER UNDER STREET PAVEMENT.
5. BACKFILL ALL TRENCHES IN PARKING LOTS WITH GRANULAR FILL.
6. BACKFILL IN LANDSCAPED AREAS TO BE CLASS FIVE.
7. MATERIALS

LDS: SDR-35
CATCH BASINS: 750 mm x 1.20 m WITH OPEN GRATES

2.0 DRAINAGE DESIGN NOTES

1. RATIONAL FORMULA WAS USED:
 $Q = CIA$ FOR FIVE YEAR STORM
CATCHMENT AREA (A) = 6000SM = 1.48AC
I = 20 MINUTES
I = 3.0 IN/HR

ASSUMED ALLOWABLE RUNOFF COEFFICIENT: C = 0.35
MAXIMUM ALLOWABLE OUTFLOW: 1.5 CFS (PEAK FLOW)

CALCULATED RUNOFF COEFFICIENT FOR CATCHMENT AREA IS 0.55
(REFER TO RUNOFF CALCULATION TABLE)
ORFICE SIZE REQUIRED IS 75 mm (MINIMUM SIZE)

ALL STORAGE CATCHMENT AREAS ARE CALCULATED TO CONTAIN A 25 YEAR STORM.

RUNOFF COEFFICIENT TABLE			
SURFACE	AREA	C	FRACTION
PAVEMENT	3500 SM	0.90	0.52
LANDSCAPING	2500 SM	0.10	0.01
	6000 SM		0.56

AVERAGE WEIGHTED C = 0.55 (ROUND OFF)

3.0 MISCELLANEOUS NOTES

1. TOPGRAPHIC SURVEY BY PUBLIC WORKS
2. EXISTING UTILITY INFORMATION COMPILED FROM WATER & WASTE GEO ENGINEERING DRAWING.
3. GEODETIC BENCH MARK 62-001 ELEVATION 232.121 METERS.
4. SECONDARY BENCH MARK NO #2 - TOP OF HYDRANT AS SHOWN 232.343 METERS.

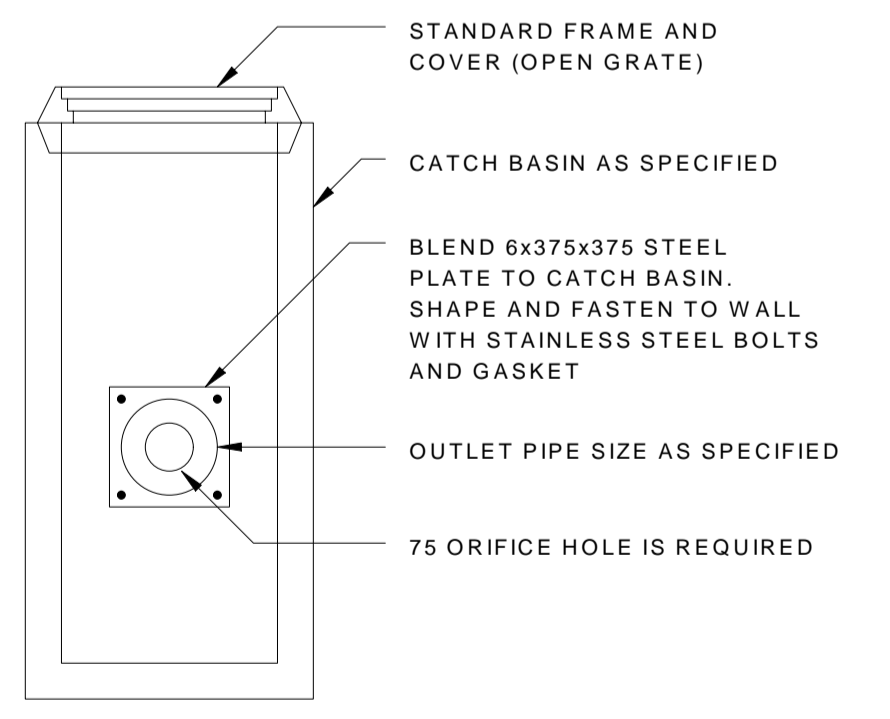

ORFICE DETAIL
N.T.S.

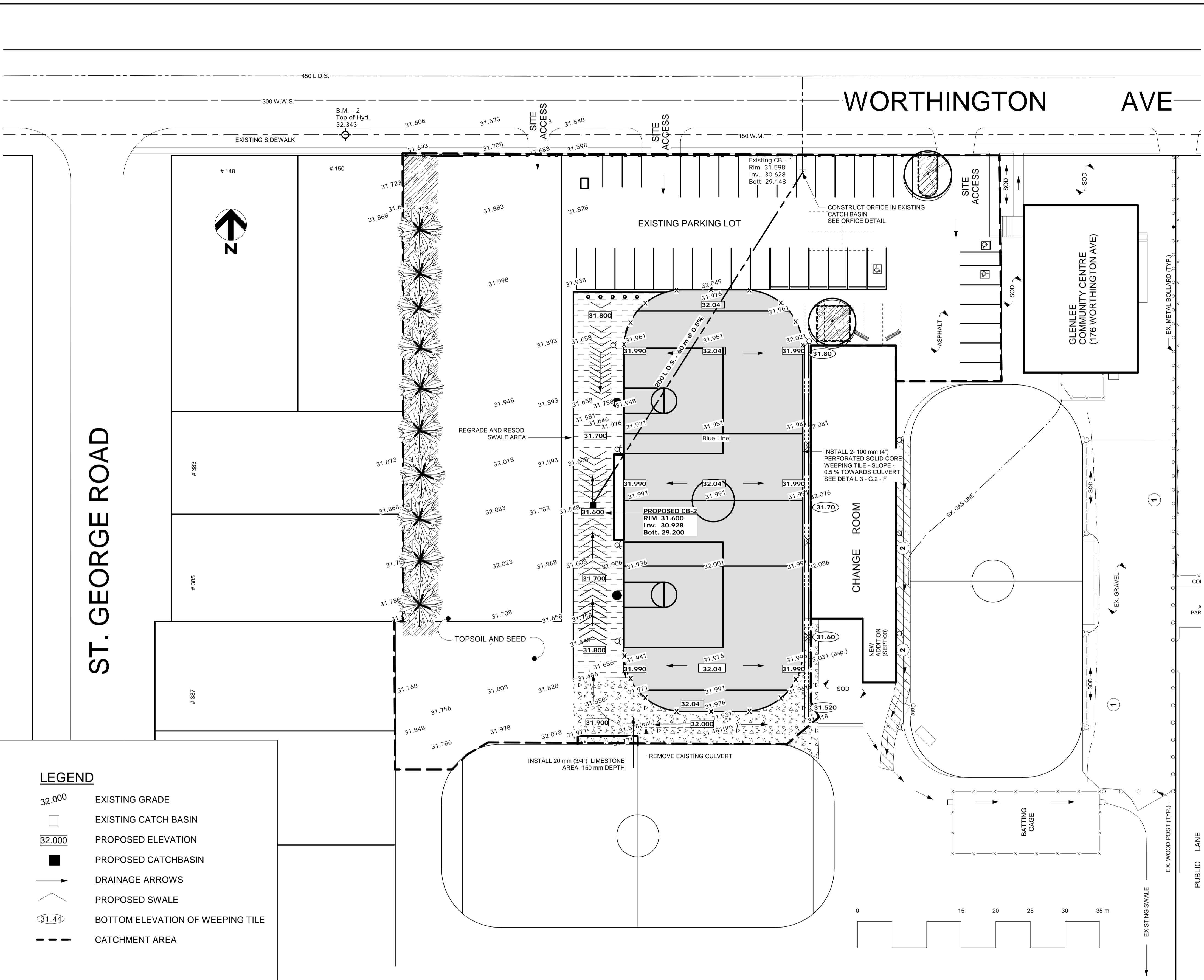

LEGEND

32.000	EXISTING GRADE
□	EXISTING CATCH BASIN
32.000	PROPOSED ELEVATION
■	PROPOSED CATCHBASIN
→	DRAINAGE ARROWS
—	PROPOSED SWALE
31.44	BOTTOM ELEVATION OF WEEPING TILE
- - -	CATCHMENT AREA

EXISTING	LEGEND - PLAN	PROPOSED	EXISTING	LEGEND - PLAN	PROPOSED	EXISTING	LEGEND - PROFILE	PROPOSED
	WATERMAIN			HYDRO			WATERMAIN	
	HYDRANT			M.T.S.			HYDRANT	
	VALVE			CONCRETE			VALVE	
	LAND DRAINAGE SEWER			ASPHALT			LAND DRAINAGE SEWER	
	WASTE WATER SEWER			PROPERTY LINE			WASTE WATER SEWER	
	MANHOLE			SURVEY BAR			MANHOLE	
	CATCH BASIN			CURB STOP			CATCH BASIN	
	CURB INLET			C.B. LEAD			CURB INLET	
	GAS			SIDEWALK			GAS	
				ELEVATIONS				
				SIDEWALK RAMP				

LOCATION APPROVED UNDERGROUND STRUCTURES

SUPV. U/G STRUCTURES COMMITTEE DATE

NOTE:
LOCATION OF UNDERGROUND STRUCTURES AS SHOWN ARE BASED ON THE BEST INFORMATION AVAILABLE BUT NO GUARANTEE IS GIVEN THAT ALL EXISTING UTILITIES ARE SHOWN OR THAT THE GIVEN LOCATIONS ARE EXACT. CONFIRMATION OF EXISTENCE AND EXACT LOCATION OF ALL SERVICES MUST BE OBTAINED FROM THE INDIVIDUAL UTILITIES BEFORE PROCEEDING WITH CONSTRUCTION.

B.M. ELEV.	G.B.M. - 62-001	232.121
NO.	REVISIONS	DATE BY

THIS DRAWING SHALL NOT BE USED FOR CONSTRUCTION PURPOSES UNTIL SIGNED BELOW.

THE CONTRACTOR SHALL CHECK ALL DIMENSIONS AND OTHER DATA ON SITE AND REPORT ANY DISCREPANCIES TO THE CONTRACT ADMINISTRATOR.

FIGURED DIMENSIONS TO BE TAKEN IN PREFERENCE TO SCALED DIMENSIONS.

DESIGNED BY	J.F.	CHECKED BY	J.K.	RELEASED FOR CONSTRUCTION
DRAWN BY	J.F.	APPROVED BY	J.K.	DATE
HORI. SCALE	1:300	MANAGER,	PARKS AND OPEN SPACE	DATE
VERT. SCALE		DIRECTOR OF PLANNING,	PROPERTY AND DEVELOPMENT DEPARTMENT	DATE
DATE	February 2007			

ENGINEER'S SEAL

CONSULTANT DRAWING (016178)

THE CITY OF WINNIPEG
Planning, Property and Development Department
Planning and Land Use Division
Unit 15 - 30 Fort Street, Winnipeg, Manitoba R3C 4X5

DRAWING TITLE
Glenlee Community Center
Grading and Land Drainage Plan
176 Worthington Avenue

CAD DRAWING NO.
SHEET 2 OF 4
DRAWING NO.
G.2 - E