

STRA

CORDOVA

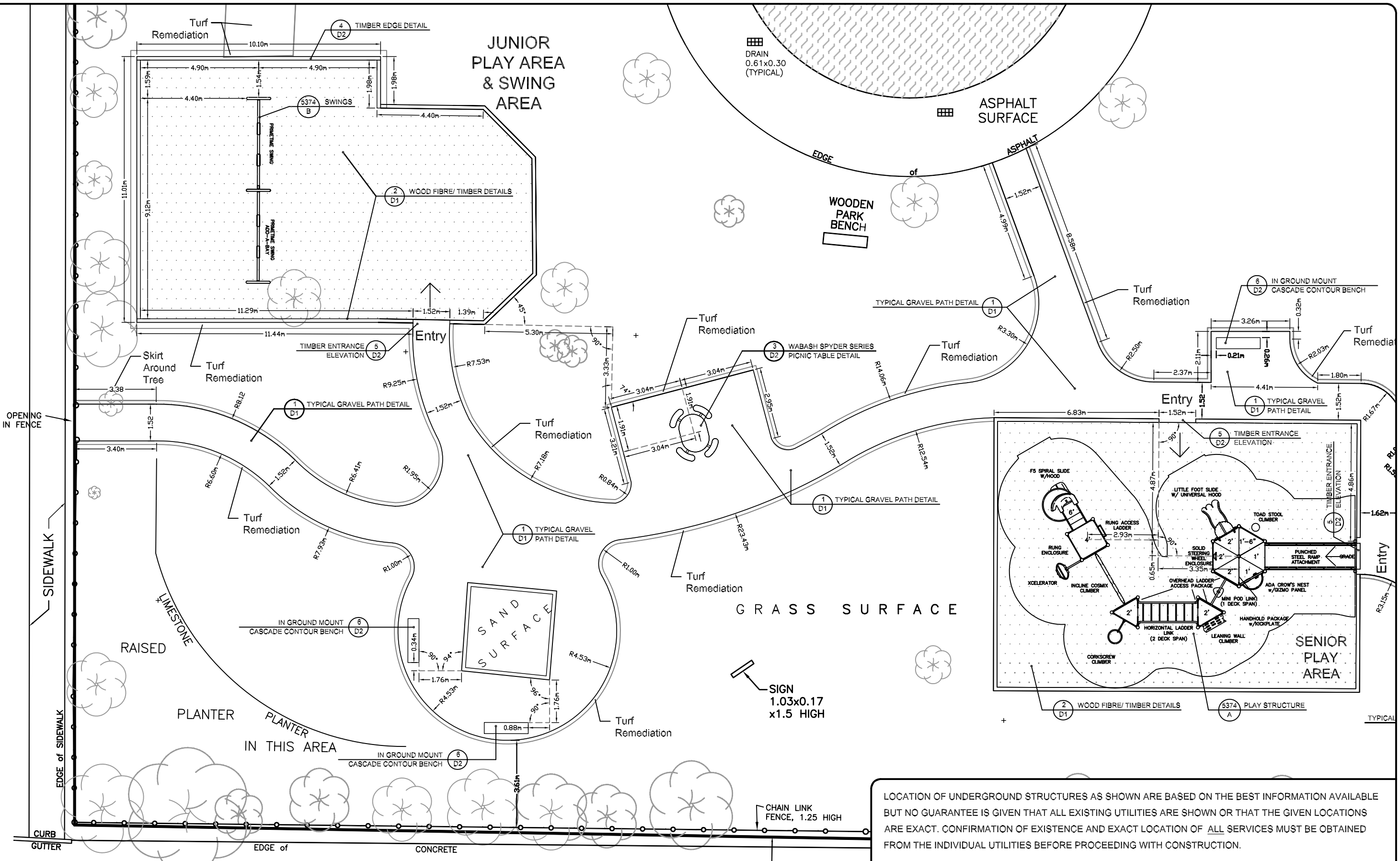

LOCATION OF UNDERGROUND STRUCTURES AS SHOWN ARE BASED ON THE BEST INFORMATION AVAILABLE BUT NO GUARANTEE IS GIVEN THAT ALL EXISTING UTILITIES ARE SHOWN OR THAT THE GIVEN LOCATIONS ARE EXACT. CONFIRMATION OF EXISTENCE AND EXACT LOCATION OF ALL SERVICES MUST BE OBTAINED FROM THE INDIVIDUAL UTILITIES BEFORE PROCEEDING WITH CONSTRUCTION.



THE CITY OF WINNIPEG
 Planning, Property and Development Department
 Planning and Land Use Division
 Unit 15 - 30 Fort Street, Winnipeg, MB, (R3C 4X5)

DESIGNED BY	RC	CHECKED BY	APPROVED BY
DRAWN BY	RC	RELEASED FOR CONSTRUCTION	
HORIZ. SCALE	1 : 150		
VERT. SCALE			
DATE	OCT. 15 /07	MANAGER, PLANNING AND LAND USE DIVISION	DATE

DRAWING TITLE
**CORDOVA PARK PLAYGROUND
 RENOVATIONS - JUNIOR AREA
 LAYOUT PLAN**

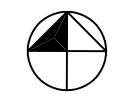

CAD DRAWING NO.
 DRAWING NO.
109/07-L2