

ALLEY PAVEMENT PROFILE

SCALE: 1:250 HOR
1:10 VER

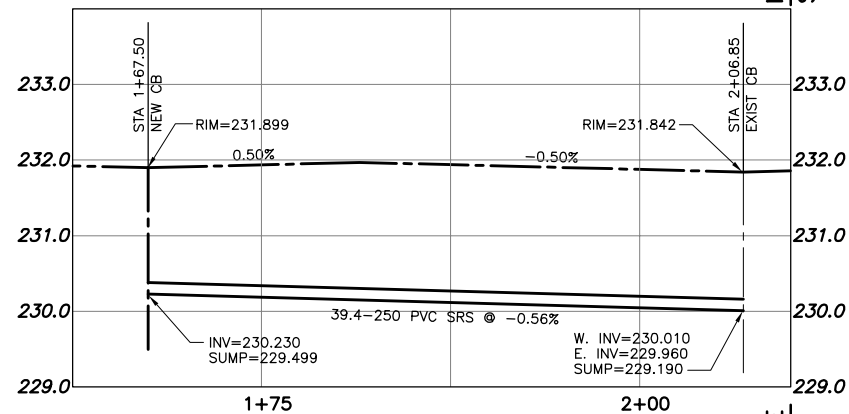

CATCH BASIN & CATCH BASIN LEAD PROFILE

SCALE: 1:250 HOR
1:50 VER

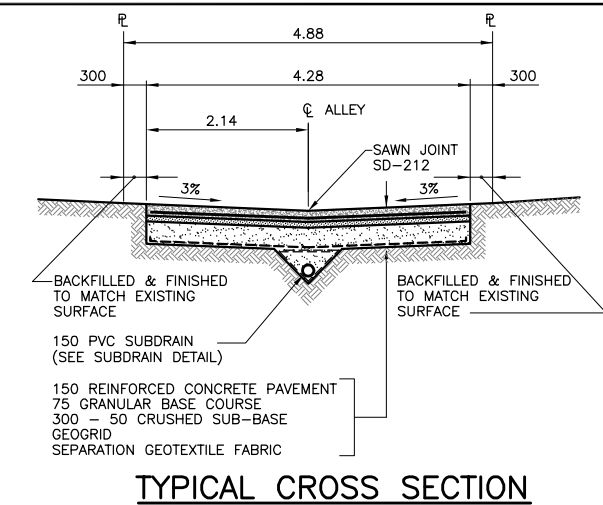

TYPICAL CROSS SECTION

SCALE: 1:50

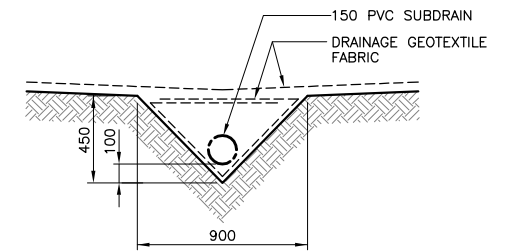

SUBDRAIN DETAIL

SCALE: 1:20

NOTE:

1. STATION CHAINAGE IS BASED ON CENTERLINE OF ALLEY RIGHT OF WAY.
2. ADJUST MH AND CB RIMS TO NEW GRADES.
3. PLUG SUBDRAINS AT TERMINAL ENDS.
4. REGRADE EXISTING PRIVATE SIDEWALKS AS REQUIRED.
5. INSTALLATION OF LIP CURBS AND THEIR EXTENTS TO BE DETERMINED BY THE CONTRACT ADMINISTRATOR.
6. LIGHT STANDARDS, HYDRO POLES AND ANCHORS MAY REQUIRE TEMPORARY SUPPORT/REMOVAL OR REPLACEMENT AT THE CONTRACTOR'S EXPENSE.
7. ISOLATE ALL POLES, BASES AND PILES WITHIN ALLEY RIGHT OF WAY (SD-228C).
8. AVOID DAMAGE TO EXISTING TREES WITHIN THE LIMITS OF CONSTRUCTION.

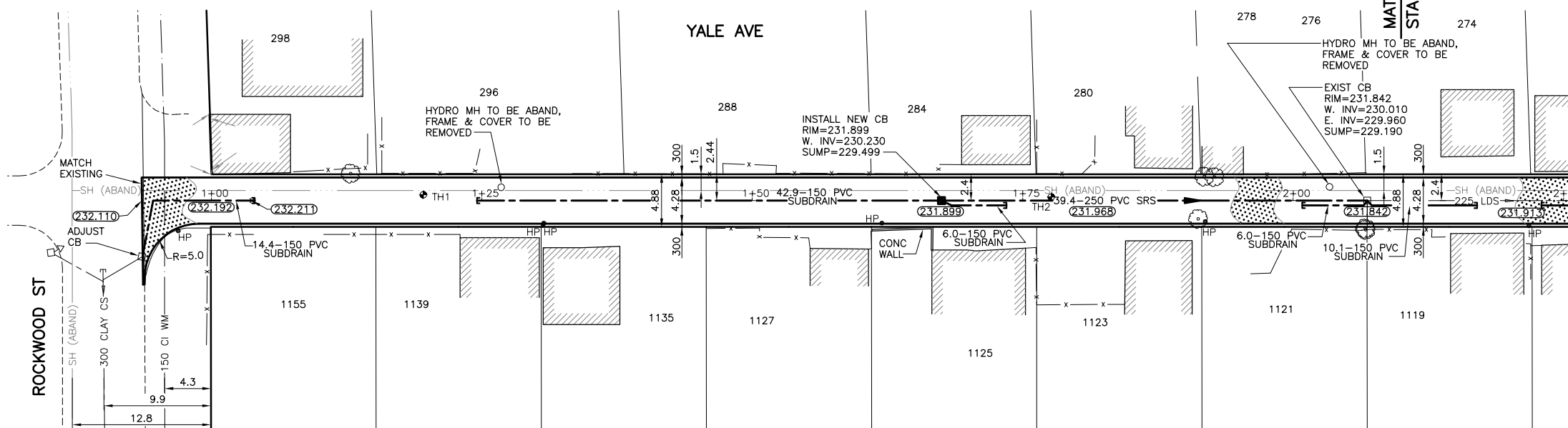

GROSVENOR AVE ALLEY PAVEMENT PLAN

SCALE: 1:250 HOR

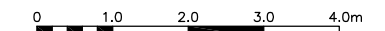

SCALE: 1:50 METRIC A1
1:100 METRIC A3

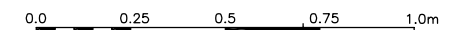

SCALE: 1:10 METRIC A1
1:20 METRIC A3



SCALE: 1:250 METRIC A1
1:500 METRIC A3

METRIC
WHOLE NUMBERS INDICATE MILLIMETRES
DECIMALIZED NUMBERS INDICATE METRES

WARNING

IF POWER EQUIPMENT OR EXPLOSIVES ARE TO BE USED FOR EXCAVATION ON THIS PROJECT THE CONTRACTOR MUST:
1) NOTIFY THE GAS COMPANY OF THE PROPOSED LOCATION OF EXCAVATION.
2) TAKE PRECAUTION TO AVOID DAMAGE TO GAS COMPANY INSTALLATIONS.
SEE PROVINCIAL REGULATION 210/72 FOR DETAILS.



Certificate of Authorization
KGS Group

No. 245 Expiry: April 30, 2007

300 LBS	LAND DRAINAGE SEWER	300 LBS		TEST HOLE			
250 WWS	WASTE WATER SEWER	250 WWS	+	GUY WIRE			
---	GAS	---	+	LIGHT STANDARD			
---	HYDRO	---	+	BACK OF CURB			
---	M.T.S.	---	+	CONCRETE			
150 WM	WATERMAIN	150 WM	+	ASPHALT			
+	HYDRANT	+	+	SIDEWALK			
+	VALVE	+	+	PROPERTY LINE			
+	MANHOLE	+	+	SURVEY BAR			
+	CATCH BASIN	+	+	GEODETIC BENCHMARK			
+	CURB INLET	+	+	ELEVATION			
+	POLES	+	+				
EXISTING	LEGEND-PLAN	PROPOSED	EXISTING	LEGEND-PLAN	PROPOSED	EXISTING	LEGEND-PROFILE

LOCATION APPROVED UNDERGROUND STRUCTURES

SUPV. U/G STRUCTURES DATE COMMITTEE

NOTE:
LOCATION OF UNDERGROUND STRUCTURES AS SHOWN ARE BASED ON THE BEST INFORMATION AVAILABLE BUT NO GUARANTEE IS GIVEN THAT ALL EXISTING UTILITIES ARE SHOWN OR THAT THE GIVEN LOCATIONS ARE EXACT. CONFIRMATION OF EXISTENCE AND EXACT LOCATION OF ALL SERVICES MUST BE OBTAINED FROM THE INDIVIDUAL UTILITIES BEFORE PROCEEDING WITH CONSTRUCTION.

B.M. 52-039
ELEV. 232.480m

S.W. COR. GROSVENOR AVE. & WILTON ST.,
TRIAL, IN N. CONG. WALL OF ST. GEORGE'S
ANGLICAN CHURCH, NO. 1118 GROSVENOR
AVE., 1.0m E. & 0.5m BELOW TYPICAL STONE
OF N.W. COR. OF CHURCH.

KGS GROUP
CONSULTING ENGINEERS & PROJECT MANAGERS
WINNIPEG (204) 896-1209
THUNDER BAY (807) 345-2233

DESIGNED BY	RO	CHECKED BY	CR
DRAWN BY	DW	APPROVED BY	
HOR. SCALE:	1:250	RELEASED FOR CONSTRUCTION:	
VERTICAL:	1:50	DATE	05/01/07
NO. REVISIONS		DATE	

ENGINEER'S SEAL

ORIGINAL SIGNED BY
M.C. ROWBOTHAM
FEB 07/2007

CONSULTANT DRAWING NO.
06-0107-18

THE CITY OF WINNIPEG
PUBLIC WORKS DEPARTMENT
ENGINEERING SERVICES DIVISION

PROJECT TITLE
2007 ALLEY RENEWAL PROGRAM
YALE AVE/GROSVENOR AVE ALLEY
ROCKWOOD ST TO WILTON ST
STA. 0+93.68 TO STA. 2+10

SHEET **08** OF **09**
COMPUTER FILE NAME
06-0107-18
CITY DRAWING NUMBER
0008

P:\PROJECTS\2006\06-0107-18\MUN\DWGS\YALE\DWG\YALE_ALLEY-PLAN-DWG
PLOT 1:1 A-1