

**GENERAL NOTES**

- SITE PLAN DRAWING E-1.0 SHALL BE READ IN CONJUNCTION WITH ELECTRICAL DRAWINGS E-2.0 THROUGH E-8.0.
- ALL BUILDING OPERATIONS WILL CONTINUE DURING RENOVATION WORK. INCLUDE ALL ALLOWANCES NECESSARY TO COMPLETE INSTALLATION OF NEW EQUIPMENT PRIOR TO DEMOLISHING OR DISCONNECTING EQUIPMENT ESSENTIAL FOR DEPARTMENT OPERATIONS.
- ELECTRICAL SUBCONTRACTOR SHALL COORDINATE ALL DEMOLITION WORK WITH THE CONTRACTOR IN EXISTING AREAS.
- ALL EXISTING SYSTEMS/EQUIPMENT/DEVICES REQUIRING DISCONNECTION TO FACILITATE DEMOLITION SHALL BE RECONNECTED AND RETURNED TO FULLY OPERATIONAL CONDITION.
- ELECTRICAL SUBCONTRACTOR TO PROVIDE FOR AND SUBMIT PLAN OF TEMPORARY POWER PROVISIONS AND COORDINATE ANY SHUTDOWNS WITH THE CONTRACTOR AND THE CONTRACT ADMINISTRATOR ON SITE.
- ELECTRICAL SUBCONTRACTOR TO LOCATE/RELOCATE EXISTING SERVICES AS REQUIRED TO SUIT EXPANSION.

**DRAWING NOTES:**

- EXISTING ELECTRIC UTILITY POLE, TRANSFORMER, O/H LINES, TELEPHONE LINES, ETC. TO BE DISCONNECTED AND REMOVED AFTER THE NEW MAIN DISTRIBUTION AND NEW TELEPHONE LINE INSTALLATION IS IN-PLACE. CONTRACTOR SHALL MAKE ALL PROVISIONS TO COORDINATE WITH OWNER AND UTILITIES FOR PROPER DEMOLITION PHASING.
- MAKE ALL PROVISIONS TO DISCONNECT, REMOVE AND DISPOSE FROM SITE EXISTING LAMP STANDARDS.
- PROVIDE 2" CONDUIT FROM NEW MAIN TELEPHONE BACKBOARD TO EXISTING TELEPHONE BACKBOARD. PROVIDE ALL REQUIRED BACKBONE TELEPHONE/TELEVISION CABLES BETWEEN THE NEW TELEPHONE/TELEVISION BACKBOARD AND EXISTING TELEPHONE/TELEVISION BACKBOARD. COORDINATE WITH TELEPHONE/TELEVISION UTILITIES FOR ALL REQUIREMENTS TO RE-CONNECT THE EXISTING TELEPHONE/TELEVISION SYSTEM IN THE EXISTING BUILDING.
- E.C. SHALL REFER TO MECH. DWGS, ARCHITECTURAL SITE PLAN & SURVEY PLAN FOR LOCATIONS OF BURIED LINES. COORDINATION IS REQUIRED. CONFIRM ALL U/C SERVICES AND LINES ON SITE WITH APPROPRIATE UTILITIES. THIS DRAWING IS SCHEMATIC, SHALL BE USED AS A REFERENCE ONLY AND MAY NOT INDICATE EVERY BURIED LINE, PIPE OR CONDUCTOR.
- MAKE ALL PROVISIONS TO COORDINATE WITH MTS/SHAW TO REMOVE THE TELEPHONE/TELEVISION CABLES AND INSTALL AT THEIR NEW LOCATION.
- EXISTING RINK LIGHTING TO BE DISCONNECTED, REMOVED FROM SITE AND SALVAGED OR DISPOSED OF.

**DRAWING LIST**

E-10	ELECTRICAL SITE PLAN
E-20	ELECTRICAL DEMOLITION PLAN
E-30	ELECTRICAL LIGHTING LAYOUT
E-40	ELECTRICAL POWER & SYSTEMS LAYOUT
E-50	ELECTRICAL DETAILS
E-60	ELECTRICAL SCHEDULES
E-70	ELECTRICAL SINGLE LINE DIAGRAM
E-80	ELECTRICAL SPECIFICATIONS

**LEGEND**

CA	STRIP FLUORESCENT LIGHT (CA DENOTES TYPE)	⊕	DUPLEX RECEPTACLE - CEILING MOUNTED	⊞	FUSED DISCONNECT SWITCH
A	1'x4' FLUORESCENT LIGHT (A DENOTES TYPE)	⊕	DUPLEX RECEPTACLE	⊞	MOTOR AND DISCONNECT
⊙	H.I.D. OR INCANDESCENT FIXTURE (C DENOTES TYPE)	⊕	DUPLEX RECEPTACLE - ABOVE COUNTER (GFCI)	⊞	BASEBOARD HEATER (1000 DENOTES 1000 WATTS)
⊙	WALL MOUNTED LIGHT FIXTURE (D DENOTES TYPE)	⊕	DUPLEX RECEPTACLE - GROUND FAULT CIRCUIT INTERRUPTER	⊞	FORCE FLOW HEATER
⊕	LIGHT STANDARD (C DENOTES TYPE)	⊕	MOTION DETECTOR	⊞	UNIT HEATER
⊕	LIGHT STANDARD (2 DENOTES LAMP COUNT)	⊕	JUNCTION BOX CEILING MOUNTED	⊞	THERMOSTAT
⊕	LIGHT FIXTURE ON NIGHT LIGHT CIRCUIT	⊕	120V JUNCTION BOX WALL MOUNTED	⊞	SPEED CONTROL SWITCH
⊕	EMERGENCY LIGHT (REMOTE - 2 HEADS)	⊕	DOOR OPERATING CONTROL PUSH BUTTON	⊞	SMOKE DETECTOR (ADDRESSABLE)
⊕	EXIT LIGHT C/W DIRECTIONAL ARROWS AS SHOWN	⊕	DIRECT CONNECT	⊞	HEAT DETECTOR (COMBINATION)
⊕	EMERGENCY BATTERY BANK UNIT C/W HEAD LIGHTS	⊕	POWER PANELBOARD - SURFACE MOUNT/FLUSH MOUNT	⊞	MANUAL PULL STATION
⊕	SINGLE POLE SWITCH (3 DENOTE 3 WAY SWITCH)	⊕	SYSTEM PANELBOARD - SURFACE MOUNT/FLUSH MOUNT	⊞	FIRE ALARM SIGNAL HORN & STROBE
⊕	MOTION SENSOR SWITCH (WALL MOUNTED)	⊕	TRANSFORMER	⊞	SIGNAL HORN
⊕	DIMMER SWITCH	⊕	TELEPHONE BACKBOARD	⊞	SPRINKLER FLOW SWITCH
⊕	PUSH BUTTON	⊕	VOICE/DATA OUTLET	⊞	SPRINKLER TAMPER PROOF VALVE
⊕	TIMECLOCK	⊕	DOOR CONTACT (FLUSH IN FRAME)	⊞	EXISTING TO BE REMOVED/RELOCATED
⊕	NURSE CALL SYSTEM DOME LIGHT	⊕	WIRE GUARD	⊞	EXISTING TO REMAIN
⊕	PUBLIC ADDRESS SYSTEM SPEAKER	⊕	GLASS BREAK DETECTOR	⊞	RELOCATED EXISTING (SHOWN IN NEW LOCATION)

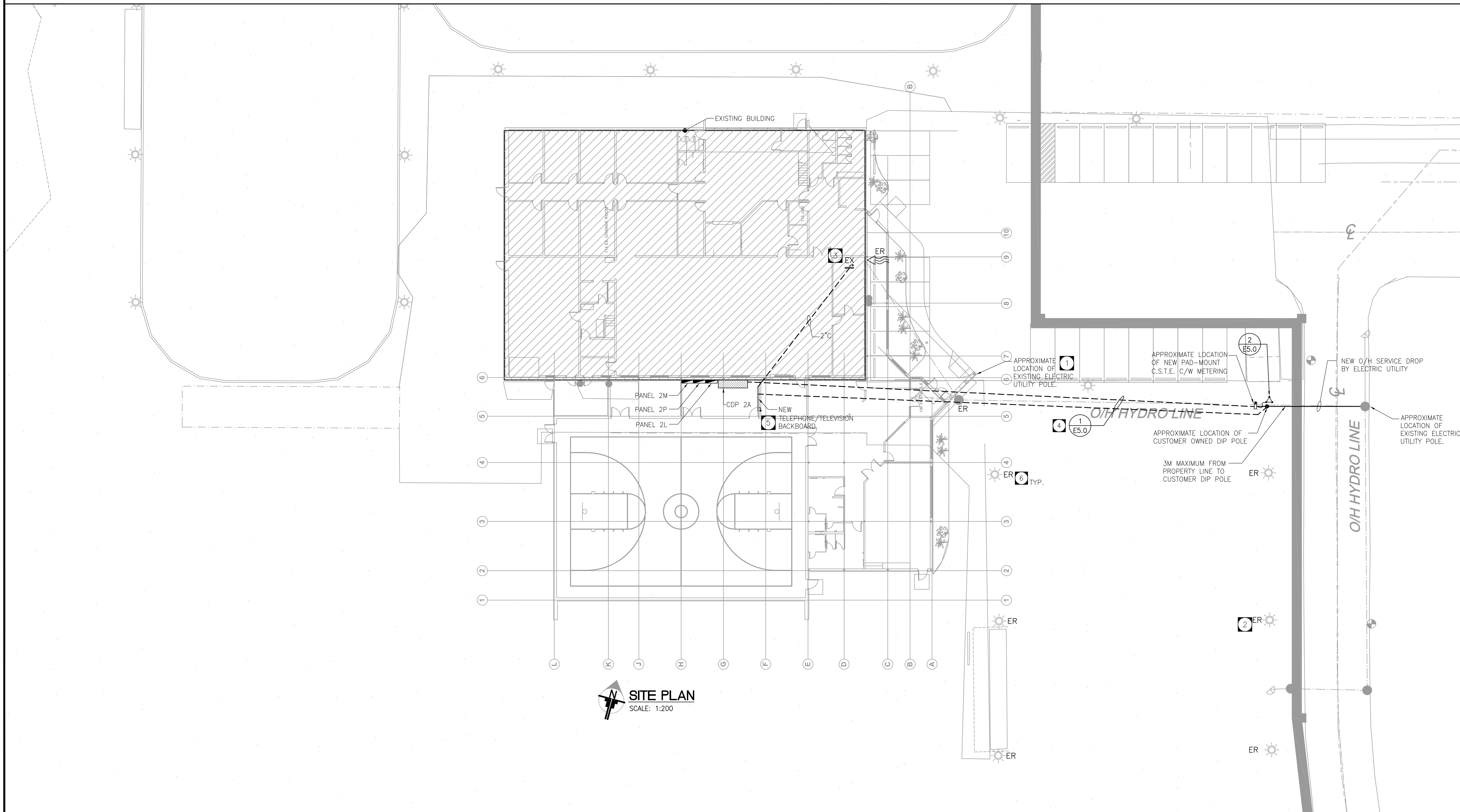

4	GENERAL REVISION	04/08/08	TT
3	ISSUED FOR BID OPPORTUNITY	03/27/08	TT
2	ISSUED FOR 90% REVIEW	02/12/08	TT
1	ISSUED FOR 75% REVIEW	01/22/08	TT
0	ISSUED FOR 50% REVIEW	10/05/07	TT

THIS DRAWING IS THE EXCLUSIVE PROPERTY OF THE ARCHITECT AND CAN BE REPRODUCED ONLY WITH THE PERMISSION OF THE ARCHITECT IN WHICH CASE THE REPRODUCTION MUST BEAR THE NAME OF THE ARCHITECT.

THIS DRAWING SHALL NOT BE SCALED. FOLLOW GIVEN DIMENSIONS ONLY.

THE CONTRACTOR SHALL SATISFY HIMSELF THAT ALL DIMENSIONS AND INFORMATION SHOWN ARE CORRECT.

PRIOR TO COMMENCEMENT OF WORK REPORT ANY DISCREPANCIES TO THE ARCHITECT.

VARIATIONS AND MODIFICATIONS TO WORK SHOWN WILL NOT BE ALLOWED WITHOUT WRITTEN PERMISSION OF THE ARCHITECT.

CONSULTANT TOWER PROJECT NO. : 6174

**TOWER ENGINEERING GROUP INC.**  
 208 - 897 CORYDON AVE. WINNIPEG, MB R3M 0W7  
 TEL: (204) 925-1150 FAX: (204) 925-1155  
 EMAIL: towereng@towereng.ca WEB: www.towereng.ca

**APEGN**  
 Certificate of Authorization  
 Tower Engineering Group  
 No. 1918 Expiry: April 30, 2008

**CALNITSKY ASSOCIATES ARCHITECTS**

ARCHITECTURE 124 Nassau Street North Tel: (204) 453-6441 E-mail: caa@escape.ca  
 INTERIOR DESIGN Winnipeg, Manitoba R3L 2H1 Fax: (204) 453-3392

PROJECT TITLE  
**NORBERRY-GLENLEE COMMUNITY CENTRE EXPANSION**  
 26 MOLGAT AVENUE WINNIPEG, MB

SHEET TITLE  
 ELECTRICAL SITE PLAN

DRAWN BY	SCALE	SHEET NUMBER
DR	AS NOTED	E-1.0
CHECKED BY	DATE	
TT	04/08/08	
PROJECT NUMBER	REVISION	
06-017	4	