

1 PARTIAL PLAN - ADMINISTRATION (SECOND FLOOR LEVEL)
WB-B0129 1:100

2 PARTIAL PLAN - DAF INFLUENT GALLERY (SECOND FLOOR LEVEL)
WB-B0129 1:100

NOTE: SEE DRAWING WB-B0353 FOR INTERIOR DETAILS OF THIS AREA

WALL TYPES:

- W1 EXIST CAST-IN-PLACE CONCRETE TYPICAL, UNLESS NOTED
- W2 CMU 290mm
- W3 CMU 240mm
- W4 CMU 190mm
- W5 CMU 140mm
- W6 CMU 90mm
- W6BD CMU 90mm BURNISHED
CMU 90mm BURNISHED (DUAL WHYTE - BACK TO BACK)
- W7 FROM FIN FLOOR TO 1200mm AFF: CMU 90mm BURNISHED
13mm FURRING BAR @ 400mm O/C
13mm GYP BD - PT
FROM 1200mm AFF TO U/S OF CONCRETE SLAB - WALL TYPE WB
- WB 13mm GYP BD - PT
92mm STEEL STUDS @ 400mm O/C
13mm GYP BD - PT
ACOUSTICAL BATT INSULATION
ACOUSTICAL CAULK ON TOP & BOT PLATE
- W2B CMU 290mm BURNISHED
- W3A 240mm CMU AIR SPACE
92mm METAL STUDS
13mm GYP BD-PT
- W4B CMU 190mm BURNISHED
- W5B CMU 140mm BURNISHED
- W6B CMU 90mm BURNISHED

FIRE RATINGS:

- 1 HR FIRE RATING
- 2 HR FIRE RATING

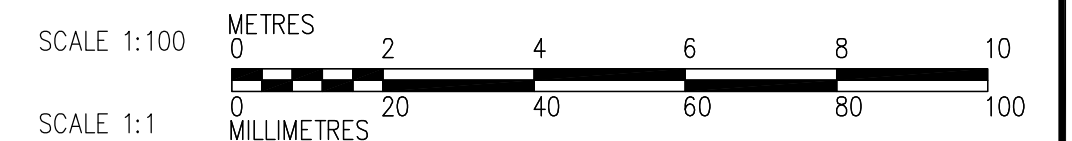
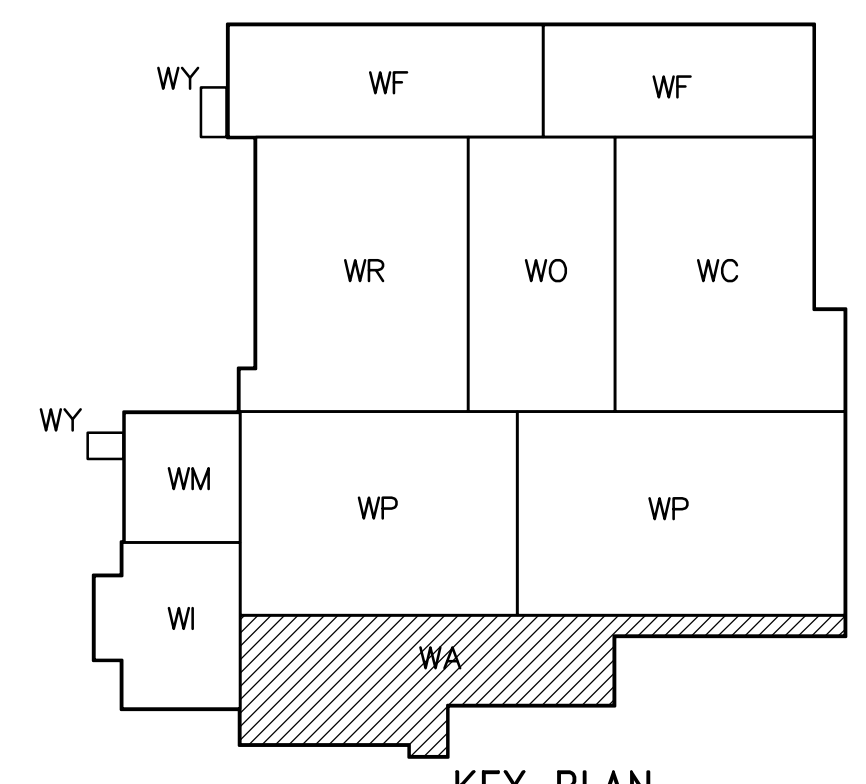

B.M. ELEV.		CH2MHILL Frederickson Cooper ARCHITECTS		EarthTech A Total International Ltd. Company		ENGINEER'S SEAL ORIGINAL SIGNED BY NEIL COOPER 2007/06/05	
DESIGNED BY	TWS	CHECKED BY	BJS	APPROVED BY	AHL	CONSULTANT DRAWING NO.	WB-B0129
DRAWN BY	SH/LK/AL	RELEASED FOR CONSTRUCTION BY:	R. SOROKOWSKI	DATE	2007/06/05		
SCALE:	1:100	DATE	2005/08/03				
ISSUED FOR TENDER	07/06/05						
NO. REVISIONS	DATE	BY	DATE	2005/08/03	DATE	2007/06/05	

THE CITY OF WINNIPEG
WATER AND WASTE DEPARTMENT
ENGINEERING DIVISION

WATER TREATMENT PLANT
MAIN BUILDING
OFFICE AND PLANT INTERIOR FINISHES

ARCHITECTURAL
PARTIAL PLAN OF ADMINISTRATION
& DAF INFLUENT GALLERY (ELEV. 242.500)

CITY FILE NUMBER
SHEET OF
CITY DRAWING NUMBER
1-0601B-A-B0129-001-03D