

SECOND FLOOR PLAN
1:100

NOTES:

1. WALLS AND PARTITIONS SHOWN ON THIS DRAWING INDICATE GENERAL WALL LOCATIONS. CONFIRM AND VERIFY EXACT WALL LOCATIONS AS SHOWN ON THE ARCHITECTURAL DRAWINGS.
2. ALL CURBS AND DOWELS FOR CMU WALLS ARE IN THE SCOPE OF BO 583-2005.
3. FOR WALL CONTROL JOINTS SEE ARCHITECTURAL DRAWINGS.
4. SEE DETAIL **2** FOR OPENING REINFORCING.
5. FOR CMU OPENINGS SEE ARCHITECTURAL, MECHANICAL AND ELECTRICAL DRAWINGS.
6. USE NO.9 ASWG@400 JOINT REINFORCEMENT.
7. FOR STAIRS AND HANDRAILS TO PLATFORMS AT ALL LEVELS SEE ARCHITECTURAL DRAWINGS.
8. COORDINATE ALL FABRICATION WITH BO 742-2005 CONTRACTOR.

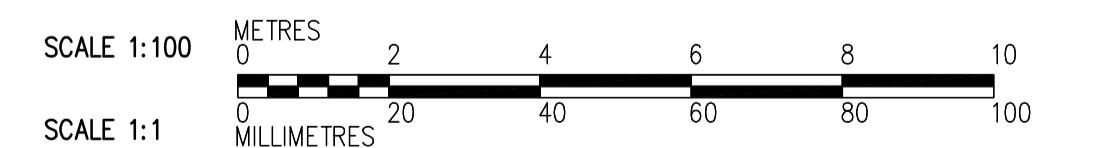
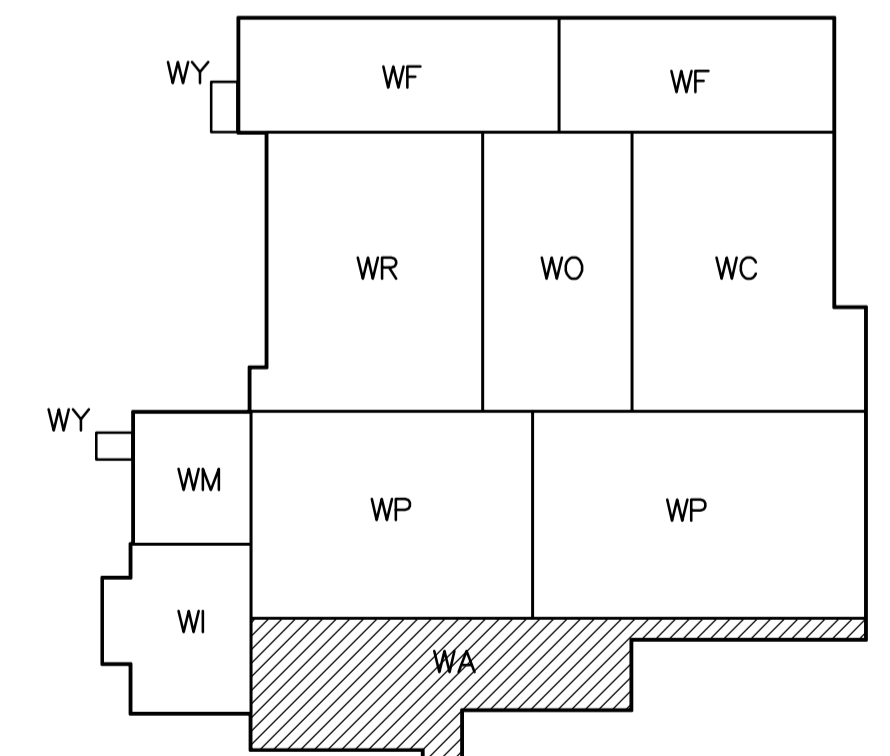

 Certificate of Authorization CH2M HILL Canada Ltd. No. 1441 Expiry: April 30, 2008	B.M. ELEV.	 Frederickson Cooper ARCHITECTS	 A Tyco International Ltd. Company	ENGINEER'S SEAL	 THE CITY OF WINNIPEG WATER AND WASTE DEPARTMENT ENGINEERING DIVISION	WATER TREATMENT PLANT ADMINISTRATION OFFICE AND PLANT INTERIOR FINISHES	CITY FILE NUMBER		
				DESIGNED BY: MH			CHECKED BY: AP	ORIGINAL SIGNED BY: C. MILITANO	SHEET OF
				DRAWN BY: CR			APPROVED BY: AHL	2007/06/05	CITY DRAWING NUMBER
				SCALE: 1:100			RELEASED FOR CONSTRUCTION BY: R. SOROKOWSKI	CONSULTANT DRAWING NO. WA-S4121	1-0601A-A-S4121-001-000
	NO. REVISIONS	DATE	BY	DATE	STRUCTURAL ADMINISTRATION AREA SECOND FLOOR PLAN				
	00	ISSUED FOR TENDER	07/06/05	MH	DATE	2007/06/05	DATE	2007/05/06	