

1 PARTIAL PLAN - DAF INFLUENT GALLERY (LOWER LEVEL)  
WB-B0106 1:100

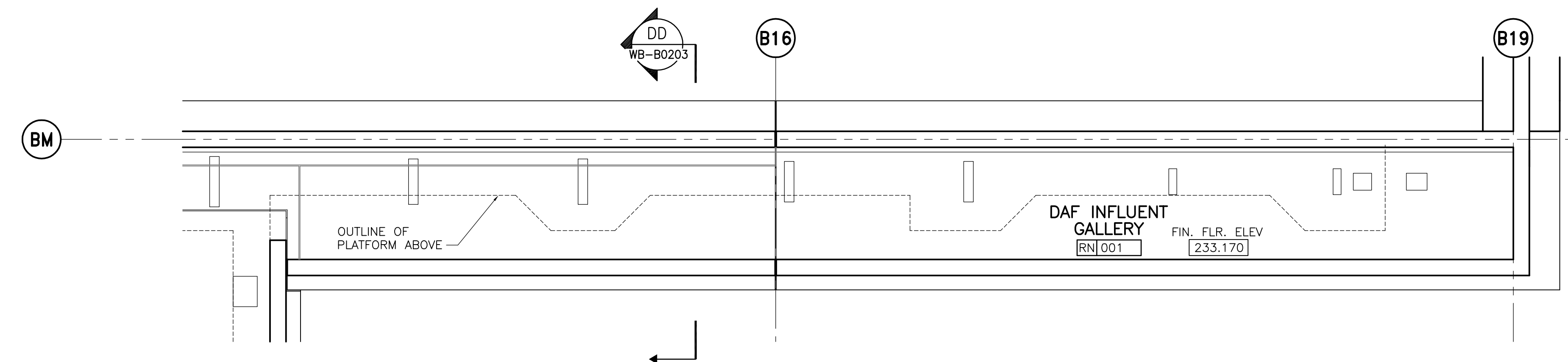

2 PARTIAL PLAN - DAF INFLUENT GALLERY (LOWER LEVEL)  
WB-B0106 1:100

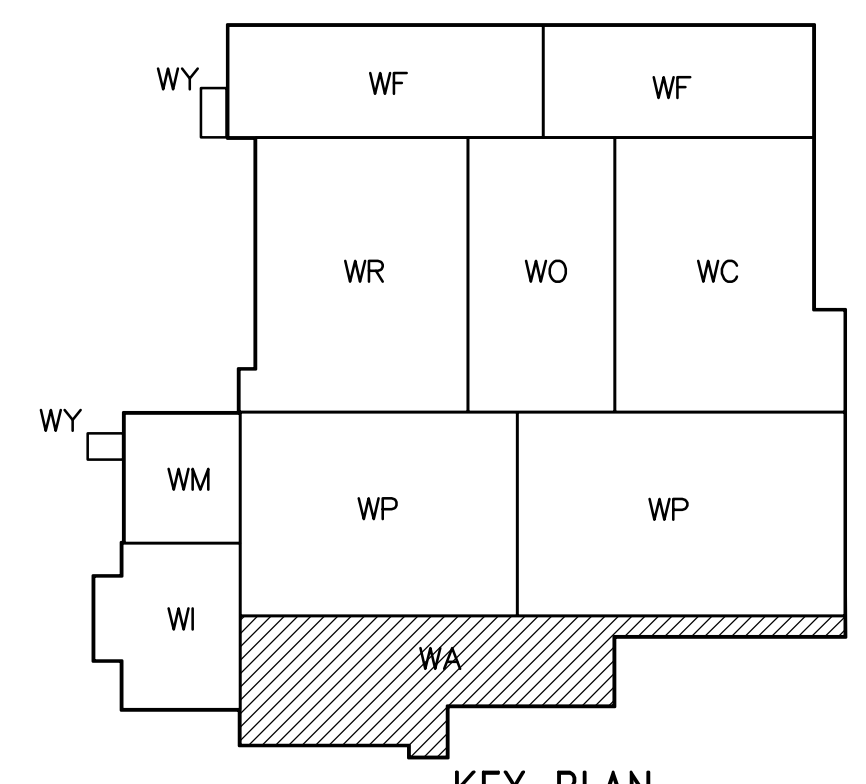

KEY PLAN

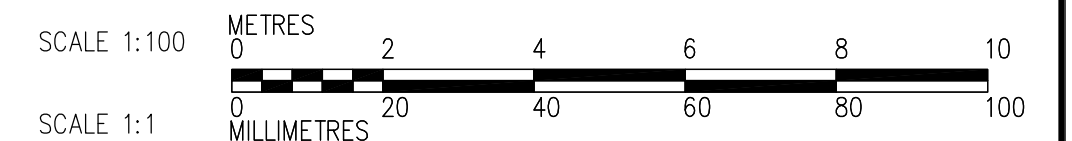

B.M. ELEV.			
DESIGNED BY	TWS	CHECKED BY	BJS
DRAWN BY	SH/LK/AL	APPROVED BY	AHL
SCALE:	1:100	RELEASED FOR CONSTRUCTION BY:	R. SOROKOWSKI
00 ISSUED FOR TENDER	07/06/05	DATE	2005/08/03
NO. REVISIONS	DATE	BY	DATE

 	 <small>A Tyco International Lic. Company</small>
DESIGNED BY: TWS DRAWN BY: SH/LK/AL SCALE: 1:100	CHECKED BY: BJS APPROVED BY: AHL RELEASED FOR CONSTRUCTION BY: R. SOROKOWSKI
DATE: 2005/08/03	DATE: 2007/06/05

ENGINEER'S SEAL  
ORIGINAL SIGNED BY  
NEIL COOPER  
2007/06/05  
CONSULTANT DRAWING NO.  
WB-B0106

**THE CITY OF WINNIPEG**  
 WATER AND WASTE DEPARTMENT  
 ENGINEERING DIVISION

WATER TREATMENT PLANT  
 MAIN BUILDING  
 OFFICE AND PLANT INTERIOR FINISHES

ARCHITECTURAL  
 PARTIAL PLAN OF DAF INFLUENT GALLERY  
 (ELEV. 233.500)

CITY FILE NUMBER  
 SHEET OF  
 CITY DRAWING NUMBER  
**1-0601B-A-B0106-001-000**