

- WALL TYPES:**
- W3 CMU 240mm
- FIRE RATINGS:**
- 2 HR FIRE RATING (indicated by diagonal hatching)
  - 1 HR FIRE RATING (indicated by solid black fill)

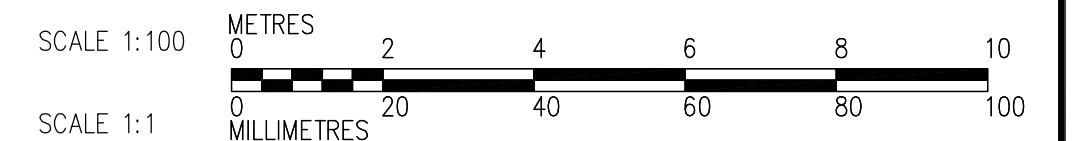
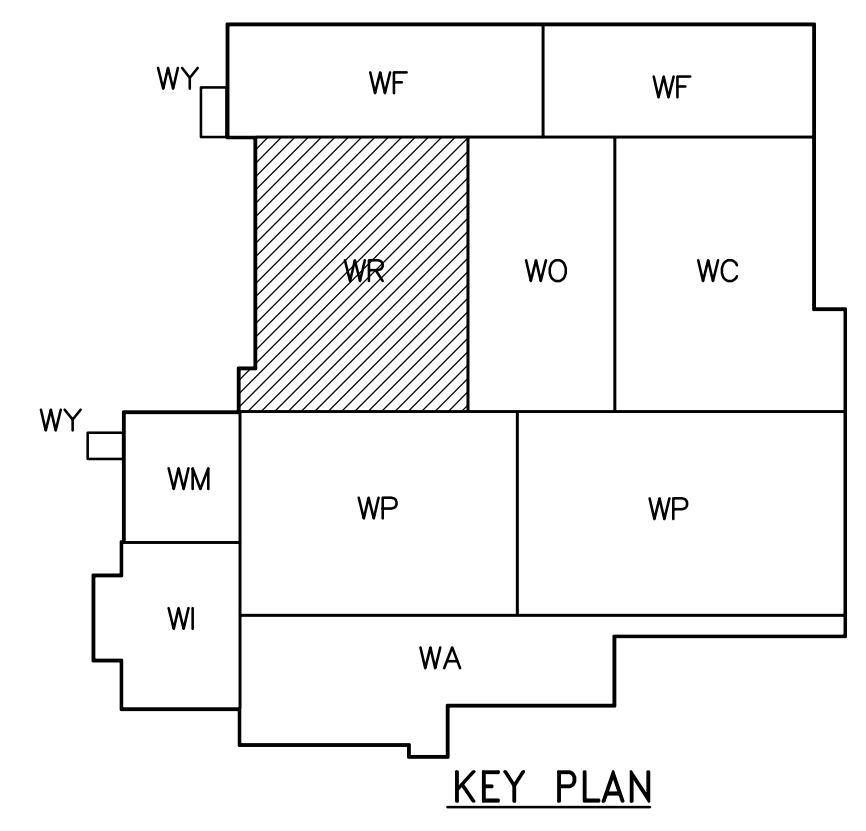

|                   |             |
|-------------------|-------------|
| B.M. ELEV.        |             |
| DESIGNED BY       | TWS         |
| DRAWN BY          | AL/LK       |
| SCALE:            | 1:100       |
| ISSUED FOR TENDER | 07/06/05 LK |
| NO. REVISIONS     | DATE BY     |
|                   | 2005/08/03  |

|                                |                                    |                               |               |
|--------------------------------|------------------------------------|-------------------------------|---------------|
| CH2M HILL                      | EarthTech                          |                               |               |
| Frederickson Cooper ARCHITECTS | A Total International Ltd. Company |                               |               |
| DESIGNED BY                    | TWS                                | CHECKED BY                    | BJS           |
| DRAWN BY                       | AL/LK                              | APPROVED BY                   | AHL           |
| SCALE:                         | 1:100                              | RELEASED FOR CONSTRUCTION BY: | R. SOROKOWSKI |
| ISSUED FOR TENDER              | 07/06/05 LK                        | DATE                          | 2005/08/03    |
| NO. REVISIONS                  | DATE BY                            | DATE                          | 2007/06/05    |

ENGINEER'S SEAL  
ORIGINAL SIGNED BY  
NEIL COOPER  
2007/06/05  
CONSULTANT DRAWING NO.  
WB-B0133

**THE CITY OF WINNIPEG**  
WATER AND WASTE DEPARTMENT  
ENGINEERING DIVISION

WATER TREATMENT PLANT  
MAIN BUILDING  
OFFICE AND PLANT INTERIOR FINISHES

ARCHITECTURAL  
PARTIAL PLAN OF  
MECHANICAL ROOM

CITY FILE NUMBER  
SHEET OF  
CITY DRAWING NUMBER  
1-0601B-A-B0133-001-00D