

NOTES:

- FOR WALL CONTROL JOINTS SEE ARCHITECTURAL DRAWINGS.
- SEE DETAIL FOR OPENING REINFORCING.
WB-S4451
- USE NO.9 ASWG@400 FOR JOINT REINFORCEMENT.
- FOR DETAILS OF LINTELS, BOND BEAMS, AND CORE FILLS REFER TO AND .
WB-S4451 WB-S4451
- COORDINATE EXACT DIMENSIONS AND LOCATIONS OF OPENINGS WITH BO 742-2005 CONTRACTOR.
- SEE SPECIFICATIONS FOR ALL FRP STAIRS, PLATFORMS AND HANDRAILS.
- PROVIDE FRP HANDRAILING AND GUARDRAILING FOR FRP STAIRS AND PLATFORMS MORE THAN 600mm ABOVE CONCRETE FLOOR.

FIRST FLOOR PLAN
1:100

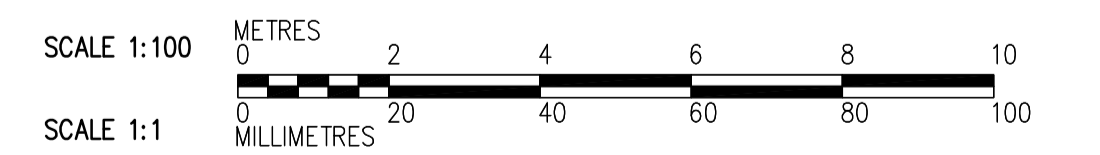
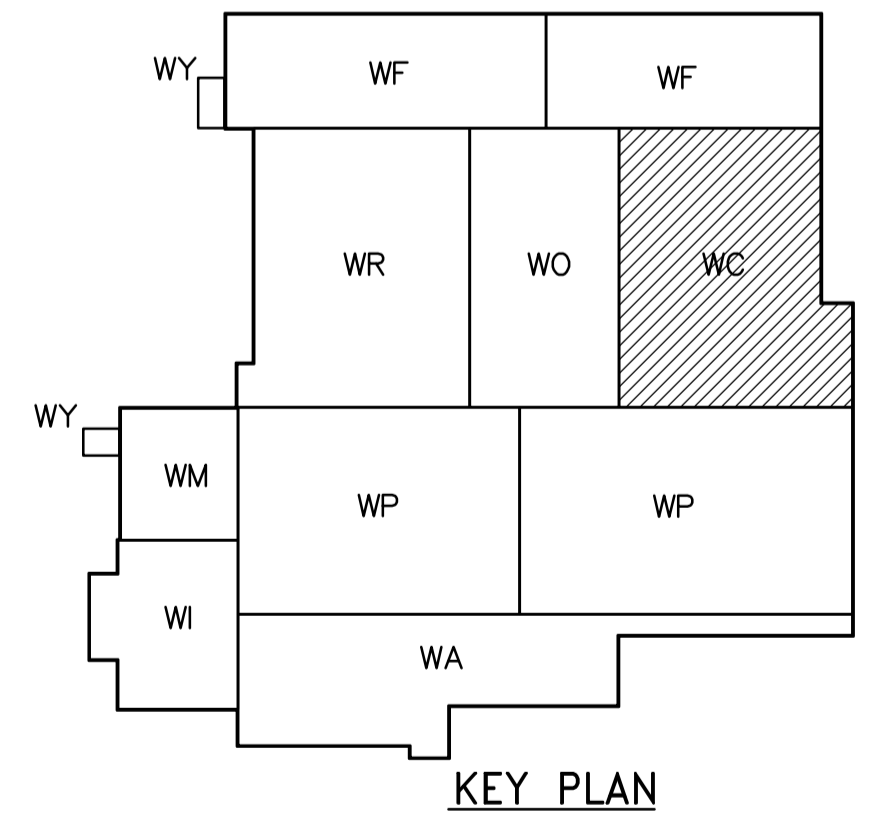

 Certificate of Authorization CH2M HILL Canada Ltd. No. 1441 Expiry: April 30, 2008	 Frederickson Cooper ARCHITECTS		 A Tyco International Ltd. Company		ENGINEER'S SEAL ORIGINAL SIGNED BY C. MILITANO 2007/06/05	 THE CITY OF WINNIPEG WATER AND WASTE DEPARTMENT ENGINEERING DIVISION WATER TREATMENT PLANT CHEMICAL FEED SYSTEMS OFFICE AND PLANT INTERIOR FINISHES STRUCTURAL CHEMICAL AREA FIRST FLOOR PLAN	CITY FILE NUMBER
	DESIGNED BY: MH CHECKED BY: AP	DRAWN BY: CR APPROVED BY: AHL	SCALE: 1:100 RELEASED FOR CONSTRUCTION BY: R. SOROKOWSKI	CONSULTANT DRAWING NO. WC-S4111	SHEET OF		
	NO. 00 REVISIONS	DATE 07/06/05 BY MH	DATE 2007/06/05	DATE 2007/05/06	CITY DRAWING NUMBER 1-0601C-A-S4111-001-000		