

**A SECTION**  
WC-S4131 1:50

- NOTES:**
- FOR WALL CONTROL JOINTS SEE ARCHITECTURAL DRAWINGS.
  - SEE DETAIL **2** FOR OPENING REINFORCING.  
WB-S4451
  - USE NO.9 ASWG@400 FOR JOINT REINFORCEMENT.
  - FOR DETAILS OF LINTELS, BOND BEAMS, AND CORE FILLS REFER TO **2** AND **3**.  
WB-S4451 WB-S4451
  - COORDINATE EXACT DIMENSIONS AND LOCATIONS OF OPENINGS WITH BO 742-2005 CONTRACTOR.

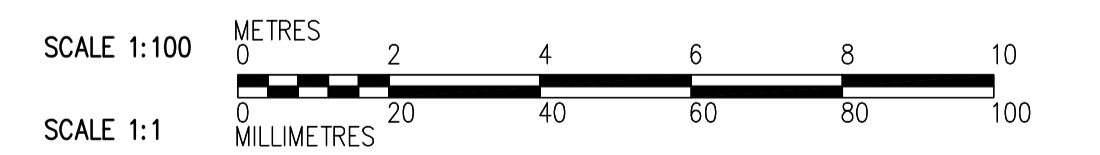
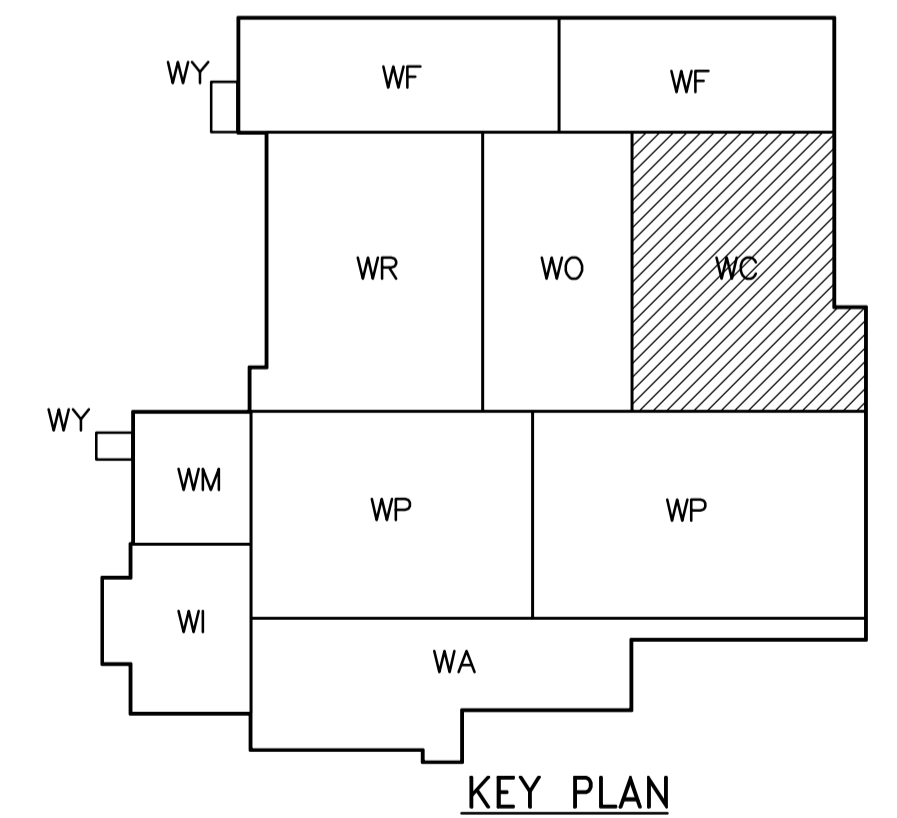

 Certificate of Authorization CH2M HILL Canada Ltd. No. 1441 Expiry: April 30, 2008	 Frederickson Cooper ARCHITECTS		 A Tyco International Ltd. Company		ENGINEER'S SEAL  ORIGINAL SIGNED BY C. MILITANO 2007/06/05	 <b>THE CITY OF WINNIPEG</b> WATER AND WASTE DEPARTMENT ENGINEERING DIVISION  WATER TREATMENT PLANT CHEMICAL FEED SYSTEMS OFFICE AND PLANT INTERIOR FINISHES  STRUCTURAL CHEMICAL AREA SECTIONS	CITY FILE NUMBER SHEET OF
	DESIGNED BY EL	CHECKED BY AP	SCALE: 1:50		CONSULTANT DRAWING NO. WC-S4201		CITY DRAWING NUMBER 1-0601C-A-S4201-001-000
	DRAWN BY CR	APPROVED BY AHL	RELEASED FOR CONSTRUCTION BY: R. SOROKOWSKI				
	NO. REVISIONS 00	ISSUED FOR TENDER 07/06/05	DATE 07/06/05	BY EL	DATE 2007/06/05		DATE 2007/05/06