

- NOTES:**
- FOR WALL CONTROL JOINTS SEE ARCHITECTURAL DRAWINGS.
  - SEE DETAIL **2** FOR OPENING REINFORCING.  
WB-S4451
  - USE NO.9 ASWG@400 FOR JOINT REINFORCEMENT.
  - FOR DETAILS OF LINTELS, BOND BEAMS, AND CORE FILLS REFER TO **2** AND **3**.  
WB-S4451 WB-S4451
  - COORDINATE EXACT DIMENSIONS AND LOCATIONS OF OPENINGS WITH BO 742-2005 CONTRACTOR.

THIRD FLOOR PLAN  
1:100

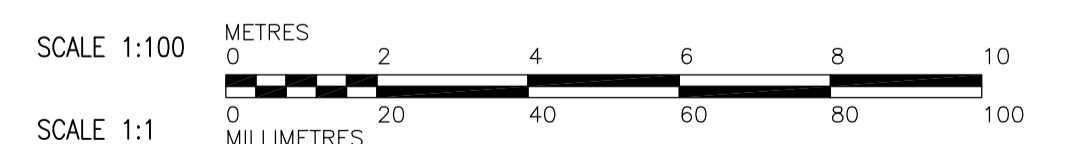
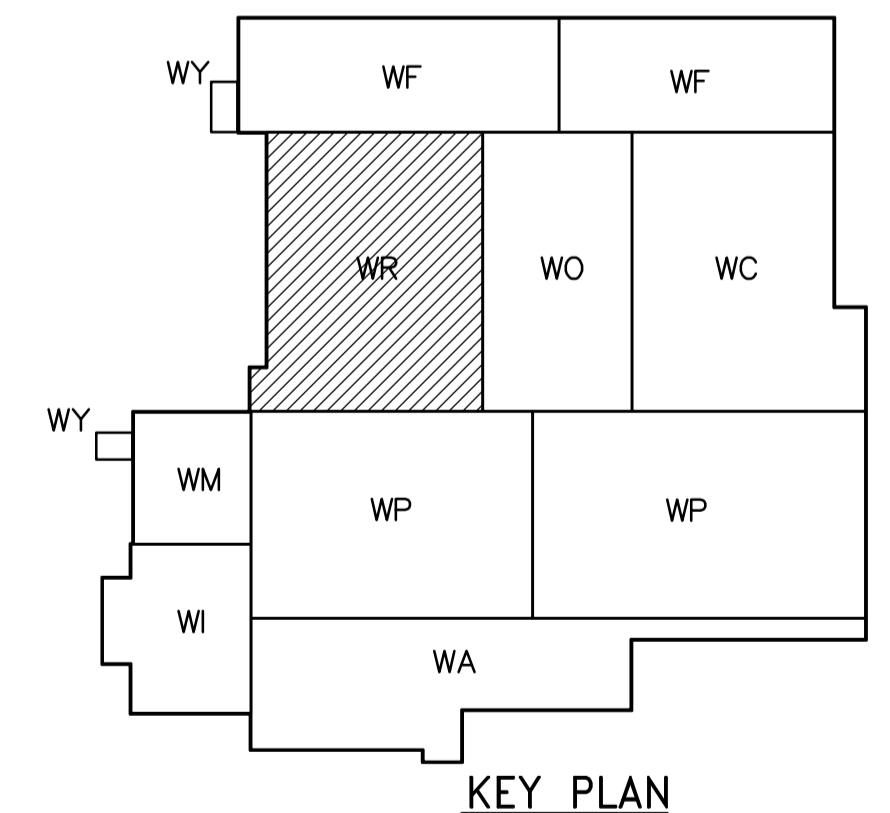

<p>Certificate of Authorization CH2M HILL Canada Ltd. No. 1441 Expiry: April 30, 2008</p>					ENGINEER'S SEAL ORIGINAL SIGNED BY C. MILITANO 2007/06/05	<p>THE CITY OF WINNIPEG WATER AND WASTE DEPARTMENT ENGINEERING DIVISION</p>
	DESIGNED BY: MH DRAWN BY: CR SCALE: 1:100	CHECKED BY: AP APPROVED BY: AHL RELEASED FOR CONSTRUCTION BY: R. SOROKOWSKI	CONSULTANT DRAWING NO. WR-S4131		WATER TREATMENT PLANT RESIDUALS HANDLING OFFICE AND PLANT INTERIOR FINISHES	
	B.M. ELEV. NO. REVISIONS DATE BY 00 ISSUED FOR TENDER 07/06/05 MH NO. REVISIONS DATE BY	DATE BY 2007/06/05	DATE BY 2007/05/06	CITY FILE NUMBER SHEET OF CITY DRAWING NUMBER 1-0401R-A-S4131-001-000		