

C SECTION
WR-S4131 1:50

- NOTES:**
- FOR WALL CONTROL JOINTS SEE ARCHITECTURAL DRAWINGS.
 - SEE DETAIL FOR OPENING REINFORCING.
 - USE NO.9 ASWG@400 FOR JOINT REINFORCEMENT.
 - FOR DETAILS OF LINTELS, BOND BEAMS, AND CORE FILLS REFER TO AND .
 - COORDINATE EXACT DIMENSIONS AND LOCATIONS OF OPENINGS WITH BO 742-2005 CONTRACTOR.

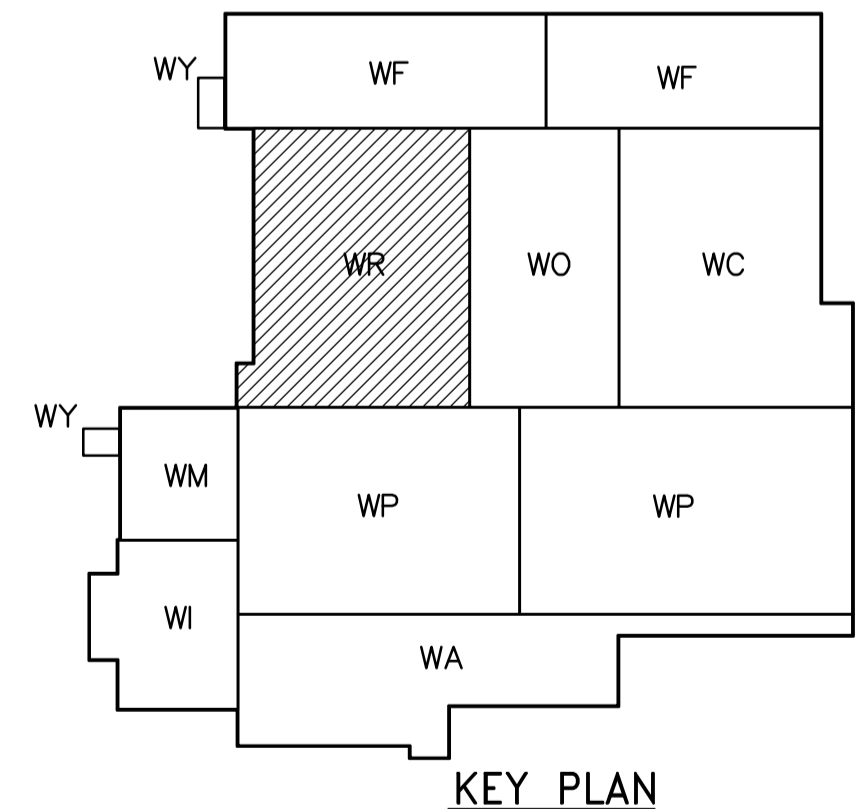

 Certificate of Authorization CH2M HILL Canada Ltd. No. 1441 Expiry: April 30, 2008	 Frederickson Cooper ARCHITECTS		 A Tyco International Ltd. Company		ENGINEER'S SEAL ORIGINAL SIGNED BY C. MILITANO 2007/06/05	 THE CITY OF WINNIPEG WATER AND WASTE DEPARTMENT ENGINEERING DIVISION WATER TREATMENT PLANT RESIDUALS HANDLING OFFICE AND PLANT INTERIOR FINISHES STRUCTURAL RESIDUALS HANDLING AREA SECTIONS	CITY FILE NUMBER	
	DESIGNED BY	MH	CHECKED BY	AP	SHEET OF			
	DRAWN BY	CR	APPROVED BY	AHL	CITY DRAWING NUMBER			
	SCALE:	1:50	RELEASED FOR CONSTRUCTION BY:	R. SOROKOWSKI	1-0401R-A-S4202-001-000			
00	ISSUED FOR TENDER	07/06/05	MH	DATE	2007/06/05	DATE	2007/05/06	CONSULTANT DRAWING NO. WR-S4202
NO.	REVISIONS	DATE	BY	DATE	2007/06/05	DATE	2007/05/06	