

**GENERAL NOTES**

1. CHAINAGE IS ALONG CENTRELINE OF PROPOSED RIGHT-OF-WAY OF WAVERLEY STREET.

**CONSTRUCTION NOTES**

1. ALL PIPE BACKFILL UNDER BOULEVARD TO BE CLASS 4 UNLESS OTHERWISE NOTED.
2. INSTALL PIPE UNDER EXISTING OR FUTURE PAVEMENT USING TRENCHLESS METHODS. WHERE NOT POSSIBLE, OPEN CUT WITH CLASS 2 BACKFILL.
3. USE CLASS 2 BACKFILL WITHIN 3m OF NEW MANHOLE INSTALLATIONS.

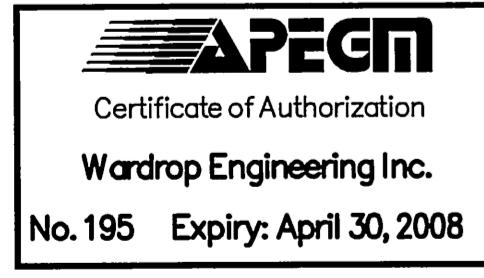
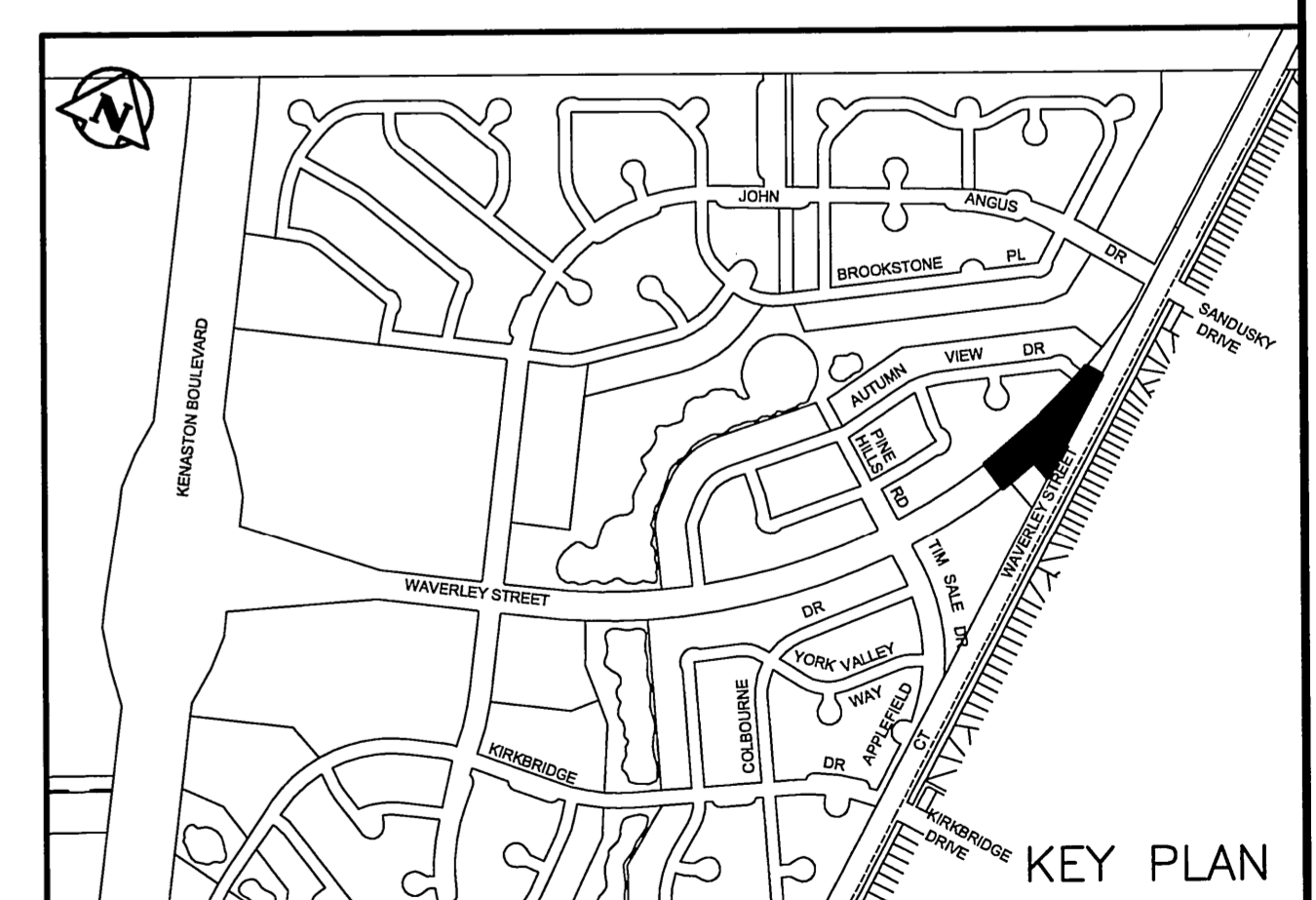

400 FM	FEEDERMAIN	15.240	LEGAL DIMENSION	PROPERTY LINE	LOCATION APPROVED UNDERGROUND STRUCTURES	B.M. CITY OF WINNIPEG 82-024 ELEV. 232.259m	<b>WARDROP</b> Engineering Inc. DESIGNED BY WTJ DRAWN BY GMD HOR. SCALE: 1 : 500 VERTICAL: 1 : 50 CHECKED BY [Signature] APPROVED BY [Signature] RELEASED FOR CONSTRUCTION [Signature]	PROVINCE OF MANITOBA <b>W.T. JACKSON</b> Member 2078266 REGISTERED PROFESSIONAL ENGINEER	<b>THE CITY OF WINNIPEG</b> WATER AND WASTE DEPARTMENT WAVERLEY WEST SUBDIVISION WASTEWATER SEWER INTERCEPTOR WAVERLEY STREET 150.0 NORTH OF TIM SALE DRIVE TO 10.0 NORTH OF AUTUMN VIEW DRIVE	CITY DRAWING NUMBER <b>8232</b> SHEET <b>2</b> OF <b>3</b>
250 WWS	WASTEWATER SEWER	750 WWS	SURVEY BAR	HYDRO	NO. REVISIONS	DATE				
---	WWS REFERENCE ONLY	○	MANHOLE	×31.175	ELEVATION	00	08.02.08	U		
---	WATERMAIN	●	HYDRO POLE	---	ASPHALT					
---	SHAW FIBRE OPTICS	○	TREE	---	GRAVEL					
---		○	SHRUB	×	FENCE					
---		+	SIGN	---	CURB (FUTURE)					
---		[ ]	CULVERT	---	CURB					
EXISTING	LEGEND-PLAN	PROPOSED	EXISTING	LEGEND-PLAN	PROPOSED	EXISTING	LEGEND-PLAN	PROPOSED		

NOTE:  
LOCATION OF UNDERGROUND STRUCTURES AS SHOWN ARE BASED ON THE BEST INFORMATION AVAILABLE. BUT NO GUARANTEE IS GIVEN THAT ALL EXISTING UTILITIES ARE SHOWN OR THAT THE GIVEN LOCATIONS ARE EXACT. CONFIRMATION OF EXISTENCE AND EXACT LOCATION OF ALL SERVICES MUST BE OBTAINED FROM THE INDIVIDUAL UTILITIES BEFORE PROCEEDING WITH CONSTRUCTION.