

- CONSTRUCTION NOTES**
1. EXPOSE EXISTING WATERMAIN & CONFIRM INVERTS PRIOR TO CONSTRUCTION.
 2. CONFIRM LOCATION OF ALL SERVICES IN THE FIELD.
 3. INSTALL WATERMAIN BY TRENCHLESS METHODS.
 4. TRENCHES AND EXCAVATIONS WITHIN 1 METRE OF A PAVED AREA INCLUDING SIDEWALKS SHALL BE CLASS 3 BACKFILL.
 5. ALL MATERIALS SHALL CONFORM TO THE CITY OF WINNIPEG STANDARD CONSTRUCTION SPECIFICATIONS.
 6. MINIMUM COVER TO TOP OF WATERMAIN SHALL BE 2.4 m.
 7. REPLACE ALL EXISTING LEAD SERVICES FROM PROPOSED WATERMAIN TO R.
 8. NOTIFY ALL AFFECTED RESIDENTS AND BUSINESSES 24 HOURS IN ADVANCE OF ANY WATER SHUTDOWNS OR DISRUPTION OF SERVICE.
 9. EXCAVATIONS TO BE LOCATED AWAY FROM EXISTING TREE'S.

NOTE: CHAINAGES SHOWN ARE ALONG E. R. OF MINNETONKA ST.

WATER SERVICE INFORMATION

ADDRESS	SIZE(mm) & TYPE (STREET)	SIZE(mm) & TYPE (PROP)	SHORT & LONG MEASUREMENT	CORP. LOCATION	REMARKS
28 MINNETONKA ST	20 COPPER	20 COPPER	2.36 NSL HSE	-	EXACT CORP LOCATION UNKNOWN
32 MINNETONKA ST	20 COPPER	20 COPPER	2.77 NSL WEeping WILLOW	-	EXACT CORP LOCATION UNKNOWN
36 MINNETONKA ST	20 COPPER	20 COPPER	3.02 NSL HSE	-	EXACT CORP LOCATION UNKNOWN
40 MINNETONKA ST	20 COPPER	20 COPPER	13.17 SSL WEeping WILLOW	-	EXACT CORP LOCATION UNKNOWN
44 MINNETONKA ST	20 COPPER	20 COPPER	5.55 NSL HSE	-	EXACT CORP LOCATION UNKNOWN
48 MINNETONKA ST	20 COPPER	20 COPPER	29.36 SSL WEeping WILLOW	-	EXACT CORP LOCATION UNKNOWN
52 MINNETONKA ST	20 COPPER	20 COPPER	5.80 SNL HSE	-	EXACT CORP LOCATION UNKNOWN
56 MINNETONKA ST	20 COPPER	20 COPPER	46.63 SSL WEeping WILLOW	-	EXACT CORP LOCATION UNKNOWN
60 MINNETONKA ST	20 COPPER	20 COPPER	2.52 SNL HSE	-	EXACT CORP LOCATION UNKNOWN
64 MINNETONKA ST	20 COPPER	20 COPPER	12.40 NSL BLUE SPRUCE	-	-
68 MINNETONKA ST	20 COPPER	20 COPPER	4.65 NSL HSE	-	-
72 MINNETONKA ST	20 COPPER	20 COPPER	6.02 SNL BLUE SPRUCE	-	-
76 WEeping WILLOW DR	20 COPPER	20 COPPER	3.01 WEL HSE	5.0 E OF S/C	-
80 WEeping WILLOW DR	20 COPPER	20 COPPER	9.25 WEL MINNETONKA	0.9 W OF S/C	-
84 WEeping WILLOW DR	20 COPPER	20 COPPER	2.02 WEL HSE	-	-
88 BLUE SPRUCE DR	20 COPPER	20 COPPER	4.72 WEL HSE	-	-
92 BLUE SPRUCE DR	20 COPPER	20 COPPER	18.81 WEL MINNETONKA	-	-
96 BLUE SPRUCE DR	20 COPPER	20 COPPER	8.59 WEL MINNETONKA	-	-

* SERVICES TO BE RENEWED TO R UPON CONFIRMATION BY THE CONTRACTOR OF EXISTING 1/2" COPPER OR LEAD SERVICE. OBTAIN APPROVAL FROM CONTRACT ADMINISTRATOR PRIOR TO RENEWAL.

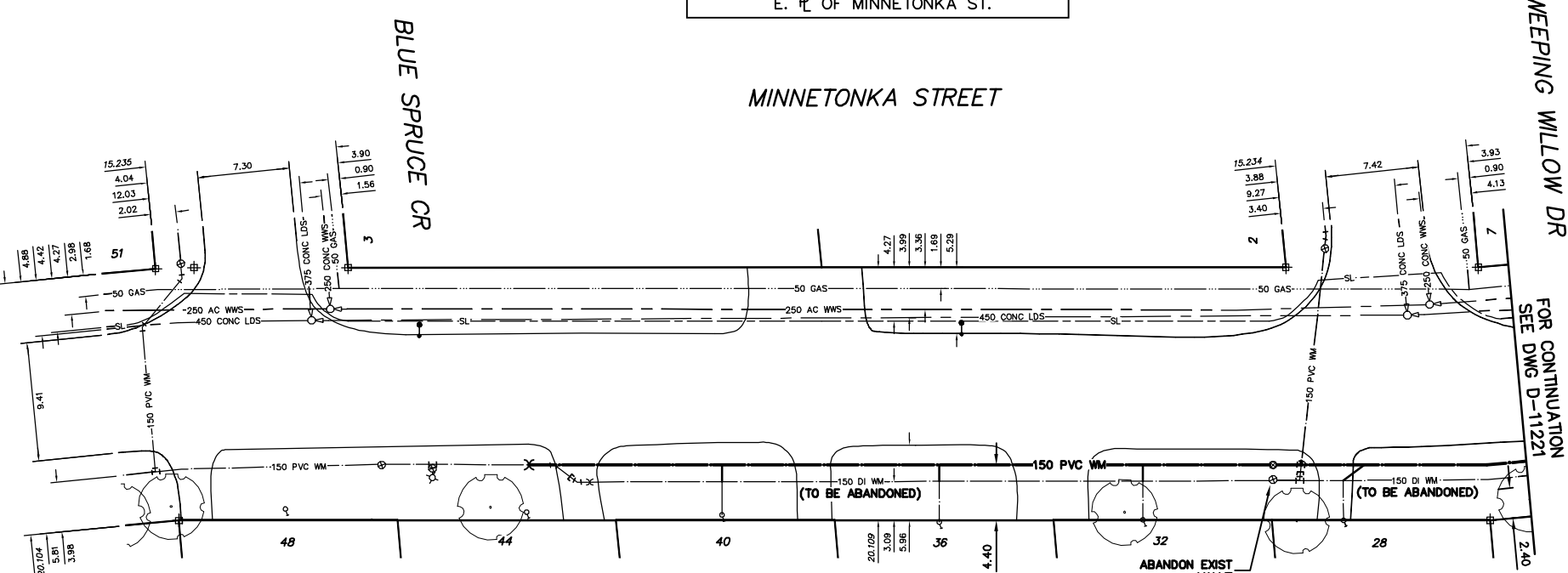

METRIC

WHOLE NUMBERS INDICATE MILLIMETRES
DECIMALIZED NUMBERS INDICATE METRES

NOTE: ALL VALVES TO BE INSTALLED CLOCKWISE TO CLOSE

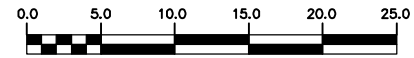

WARNING

IF POWER EQUIPMENT OR EXPLOSIVES ARE TO BE USED FOR EXCAVATION ON THIS PROJECT THE CONTRACTOR MUST:
1) NOTIFY THE GAS COMPANY OF THE PROPOSED LOCATION OF EXCAVATION.
2) TAKE PRECAUTION TO AVOID DAMAGE TO GAS COMPANY INSTALLATIONS.
SEE PROVINCIAL REGULATION 210/72 FOR DETAILS

EXISTING	LEGEND-PLAN	PROPOSED	EXISTING	LEGEND-PLAN	PROPOSED	EXISTING	LEGEND-PROFILE	PROPOSED
200 WM	WATERMAIN	200 WM	SL, HYDRO	150 WM	WATERMAIN	150 WM		
525 LDS	LAND DRAINAGE SEWER	525 LDS	MTS	300 LDS	LAND DRAINAGE SEWER	300 LDS		
375 WWS	WASTEWATER SEWER	375 WWS	TRAFFIC SIGNALS	250 WWS	WASTEWATER SEWER	250 WWS		
51	MANHOLE	51	GAS	50 GAS	GAS	50 GAS		
48	CATCH BASIN	48	SURVEY BAR	44	FENCE	44		
40	CURB INLET	40	POLE - HYDRO, MTS	36	POLE - HYDRO, MTS	36		
32	REDUCER	32	CURB STOP	28	CURB STOP	28		
28	COUPLER	28	GUY ANCHOR	24	GUY ANCHOR	24		
	ANODE		LIGHT STANDARD	20	LIGHT STANDARD	20		
			TREE	16	TREE	16		

LOCATION APPROVED UNDERGROUND STRUCTURES

NOTE: LOCATION OF UNDERGROUND STRUCTURES AS SHOWN ARE BASED ON THE BEST INFORMATION AVAILABLE BUT NO GUARANTEE IS GIVEN THAT ALL EXISTING UTILITIES ARE SHOWN OR THAT THE GIVEN LOCATIONS ARE EXACT. CONFIRMATION OF EXISTENCE AND EXACT LOCATION OF ALL SERVICES MUST BE OBTAINED FROM THE INDIVIDUAL UTILITIES BEFORE PROCEEDING WITH CONSTRUCTION.

NO.	REVISIONS	DATE	BY

CITY OF WINNIPEG WATER AND WASTE ENGINEERING DIVISION

DESIGNED BY: DB
CHECKED BY: NC
DRAWN BY: CJH
APPROVED BY: KZ

HOR. SCALE: 1:250
VERTICAL SCALE: 1:50

RELEASED FOR CONSTRUCTION: 2008 03 03

ENGINEER'S SEAL
ORIGINAL SIGNED BY: K.R. ZUREK
08/03/03

THE CITY OF WINNIPEG WATER AND WASTE DEPARTMENT

2008 WATERMAIN RENEWALS CONTRACT 3
MINNETONKA STREET
BLUE SPRUCE CRESCENT TO WEeping WILLOW DRIVE

SHEET 4 OF 9
CITY DRAWING NUMBER: D-11220