

WATER SERVICE INFORMATION					
ADDRESS	SIZE(mm) & TYPE (STREET)	SIZE(mm) & TYPE (PROP)	SHORT & LONG MEASUREMENT	CORP. LOCATION	REMARKS
519 ST ANTHONY ST	20	-	3.87 WEL HSE	0.2 W OF S/C	-
RESIDENTIAL	COPPER	-	8.85 EEL MCKENZIE		-
530 ST ANTHONY ST	20	-	1.88 WEL HSE	1.0 W OF S/C	-
RESIDENTIAL	COPPER	-	9.91 EEL MCKENZIE		-
529 ST ANTHONY ST	20	-	0.66 WEL HSE	0.43 E OF S/C	-
RESIDENTIAL	COPPER	-	2.28 WEL MCKENZIE		-
530 ST ANTHONY ST	20	-	0.89 WEL HSE	OPP S/C	-
RESIDENTIAL	COPPER	-	3.35 WEL MCKENZIE		-
533 ST ANTHONY ST	20	-	1.72 WEL HSE	0.5 E OF S/C	-
RESIDENTIAL	COPPER	-	17.15 WEL MCKENZIE		-
534 ST ANTHONY ST	20	-	OPP EL HSE	2.5 E OF S/C	-
RESIDENTIAL	COPPER	-	15.73 WEL MCKENZIE		-
537 ST ANTHONY ST	20	-	0.67 WEL HSE	0.81 E OF S/C	-
RESIDENTIAL	COPPER	-	28.41 WEL MCKENZIE		-
538 ST ANTHONY ST	20	-	4.30 WEL HSE	1.95 E OF S/C	-
RESIDENTIAL	COPPER	-	33.36 WEL MCKENZIE		-
541 ST ANTHONY ST	20	-	2.90 WEL HSE	0.62 E OF S/C	-
RESIDENTIAL	COPPER	-	52.22 WEL MCKENZIE		-
542 ST ANTHONY ST	20	-	2.50 WEL HSE	1.47 E OF S/C	-
RESIDENTIAL	COPPER	-	50.57 WEL MCKENZIE		-
545 ST ANTHONY ST	20	-	2.24 WEL HSE	1.38 E OF S/C	-
RESIDENTIAL	COPPER	-	60.42 WEL MCKENZIE		-
548 ST ANTHONY ST	20	-	OPP EHL	1.98 E OF S/C	-
RESIDENTIAL	COPPER	-	57.28 WEL MCKENZIE		-
549 ST ANTHONY ST	20	-	2.95 WEL HSE	0.95 E OF S/C	-
RESIDENTIAL	COPPER	-	78.79 WEL MCKENZIE		-
550 ST ANTHONY ST	20	-	1.11 WEL HSE	2.2 E OF S/C	-
RESIDENTIAL	COPPER	-	71.61 WEL MCKENZIE		-

NOTE: CHAINAGES SHOWN ARE ALONG S. R. OF ST ANTHONY AVE.

ST ANTHONY AVENUE

* SERVICES TO BE RENEWED TO R UPON CONFIRMATION BY THE CONTRACTOR OF EXISTING 1/2" COPPER OR LEAD SERVICE. OBTAIN APPROVAL FROM CONTRACT ADMINISTRATOR PRIOR TO RENEWAL.

- CONSTRUCTION NOTES**
1. EXPOSE EXISTING WATERMAIN & CONFIRM INVERTS PRIOR TO CONSTRUCTION.
 2. CONFIRM LOCATION OF ALL SERVICES IN THE FIELD.
 3. INSTALL WATERMAIN BY TRENCHLESS METHODS.
 4. TRENCHES AND EXCAVATIONS WITHIN 1 METRE OF A PAVED AREA INCLUDING SIDEWALKS SHALL BE CLASS 3 BACKFILL.
 5. ALL MATERIALS SHALL CONFORM TO THE CITY OF WINNIPEG STANDARD CONSTRUCTION SPECIFICATIONS.
 6. MINIMUM COVER TO TOP OF WATERMAIN SHALL BE 2.4 m.
 7. REPLACE ALL EXISTING LEAD SERVICES FROM PROPOSED WATERMAIN TO R.
 8. NOTIFY ALL AFFECTED RESIDENTS AND BUSINESSES 24 HOURS IN ADVANCE OF ANY WATER SHUTDOWNS OR DISRUPTION OF SERVICE.
 9. EXCAVATIONS TO BE LOCATED AWAY FROM EXISTING TREE'S.

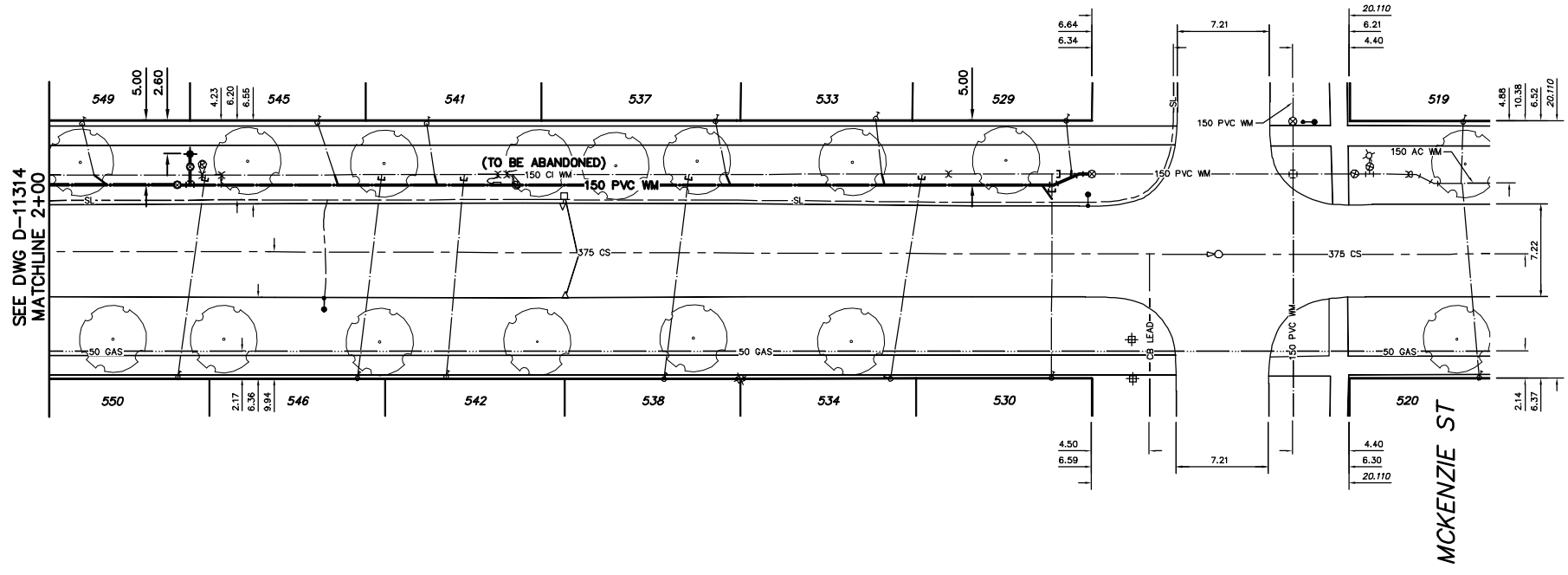

METRIC
WHOLE NUMBERS INDICATE MILLIMETRES
DECIMALIZED NUMBERS INDICATE METRES
NOTE: ALL VALVES TO BE INSTALLED CLOCKWISE TO CLOSE

WARNING
IF POWER EQUIPMENT OR EXPLOSIVES ARE TO BE USED FOR EXCAVATION ON THIS PROJECT THE CONTRACTOR MUST:
1) NOTIFY THE GAS COMPANY OF THE PROPOSED LOCATION OF EXCAVATION.
2) TAKE PRECAUTION TO AVOID DAMAGE TO GAS COMPANY INSTALLATIONS.
SEE PROVINCIAL REGULATION 210/72 FOR DETAILS

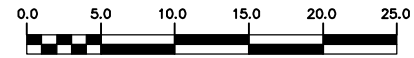

EXISTING	LEGEND-PLAN	PROPOSED	EXISTING	LEGEND-PLAN	PROPOSED	EXISTING	LEGEND-PROFILE	PROPOSED
200 WM	WATERMAIN	200 WM	SL, HYDRO	150 WM	WATERMAIN	150 WM	WATERMAIN	150 WM
⊕	HYDRANT	⊕	MTS	+	HYDRANT	+	HYDRANT	+
⊙	VALVE	⊙	TRAFFIC SIGNALS	⊗	VALVE	⊗	VALVE	⊗
525 LDS	LAND DRAINAGE SEWER	525 LDS	GAS	50 GAS	300 LDS	LAND DRAINAGE SEWER	300 LDS	LAND DRAINAGE SEWER
375 WWS	WASTEWATER SEWER	375 WWS	SURVEY BAR	250 WWS	WASTEWATER SEWER	250 WWS	WASTEWATER SEWER	250 WWS
○	MANHOLE	●	FENCE	⊗	PROFILE	⊗	PROFILE	⊗
□	CATCH BASIN	■	POLE - HYDRO, MTS	⊗	GROUND ABOVE PIPE	⊗	GROUND ABOVE PIPE	⊗
▽	CURB INLET	▽	CURB STOP	⊗	⊕ DITCH (NORTH & WEST)	⊕	⊕ DITCH (NORTH & WEST)	⊕
◁	REDUCER	◁	GUY ANCHOR	⊕	⊕ DITCH (SOUTH & EAST)	⊕	⊕ DITCH (SOUTH & EAST)	⊕
X	COUPLER	X	LIGHT STANDARD	⊕	⊕ GUTTER (NORTH & WEST)	⊕	⊕ GUTTER (NORTH & WEST)	⊕
⊕	ANODE	⊕	TREE	⊕	⊕ GUTTER (SOUTH & EAST)	⊕	⊕ GUTTER (SOUTH & EAST)	⊕

LOCATION APPROVED		B.M. ELEV.	FIELD BOOK #:
UNDERGROUND STRUCTURES			
SUPV. U/G STRUCTURES COMMITTEE	DATE		
NOTE: LOCATION OF UNDERGROUND STRUCTURES AS SHOWN ARE BASED ON THE BEST INFORMATION AVAILABLE BUT NO GUARANTEE IS GIVEN THAT ALL EXISTING UTILITIES ARE SHOWN OR THAT THE GIVEN LOCATIONS ARE EXACT. CONFIRMATION OF EXISTENCE AND EXACT LOCATION OF ALL SERVICES MUST BE OBTAINED FROM THE INDIVIDUAL UTILITIES BEFORE PROCEEDING WITH CONSTRUCTION.			
NO.	REVISIONS	DATE	BY

CITY OF WINNIPEG
WATER AND WASTE
ENGINEERING DIVISION

DESIGNED BY: DB
CHECKED BY: NC
DRAWN BY: C/JH
APPROVED BY: KZ

HOR. SCALE: 1:250
VERTICAL: 1:50

RELEASED FOR CONSTRUCTION
SIGNED BY K. ZUREK

DATE: 2008 03 20
DATE: 08/03/20

ENGINEER'S SEAL
ORIGINAL SIGNED BY K.R. ZUREK
08/03/20

THE CITY OF WINNIPEG
WATER AND WASTE DEPARTMENT

2008 WATERMAIN RENEWALS
CONTRACT 1
ST ANTHONY AVENUE
100 E OF PARR STREET TO
MCKENZIE STREET

SHEET 13 OF 16
CITY DRAWING NUMBER
D-11314