

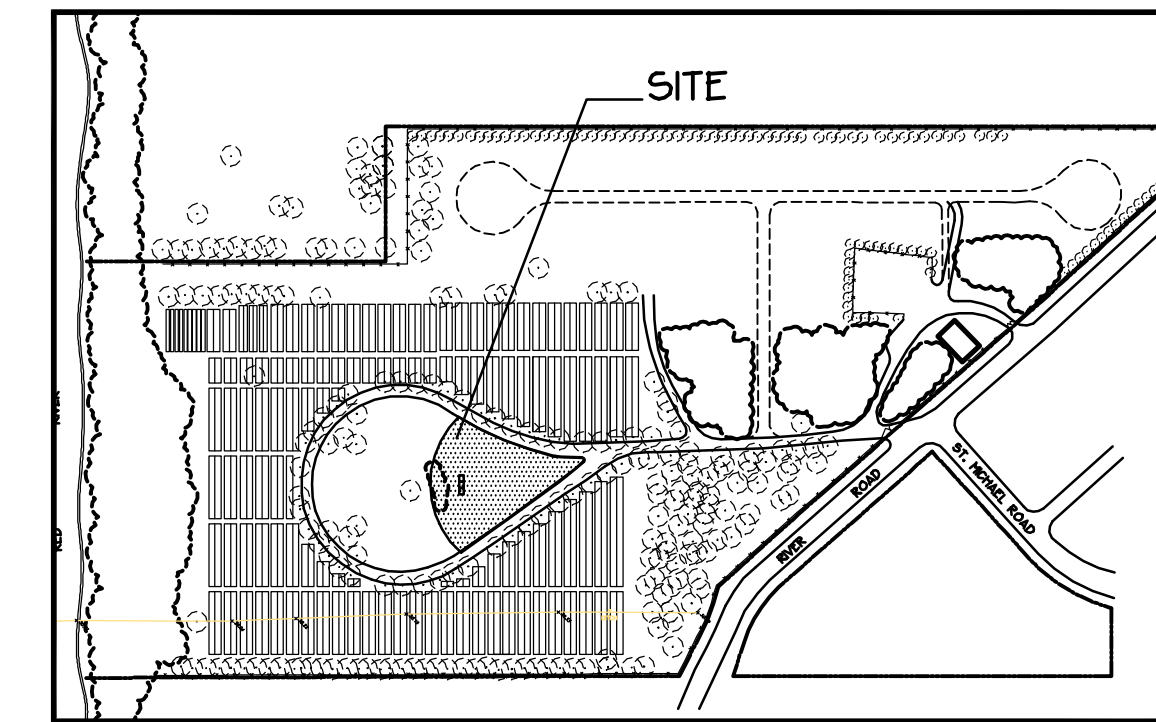





KEY MAP: ST. VITAL CEMETERY CREMATION GARDEN

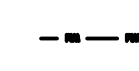
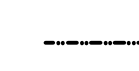

NOTES + LEGEND

-  DENOTES FOUNDATION TO BE Poured LEVEL
- $+ 30.42$ DENOTES PROPOSED ELEVATION
- $+ 30.42$ TF DENOTES PROPOSED TOP OF FOUNDATION
- $+ 32.18$ TW DENOTES PROPOSED TOP OF WALL
- $+ 30.67$ EXISTING ELEVATION
-  WATERMAIN
-  IRRIGATION WATERLINES
-  MANHOLE
-  SPRINKLER
-  WATER VALVE

SURVEY INFO BY:
BARNES & DUNCAN
 LAND SURVEYORS
 Made on the 28th and 29th days of August, 2006.

DATE	DESCRIPTION	BY	APP'D
02/03/08	REVISED FOR TENDER	AH	
01/29/08	REVISED FOR CLIENT REVIEW	AH	

REVISIONS

Detail No. Where Detailed
 All drawings, specifications and related documents are the copyright property of the Consultant and must be returned upon request. Reproduction of some or part of in whole is forbidden without the Consultant's written permission.
 Only those drawings signed under original signature by an authorized representative of Hilton Landmarks Inc. are considered true copies. Contractor must check and verify all dimensions and elevations on the job. Report any discrepancies to the Consultant. Do not scale drawing.

Hilton LANDMARKS Inc.
 Cemetery Consultants, Planning and Design
 155 Frobisher Drive, Suite J-102 Tel: (519) 725-7333
 Waterloo, Ontario N2V 2E1 Fax: (519) 725-3008
 www.hiltonlandmarks.com Email: hll@golden.net



Project
ST. VITAL CREMATION GARDEN SITE WORKS CONTRACT
 WINNIPEG, MANITOBA

Drawing
PHASE TWO GRADING PLAN

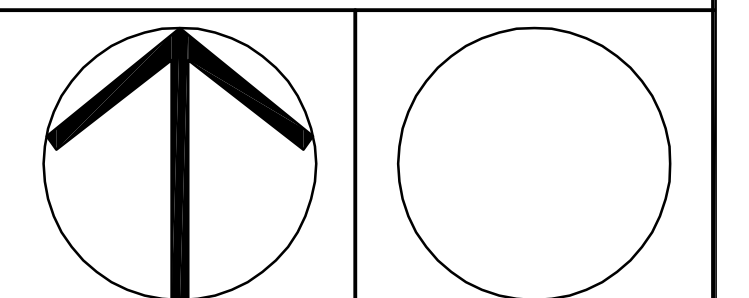

Scale: 1:150

Design By: A.H./R.H.	Project No. 99048-05
Drawn By: A.H.	Date: November, 2006
Checked By: CAD File	CAD File: 98048DD L-1
Drawing No. L-3	Sheet No. 4 of 7

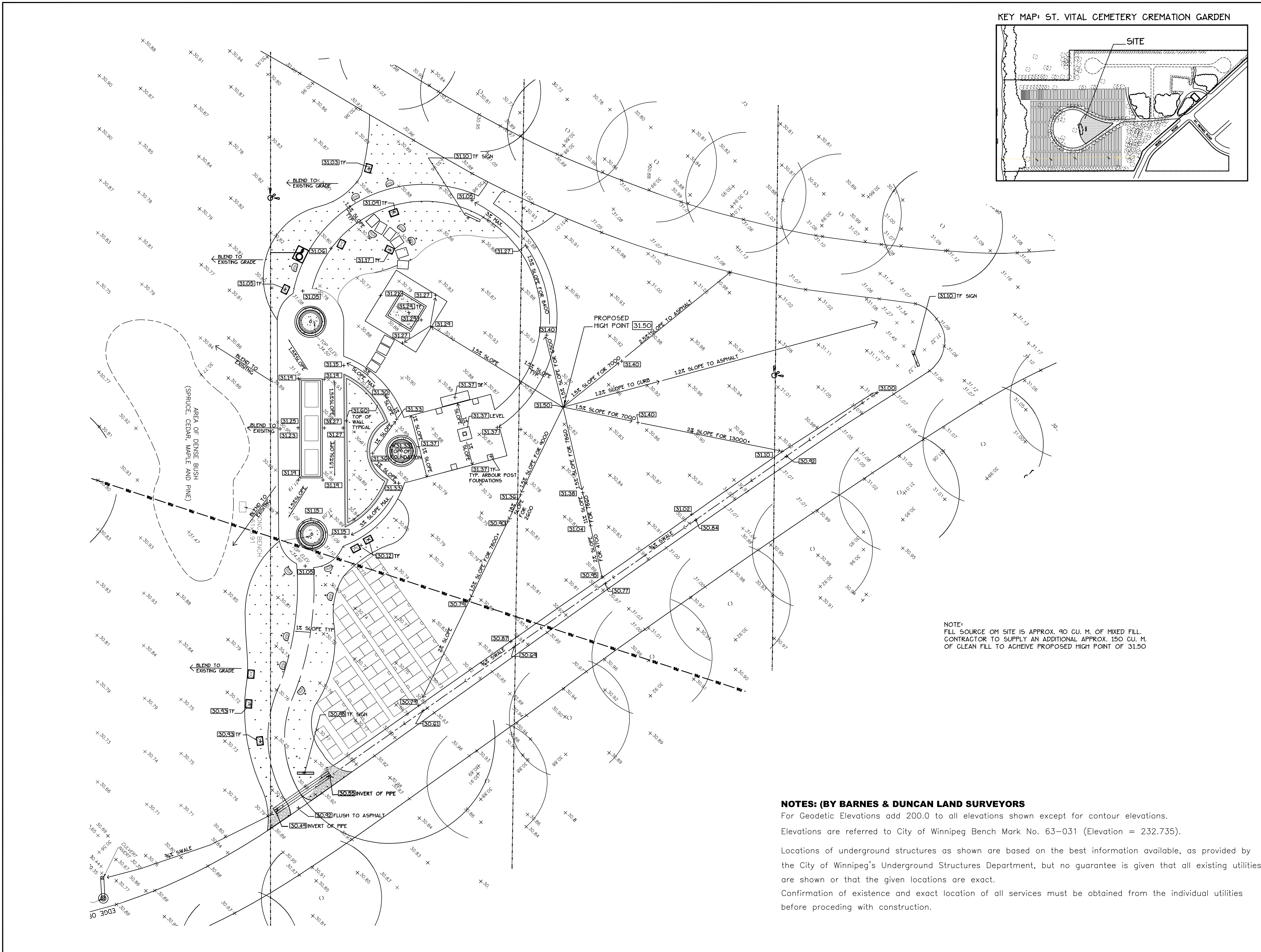

NOTES: (BY BARNES & DUNCAN LAND SURVEYORS)
 For Geodetic Elevations add 200.0 to all elevations shown except for contour elevations.
 Elevations are referred to City of Winnipeg Bench Mark No. 63-031 (Elevation = 232.735).
 Locations of underground structures as shown are based on the best information available, as provided by the City of Winnipeg's Underground Structures Department, but no guarantee is given that all existing utilities are shown or that the given locations are exact.
 Confirmation of existence and exact location of all services must be obtained from the individual utilities before proceeding with construction.