

Eastbound Portage, N/S Maryland
Stop 10576 Maryland

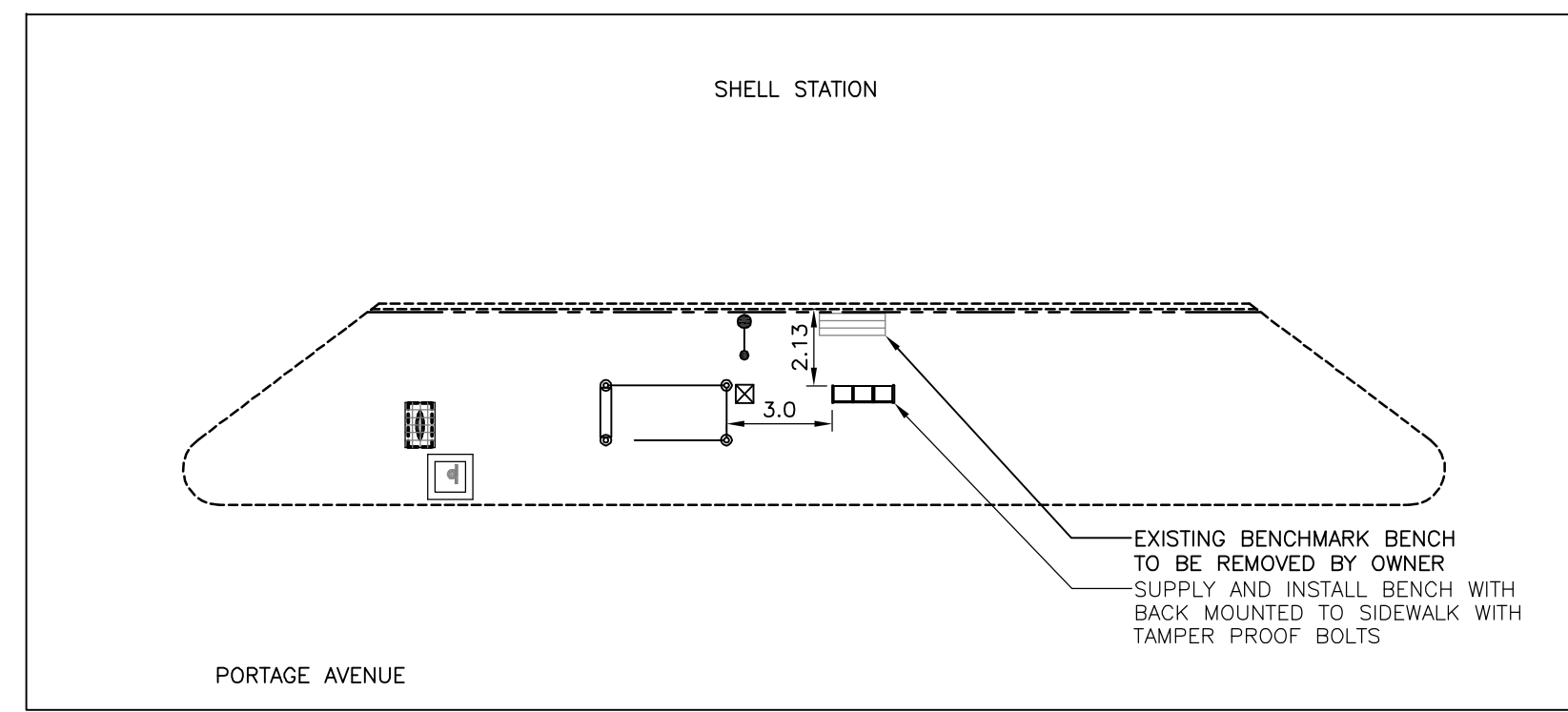

Westbound Portage, N/S McGee
Stop 10549 Maryland

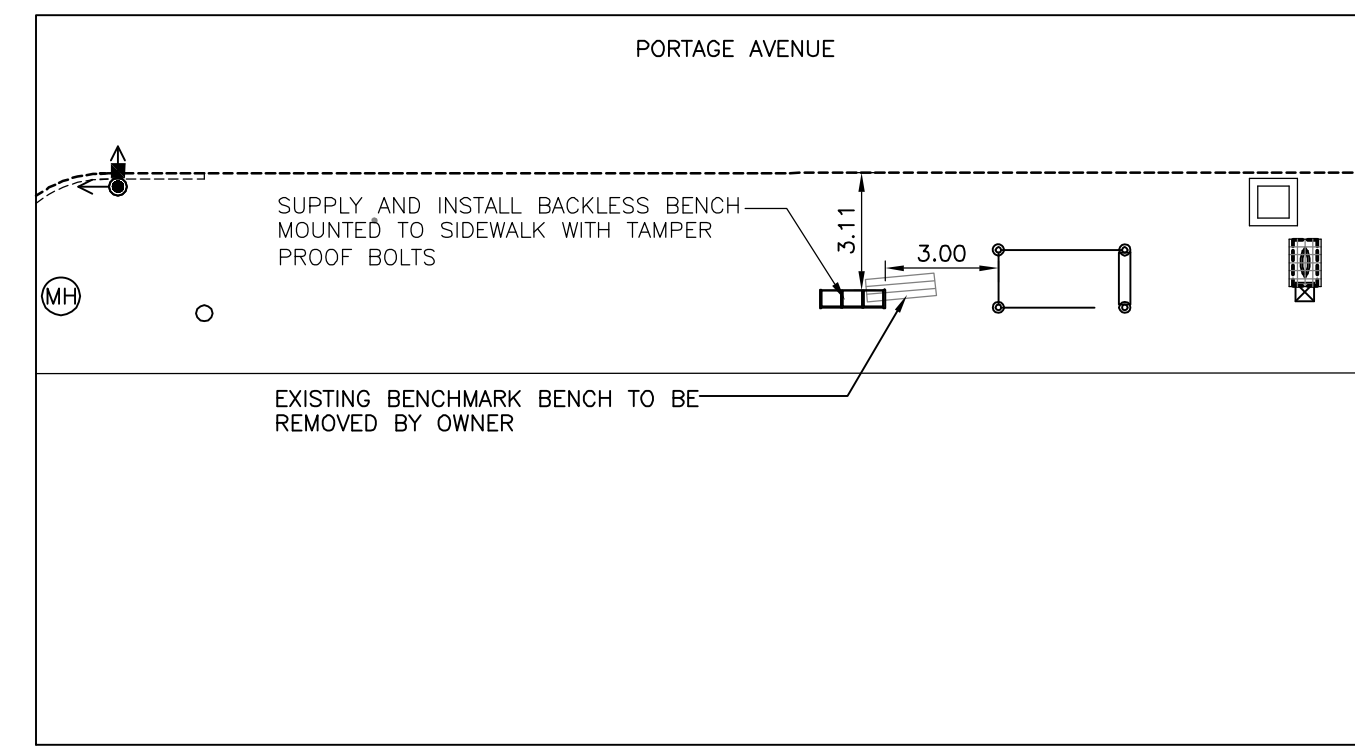

Westbound Portage, F/S Sherbrook
Stop 10577 Sherbrook

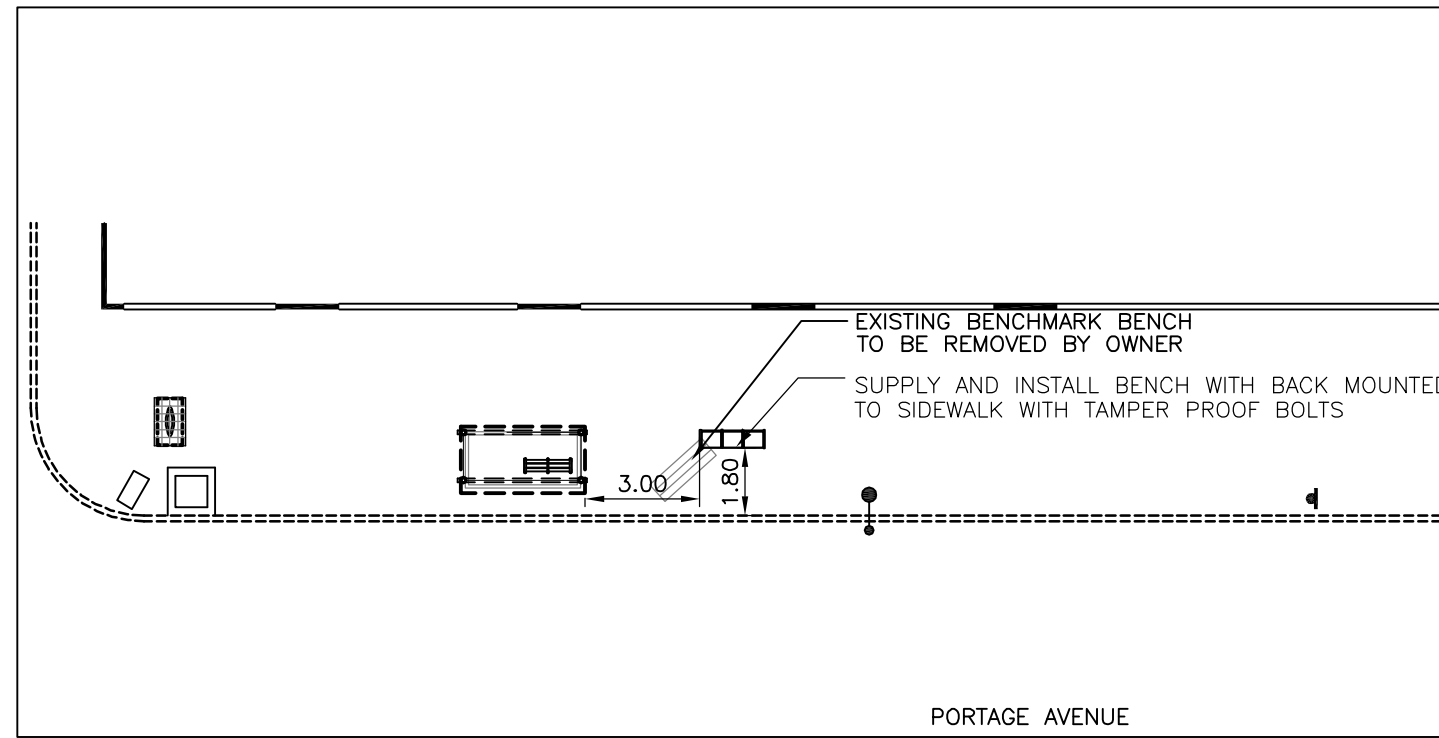
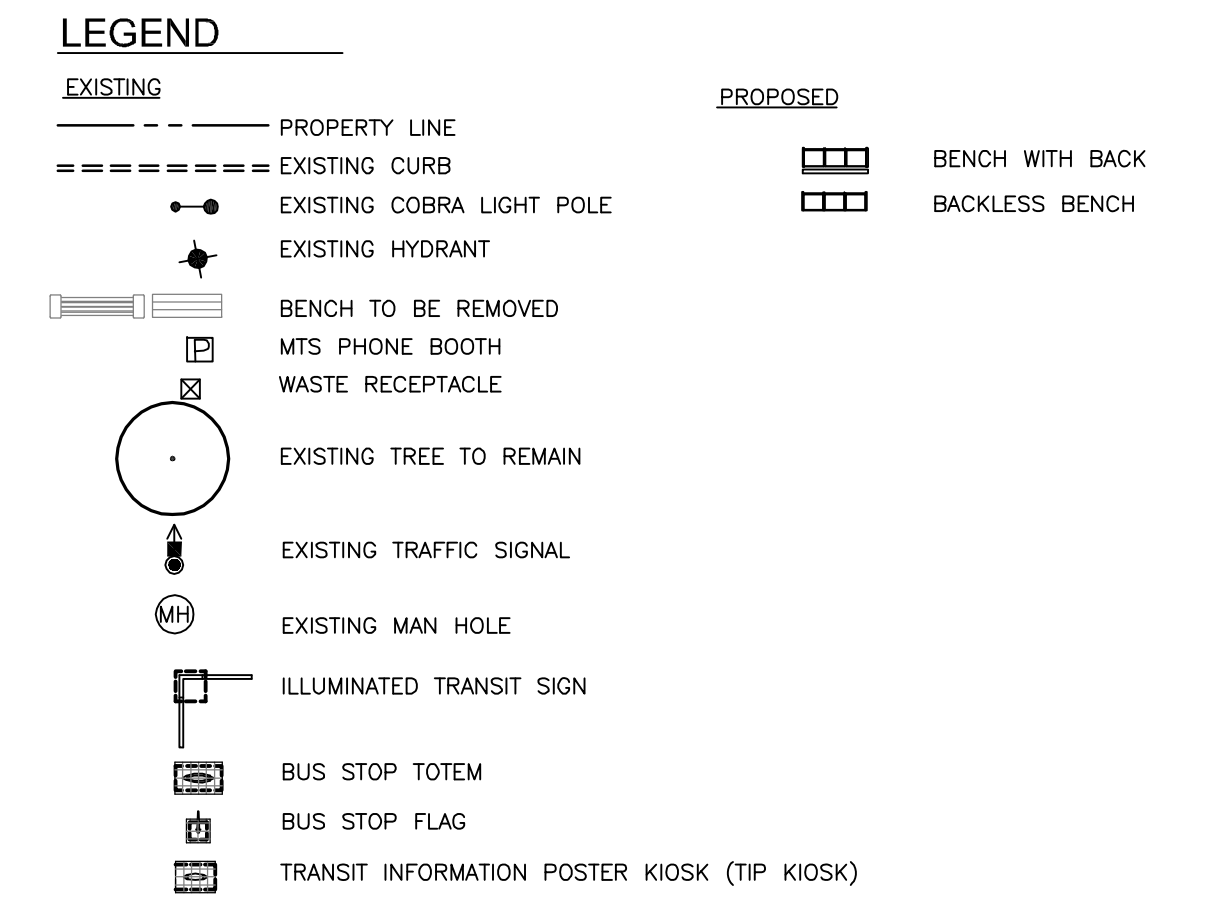

Westbound Portage, N/S Sherbrook
Stop 10548 Sherbrook

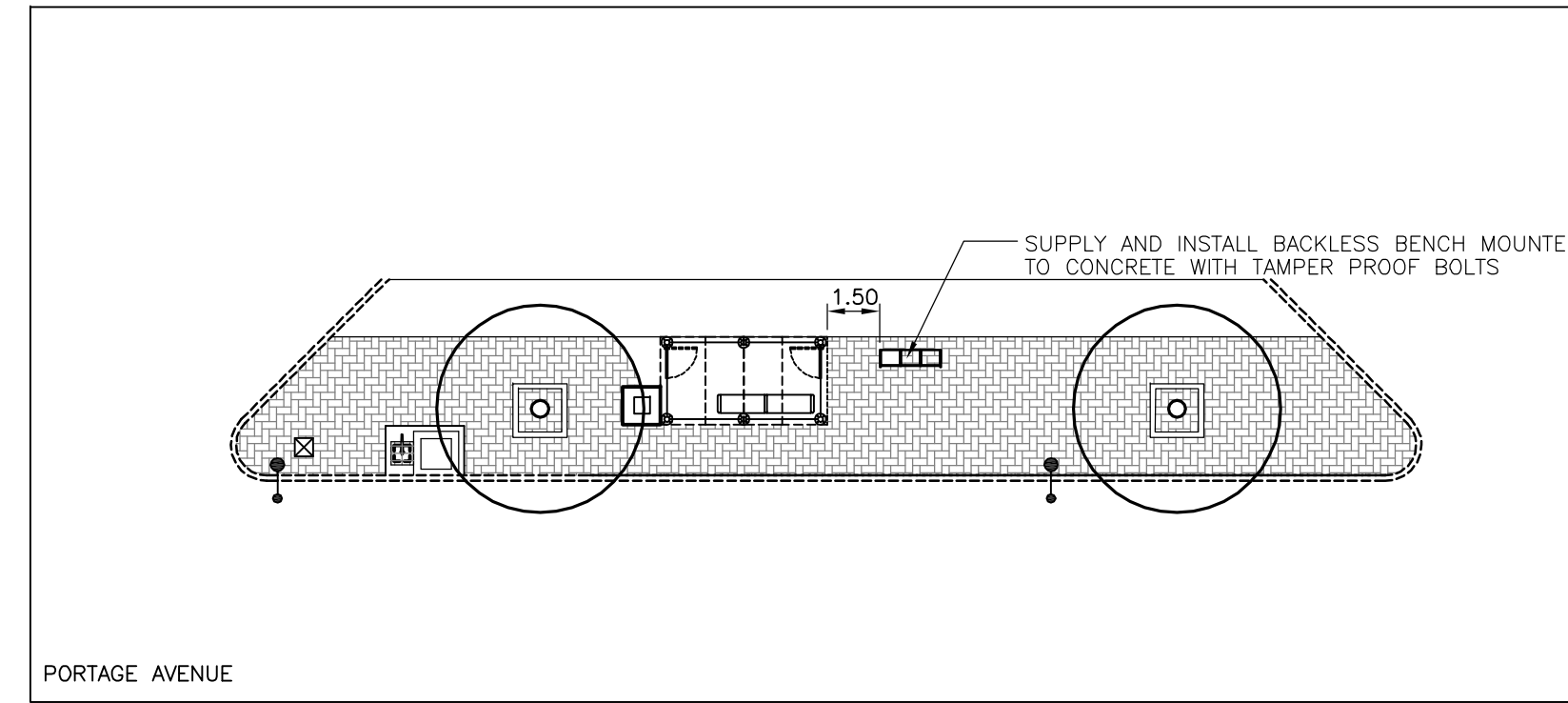

Eastbound Portage, N/S Langside
Stop 10578 Langside

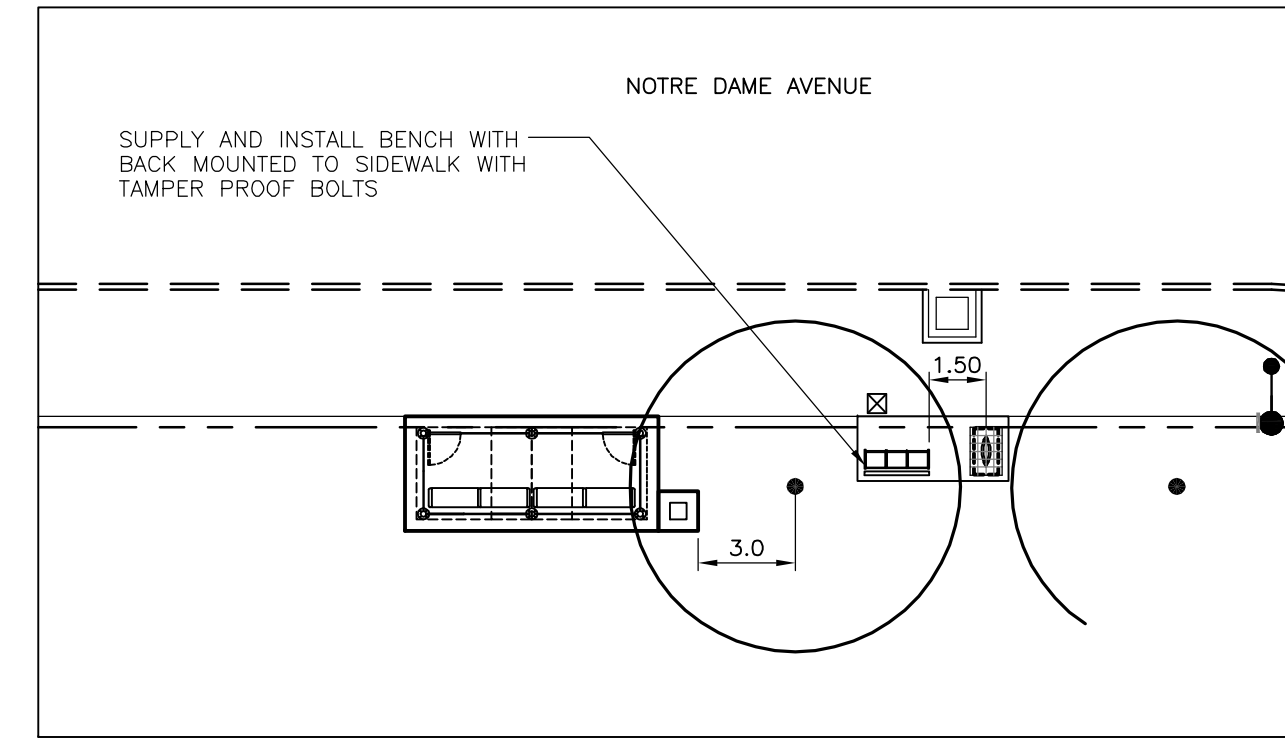

Eastbound Notre Dame, N/S Wall
Stop 10407 Wall

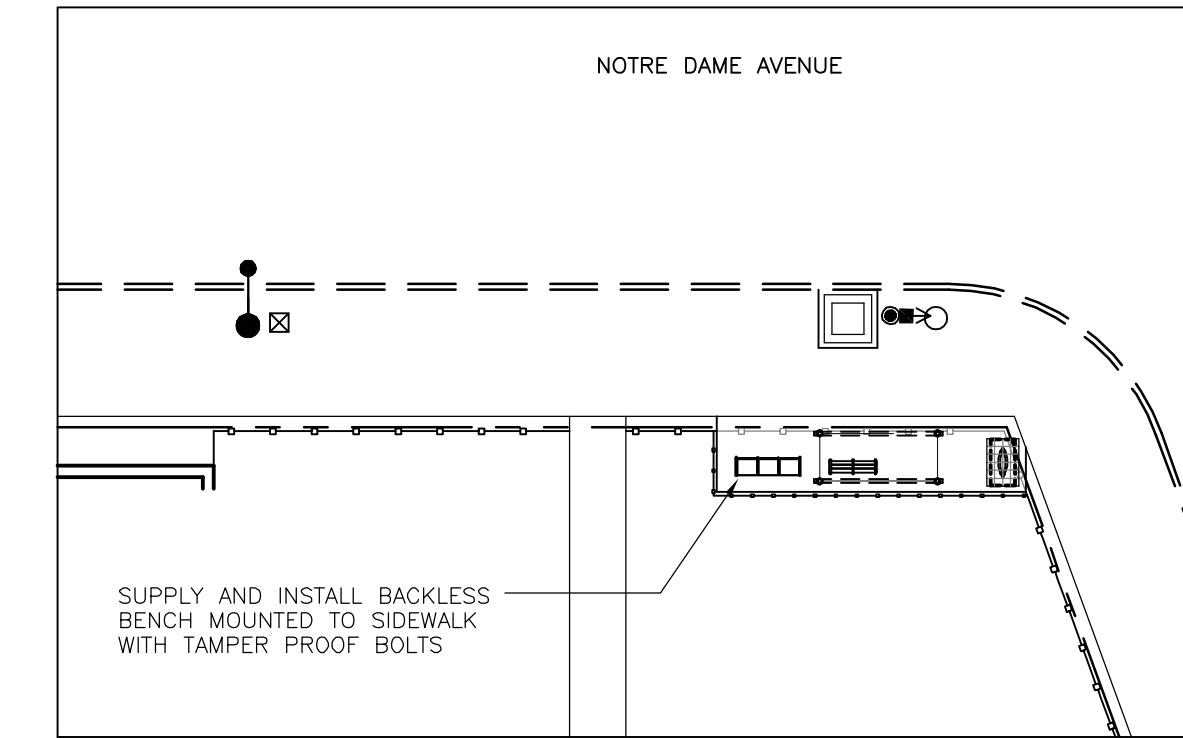

Eastbound Notre Dame, N/S Arlington
Stop 10789 Arlington

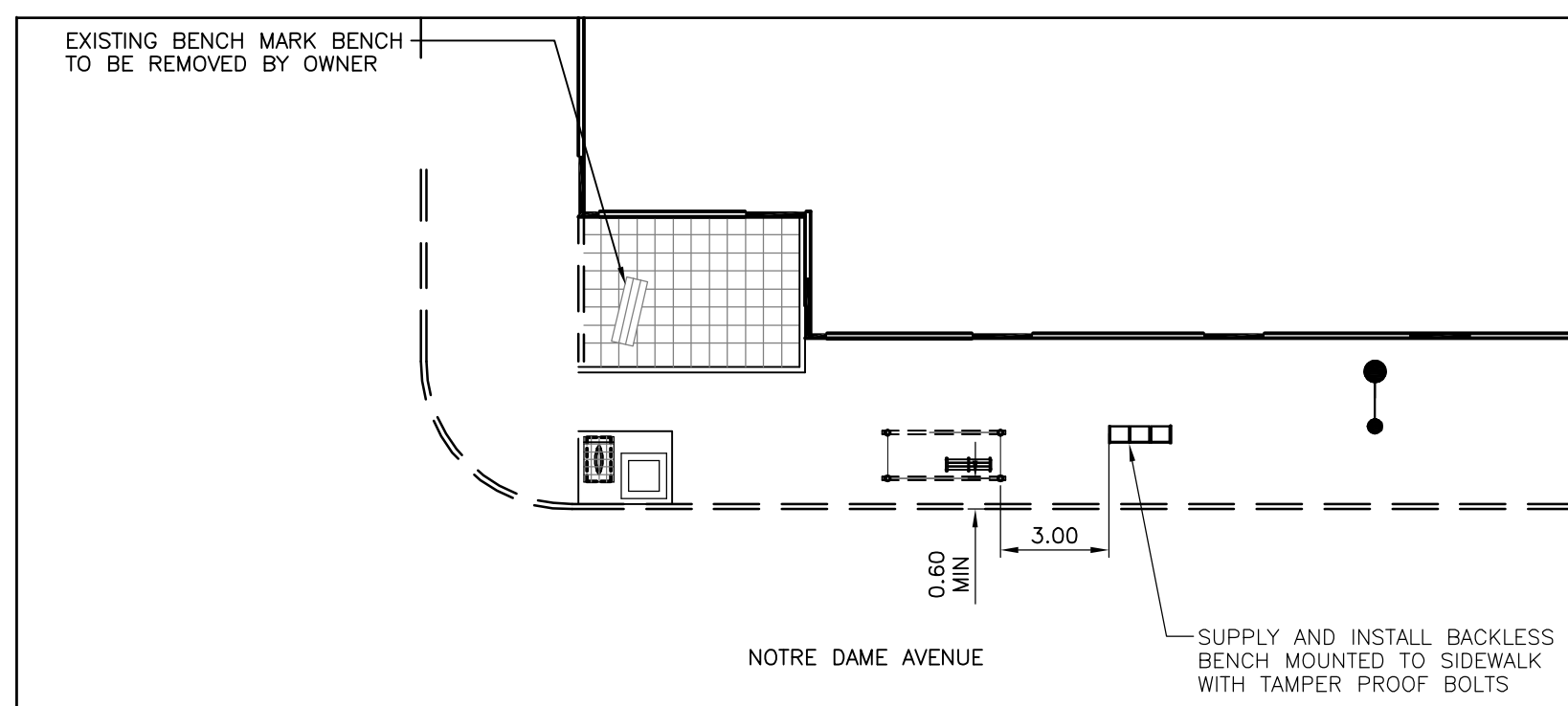

Westbound Notre Dame, N/S Arlington
Stop 10417 Arlington

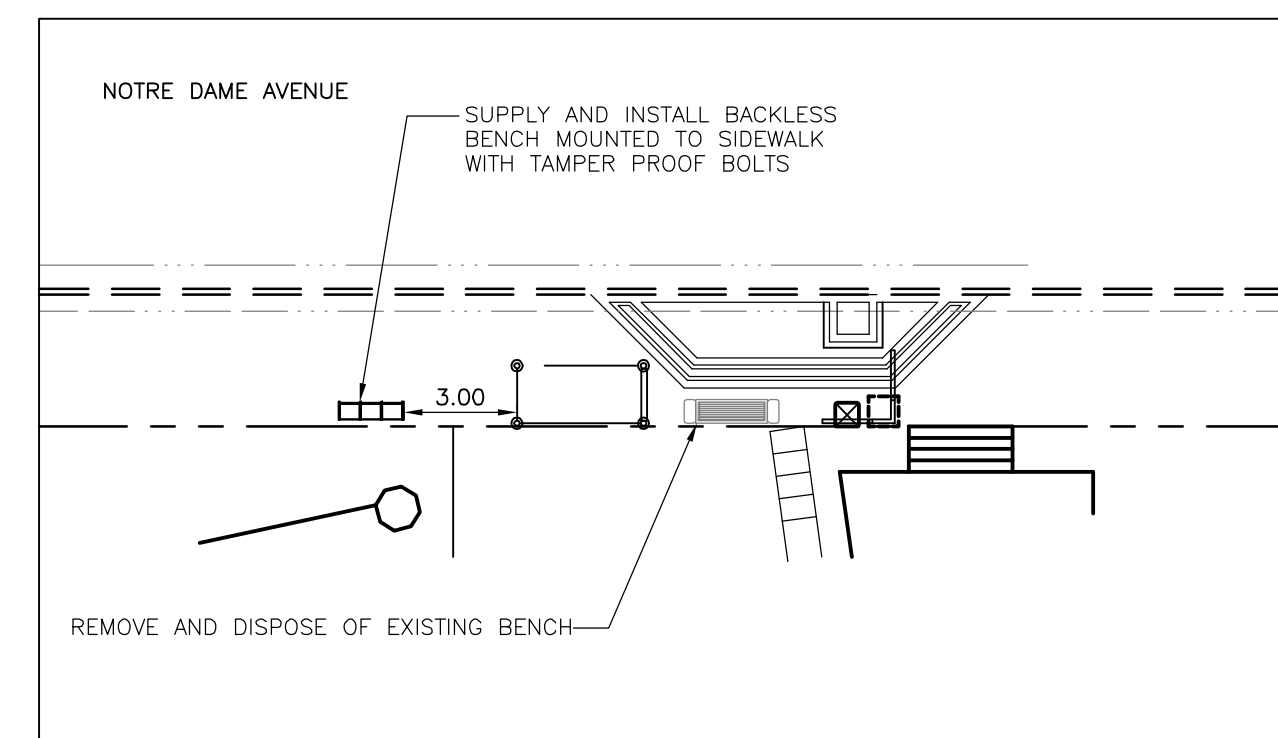

Eastbound Notre Dame, F/S McGee
Stop 10422 McGee (Health Sciences Centre)

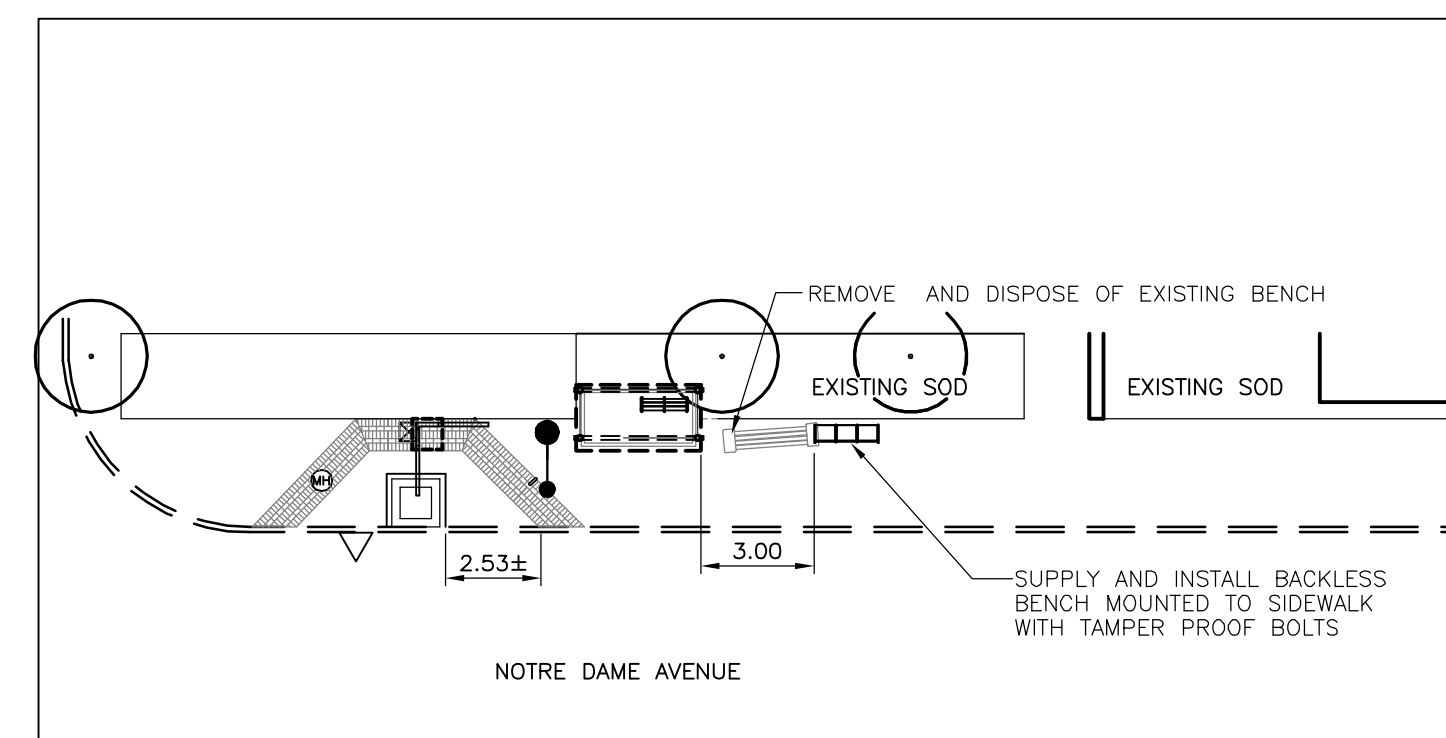

Westbound Notre Dame, N/S Pearl
Stop 10423 Pearl

No.	Revisions	Date	By
02-04-08	1:200		
Designed By	Drawn By	Checked By	
JW	SAS	JW	

Seals

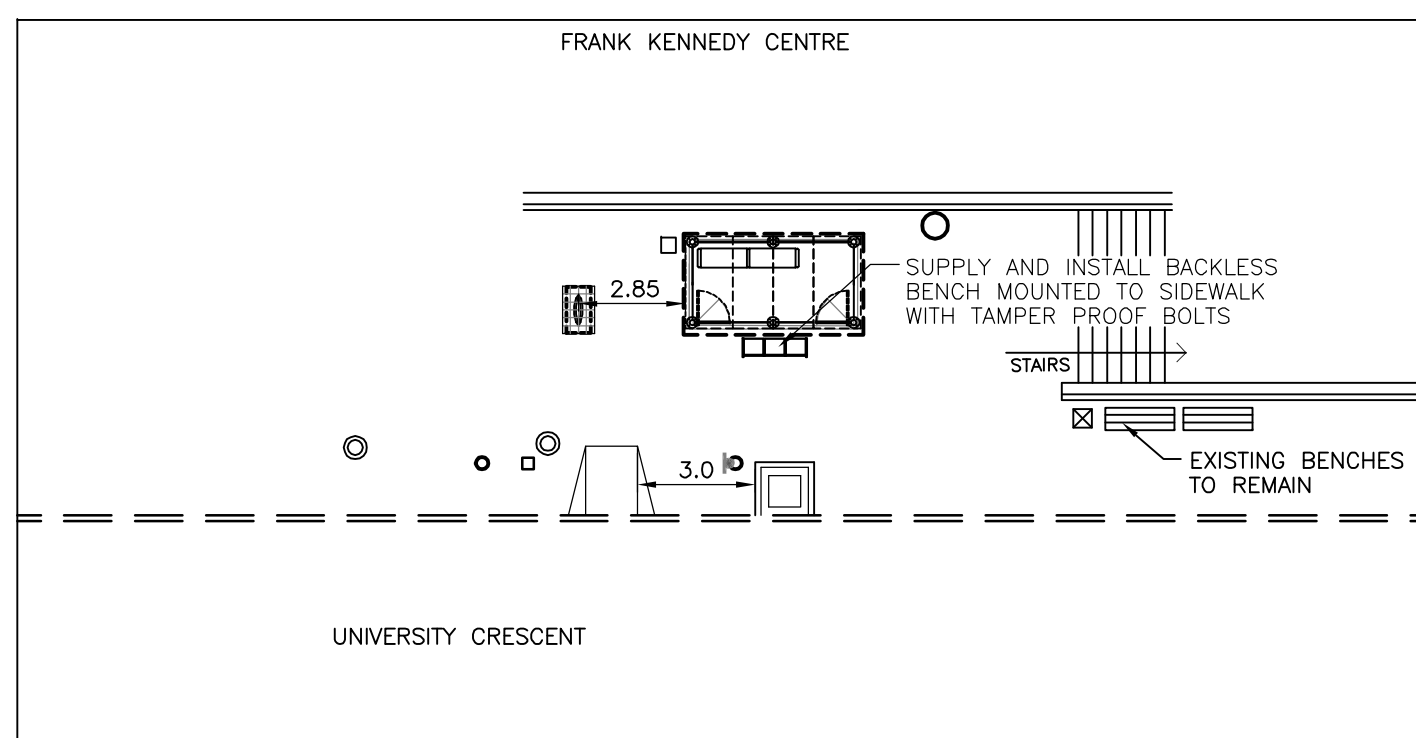

Northbound University, N/S Opp Chancellor Matheson
Stop 60103 Chancellor Matheson

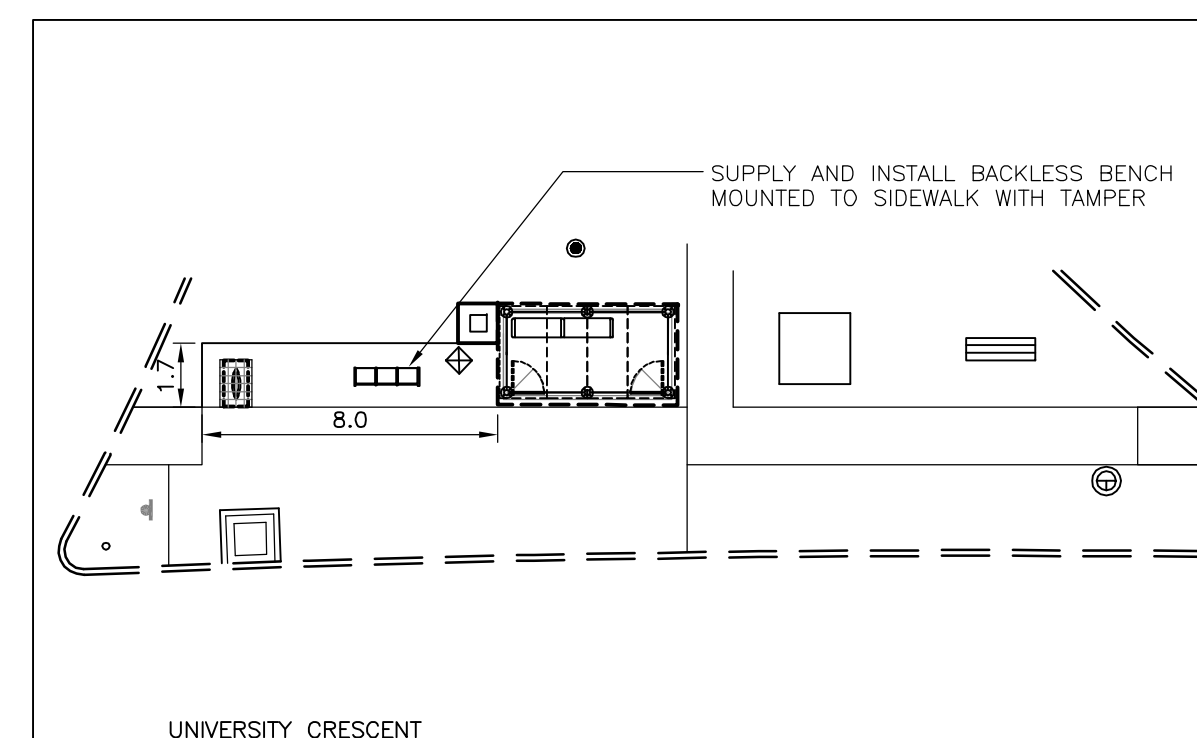

Northbound University, N/S Dysart
Stop 60108 Dysart

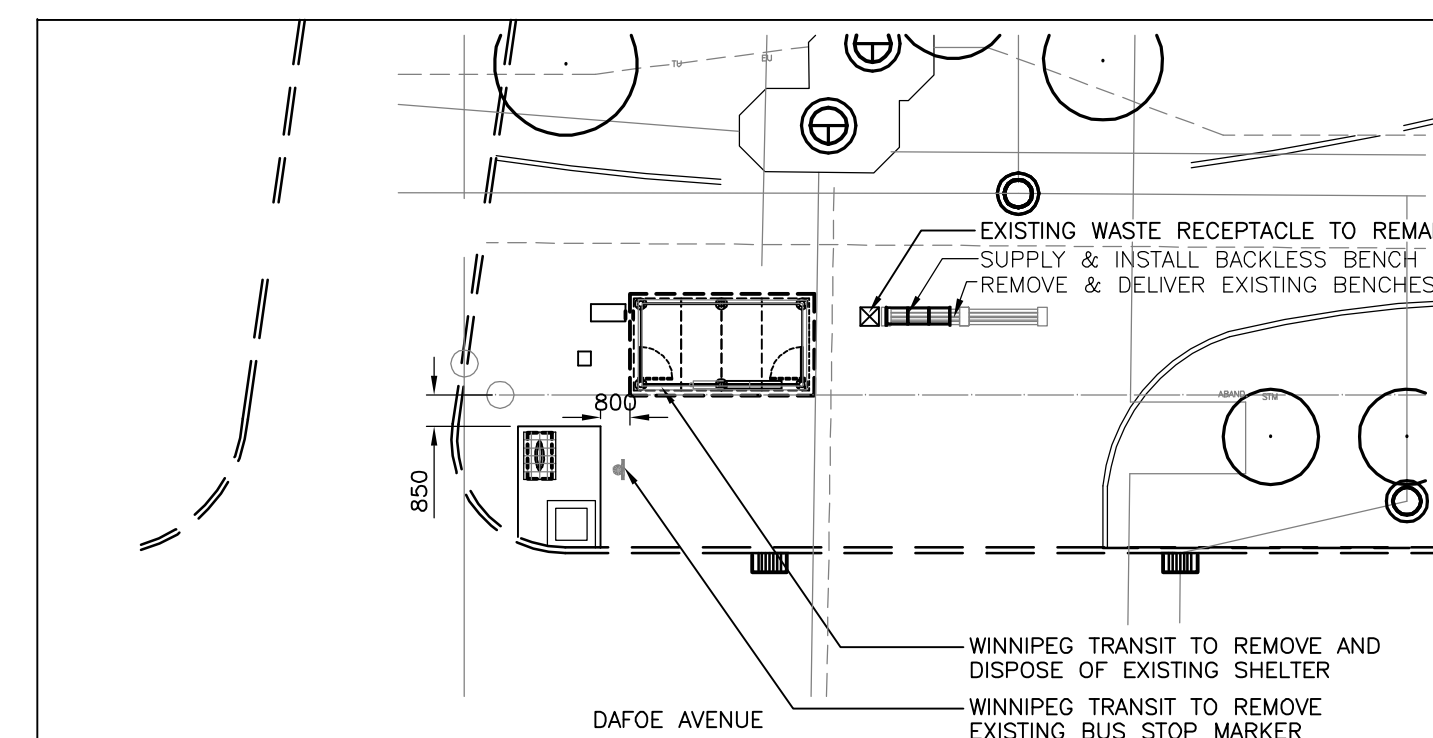

Westbound Dafoe, N/S University
Stop 60105 Dafoe

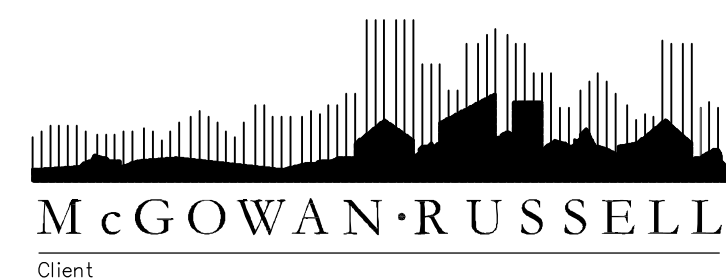

Client
WINNIPEG TRANSIT
Project Title
SUPPLY AND INSTALL BENCHES FOR WINNIPEG TRANSIT - PHASE 2

Sheet Title
SITE LAYOUT PLANS 2 OF 4

Project No. 06-029 Drawing No. B1.2