

**SITE PLAN**  
SCALE 1:100  
01-S-0001

**DRAWING NOTES**

- GENERAL**
- DO NOT SCALE DRAWINGS.
  - VERIFY ALL DIMENSIONS SHOWN PRIOR TO COMMENCING CONSTRUCTION.
  - VERIFY WEIGHT AND LOCATION OF ALL EQUIPMENT ON STRUCTURE AND REPORT ANY DISCREPANCIES TO CONTRACT ADMINISTRATOR PRIOR TO CONSTRUCTION.
  - LOCATE UNDERGROUND SERVICES AND PROTECT THEM AT ALL TIMES DURING CONSTRUCTION.
  - STRUCTURAL DRAWINGS SHOWING THE COMPLETED STRUCTURE DO NOT INDICATE COMPONENTS WHICH MAY BE NECESSARY FOR SAFETY DURING CONSTRUCTION.
- SELECTIVE DEMOLITION**
- REMOVE ITEMS AND MATERIALS WHERE SHOWN ON DRAWINGS. REMOVE ONLY MATERIALS REQUIRED TO ACCOMMODATE NEW CONSTRUCTION.
  - PROTECT WORK TO REMAIN.
  - PROVIDE PROTECTION TO PERSONNEL WORKING IN ADJACENT AREAS, AND TO THE PUBLIC.
  - CAP OFF AND MAKE SAFE MECHANICAL AND ELECTRICAL SERVICES AS REQUIRED.
  - STORE AND PROTECT MATERIALS AND ITEMS TO BE INSTALLED IN RENOVATED AREAS.
  - REMOVE FROM SITE ALL MATERIALS NOT REQUIRED.

- EARTHWORK**
- EXCAVATE AS REQUIRED AND REMOVE FROM SITE MATERIALS NOT REQUIRED FOR BACK FILL OR GRADING.
  - BACKFILL WITH MATERIALS INDICATED ON DRAWINGS AND SPECIFICATIONS.
  - COMPACTION (STANDARD PROCTOR DRY DENSITY %)  
 .1 SUB GRADE: 95%  
 .2 UNDER SLAB-ON-GRADE 100%
  - GRADE AND FILL SITE TO ELEVATION SHOWN ALLOWING TOPSOIL, PLANTING OR GRADE PAVEMENTS.
  - FILL IN 8" (200mm) LIFTS (LOOSE) AND COMPACT EACH LIFT TO REQUIRED DENSITY.

- CAST-IN-PLACE CONCRETE**
- ALL CONCRETE TO BE MANUFACTURED AND INSTALLED IN ACCORDANCE WITH LATEST EDITION OF CSA A23.1 AND CSA A23.2.
  - CONCRETE STRENGTH AT 28 DAYS SHALL BE AS FOLLOWS UNLESS NOTED OTHERWISE ON DRAWINGS.
- SLABS-ON-GRADE:**  
 32MPa;  
 SLUMP MAX. 70mm;  
 AGGREGATE MAX. 20mm;  
 ENTRAINED AIR 5-8%
- AIR ENTRAINING ADMIXTURES SHALL CONFORM TO REQUIREMENTS OF CSA A266.4.

- REINFORCING STEEL**
- ALL REINFORCING STEEL TO BE CSA G30.12M 400W MPa DEFORMED BARS. ALL REINFORCING TO BE DETAILED IN ACCORDANCE WITH LATEST EDITION OF ACI DETAILING MANUAL, UNLESS OTHERWISE NOTED.
  - ALL REINFORCING TO BE HELD IN PLACE AND TIED WITH PROPER ACCESSORIES, SUCH AS HI-CHAIRS AND SPACERS. SUPPLY AND DETAIL ALL ACCESSORIES. HI-CHAIRS TO HAVE 4 LEGS AND TO BE STAPLED OR NAILED TO FORMWORK.
  - ALL OPENINGS THROUGH CAST-IN-PLACE CONCRETE TO BE TRIMMED WITH 2-15M EXTENDING A MINIMUM OF 24" (600mm) PAST OPENING UNLESS NOTED OTHERWISE.
- METAL FABRICATIONS**
- PROVIDE SHOP DRAWINGS FOR APPROVAL PRIOR TO CONSTRUCTION.
  - MATERIAL: (GALVANIZED) STEEL AND PAINTED
  - WELDING: STEEL TO CSA W59-M1989
  - STEEL SECTIONS AND PLATES: TO CAN3 G40.21-92 GRADE 300W.
  - STEEL PIPE: TO ASTM A53.
  - BOLTS AND ANCHOR BOLTS: STAINLESS STEEL

| SURVEY BAR CONTROL POINTS |  |         |
|---------------------------|--|---------|
|                           | LOCAL COORDINATE SYSTEM (GROUND DISTANCES) |         |
| CONTROL POINTS            | NORTHING                                   | EASTING |
| SURVEY BAR#1              | 2732.674                                   | 10.459  |
| SURVEY BAR#2              | 2733.482                                   | 293.089 |

| WORKING POINT COORDINATES |  |         |
|---------------------------|--|---------|
|                           | LOCAL COORDINATE SYSTEM (GROUND DISTANCES) |         |
| W.P.                      | NORTHING                                   | EASTING |
| W.P. 1                    | 2850.641                                   | 374.276 |
| W.P. 2                    | 2850.641                                   | 389.276 |

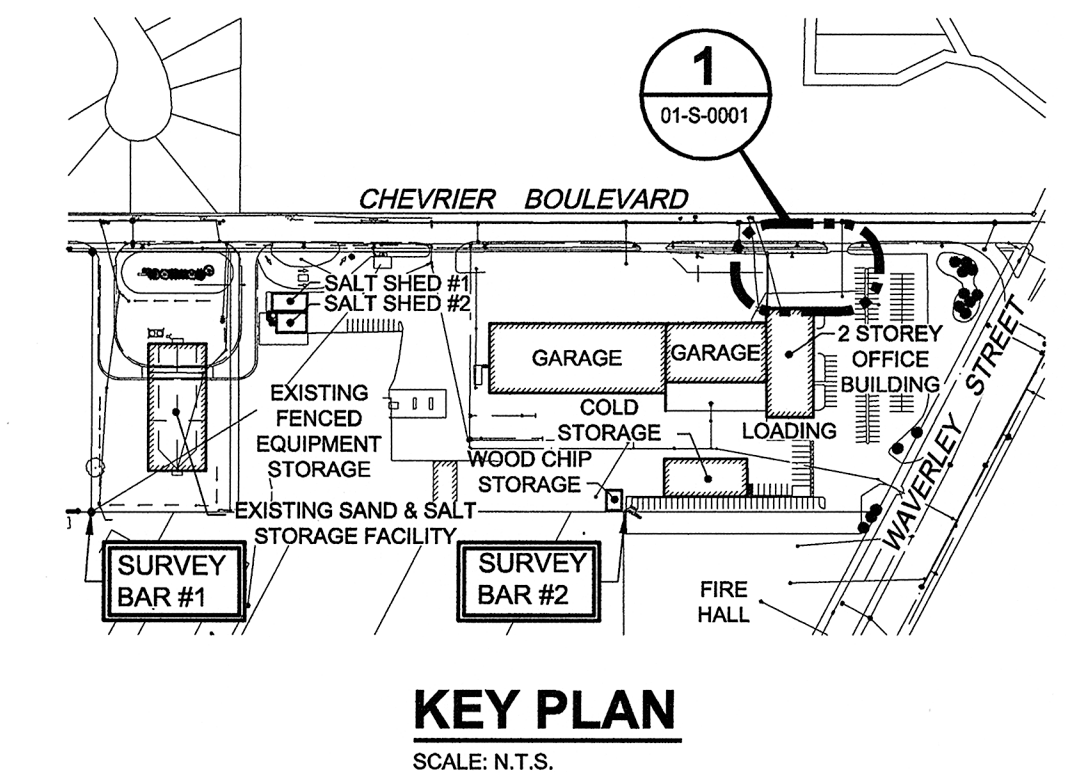

DO NOT SCALE THIS DOCUMENT.  
 ALL MEASUREMENTS MUST BE OBTAINED FROM STATED DIMENSIONS.  
 © 2008 UMA ENGINEERING LTD. ALL RIGHTS RESERVED.  
 THIS DOCUMENT IS PROTECTED BY COPYRIGHT LAW AND MAY NOT BE REPRODUCED IN ANY MANNER, OR FOR ANY PURPOSE EXCEPT BY THE WRITTEN PERMISSION OF UMA ENGINEERING LTD.

**PRELIMINARY**  
 NOT FOR CONSTRUCTION  
 Date: 08/05/06

| I/R | YY/MM/DD | ISSUE/REVISION DESCRIPTION            | DRN | CHK | DES | ENG | IDR | APP |
|-----|----------|---------------------------------------|-----|-----|-----|-----|-----|-----|
| D   | 08/05/06 | Revised For Bid - With Owner Comments | EDM | MP  | CGC | SBB | SBB | BLL |
| C   | 08/04/21 | Issued For Bid                        | MP  | CGC | SBB | SBB | BLL | -   |
| B   | 08/04/07 | Issued For Review                     | MP  | CGC | SBB | SBB | BLL | -   |
| A   | 08/03/07 | Issued For Review                     | MP  | CK  | SBB | SBB | WJ  | -   |



**City of Winnipeg**  
 Construction of a New Fueling Facility  
 District 6 Public Works Yard, 1539 Waverley St.  
**Structural Site Plan**

|                |                |                |
|----------------|----------------|----------------|
| PROJECT NUMBER | DRAWING NUMBER | ISSUE/REVISION |
| 0265-405-00    | 01-S-0001      | D              |