

GIBRALTAR BY

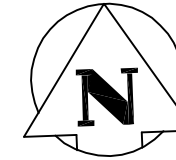

SEWER JUNCTION INFORMATION  
REFERENCE—METERS WEST OF MANHOLE MH20001762

| DIST. FROM REF. MANHOLE | JUNCTION DIA. | CLOCK REF. | SERVICE TYPE |
|-------------------------|---------------|------------|--------------|
| 2.4                     | 150           | 09         | CX           |
| 3.0                     | 150           | 03         | CN           |

ALL JUNCTION INFORMATION  
BASED ON CCTV INSPECTION

REFERENCE—METERS EAST OF MANHOLE MH20001764

| DIST. FROM REF. MANHOLE | JUNCTION DIA. | CLOCK REF. | SERVICE TYPE |
|-------------------------|---------------|------------|--------------|
| 4.6                     | 150           | 03         | CX           |

ALL JUNCTION INFORMATION  
BASED ON CCTV INSPECTION

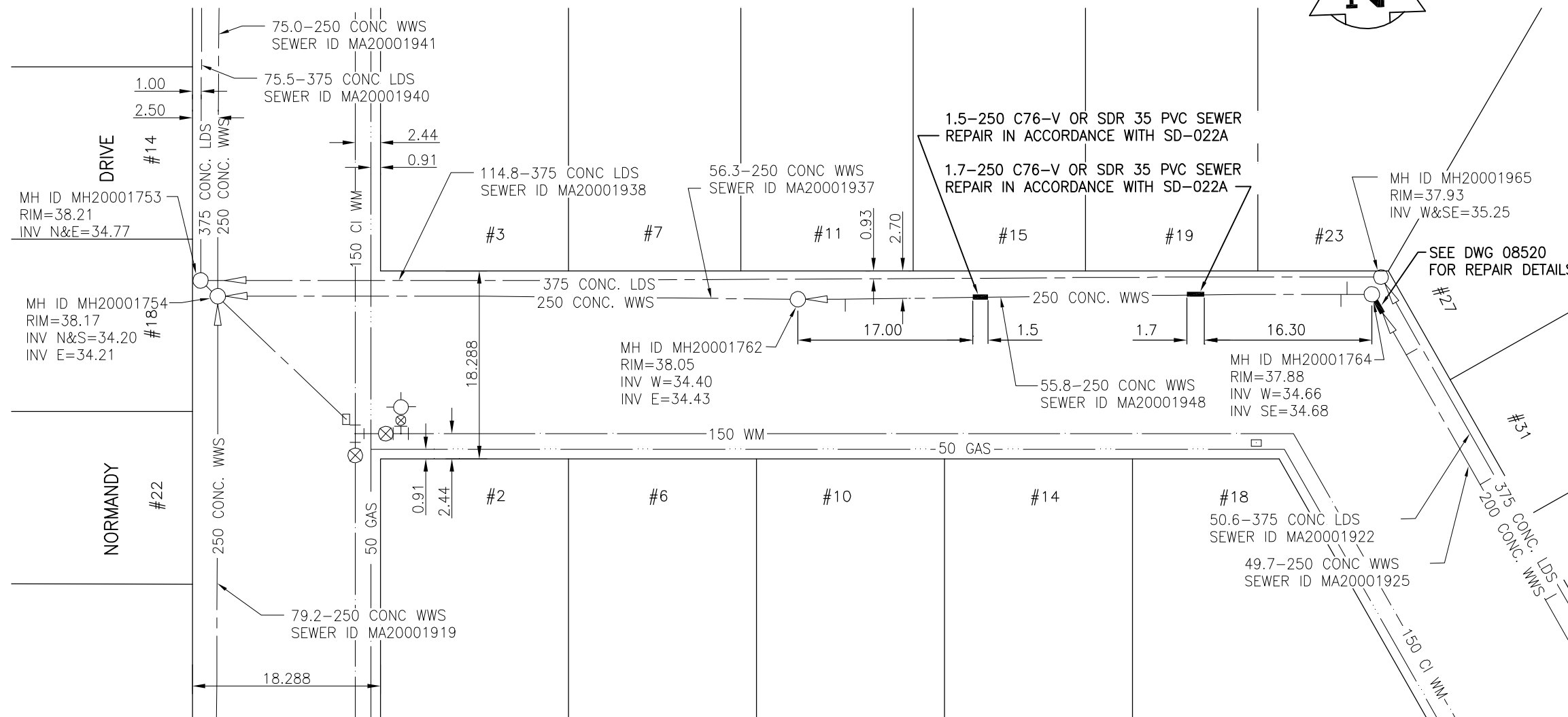

METRIC

WHOLE NUMBERS INDICATE MILLIMETRES  
DECIMALIZED NUMBERS INDICATE METRES

WARNING

IF POWER EQUIPMENT OR EXPLOSIVES ARE TO BE USED FOR EXCAVATION ON THIS PROJECT THE CONTRACTOR MUST:  
1) NOTIFY THE GAS COMPANY OF THE PROPOSED LOCATION OF EXCAVATION.  
2) TAKE PRECAUTION TO AVOID DAMAGE TO GAS COMPANY INSTALLATIONS.  
SEE PROVINCIAL REGULATION 140/92 FOR DETAILS

BENCH MARK: E. side Cavalier Dr. @ Lumsden Ave., tblt. in W. conc. foundation No. 959 Cavalier Dr., 0.5m S. & 0.2m below stucco of N.W. cor. of dwelling.



Certificate of Authorization

Stantec Consulting Ltd.

No. 1301 Expiry: April 30, 2009

BID OPPORTUNITY 391-2008

LOCATION APPROVED UNDERGROUND STRUCTURES

SUPV. U/G STRUCTURES COMMITTEE DATE

NOTE:  
LOCATION OF UNDERGROUND STRUCTURES AS SHOWN ARE BASED ON THE BEST INFORMATION AVAILABLE BUT NO GUARANTEE IS GIVEN THAT ALL EXISTING UTILITIES ARE SHOWN OR THAT THE GIVEN LOCATIONS ARE EXACT. CONFIRMATION OF EXISTENCE AND EXACT LOCATION OF ALL SERVICES MUST BE OBTAINED FROM THE INDIVIDUAL UTILITIES BEFORE PROCEEDING WITH CONSTRUCTION.

|                               |           |      |    |
|-------------------------------|-----------|------|----|
| B.M. 40-020<br>ELEV. 237.963m |           |      |    |
| NO.                           | REVISIONS | DATE | BY |
|                               |           |      |    |



Stantec Consulting Ltd.

905 Waverley Street, Winnipeg, Manitoba  
Tel 204-489-5900 Fax 204-453-9012

|             |           |                            |        |
|-------------|-----------|----------------------------|--------|
| DESIGNED BY | J.K.H.    | CHECKED BY                 | W.A.B. |
| DRAWN BY    | W.B.G.    | APPROVED BY                | H.A.K. |
| HOR. SCALE: | 1:500     | RELEASED FOR CONSTRUCTION: |        |
| VERTICAL:   | N/A       | DATE                       |        |
| NO.         | REVISIONS | DATE                       | BY     |
|             |           | 08.04.22                   |        |

ENGINEER'S SEAL



CONSULTANT DRAWING NO.  
C-220



THE CITY OF WINNIPEG  
WATER AND WASTE DEPARTMENT

2008 WATERMAIN RENEWALS, SEWER RENEWALS, AND EXTERNAL POINT REPAIRS - CONTRACT 7  
GIBRALTAR BY (N. LEG)  
1ST MH E OF NORMANDY TO 2ND MH E OF NORMANDY  
250 WWS POINT REPAIR

|   |    |
|---|----|
| SHEET   | OF |
| 20  | 26 |
| CAD FILE DRAWING NUMBER<br>10340c-220-702.dwg |    |
| CITY DRAWING NUMBER<br>08521                  |    |