

**ALLEY PAVEMENT PROFILE**  
SCALE: 1:250 HOR  
1:10 VER

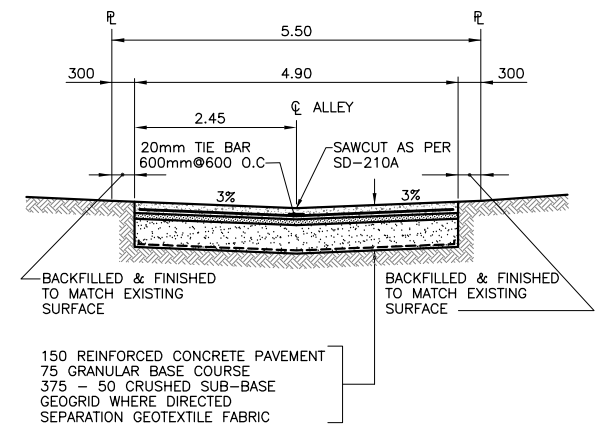

**TYPICAL CROSS SECTION**  
SCALE: NTS

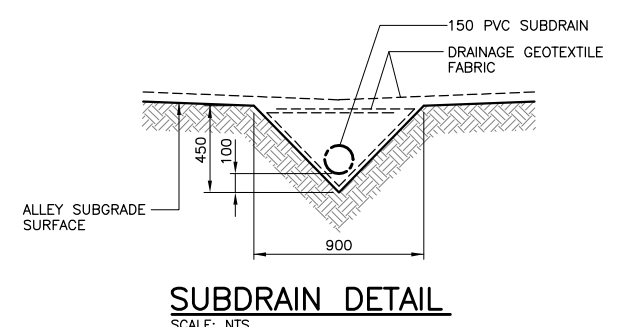

**SUBDRAIN DETAIL**  
SCALE: NTS

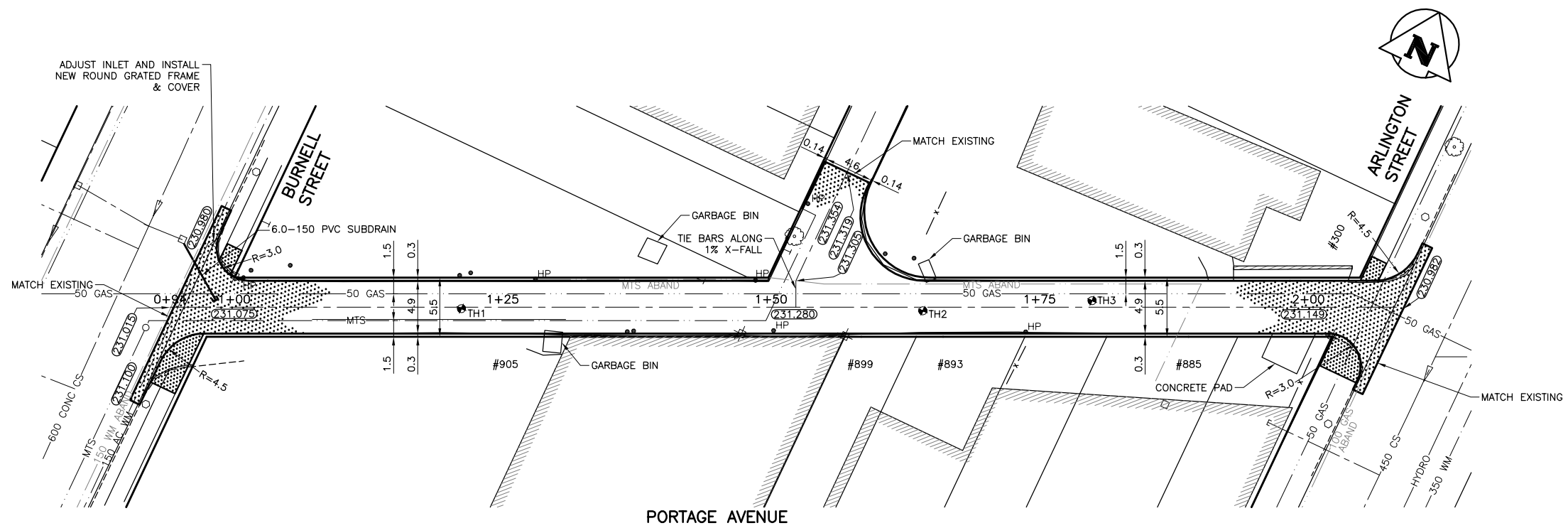

**ALLEY PAVEMENT PLAN**  
SCALE: 1:250 HOR

- NOTE:**
1. STATION CHAINAGE IS BASED ON CENTERLINE OF ALLEY RIGHT OF WAY.
  2. ADJUST MH AND CB RIMS TO NEW GRADES.
  3. PLUG SUBDRAINS AT TERMINAL ENDS.
  4. REGRADE EXISTING PRIVATE SIDEWALKS AS REQUIRED.
  5. INSTALLATION OF LIP CURBS AND THEIR EXTENTS TO BE DETERMINED BY THE CONTRACT ADMINISTRATOR.
  6. LIGHT STANDARDS, HYDRO POLES AND ANCHORS MAY REQUIRE TEMPORARY SUPPORT/REMOVAL OR REPLACEMENT AT THE CONTRACTOR'S EXPENSE.
  7. ISOLATE ALL POLES, BASES AND PILES WITHIN ALLEY RIGHT OF WAY (SD-228C)
  8. AVOID DAMAGE TO EXISTING TREES WITHIN THE LIMITS OF CONSTRUCTION.

**PROPERTY LIMITS DELINEATION**

DELINEATION OF PROPERTY LIMITS AS SHOWN ON THIS DWG DOES NOT REPRESENT A "LEGAL SURVEY". KGS GROUP MAKES NO REPRESENTATION OR WARRANTY AS TO THE ACCURACY OF PROPERTY LIMITS DELINEATED ON THIS DWG, NOR ON THE DIMENSIONAL ACCURACY OF DWG FEATURES RELATIVE TO THOSE PROPERTY LIMITS.

**WARNING**

1. NOTIFY THE GAS COMPANY OF THE PROPOSED LOCATION OF EXCAVATION.
2. TAKE PRECAUTION TO AVOID DAMAGE TO GAS COMPANY INSTALLATIONS.
3. SEE PROVINCIAL REGULATION 210/72 FOR DETAILS.

**METRIC**

WHOLE NUMBERS INDICATE MILLIMETRES  
DECIMALIZED NUMBERS INDICATE METRES

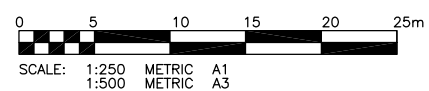

300 LBS	LAND DRAINAGE SEWER	300 LBS		TEST HOLE			
250 WWS	WASTE WATER SEWER	250 WWS		GUY WIRE			
---	GAS	---		LIGHT STANDARD			
---	HYDRO	---		BACK OF CURB			
---	M.T.S.	---		CONCRETE			
150 WM	WATERMAIN	150 WM		ASPHALT			
+	HYDRANT	+		SIDEWALK			
+	VALVE	+		PROPERTY LINE			
○	MANHOLE	○		SURVEY BAR			
□	CATCH BASIN	□		GEODETIC BENCHMARK			
▽	CURB INLET	▽		ELEVATION			
•	POLES	•					
---	LEGEND-PLAN	---					
---	LEGEND-PROFILE	---					

**LOCATION APPROVED UNDERGROUND STRUCTURES**

SUPV. U/G STRUCTURES DATE COMMITTEE

**NOTE:**  
LOCATION OF UNDERGROUND STRUCTURES AS SHOWN ARE BASED ON THE BEST INFORMATION AVAILABLE BUT NO GUARANTEE IS GIVEN THAT ALL EXISTING UTILITIES ARE SHOWN OR THAT THE GIVEN LOCATIONS ARE EXACT. CONFIRMATION OF EXISTENCE AND EXACT LOCATION OF ALL SERVICES MUST BE OBTAINED FROM THE INDIVIDUAL UTILITIES BEFORE PROCEEDING WITH CONSTRUCTION.

B.M. 37-044 ELEV. 232.936m	S.W. COR. PORTAGE AVE. & HOME ST., TBLT. IN MOST SLY. CONC. FOUNDATION (R REAR) NO. 870 PORTAGE AVE (C.M.H.C.), 0.5m W. & 0.3m BELOW BRICK OF MOST SLY. & E. COR. OF BLDG.
NO. REVISIONS	DATE BY
0	ISSUED FOR CONSTRUCTION 14/07/08 CR
	DATE 12/05/08

**KGS CONSULTING ENGINEERS & PROJECT MANAGERS GROUP**  
WINNIPEG (204) 896-1209  
THUNDER BAY (807) 345-2233

DESIGNED BY: CR  
CHECKED BY: RJH  
DRAWN BY: DW/CR  
APPROVED BY:

HOR. SCALE: 1:250  
VERTICAL: 1:50

RELEASSED FOR CONSTRUCTION: DATE

ENGINEER'S SEAL

ORIGINAL SIGNED BY  
**M.C. ROWBOTHAM**  
14/07/08

CONSULTANT DRAWING NO.  
**07-0107-15**

**THE CITY OF WINNIPEG**  
PUBLIC WORKS DEPARTMENT  
TRANSPORTATION ENGINEERING DIVISION

PROJECT TITLE  
**2008 ALLEY RENEWAL PROGRAM  
NORTH AREA - CONTRACT 2  
PORTAGE AVE NORTH ALLEY  
BURNELL ST TO ARLINGTON ST  
STA. 0+94.0 TO STA. 2+08.2**

SHEET OF  
**01** OF **09**

COMPUTER FILE NAME  
**PORTAGE.DWG**

CITY DRAWING NUMBER  
**0001**

P:\PROJECTS\2007\07-0107-15\MUN\DWGS\SO\CONTRACT\PORTAGE\DWG\PORTAGE.DWG  
PLOT 1:1 (A1)