

STA: 15+00

STA: 22+50

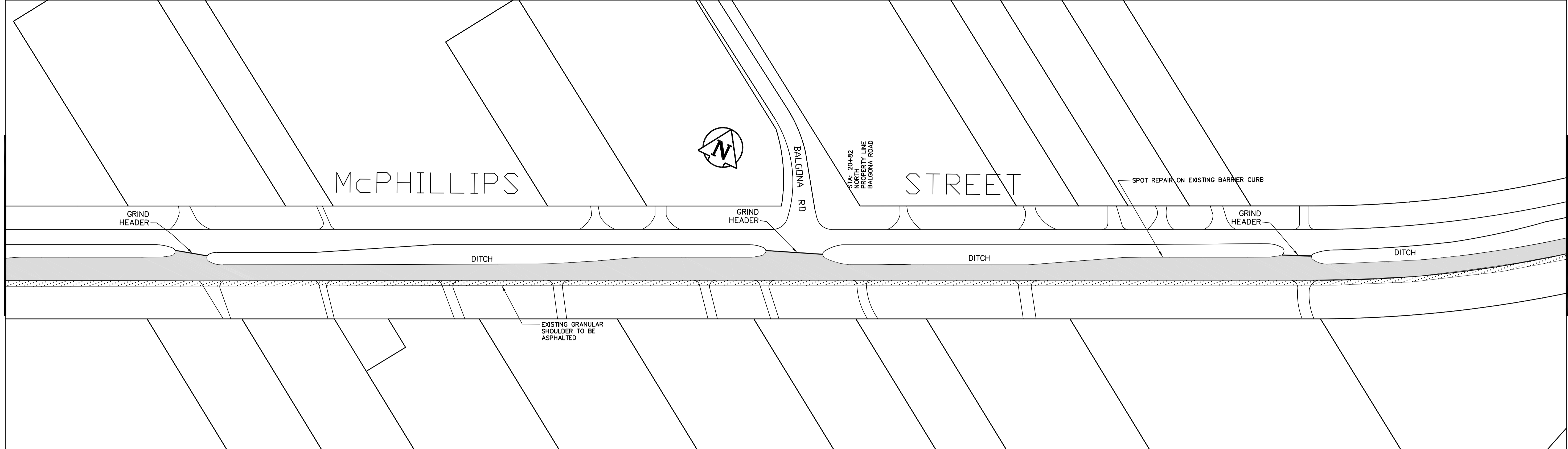

STA: 22+50

EMES ROAD

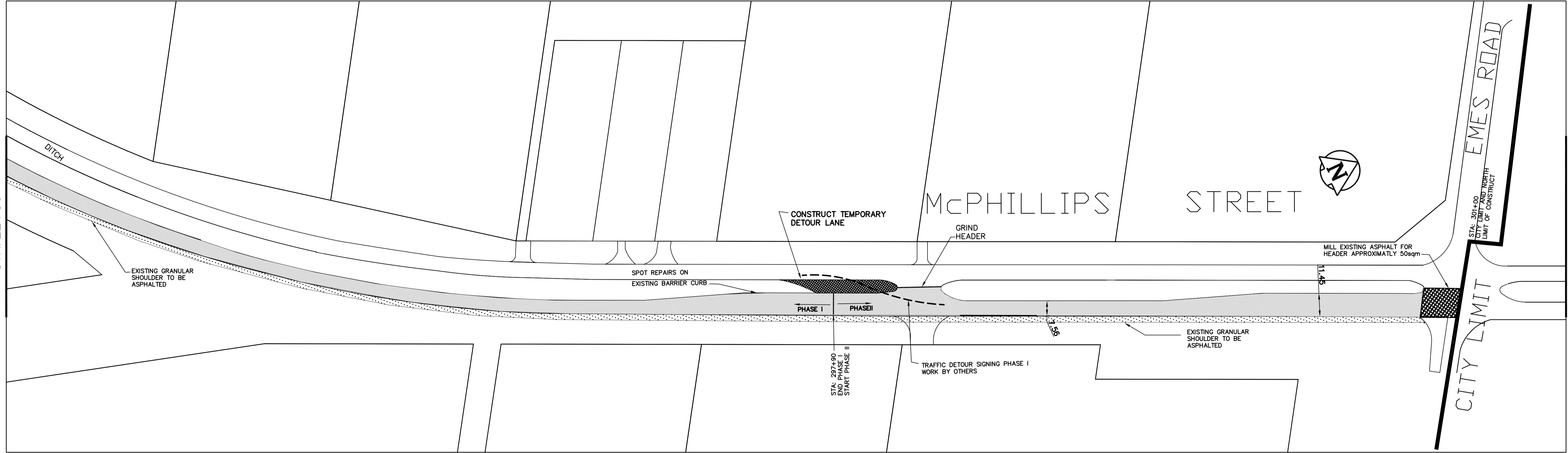

METRIC
WHOLE NUMBERS INDICATE MILLIMETRES
DECIMALIZED NUMBERS INDICATE METRES
ADD 200.00 TO ELEVATIONS TO OBTAIN GEODEIC DATUM

BID OPPORTUNITY 465-2008

EXISTING	LEGEND - PLAN	PROPOSED	EXISTING	LEGEND - PLAN	PROPOSED	EXISTING	LEGEND - PROFILE	PROPOSED
150 mm WM	WATERMAIN	150 mm WM	---	HYDRO	---	150 mm WM	WATERMAIN	---
+	HYDRANT VALVE	+	---	MTS	---	+	HYDRANT VALVE	---
300 mm LDS	LAND DRAINAGE SEWER	300 mm LDS	---	CONCRETE	---	X	SEWER	---
250 mm WWS	WASTE WATER SEWER MANHOLE	250 mm WWS	---	LIMIT OF ASPHALT	---	---	SOUTH/EAST P	---
o	CATCH BASIN	o	---	CURB RENEWAL	---	---		---
□	CURB INLET	▲	---	ASPHALT	---	---		---
△	WOOD POLES	▲	---	ASPHALT OVERLAY	---	---		---
○	LAMP STANDARD	○	---	PAVING STONE	---	---		---
---	GAS	---	---	PROPERTY LINE	---	---		---
				SURVEY BAR	---			
				RAMP CURB	---			

LOCATION APPROVED UNDERGROUND STRUCTURES

NO. REVISIONS DATE BY

NOTE: LOCATION OF UNDERGROUND STRUCTURES AS SHOWN ARE BASED ON THE BEST INFORMATION AVAILABLE. BUT NO GUARANTEE IS GIVEN THAT ALL EXISTING UTILITIES ARE SHOWN OR THAT THE GIVEN LOCATIONS ARE EXACT. CONFIRMATION OF EXISTENCE AND EXACT LOCATION OF ALL SERVICES MUST BE OBTAINED FROM THE INDIVIDUAL UTILITIES BEFORE PROCEEDING WITH CONSTRUCTION.

B.M. ELEV.					

DESIGNED BY	ASF	CHECKED BY	BK
DRAWN BY	ASF	APPROVED BY	P.S. PAUL
HOR. SCALE:	N.T.S.	RELEASED FOR CONSTRUCTION	
VERTICAL:			
DATE	08/06/01	DATE	

ENGINEER'S SEAL

ORIGINAL SIGNED BY P.S. PAUL ON JUNE 10, 2008

THE CITY OF WINNIPEG
PUBLIC WORKS DEPARTMENT

McPHILLIPS STREET NORTH BOUND
ALTERNATE CONCRETE REPAIRS AND ASPHALT OVERLAY
FROM SWAILES AVENUE TO EMES ROAD

FROM STA: 15+00
TO EMES ROAD

CITY DRAWING NUMBER SE-08-35
SHEET 2 OF 2

2