

CHAINAGE ALONG SOUTH PROPERTY LINE OF ANTRIM ROAD
ANTRIM ROAD

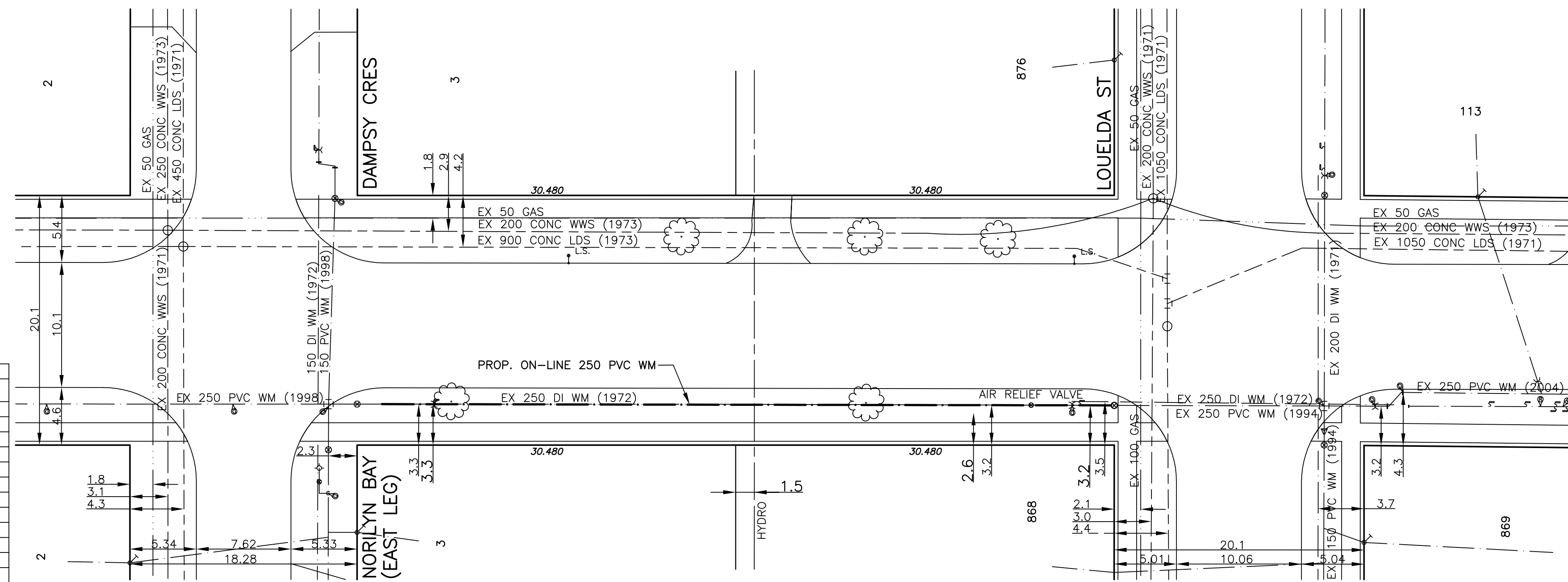

ADDRESS & NATURE OF SERVICE	SIZE	TYPE (Street)	SHORT & LONG MEASUREMENT	REMARKS
140 Antrim Road	34	Copper	7.6 N OF S HOUSE CORNER	CORP. LONG 39.60' SSL
Residential			6.2 W OF SIDE HOUSE	ANTRIM RD, MULLER CORP
151 Antrim Road	10	Copper	5.6 WE HOUSE CORNER	DOUBLE SERV WITH 153
Residential			8.7 FROM HOUSE FRONT	CORP MEAS: 111.
2 Dampsey Crescent	34	Copper	7.9 N OF S HSE CORNER	
Residential			9.8 FROM HOUSE FRONT	
3 Dampsey Crescent	34	Copper	5.5 N OF SL OF HOUSE	
Residential			7.9 FROM GARAGE F LINE	
868 Louelda Street	34	Copper	6.4 N OF S HOUSE CORNER	CORP. MEAS: 54.8' N OF 1ST HYDRANT S OF
Residential			9.5 FROM HSE FRONT	ANTRIM. WATERMAIN RENEWAL
876 Louelda Street	34	Copper	4.9 S OF N HOUSE CORNER	TAX-NKLD-50312-04
Residential			10.1 FROM HSE FRONT	
2 Norilyn Bay	34	Copper	5.9 S OF N HSE CORNER	CORP. LONG 28.9' SSL
Residential				ANTRIM RD, MULLER CORP
3 Norilyn Bay	34	Copper	4.3 S N HL	CORP. LONG 25.9' SSL
Residential				ANTRIM RD, MULLER CORP
95 Norilyn Bay	34	Copper	5.8 S OF N HSE CORNER	CORP. LONG 25.3' SSL
Residential				ANTRIM RD, MULLER CORP
3 Rockspur Street	34	Copper	4.3 N S HSE CORNER	
Residential			9.1 HSE FRONT	

EXISTING	LEGEND - PLAN	PROPOSED	EXISTING	LEGEND - PLAN	PROPOSED	EXISTING	LEGEND - PROFILE	PROPOSED
—	WATERMAIN	—	—	REDUCER	—	—	150mm W.M.	—
—	HYDRANT VALVE	—	—	PLUG	—	—	WATERMAIN VALVE	—
—	LAND DRAINAGE SEWER	—	—	TRAFFIC SIGNAL	—	—	LAND DRAINAGE SEWER	—
—	WASTE WATER SEWER	—	—	GAS	—	—	WASTE WATER SEWER	—
—	MANHOLE	—	—	HYDRO	—	—	JUNCTIONS	—
—	CATCH BASIN	—	—	M.T.S.	—	—	CULVERT	—
—	CURB INLET	—	—	SURVEY BAR	—	—		—
—	TEE	—	—	CURB STOP	—	—		—
—	BEND	—	—	C.B. LEAD	—	—		—
—	ANODE	—	—	TREE	—	—		—
—		—	—	LAMP STANDARD	—	—		—

LOCATION APPROVED

SUPV. U/G STRUCTURES DATE COMMITTEE

NOTE:
LOCATION OF UNDERGROUND STRUCTURES AS SHOWN ARE BASED ON THE BEST INFORMATION AVAILABLE BUT NO GUARANTEE IS GIVEN THAT ALL EXISTING UTILITIES ARE SHOWN OR THAT THE GIVEN LOCATIONS ARE EXACT. CONFIRMATION OF EXISTENCE AND EXACT LOCATION OF ALL SERVICES MUST BE OBTAINED FROM THE INDIVIDUAL UTILITIES BEFORE PROCEEDING WITH CONSTRUCTION.

B.M. 011-029
ELEV. 231.192

GENIVAR
200 TACHE AVENUE WINNIPEG, MANITOBA R2H 1A7
PH: (204)-233-2113 FAX: (204)-233-2080

DESIGNED BY L.H./D.J. CHECKED BY D.J.
DRAWN BY L.H. APPROVED BY I.McK.
HOR. SCALE: 1:250
VERT. SCALE: 1:50
RELEASED FOR CONSTRUCTION K. ZUREK P.ENG.
DATE JUNE 2008 DATE JUNE 24 2008

ENGINEER OF MANITOBA
I. G. MCKINNON
REGISTERED PROFESSIONAL ENGINEER
CONSULTANT DRAWING NO. 069-023-01

THE CITY OF WINNIPEG
WATER AND WASTE DEPARTMENT

2008 CAPITOL WORKS
WATERMAIN RENEWALS
ANTRIM ROAD
NORILYN BAY (EAST LEG) TO LOUELDA STREET

SHEET 1 OF 1
CITY DRAWING NO. D-11433

APEGM
Certificate of Authorization
SEG Engineering Inc.
No. 252 Expiry: April 30, 2008

- NOTES:**
- ALL GATE VALVES ARE COUNTER-CLOCKWISE TO OPEN WITH A BLACK OPERATING NUT.
 - WATERMAIN TO BE INSTALLED BY TRENCHLESS METHODS.
 - BACKFILL IS CLASS 5 WITHIN BOULEVARD AND CLASS 3 WHEN WITHIN PAVEMENT/SIDEWALK OR WHEN WITHIN 1.0m OF PAVEMENT OR SIDEWALK.
 - WATER SERVICES ARE 19mm UNLESS OTHERWISE NOTED.
 - MINIMUM COVER TO TOP OF WATERMAIN SHALL BE 2.4m.
 - LOCATION OF ALL SERVICES TO BE CONFIRMED IN FIELD.
 - EXPOSE EXISTING WATERMAIN TO CONFIRM DEPTH PRIOR TO CONSTRUCTION.
 - ALL LEAD SERVICES TO BE RENEWED TO PROPERTY LINE.
 - SERVICES TO BE RENEWED SHALL BE REPLACED FROM WATERMAIN TO PROPERTY LINE. ALL OTHERS TO BE RECONNECTED.