

ACCESS ROAD FEEDERMAIN CROSSING: OPTION 1
1: 250

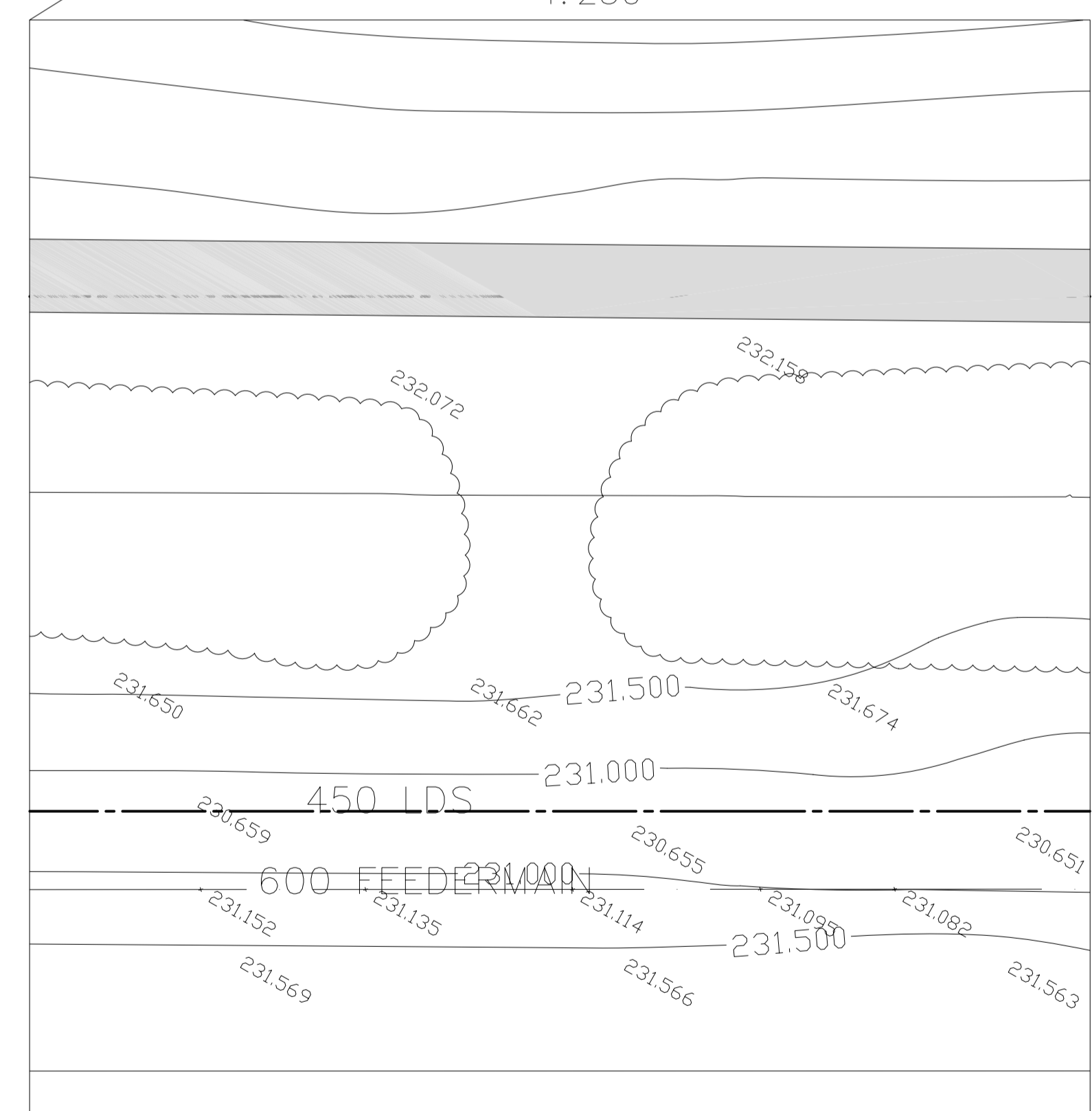

ACCESS ROAD FEEDERMAIN CROSSING: OPTION 2
1: 250

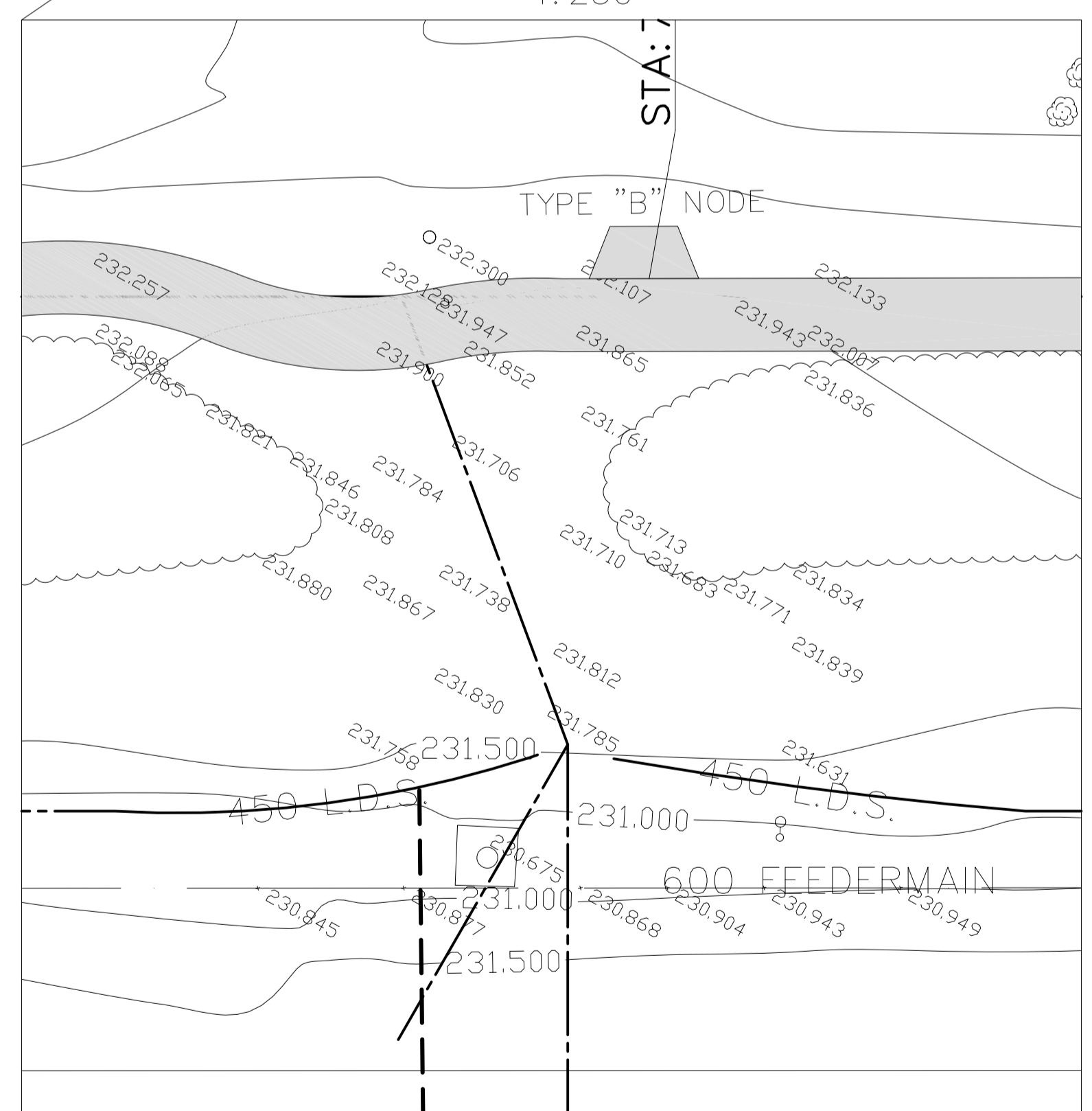

- CONSTRUCTION NOTES**
- 1) CURB REPLACEMENT AS DIRECTED BY THE CONTRACT ADMINISTRATOR
 - 2) ALL STREET RADIUS CURB UNDER 15M RADIUS SHALL BE REPLACED AS MODIFIED OR AS DIRECTED BY THE CONTRACT ADMINISTRATOR
 - 3) PAVEMENT REPAIRS SHOWN ARE ONLY A REPRESENTATIVE SAMPLE OF THE TENDERED QUANTITIES
 - 4) ASPHALT TIE-INS ON APPROACHES TO BE DETERMINED IN THE FIELD BY THE CONTRACT ADMINISTRATOR.
 - 5) ALL BULLNOSES TO HAVE SLOPED FACE.
- WARNING**
- IF POWER EQUIPMENT OR EXPLOSIVES ARE TO BE USED FOR EXCAVATION ON THIS PROJECT THE CONTRACTOR MUST:
- 1) OBTAIN CLEARANCE FROM THE GAS UTILITY PRIOR TO EXCAVATION.
 - 2) TAKE PRECAUTION TO AVOID DAMAGE TO GAS UTILITY INSTALLATIONS.
- SEE PROVINCIAL REGULATION 210/72 FOR DETAILS

METRIC
WHOLE NUMBERS INDICATE MILLIMETRES
DECIMALIZED NUMBERS INDICATE METRES

BID OPPORTUNITY 493-2008

150 mm WM	WATERMAIN	150 mm WM	HYDRO	GUY WIRE	LOCATION APPROVED	B.M. ELEV.	GBM 63-013 232.291	TRANSPORTATION ENGINEERING DIVISION TECHNOLOGY SERVICES BRANCH 106 - 1155 PACIFIC AVE	ENGINEER'S SEAL 	THE CITY OF WINNIPEG PUBLIC WORKS DEPARTMENT	BISHOP GRANDIN GREENWAY FROM RIVER ROAD TO GLEN MEADOW STREET PEDESTRIAN CYCLE FACILITY AND ASSOCIATED WORKS FROM STA. 4+50 TO STA. 8+00	CITY DRAWING NUMBER SE-08-29 SHEET 2 OF 5 2
HYDRANT VALVE CHAIN LINK FENCE WOOD BOLLARD CONCRETE SIDEWALK MANHOLE CATCH BASIN CURB INLET HYDRO POLE TRAFFIC SIGNAL POLE EXISTING	SEWER GAS CONCRETE CURB RENEWAL ELEVATIONS PROPERTY LINE SURVEY BAR GEODETIC BENCH MARK RAMP CURB GUARD RAIL PROPOSED EXISTING	O.L.S. BILLBOARD SIGN BUSH PEDESTRIAN/CYCLE FACILITY SUPR. U/G STRUCTURES DATE COMMITTEE NOTE: LOCATION OF UNDERGROUND STRUCTURES AS SHOWN ARE BASED ON THE BEST INFORMATION AVAILABLE, BUT NO GUARANTEE IS GIVEN THAT ALL EXISTING UTILITIES ARE SHOWN OR THAT THE GIVEN LOCATIONS ARE EXACT. CONFIRMATION OF EXISTENCE AND EXACT LOCATION OF ALL SERVICES MUST BE OBTAINED FROM THE INDIVIDUAL UTILITIES BEFORE PROCEEDING WITH CONSTRUCTION.	LEGEND - PLAN PROPOSED EXISTING	LEGEND - PLAN PROPOSED EXISTING	LEGEND - PLAN PROPOSED EXISTING	NO. REVISIONS DATE BY	DESIGNED R.M./A.F. CHECKED B.K. DRAWN BY R.M./A.F. APPROVED BY M.N.H. HOR. SCALE: 1 : 500 VERTICAL: 1 : 5 DATE 2008/05/10					

WATERMAIN HYDRANT VALVE CHAIN LINK FENCE WOOD BOLLARD CONCRETE SIDEWALK MANHOLE CATCH BASIN CURB INLET HYDRO POLE TRAFFIC SIGNAL POLE EXISTING	SEWER GAS CONCRETE CURB RENEWAL ELEVATIONS PROPERTY LINE SURVEY BAR GEODETIC BENCH MARK RAMP CURB GUARD RAIL PROPOSED EXISTING	O.L.S. BILLBOARD SIGN BUSH PEDESTRIAN/CYCLE FACILITY SUPR. U/G STRUCTURES DATE COMMITTEE NOTE: LOCATION OF UNDERGROUND STRUCTURES AS SHOWN ARE BASED ON THE BEST INFORMATION AVAILABLE, BUT NO GUARANTEE IS GIVEN THAT ALL EXISTING UTILITIES ARE SHOWN OR THAT THE GIVEN LOCATIONS ARE EXACT. CONFIRMATION OF EXISTENCE AND EXACT LOCATION OF ALL SERVICES MUST BE OBTAINED FROM THE INDIVIDUAL UTILITIES BEFORE PROCEEDING WITH CONSTRUCTION.	LEGEND - PLAN PROPOSED EXISTING	LEGEND - PLAN PROPOSED EXISTING	LEGEND - PLAN PROPOSED EXISTING	NO. REVISIONS DATE BY	DESIGNED R.M./A.F. CHECKED B.K. DRAWN BY R.M./A.F. APPROVED BY M.N.H. HOR. SCALE: 1 : 500 VERTICAL: 1 : 5 DATE 2008/05/10	ENGINEER'S SEAL 	THE CITY OF WINNIPEG PUBLIC WORKS DEPARTMENT	BISHOP GRANDIN GREENWAY FROM RIVER ROAD TO GLEN MEADOW STREET PEDESTRIAN CYCLE FACILITY AND ASSOCIATED WORKS FROM STA. 4+50 TO STA. 8+00	CITY DRAWING NUMBER SE-08-29 SHEET 2 OF 5 2
--	---	---	---------------------------------------	---------------------------------------	---------------------------------------	-----------------------------	---	---------------------	---	--	--