

NOTE: CHAINAGES SHOWN ARE ALONG E R OF HILLARY CR.

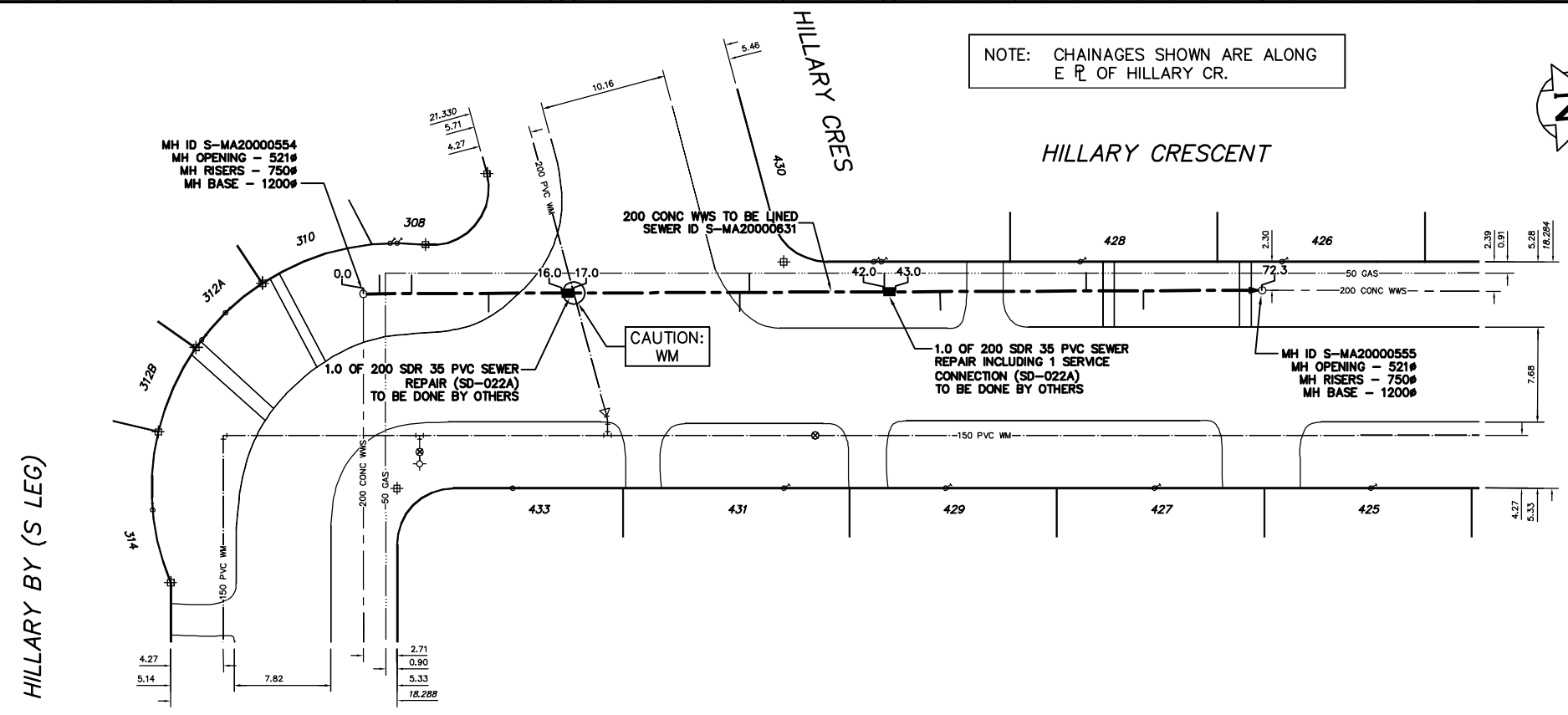

SEWER JUNCTION INFORMATION FROM SEWER VIDEO INSPECTION SEWER ID S-MA20000631

DISTANCE FROM MH ID S-MH20000554					
1.3	N	100#	WEST	CK	
3.9	N	100#	WEST	JN	
10.1	N	100#	EAST	JN	
30.4	N	100#	EAST	JN	
31.2	N	100#	WEST	JN	
42.1	N	100#	WEST	JN	
46.6	N	100#	EAST	JN	
58.4	N	100#	WEST	JN	
63.0	N	100#	EAST	JN	



SEWER SERVICE INFORMATION

ADDRESS	SIZE	E DIST JUNCTION TIE
308 HILLARY BY RESIDENTIAL	2.91 N OF SL	3.72 N MH AT HILLARY BY (S LEG)
310 HILLARY BY RESIDENTIAL	0.81 N OF NL	1.52 N MH AT HILLARY BY (S LEG)
312A HILLARY BY RESIDENTIAL	3.24 E OF NL	9.36 E MH AT HILLARY CR
312B HILLARY BY RESIDENTIAL	1.29 W OF WL	1.52 E MH AT HILLARY CR
426 HILLARY CR RESIDENTIAL	7.54 S OF NL	9.54 N 1ST MH N HILLARY BY (S LEG)
426 HILLARY CR RESIDENTIAL	5.96 N OF SL	3.44 N 1ST MH N HILLARY BY (S LEG)
427 HILLARY CR RESIDENTIAL	8.42 N OF SL	62.85 N MH AT HILLARY BY (S LEG)
428 HILLARY CR RESIDENTIAL	6.26 N OF SL	58.28 N MH AT HILLARY BY (S LEG)
429 HILLARY CR RESIDENTIAL	8.30 N OF SL	46.39 N MH AT HILLARY BY (S LEG)
430 HILLARY CR RESIDENTIAL	4.70 S OF NL	NO INFORMATION AVAILABLE
431 HILLARY CR RESIDENTIAL	4.70 S OF NL	30.54 N MH AT HILLARY BY (S LEG)
433 HILLARY CR RESIDENTIAL	8.53 S OF NL	9.81 N MH AT HILLARY BY (S LEG)

METRIC
WHOLE NUMBERS INDICATE MILLIMETRES
DECIMALIZED NUMBERS INDICATE METRES

WARNING

IF POWER EQUIPMENT OR EMPLOYEES ARE TO BE USED FOR EXCAVATION ON THIS PROJECT THE CONTRACTOR MUST:

- 1) NOTIFY THE GAS COMPANY OF THE PROPOSED LOCATION OF EXCAVATION.
- 2) TAKE PRECAUTION TO AVOID DAMAGE TO GAS COMPANY INSTALLATIONS.

SEE PROVINCIAL REGULATION 210/72 FOR DETAILS

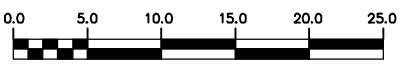

200 WM	WATERMAIN	200 WM	SL, HYDRO	150 WM	WATERMAIN	150 WM
⊕	HYDRANT	⊕	MTS	⊕	HYDRANT	⊕
⊗	VALVE	⊗	TRAFFIC SIGNALS	⊗	VALVE	⊗
—+—	525 LDS LAND DRAINAGE SEWER	—+—	GAS	—+—	50 GAS LAND DRAINAGE SEWER	—+—
—+—	375 WWS WASTEWATER SEWER	—+—	SURVEY BAR	—+—	250 WWS WASTEWATER SEWER	—+—
○	MANHOLE	●	FENCE	—	PROFILE	—
□	CATCH BASIN	■	POLE - HYDRO, MTS	⌂	GROUND ABOVE PIPE	⌂
∇	CURB INLET	∇	CURB STOP	⌂	☉ DITCH (NORTH & WEST)	⌂
⌂	JUNCTIONS	⌂	GUY ANCHOR	⌂	☉ DITCH (SOUTH & EAST)	⌂
⌂	CULVERT	⌂	LIGHT STANDARD	⌂	GUTTER (NORTH & WEST)	⌂
⌂	ANODE	⌂	TREE	⌂	GUTTER (SOUTH & EAST)	⌂
—	EXISTING	—	LEGEND-PLAN	—	LEGEND-PROFILE	—
—	LEGEND-PLAN	—	PROPOSED	—	PROPOSED	—

LOCATION APPROVED UNDERGROUND STRUCTURES

SUPV. U/G STRUCTURES COMMITTEE DATE

NOTE: LOCATION OF UNDERGROUND STRUCTURES AS SHOWN ARE BASED ON THE BEST INFORMATION AVAILABLE BUT NO GUARANTEE IS GIVEN THAT ALL EXISTING UTILITIES ARE SHOWN OR THAT THE GIVEN LOCATIONS ARE EXACT. CONFIRMATION OF EXISTENCE AND EXACT LOCATION OF ALL SERVICES MUST BE OBTAINED FROM THE INDIVIDUAL UTILITIES BEFORE PROCEEDING WITH CONSTRUCTION.

B.M. ELEV.	FIELD BOOK #
POSTED TO LBS	
NO. REVISIONS	DATE BY

CITY OF WINNIPEG WATER AND WASTE ENGINEERING DIVISION

DESIGNED BY SC/DB CHECKED BY SC

DRAWN BY CJH APPROVED BY KZ

HOR. SCALE 1:250
VERTICAL 1:50

DATE 2008 07 08

ENGINEER'S SEAL

ORIGINAL SIGNED BY K.R. ZUREK 08/07/08

BID OPPORTUNITY: 499-2008
FILENAME: 8604.dwg
PLOT DATE: 2008 07 08

THE CITY OF WINNIPEG WATER AND WASTE DEPARTMENT

2008 SEWER RENEWALS BY CIPP LINING

HILLARY CRESCENT
MH AT HILLARY BAY (S LEG) TO 1ST MH N OF HILLARY BAY (S LEG)

SHEET 6 OF 24
CITY DRAWING NUMBER 8604