

NOTE: CHAINAGES SHOWN ARE ALONG W.P. OF SHELLEY ST.

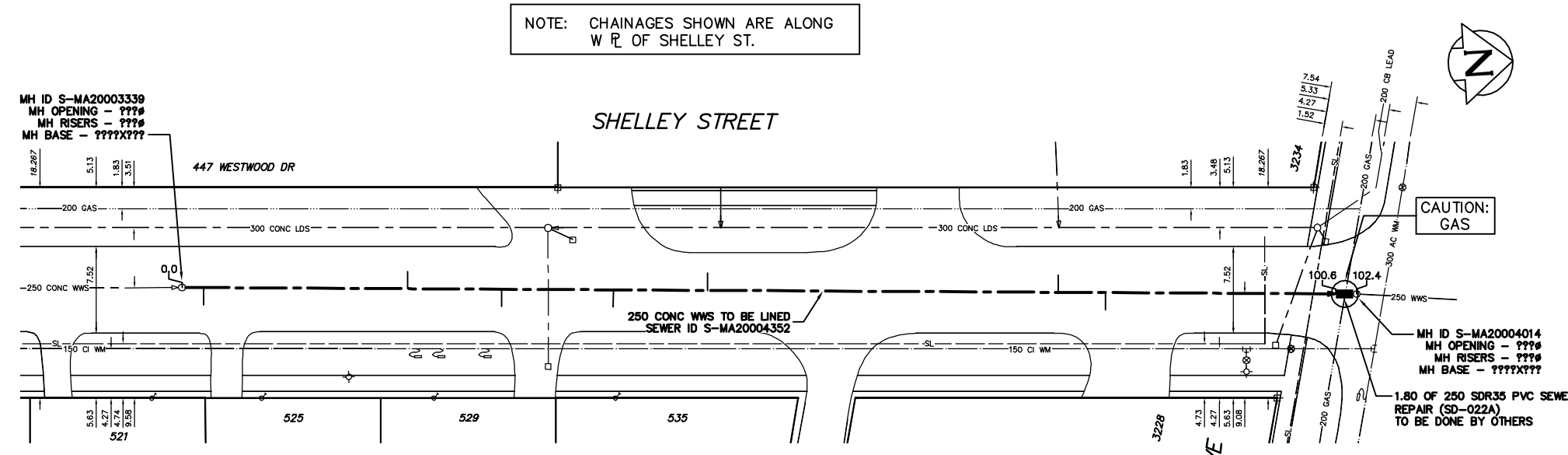

SEWER SERVICE INFORMATION			
ADDRESS	SIZE	R DIST	R DIST
521 SHELLEY ST	RESIDENTIAL	4.07 S OF NL	JUNCTION TIE
525 SHELLEY ST	RESIDENTIAL	2.47 N 1ST MH S PORTAGE AVE	5.78 N OF SL
529 SHELLEY ST	RESIDENTIAL	20.06 N 1ST MH S PORTAGE AVE	5.99 N OF SL
535 SHELLEY ST	RESIDENTIAL	38.25 N 1ST MH S PORTAGE AVE	NO INFORMATION AVAILABLE
3228 PORTAGE AVE	RESIDENTIAL	NO INFORMATION AVAILABLE	NO INFORMATION AVAILABLE
3234 PORTAGE AVE	RESIDENTIAL	12.55 N OF SL	NO INFORMATION AVAILABLE
477 WESTWOOD DR	RESIDENTIAL	45.34 N 1ST MH S PORTAGE AVE	NO INFORMATION AVAILABLE

SEWER JUNCTION INFORMATION FROM SEWER VIDEO INSPECTION SEWER ID S-MA20004352			
DISTANCE FROM MH ID S-MH20003339			
1.9	N	150#	TOP JN
19.6	N	150#	TOP JN
27.8	N	150#	EAST JN
37.5	N	150#	TOP JN
43.7	N	150#	WEST JN
76.2	N	100#	TOP JN
80.3	N	150#	TOP JN

METRIC  
WHOLE NUMBERS INDICATE MILLIMETRES  
DECIMALIZED NUMBERS INDICATE METRES

**WARNING**  
IF POWER EQUIPMENT OR EXPLOSIVES ARE TO BE USED FOR EXCAVATION ON THIS PROJECT THE CONTRACTOR MUST:  
1) NOTIFY THE GAS COMPANY OF THE PROPOSED LOCATION OF EXCAVATION.  
2) TAKE PRECAUTION TO AVOID DAMAGE TO GAS COMPANY INSTALLATIONS.  
SEE PROVINCIAL REGULATION 210/72 FOR DETAILS

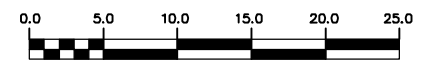

200 WM	WATERMAIN	200 WM	SL, HYDRO	150 WM	WATERMAIN	150 WM
⊕	HYDRANT	⊕	MTS	⊕	HYDRANT	⊕
⊙	VALVE	⊙	TRAFFIC SIGNALS	⊙	VALVE	⊙
525 LDS	LAND DRAINAGE SEWER	525 LDS	GAS	300 LDS	LAND DRAINAGE SEWER	300 LDS
375 WWS	WASTEWATER SEWER	375 WWS	SURVEY BAR	250 WWS	WASTEWATER SEWER	250 WWS
○	MANHOLE	●	FENCE	⊕	PROFILE	⊕
□	CATCH BASIN	■	POLE - HYDRO, MTS	⊕	GROUND ABOVE PIPE	⊕
▽	CURB INLET	▽	CURB STOP	⊕	☉ DITCH (NORTH & WEST)	⊕
⊕	JUNCTIONS	⊕	GUY ANCHOR	⊕	☉ DITCH (SOUTH & EAST)	⊕
⊕	CULVERT	⊕	LIGHT STANDARD	⊕	☉ GUTTER (NORTH & WEST)	⊕
⊕	ANODE	⊕	TREE	⊕	☉ GUTTER (SOUTH & EAST)	⊕
EXISTING	LEGEND-PLAN	PROPOSED	EXISTING	LEGEND-PLAN	PROPOSED	EXISTING
EXISTING	LEGEND-PROFILE	PROPOSED	EXISTING	LEGEND-PROFILE	PROPOSED	EXISTING

LOCATION APPROVED UNDERGROUND STRUCTURES	
SUPV. U/G STRUCTURES COMMITTEE	DATE
NOTE: LOCATION OF UNDERGROUND STRUCTURES AS SHOWN ARE BASED ON THE BEST INFORMATION AVAILABLE BUT NO GUARANTEE IS GIVEN THAT THE GIVEN LOCATIONS ARE EXACT. CONFIRMATION OF EXISTENCE AND EXACT LOCATION OF ALL SERVICES MUST BE OBTAINED FROM THE INDIVIDUAL UTILITIES BEFORE PROCEEDING WITH CONSTRUCTION.	
B.M. ELEV.	FIELD BOOK #:
POSTED TO LBS	
DESIGNED BY DB/SC	CHECKED BY SC
DRAWN BY CJH	APPROVED BY KZ
HOR. SCALE 1:250	RELEASED FOR CONSTRUCTION
VERTICAL 1:50	
NO. REVISIONS	DATE BY
	DATE 2008 07 08

CITY OF WINNIPEG  
WATER AND WASTE  
ENGINEERING DIVISION

ENGINEER'S SEAL  
ORIGINAL SIGNED BY K.R. ZUREK 08/07/08

BID OPPORTUNITY: 499-2008  
FILENAME: 8616.dwg  
PLOT DATE: 2008 07 08

THE CITY OF WINNIPEG  
WATER AND WASTE DEPARTMENT

2008 SEWER RENEWALS  
BY CIPP LINING  
SHELLEY STREET  
1ST MH S OF PORTAGE AVENUE TO  
MH AT S P PORTAGE AVENUE

SHEET 18 OF 24  
CITY DRAWING NUMBER  
8616