

Skate Change Building

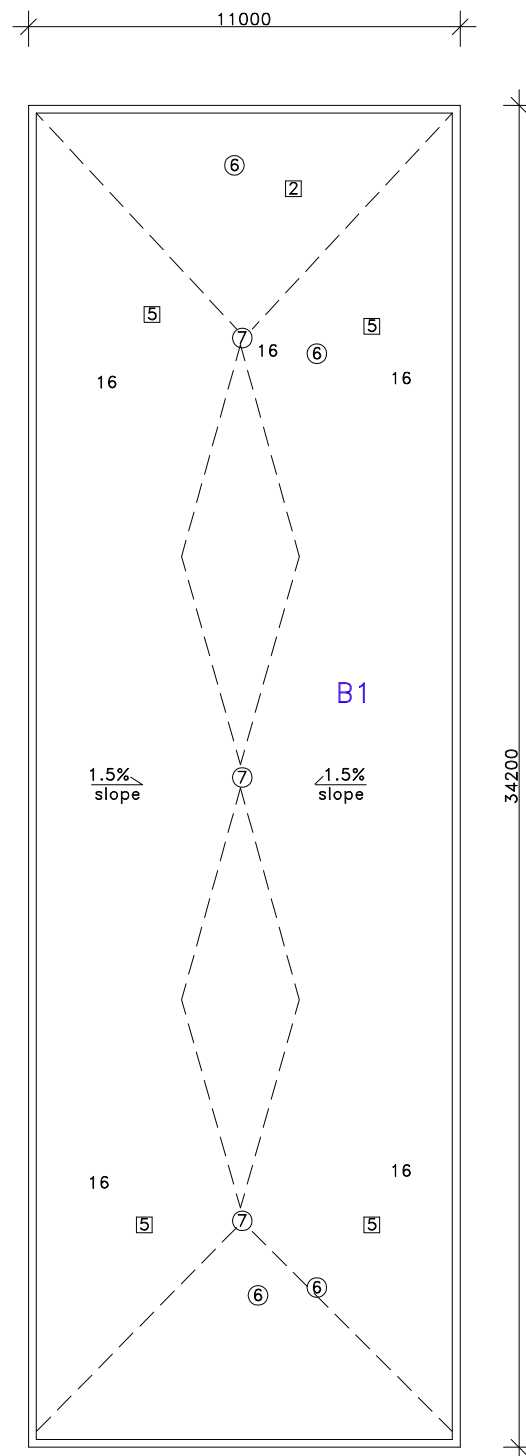

B1 Construction (1998)

- hollow core concrete
- 2 ply felt and asphalt VB
- 1.5% slope type 2 EPS min 3"
- 1" fiberboard
- 1/2" fiberboard
- Soprema Elastophene 180 p/s
- Soprema Sopralene 250 cap

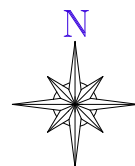

Approx. Area (sq.m.)

- Main Club House
- A1 = 198
- A2 = 380
- Skate Change Building
- A1 = 376

Notes:

- .01 Contractor is responsible for site verifications of all dimensions
- .02 Drawings are not to be scaled for estimating purposes
- .03 All areas given are approximate
- .04 Contractor is responsible for site verification of existing roof constructions

Stated scale is when in 11x17 format

The exact locations of the roof drains is to be determined on site by the Contract Administrator. The roof valleys can be shifted as required to accommodate any new plumbing.

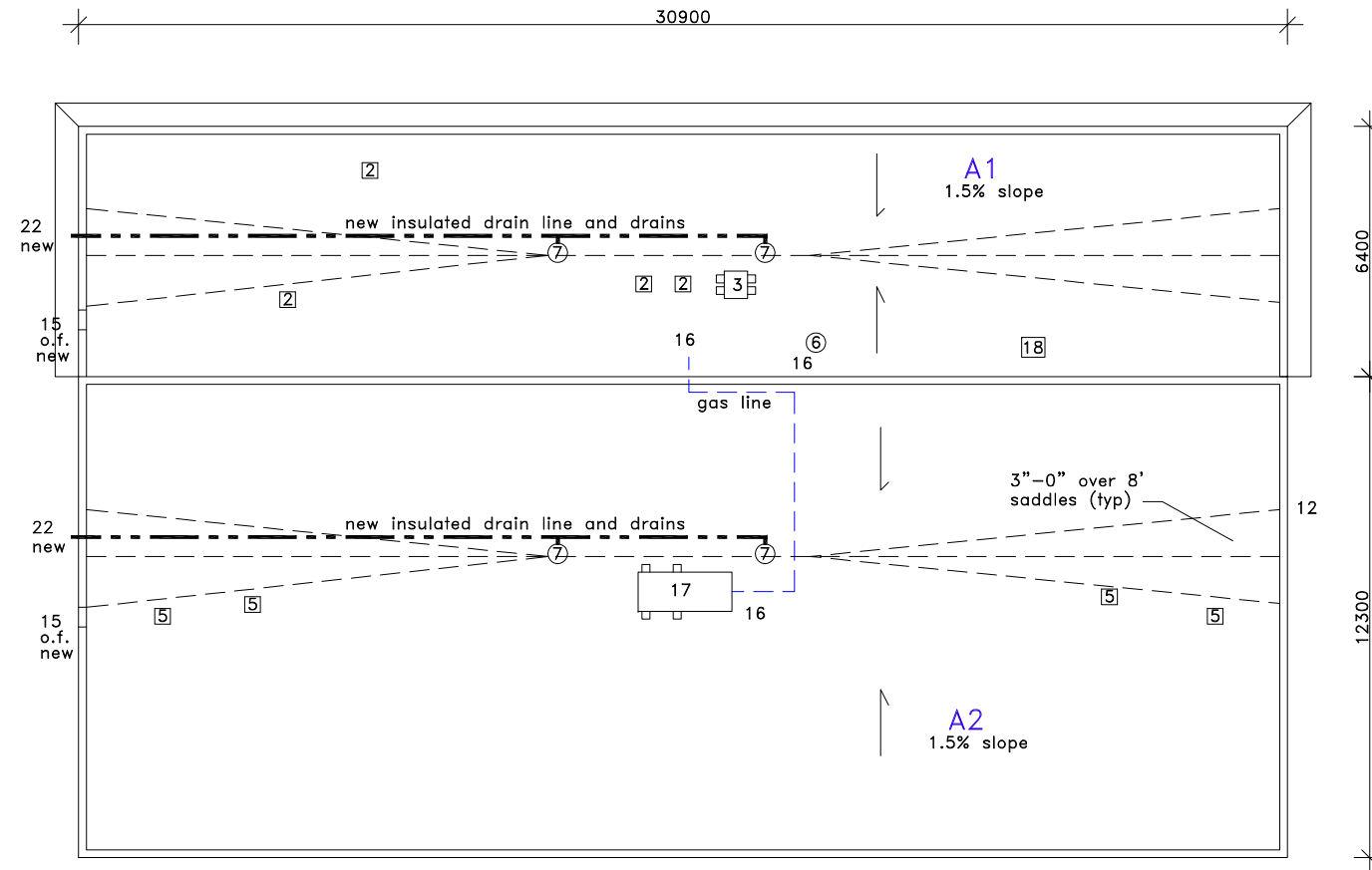

Main Clubhouse

A1 & A2 Construction (2008)

- steel deck
- 1/2" type X drywall
- Soprema Elastophene 180 s/p
- 1.5% sloped type 2 EPS min 2.25"
- 2" Soprema Colgrip A
- Soprema Colvent 810 base sheet
- Soprema Colvent 860 cap sheet

(all components adhered in place with Soprema HV Adhesive)

A1 & A2 Existing Construction

- steel deck
- 2 ply felt vapor barrier
- 1 1/2" fiberboard
- 2" polyisocyanurate
- 1/2" fiberboard
- 1/2" fiberboard
- 4 ply felt and asphalt
- gravel

GRAPHIC LEGEND

- Parapet
- Gravel stop
- Gas line
- Control joint
- Expansion joint
- New insulated drain pipe
- Photo vantage point
- Area Label

= attic vent X = leak

KEYNOTE LEGEND

- 1 core sample
- 2 chimney
- 3 AC unit
- 4 vent hood
- 5 ventilator
- 6 vent pipe
- 7 roof drain
- 8 skylight
- 9 eavestrough
- 10 firewall
- 11 antenna
- 12 ladder
- 13 stub column
- 14 roof hatch
- 15 scupper
- 16 pitch box
- 17 HVAC unit
- 18 capped curb
- 19 flag pole
- 20 electrical mast
- 21 cooling tower
- 22 splash pad
- 23 splash pan
- 24 downspout/rainwater leader
- 25 back slope
- 26 cant
- 27 increase slope to drain
- 28 cricket
- 29 parapet/wide flashing
- 30 life line anchor

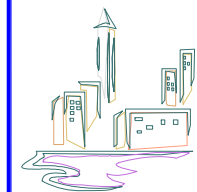

**AGASSIZ
CONSULTING
GROUP
LTD.**

809 Pipeline Road, Winnipeg, Manitoba
Phone: 697-8091 Fax: 697-8039

Project: Varsity View CC
315 Laxdal Road
Winnipeg, MB

Date: January 7, 2008

Drawing No. R-1

File no: 3124-08 Scale: 1:200