



THE CITY OF WINNIPEG

WATER AND WASTE DEPARTMENT
ENGINEERING DIVISION

2008 WATERMAIN RENEWALS

CONTRACT 2

BID OPPORTUNITY 56-2008

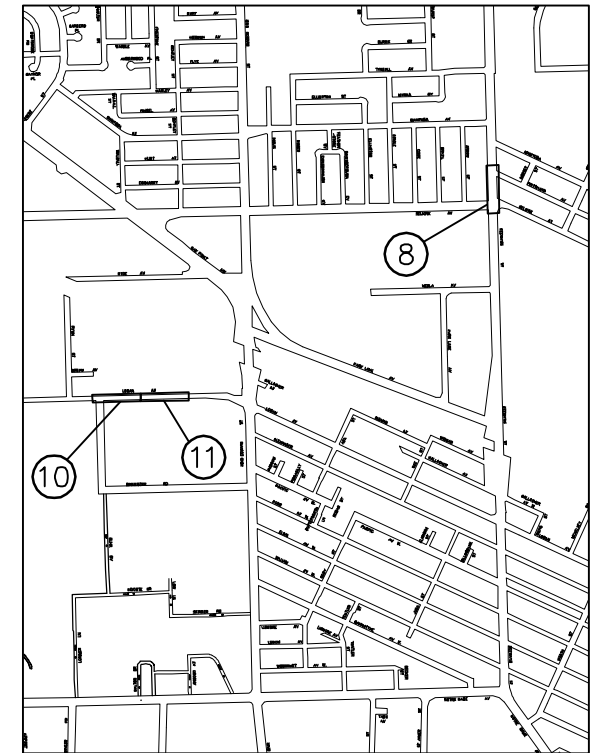
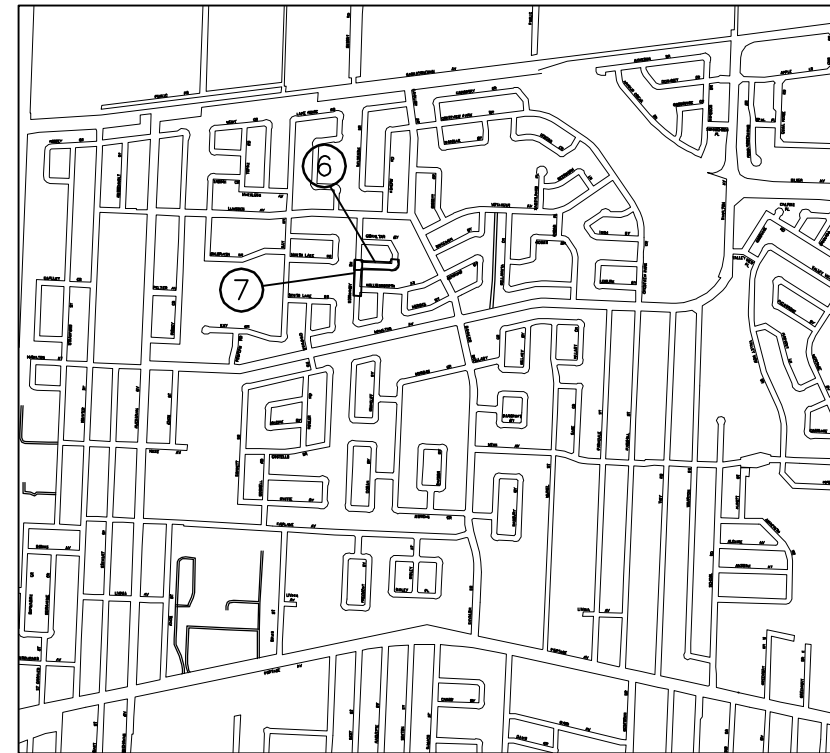

- ① D-11230 CARPATHIA ROAD – TUXEDO AVENUE TO 87.5 N OF TUXEDO AVENUE
- ② D-11231 CARPATHIA ROAD – 87.5 N OF TUXEDO AVENUE TO WILLOW AVENUE
- ③ D-11232 DONALD STREET – 105 S OF ST MARY AVENUE TO ST MARY AVENUE
- ④ D-11233 ERIN STREET – 100 N OF RICHARD AVENUE TO 200 N OF RICHARD AVENUE
- ⑤ D-11234 ERIN STREET – 200 N OF RICHARD AVENUE TO CPR R.O.W.
- ⑥ D-11235 GIBRALTER BAY (S LEG) – NORMANDY DRIVE (W LEG) TO GIBRALTER BAY (E LEG)
- ⑦ D-11236 NORMANDY DRIVE (W LEG) – HOLLINGSWORTH AVENUE TO GIBRALTER BAY (S LEG)
- ⑧ D-11237 KEEWATIN STREET – SELKIRK AVENUE TO PRITCHARD AVENUE
- ⑨ D-11238 KING STREET – BANNATYNE AVENUE TO WILLIAM AVENUE
- ⑩ D-11239 LOGAN AVENUE – BANNISTER ROAD TO 125 E OF BANNISTER ROAD
- ⑪ D-11240 LOGAN AVENUE – 125 E OF BANNISTER ROAD TO 300 E OF BANNISTER ROAD
- ⑫ D-11241 NIGHTINGALE ROAD – 90 S OF LODGE AVENUE TO LODGE AVENUE
- ⑬ D-11242 ROSEBERRY STREET – 300 S OF PORTAGE AVENUE TO 175 S OF PORTAGE AVENUE
- ⑭ D-11243 ROSEBERRY STREET – 175 S OF PORTAGE AVENUE TO PORTAGE AVENUE
- ⑮ D-11244 ST. JAMES STREET – WELLINGTON AVENUE TO 120 N OF WELLINGTON AVENUE
- ⑯ D-11245 ST. JAMES STREET – 120 N OF WELLINGTON AVENUE TO 282.5 N OF WELLINGTON AVENUE
- ⑰ D-11246 ST. JAMES STREET – 100 S OF SASKATCHEWAN AVENUE TO SASKATCHEWAN AVENUE

