

SEWER SERVICE INFORMATION			
ADDRESS	SIZE	R. DIST.	JUNCTION TIE
429 SHAFESBURY BLVD	150	-	-
RESIDENTIAL	-	27.10 E. MH AT SHAFESBURY	-
120 MOUNTBATTEN AVE	150	-	-
RESIDENTIAL	-	28.50 E. MH AT SHAFESBURY	-
119 MOUNTBATTEN AVE	150	-	-
RESIDENTIAL	-	52.60 E. MH AT SHAFESBURY	-
116 MOUNTBATTEN AVE	100	-	-
RESIDENTIAL	-	73.50 E. MH AT SHAFESBURY	-
115 MOUNTBATTEN AVE	100	-	-
RESIDENTIAL	-	74.0 E. MH AT SHAFESBURY	-
111 MOUNTBATTEN AVE	-	-	SERVICED OFF BOWER
RESIDENTIAL	-	-	32.30 N. MH AT MOUNTBATTEN
103 MOUNTBATTEN AVE	-	-	-
RESIDENTIAL	-	-	52.90 E. OF MH AT BOWER
101 MOUNTBATTEN AVE	-	-	-
RESIDENTIAL	-	-	NO INFORMATION AVAILABLE
429 BOWER BLVD	-	-	-
RESIDENTIAL	-	-	45.70 E. OF MH AT BOWER
500 BOWER BLVD	-	-	-
RESIDENTIAL	-	-	SERVICED OFF BOWER
501 BOWER BLVD	-	-	-
RESIDENTIAL	-	-	44.90 E. OF MH AT BOWER
501 BOWER BLVD	-	-	-
RESIDENTIAL	-	-	57.60 E. OF MH AT BOWER
500 LAIDLAW AVE	-	-	-
RESIDENTIAL	-	-	97.10 E. OF MH AT BOWER

- CONSTRUCTION NOTES:**
- EXCAVATIONS SHALL BE AS FAR AS POSSIBLE FROM EXISTING TREES.
 - INSTALL SEWER BY TRENCHLESS METHODS.
 - CONFIRM THE LOCATION OF ALL SEWER SERVICES.
 - BACKFILL UNDER PAVEMENT, IN SIDEWALKS, & WITHIN 1.0 OF PAVEMENT TO BE CLASS 3.
 - BACKFILL IN BOULEVARD TO BE CLASS 5.
 - RENEW SEWER SERVICES TO R.
 - INSTALL SEWER SERVICE RISERS TO ELEVATION WHERE MINIMUM SLOPE OF 1% IS MAINTAINED FOR ALL SERVICES.

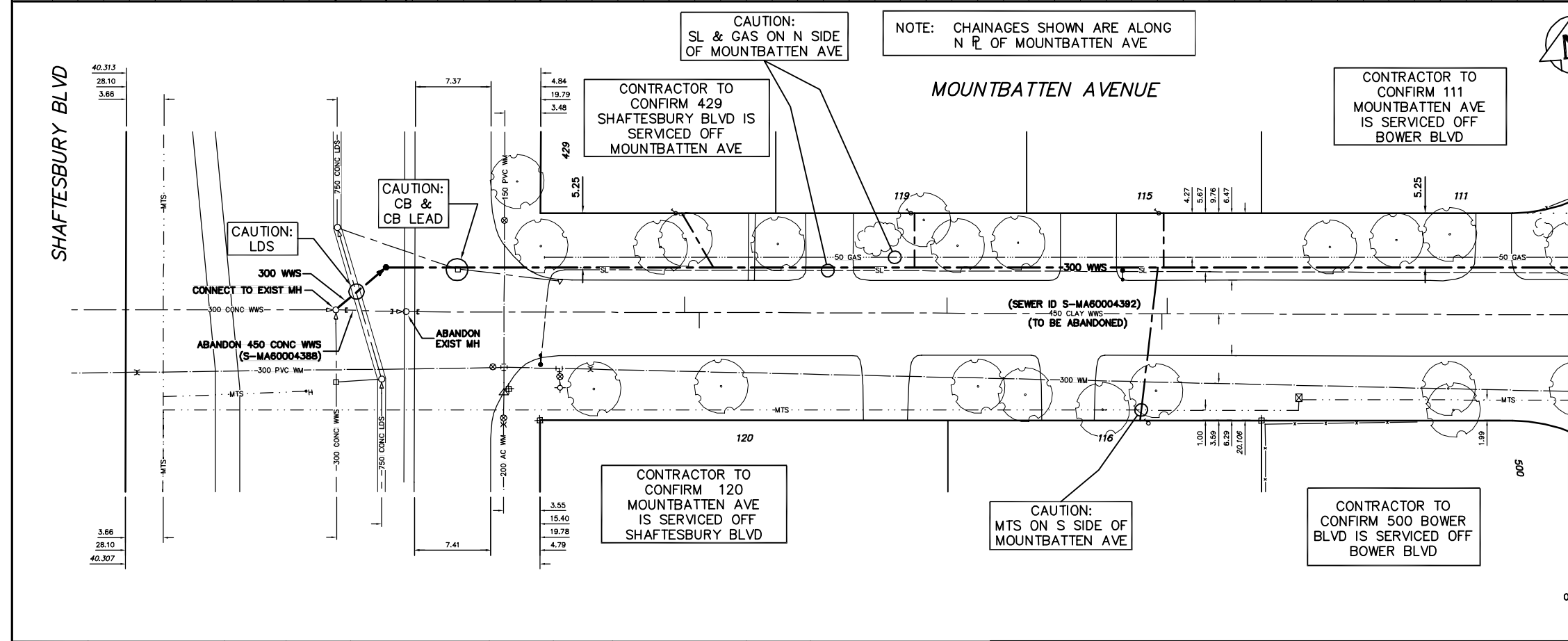

WATER SERVICE INFORMATION				
ADDRESS	SIZE(mm) & TYPE (STREET)	SIZE(mm) & TYPE (PROP)	SHORT & LONG MEASUREMENT	CORP. LOCATION
120 MOUNTBATTEN AVE	-	-	(P10) NO INFORMATION AVAILABLE	-
RESIDENTIAL	-	-	-	-
119 MOUNTBATTEN AVE	-	-	9.93 WEL HOUSE	-
RESIDENTIAL	-	-	36.01 EEL SHAFESBURY	-
116 MOUNTBATTEN AVE	20	20	9.32 WEL HOUSE	-
RESIDENTIAL	COPPER	COPPER	58.77 EEL SHAFESBURY	-
115 MOUNTBATTEN AVE	20	20	9.21 WEL HOUSE	-
RESIDENTIAL	COPPER	COPPER	60.13 EEL SHAFESBURY	-
111 MOUNTBATTEN AVE	15	15	OPP NL HOUSE	-
RESIDENTIAL	LEAD	LEAD	20.24 NNL MOUNTBATTEN	-
103 MOUNTBATTEN AVE	-	-	2.29 F.W. HOUSE	-
RESIDENTIAL	-	-	38.97 EEL BOWER	-
101 MOUNTBATTEN AVE	-	-	3.54 NSL HOUSE	-
RESIDENTIAL	-	-	20.73 N HYD N MOUNTBATTEN	-
429 SHAFESBURY BLVD	-	-	7.24 WEL HOUSE	-
RESIDENTIAL	-	-	13.14 EEL SHAFESBURY	-
429 BOWER BLVD	-	-	3.54 NSL HOUSE	-
RESIDENTIAL	-	-	17.13 NNL MOUNTBATTEN	-
500 BOWER BLVD	-	-	16.70 SSL HOUSE	OPP SC
RESIDENTIAL	-	-	20.34 SSL MOUNTBATTEN	-
501 BOWER BLVD	-	-	0.64 WEL HOUSE	-
RESIDENTIAL	-	-	28.33 EEL BOWER	-
500 LAIDLAW AVE	-	-	(P10) 4.27 E/E HL	-
RESIDENTIAL	-	-	7.01 W/W LAIDLAW	-

NOTE:
FOR CURBSTOPS AND SERVICES IN GIS:
SHORT MEASUREMENTS WERE MEASURED IN AUTOCAD USING 2005 AERIAL PHOTOS
LONG MEASUREMENTS WERE MEASURED IN AUTOCAD

FOR CURBSTOPS AND SERVICES NOT IN GIS:
INFORMATION IS FROM PANEL 10 (P10)

SEWER JUNCTION INFORMATION FROM SEWER VIDEO INSPECTION S-MA60004392			
DISTANCE FROM MH S-MH60003186			
27.1	E	150#	NORTH CX
28.5	E	150#	SOUTH CX
52.6	E	150#	NORTH CX
73.5	E	100#	SOUTH JX
74.0	E	100#	NORTH JN

METRIC
WHOLE NUMBERS INDICATE MILLIMETRES
DECIMALIZED NUMBERS INDICATE METRES

WARNING
IF POWER EQUIPMENT OR EXPLOSIVES ARE TO BE USED FOR EXCAVATION ON THIS PROJECT THE CONTRACTOR MUST:
1) NOTIFY THE GAS COMPANY OF THE PROPOSED LOCATION OF EXCAVATION.
2) TAKE PRECAUTION TO AVOID DAMAGE TO GAS COMPANY INSTALLATIONS.
SEE PROVINCIAL REGULATION 210/72 FOR DETAILS

200 WM	WATERMAIN	200 WM	SL, HYDRO	150 WM	WATERMAIN	150 WM
+	HYDRANT	+	MTS	+	HYDRANT	+
⊕	VALVE	⊕	TRAFFIC SIGNALS	+	VALVE	+
525 LDS	LAND DRAINAGE SEWER	525 LDS	GAS	50 GAS	300 LDS	LAND DRAINAGE SEWER
375 WWS	WASTEWATER SEWER	375 WWS	SURVEY BAR	250 WWS	WASTEWATER SEWER	250 WWS
○	MANHOLE	○	FENCE	⊗	PROFILE	⊗
□	CATCH BASIN	□	POLE - HYDRO, MTS	⊖	GROUND ABOVE PIPE	⊖
▽	CURB INLET	▽	CURB STOP	⊕	DITCH (NORTH & WEST)	⊕
+	JUNCTIONS	+	GUY ANCHOR	⊕	DITCH (SOUTH & EAST)	⊕
+	CULVERT	+	LIGHT STANDARD	⊕	GUTTER (NORTH & WEST)	⊕
+	ANODE	+	TREE	⊕	GUTTER (SOUTH & EAST)	⊕
EXISTING	LEGEND-PLAN	PROPOSED	EXISTING	LEGEND-PLAN	PROPOSED	EXISTING

LOCATION APPROVED UNDERGROUND STRUCTURES		B.M. ELEV.	FIELD BOOK #
NO.	REVISIONS	DATE	BY

CITY OF WINNIPEG WATER AND WASTE ENGINEERING DIVISION

DESIGNED BY: SGL
CHECKED BY: NC
DRAWN BY: CJH
APPROVED BY: KZ
HOR. SCALE: 1:250
VERTICAL: 1:50
RELEASED FOR CONSTRUCTION: 2008 07 17

ENGINEER'S SEAL
ORIGINAL SIGNED BY K.R. ZUREK
08/07/17

THE CITY OF WINNIPEG WATER AND WASTE DEPARTMENT

2008 SEWER RENEWALS
CONTRACT 15
MOUNTBATTEN AVENUE
MH AT SHAFESBURY BOULEVARD TO MH AT BOWER BOULEVARD

SHEET 7 OF 8
CITY DRAWING NUMBER 8629

BID OPPORTUNITY: 578-2008
FILENAME: 8629.dwg
PLOT DATE: 2008 07 17