

A1 SIZE 23.4" x 33.1" (594mm x 841mm)

PLOT: 08/08/20 3:46:11 PM

UMA FILE NAME: 0265-407-00\_02-S-0002\_RX.dwg Saved By: mpegrasantia

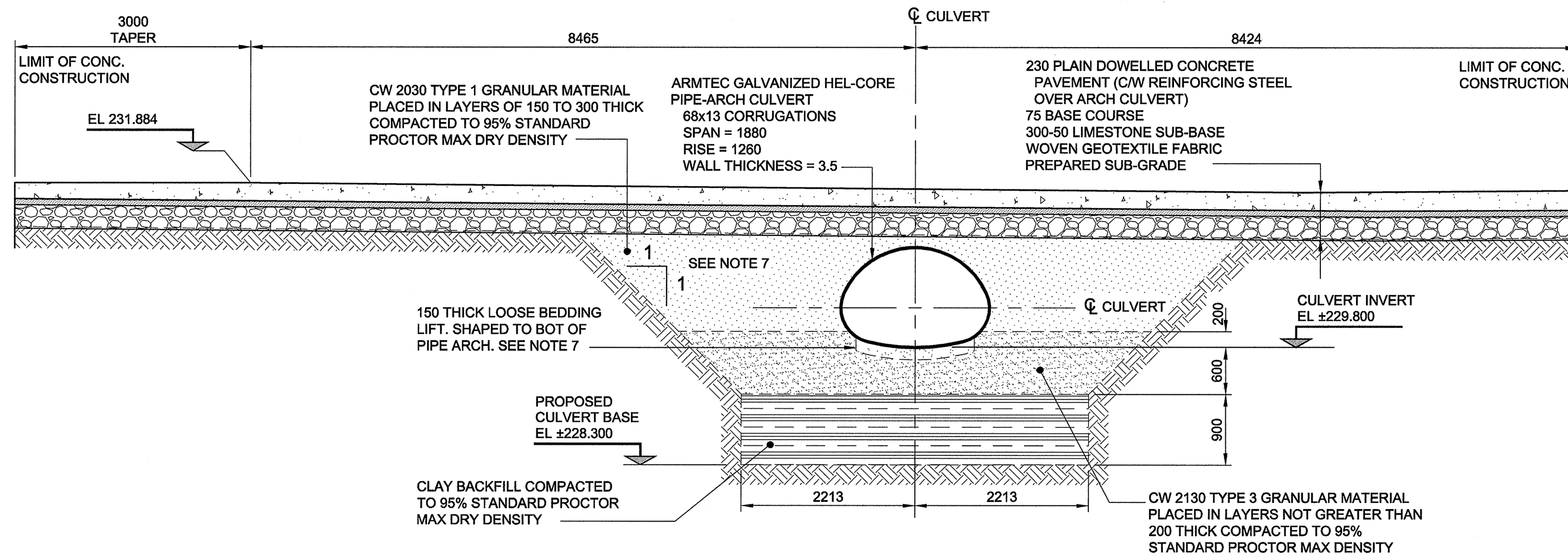

**SECTION A**  
SCALE: 1:50

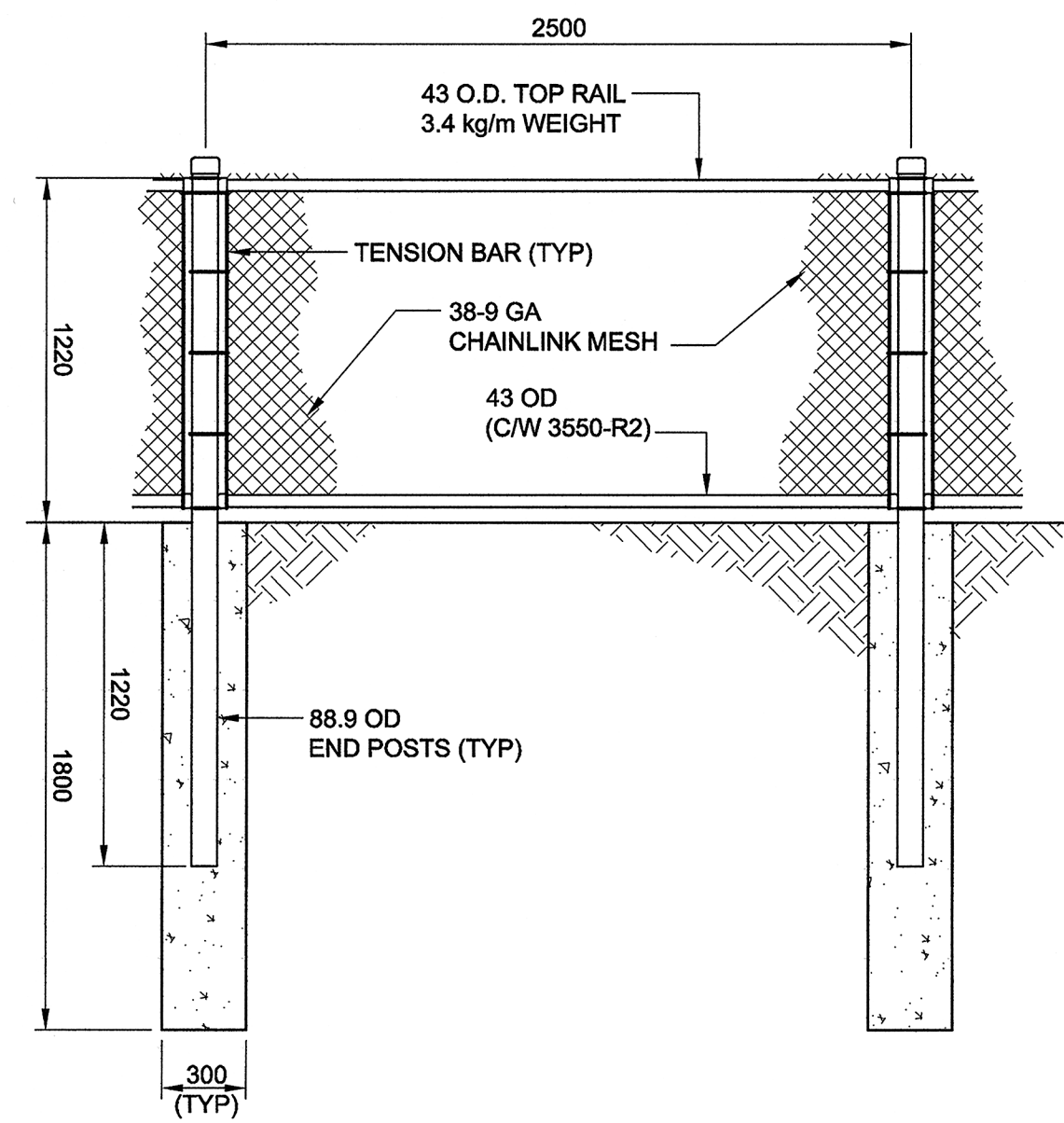

**1.22 HIGH CHAINLINK FENCE**

SCALE: 1:25

**CIRCULAR CSP BEVEL ENDS**

SCALE: 1:25

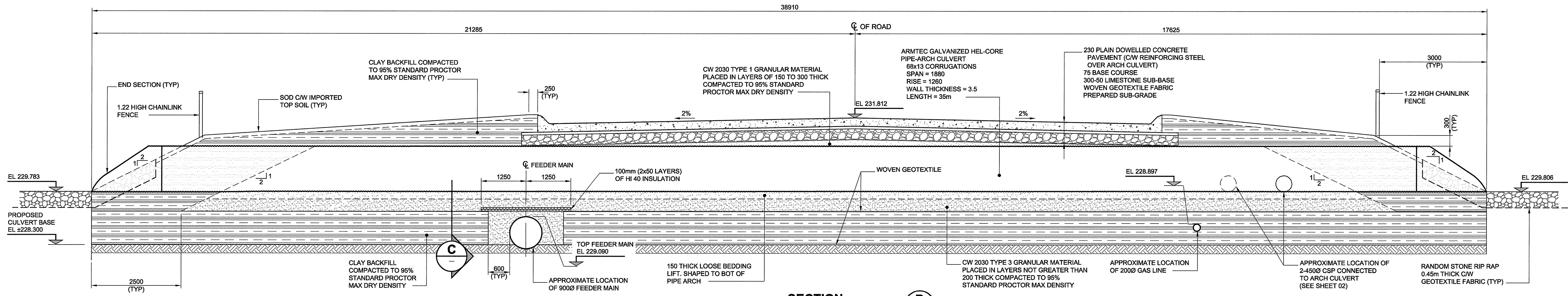

**SECTION B**  
SCALE: NTS

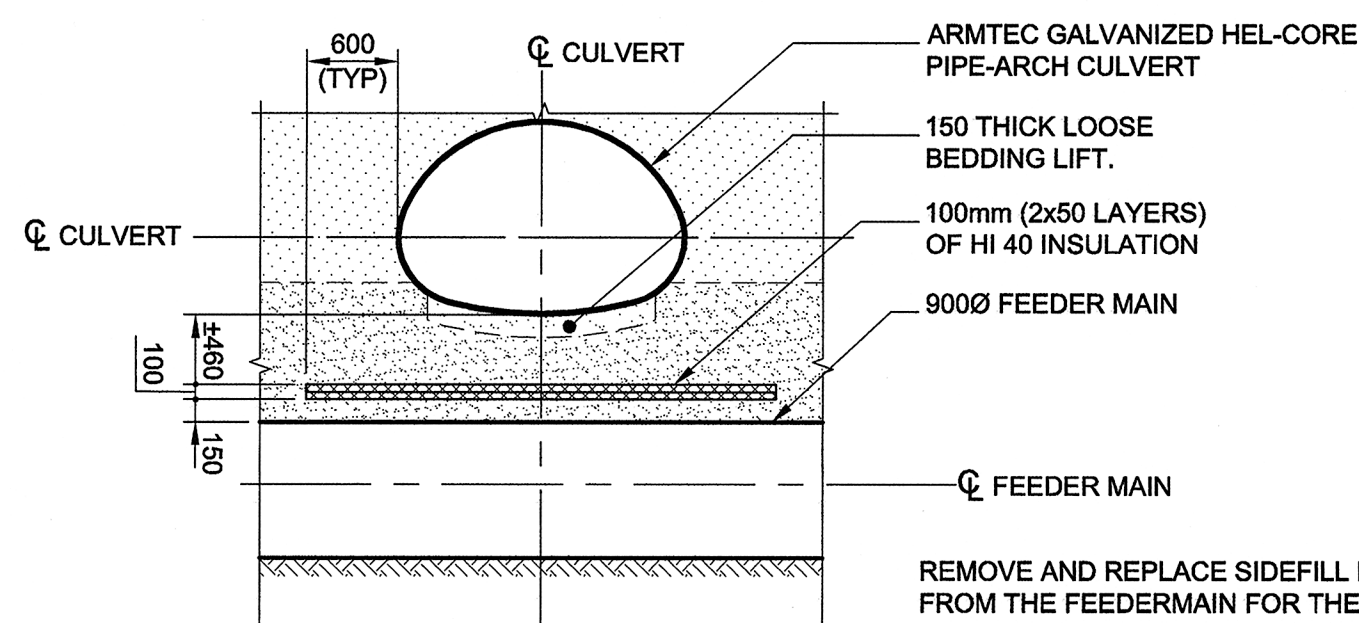

**SECTION C**  
SCALE: 1:50

**CONSTRUCTION NOTES:**

- CROSSING THE FEEDERMAIN AT LOCATIONS OTHER THAN THE DESIGNATED CROSSING LOCATIONS IS PROHIBITED.
- UMA PERSONNEL TO BRIEF CONTRACTOR ABOUT PROTOCOL FOR WORKING OVER THE PIPELINES.
- IF A BACKHOE IS TO BE UTILIZED, IT SHOULD NOT BE LOCATED DIRECTLY OVER PIPES. A MINIMUM OF 2.5m O/S FROM CENTRE LINE OF PIPES IS TO BE USED.
- CONTRACTOR TO SUBMIT A PROPOSED EQUIPMENT LIST PRIOR TO CONSTRUCTION.
- SPEED OF CONSTRUCTION VEHICLES IS TO BE KEPT TO A MINIMUM.
- CONTACT THE CITY OF WINNIPEG WATER & WASTE PERSONNEL ANDY VINCENT (PH 986 3823) PRIOR TO CONSTRUCTION.
- REFER TO UMA GEOTECHNICAL REPORT FOR EXCAVATION, CUT SLOPES FOUNDATION PREPARATION, CULVERT BEDDING AND BACKFILL CONSTRUCTION AND OTHER INFORMATION.
- PILES OF THE EXISTING BRIDGE SHALL BE CUT OFF TO A MINIMUM DISTANCE OF 0.3 m BELOW THE UNDERSIDE OF CULVERT BEDDING.

REMOVE AND REPLACE SIDEFILL MATERIAL FROM THE FEEDERMAIN FOR THE WIDTH OF THE PIPE-ARCH CULVERT TRENCH. REMOVE BY HAND EXCAVATION OR HYDROVAC TO 150mm ABOVE INVERT OF PIPE AND REPLACE WITH CW 2030 TYPE 2 MATERIAL COMPACTED TO 95% STANDARD PROCTOR MAX DRY DENSITY

**LOCATION APPROVED UNDERGROUND STRUCTURES**

NOTE: LOCATION OF UNDERGROUND STRUCTURES AS SHOWN ARE BASED ON THE BEST INFORMATION AVAILABLE. BUT NO GUARANTEE IS GIVEN THAT ALL EXISTING UTILITIES ARE SHOWN OR THAT THE GIVEN LOCATIONS ARE EXACT. CONFIRMATION OF EXISTENCE AND EXACT LOCATION OF ALL SERVICES MUST BE OBTAINED FROM THE INDIVIDUAL UTILITIES BEFORE PROCEEDING WITH CONSTRUCTION.

BM 33-011 ELEV 231.909m			
DESIGNED BY	BLL	CHECKED BY	JGK
DRAWN BY	MP	APPROVED BY	BLL
HOR. SCALE	AS NOTED	RELEASED FOR CONSTRUCTION	
VERT. SCALE	AS NOTED	DATE	08/08/01
NO. REVISIONS	Y/M/MD	BY	
0	ISSUED FOR TENDER	08/08/20	MP

**UMA | AECOM**

© 2008 UMA ENGINEERING LTD. ALL RIGHTS RESERVED.

DESIGNED BY: BLL  
CHECKED BY: JGK  
DRAWN BY: MP  
APPROVED BY: BLL

HOR. SCALE: AS NOTED  
VERT. SCALE: AS NOTED

DATE: 08/08/01

PROFESSIONAL'S SEAL

PROVINCE OF MANITOBA  
B.L. LAU  
08/08/20  
REGISTERED PROFESSIONAL ENGINEER

CONSULTANT DRAWING NO.  
0265-407-00\_02-S-0002\_RX.dwg

**METRIC**  
WHOLE NUMBERS INDICATE MILLIMETRES  
DECIMALIZED NUMBERS INDICATE METRES

BID OPPORTUNITY NO. 589-2008

**THE CITY OF WINNIPEG**  
PUBLIC WORKS DEPARTMENT  
TRANSPORTATION ENGINEERING DIVISION

**PANET ROAD**  
CROSSING OF DUGALD ROAD  
DRAIN REPLACEMENT  
CROSS SECTIONS AND  
DETAILS

CITY DRAWING NUMBER  
C376-08-04  
SHEET 4 OF 4  
DRAWING No. 04  
REV 0