

SHEET: CSM-MA001 (1/2002) FILE NAME: L:\wps\104000\104450\02e-csd\p1_01\000000\MA001\CONTR\104450.dwg LAYOUT NAME: SEPLAN PLOTTED BY: dennis.croft@wpc.ca Aug 07, 2008 11:11:39am

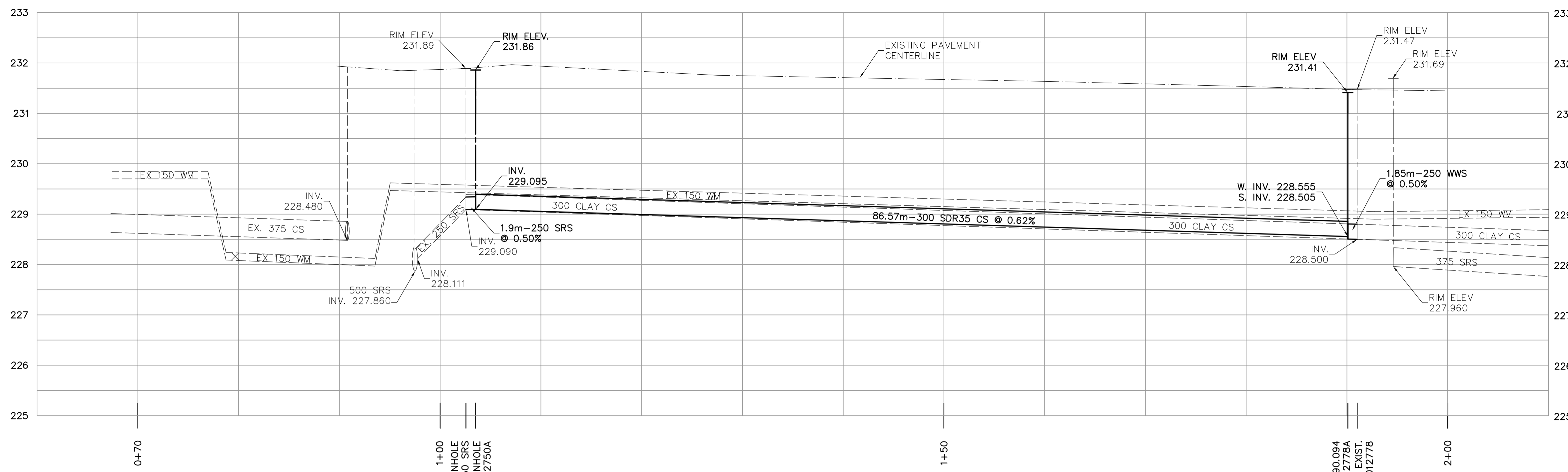

SEWER JUNCTION INFORMATION FROM VIDEO INSPECTION S-MA00014316	
DISTANCE FROM MH00012750	
6.8m EAST - 100mm CONNECTION SOUTH -	
8.4m EAST - 150mm CONNECTION NORTH -	
15.3m EAST - 150mm CONNECTION SOUTH -	
23.7m EAST - 150mm CONNECTION SOUTH -	
28.3m EAST - 150mm CONNECTION NORTH -	
38.6m EAST - 150mm CONNECTION NORTH -	
DISTANCE FROM S-MH00012778	
41.1m WEST - 150mm CONNECTION NORTH -	
31.1m WEST - 150mm CONNECTION NORTH -	
21.1m WEST - 150mm CONNECTION NORTH -	
10.9m WEST - 150mm CONNECTION NORTH -	
2.0m WEST - 150mm CONNECTION NORTH -	

SEWER SERVICE INFORMATION		
ADDRESS	SIZE	R DIST JUNCTION TIE
797 PRITCHARD RESIDENTIAL	1.6 W of EL	1.6 W of EL
803 PRITCHARD RESIDENTIAL	1.3 W of EL	1.3 W of EL
805 PRITCHARD RESIDENTIAL	10.7 W of EL	10.7 W of EL
809 PRITCHARD RESIDENTIAL	2.3 W of EL	2.3 W of EL
813 PRITCHARD RESIDENTIAL	30.8 W of EL	30.8 W of EL
815 PRITCHARD RESIDENTIAL	1.2 W of EL	1.2 W of EL
819 PRITCHARD RESIDENTIAL	41.1 W of EL	41.1 W of EL
827 PRITCHARD RESIDENTIAL	1.1 W of EL	1.1 W of EL
	37.6 E of EL	37.6 E of EL
	27.7 E of EL	27.7 E of EL
	2.5 W of EL	2.5 W of EL
	7.6 E of EL	7.6 E of EL

NOTE: EXISTING SHORT SIDE SERVICES SHALL BE REPLACED TO THE PROPERTY LINE.

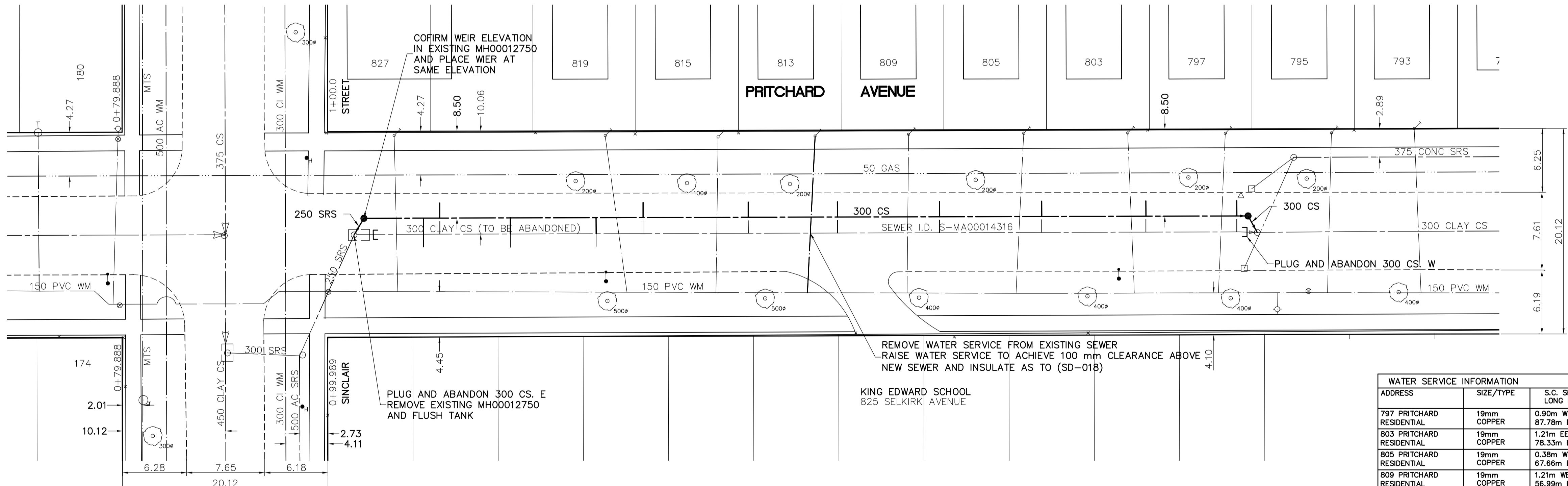
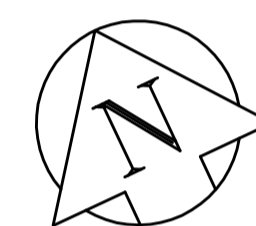

- CONSTRUCTION NOTES:**
1. ALL WORK AND MATERIALS SHALL CONFORM TO THE CITY OF WINNIPEG STANDARD SPECIFICATIONS.
 2. INSTALL SEWER BY TRENCHLESS METHODS.
 3. ALL SEWER SERVICES SHALL BE 150 PVC SDR 35.
 4. ALL AUGER SHAFTS SHALL HAVE CLASS 3 BACKFILL UNDER PAVED SURFACES AND CLASS 5 BACKFILL (GRANULAR BACKFILL TO 300mm ABOVE SERVICE) IN BOULEVARD AREAS.
 5. EXIST. COMBINED SEWER TO BE ABANDONED AND FILLED WITH FLOWABLE FILL.
 6. RENEW SEWER SERVICES TO PROPERTY LINE.
 7. AUGER NEW SEWER SERVICES TO ALL LOTS.
 8. ALL PIPE IN SHAFTS SHALL BE BEDDED IN CLEAN STONE BEDDING.

NOTE: PROPOSED SEWER SERVICES SHOWN FOR SCHEMATIC PURPOSES ONLY. CONTRACTOR SHALL LOCATE EXISTING SEWER SERVICES AT PROPERTY LINE. LOCATION OF NEW SERVICES TO BE FIELD DETERMINED AND APPROVED BY CONTRACT ADMINISTRATOR.

APEGM
 Certificate of Authorization
 Earth Tech Canada Inc.
 No. 730

METRIC
 WHOLE NUMBERS INDICATE MILLIMETRES
 DECIMALIZED NUMBERS INDICATE METRES

WATER SERVICE INFORMATION				
ADDRESS	SIZE/TYPE	S.C. SHORT AND LONG MEASUREMENT	CORP LOCATION	REMARKS
797 PRITCHARD RESIDENTIAL	19mm COPPER	0.90m WEL OF HOUSE 87.78m EEL OF SINCLAIR	0.6m W of SC	RENEWED AND CONN TO NEW WM JUNE 4/07
803 PRITCHARD RESIDENTIAL	19mm COPPER	1.21m EEL OF HOUSE 78.33m EEL OF SINCLAIR	0.6m E of SC	RENEWED AND CONN TO NEW WM JUNE 27/08
805 PRITCHARD RESIDENTIAL	19mm COPPER	0.38m WEL OF HOUSE 67.66m EEL OF SINCLAIR	0.3m W of SC	RENEWED AND CONN TO NEW WM JUNE27/08
809 PRITCHARD RESIDENTIAL	19mm COPPER	1.21m WEL OF HOUSE 56.99m EEL OF SINCLAIR	0.3m W of SC	RENEWED AND CONN TO NEW WM OCT 9/91
813 PRITCHARD RESIDENTIAL	19mm COPPER	0.61m EEL OF HOUSE 47.85m EEL OF SINCLAIR	0.9m W of SC	RENEWED AND CONN TO NEW WM OCT 9/91
815 PRITCHARD RESIDENTIAL	19mm COPPER	1.21m EEL OF HOUSE 38.10m EEL OF SINCLAIR	1.21m W of SC	RENEWED AND CONN TO NEW WM OCT 9/91
819 PRITCHARD RESIDENTIAL	19mm COPPER	1.21m WEL OF HOUSE 27.12m EEL OF SINCLAIR	2.13m E of SC	RENEWED AND CONN TO NEW WM OCT 9/91
827 PRITCHARD RESIDENTIAL	19mm COPPER	5.85m EWL OF HOUSE 6.40m EEL OF SINCLAIR	0.38m E of SC	RENEWED AND CONN TO NEW WM OCT 9/91

150 mm W.M.	WATERMAIN	150 mm W.M.	HYDRO	150 mm W.M.	WATERMAIN
	HYDRANT		TELEPHONE		HYDRANT
	VALVE		CONCRETE		VALVE
	LAND DRAINAGE SEWER		ASPHALT		LAND DRAINAGE SEWER
	WASTEWATER SEWER		PROPERTY LINE		WASTE WATER SEWER
	MANHOLE		SURVEY BAR		PROFILE
	CATCH BASIN		CURB STOP		
	CURB INLET		TREE		
	JUNCTIONS		ANODE		
	CULVERT		CONCRETE SIDEWALK FENCE		
	GAS				
EXISTING	LEGEND - PLAN	PROPOSED	EXISTING	LEGEND - PLAN	PROPOSED
			EXISTING	LEGEND - PROFILE	PROPOSED

LOCATION APPROVED UNDERGROUND STRUCTURES

SUPV. U/G STRUCTURES COMMITTEE DATE

NOTE: LOCATION OF UNDERGROUND STRUCTURES AS SHOWN ARE BASED ON THE BEST INFORMATION AVAILABLE, BUT NO GUARANTEE IS GIVEN THAT ALL EXISTING UTILITIES ARE SHOWN OR THAT THE GIVEN LOCATIONS ARE EXACT. CONFIRMATION OF EXISTENCE AND EXACT LOCATION OF ALL SERVICES MUST BE OBTAINED FROM THE INDIVIDUAL UTILITIES BEFORE PROCEEDING WITH CONSTRUCTION.

B.M. ELEV. N.W. Cor. Arlington St. & Selkirk Ave., Tbt. in S. Conc. foundation of King Edward Community School, 0.5 m W. & 0.1 m below Tyndal Stone of the most S. Ely. Cor. of School.

EARTH TECH

Earth Tech (Canada) Inc. Winnipeg, Manitoba 204.477.5381

DESIGNED BY: PL CHECKED BY: PL

DRAWN BY: JP APPROVED BY: KWF

HOR. SCALE: 1:250
 VERTICAL SCALE: 1:50

ISSUED FOR TENDER: 2008/08/01 PL
 ISSUED FOR REVIEW: 2008/07/16 PL

NO. REVISIONS DATE BY

DATE: 2007/04/11

ENGINEER'S SEAL

PROVINCE OF MANITOBA
K.W. FITCHETT
 REGISTERED PROFESSIONAL ENGINEER

CONSULTANT DRAWING NO. 104450-01

THE CITY OF WINNIPEG
 Winnipeg WATER AND WASTE DEPARTMENT

2008 SEWER RENEWALS

PRITCHARD AVENUE BETWEEN SINCLAIR STREET AND ARLINGTON STREET

SHEET 2 OF 16
 CITY DRAWING NUMBER 8653