

MATERIAL LIST

ITEM	MANUFACTURER	MATERIAL SPECIFICATION	SPECIAL FEATURES
2. SEWER PIPE			
375 OVERFLOW PIPE	SDEPTER	ASTM D3034	PVC SR 35
375 OVERFLOW PIPE	NORTHERN PIPE PRODUCTS	ASTM D3034	PVC SR 35
MANHOLES	GENSTAR MATERIALS	ASTM C-478	PRECAST CONCRETE
MANHOLE FRAMES & COVERS	HORWOOD FOUNDRY	ASTM A-48 CLASS 20	
4. ROADS			
ITEM	MANUFACTURER/SUPPLIER		
CONCRETE	SUPERCRETE		
REINFORCING STEEL	COMIN STEEL		
CONTRACTOR: B-A CONSTRUCTION LTD.			
CONSTRUCTION PERIOD: NOVEMBER/DECEMBER, 1987			
FIELD BOOK NO. 87116			

REF. or DRAWING NO. 41-02-0066-196-01
 DETAILS OVERFLOW CONTROL STRUCTURE -
 DWG. 03

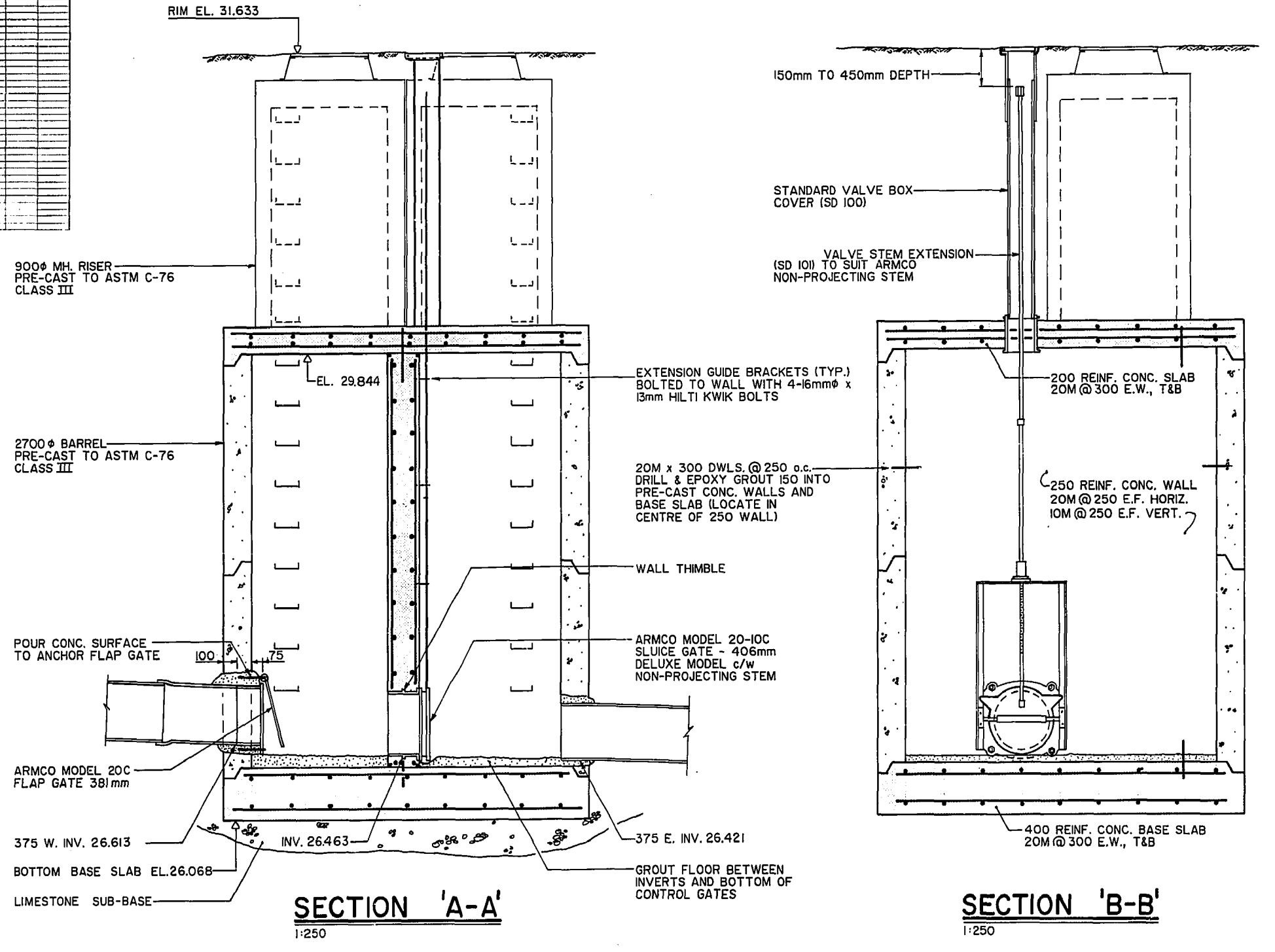
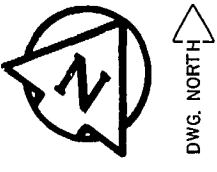
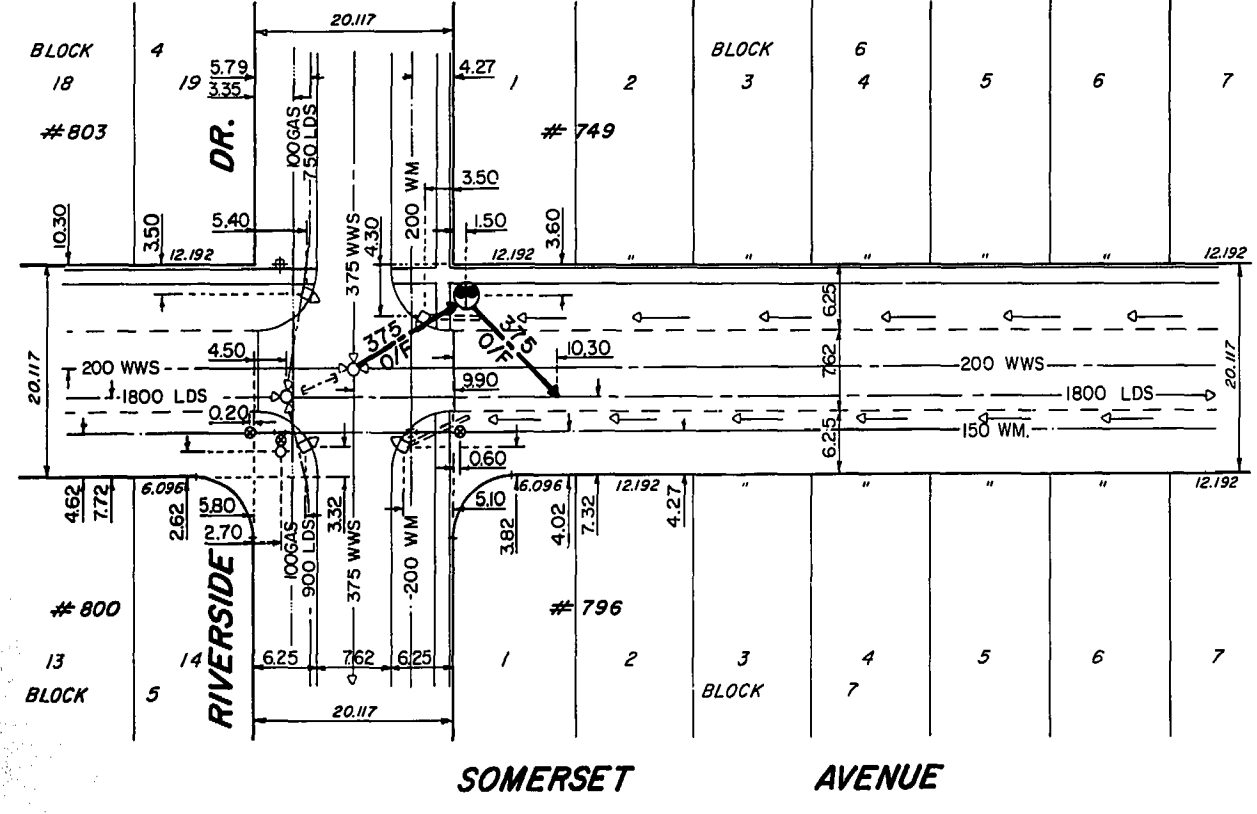

METRIC

WHOLE NUMBERS INDICATE MILLIMETRES
 DECIMALIZED NUMBERS INDICATE METRES

18 Jan 88
 CCM RECORD DRAWING

150 mm W.M.	WATERMAIN	150 mm W.M.	HYDRO	150 mm W.M.	WATERMAIN
	HYDRANT		M.T.S.		HYDRANT
	VALVE		CONCRETE		VALVE
	LAND DRAINAGE SEWER		ASPHALT		LAND DRAINAGE SEWER
	WASTE WATER SEWER		PROPERTY LINE		WASTE WATER SEWER
	MANHOLE		SURVEY BAR		Q. PROFILE
	CATCH BASIN				N. P. PROFILE
	CURB INLET				
	JUNCTIONS				
	CULVERT				
	GAS				
EXISTING	LEGEND-PLAN	PROPOSED	EXISTING	LEGEND-PLAN	PROPOSED
EXISTING	LEGEND-PROFILE	PROPOSED	EXISTING	LEGEND-PROFILE	PROPOSED

LOCATION APPROVED
 UNDERGROUND STRUCTURES

DATE: _____

NOTE:
 LOCATION OF UNDERGROUND STRUCTURES AS SHOWN ARE BASED ON THE BEST INFORMATION AVAILABLE BUT NO GUARANTEE IS GIVEN THAT ALL EXISTING UTILITIES ARE SHOWN OR THAT THE GIVEN LOCATIONS ARE EXACT. CONFIRMATION OF EXISTENCE AND EXACT LOCATION OF ALL SERVICES MUST BE OBTAINED FROM THE INDIVIDUAL UTILITIES BEFORE PROCEEDING WITH CONSTRUCTION.

NO.	REVISIONS	DATE	BY
B	REVISED TO RECORD DWG.	12-01-88	L.S.
A	Added Glass Lids on W/Side Boxes	4-20-87	leg

UMA Engineering Ltd.
 Engineers & Planners
 1475 Buffalo Place - Winnipeg, Manitoba, Canada R3T 1T7

DESIGNED BY: C.C.M.
 CHECKED BY: DR
 DRAWN BY: D.M.L.
 APPROVED BY: [Signature]

HOR SCALE: 1:500
 VERTICAL: 1:50

RELEASED FOR CONSTRUCTION: [Signature]
 DATE: 1987 04 16

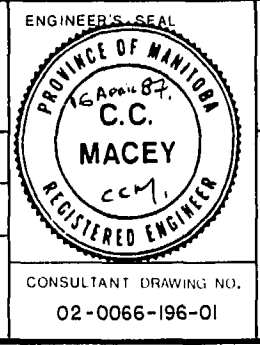

THE CITY OF WINNIPEG
 WORKS AND OPERATIONS DIVISION
 OPERATIONS DEPARTMENT - DISTRICT 6

OVERFLOW CONTROL STRUCTURE
 SOMERSET AVENUE @ RIVERSIDE DRIVE

CITY DRAWING NUMBER: SHEET 3 OF 3
03 B

CONSULTANT DRAWING NO.: 02-0066-196-01